



Chipsmall Limited consists of a professional team with an average of over 10 year of expertise in the distribution of electronic components. Based in Hongkong, we have already established firm and mutual-benefit business relationships with customers from,Europe,America and south Asia,supplying obsolete and hard-to-find components to meet their specific needs.

With the principle of “Quality Parts,Customers Priority,Honest Operation,and Considerate Service”,our business mainly focus on the distribution of electronic components. Line cards we deal with include Microchip,ALPS,ROHM,Xilinx,Pulse,ON,Everlight and Freescale. Main products comprise IC,Modules,Potentiometer,IC Socket,Relay,Connector.Our parts cover such applications as commercial,industrial, and automotives areas.

We are looking forward to setting up business relationship with you and hope to provide you with the best service and solution. Let us make a better world for our industry!



## Contact us

Tel: +86-755-8981 8866 Fax: +86-755-8427 6832

Email & Skype: info@chipsmall.com Web: www.chipsmall.com

Address: A1208, Overseas Decoration Building, #122 Zhenhua RD., Futian, Shenzhen, China



## SUMMARY

### # Wires

Low	2
High	2
Coax	0
Triax	0
Quad	0
Fiber	2
Fluidic	0



*Image is for illustrative purpose only*

### Download

[Request a quote](#)

[Catalog](#)

Series	3K
Termination type	Hybrid contacts
IP rating	68
Cable Ø	8.60 - 9.50 mm
Matching parts	FGW.3K.93C.TLMT96Z
Status	
Alternative part	

## TECHNICAL DETAILS

### Mechanics

Shell Style/Model	PB*: Fixed receptacle with rear square flange (4 hole fixing), cable adapter, with bend relief nut
Keying	5 keys (alpha=95, beta=115, gamma=20, delta=30, plug: female LV, male HV, female FO contacts)
Housing Material	Stainless steel shell, collet nut and latch sleeve, nickel plated brass mid pieces
Cable Fixing	T96: 8.6 - 9.5 mm
Variant	Z : Nut for fitting a bend relief

### Performance

Configuration	3K.93C : 2 FO Type F2, 2 HV + 2 LV
Insulator	L: PEEK (UL 94 / V-0/3.2, depends on material thickness)
Rated Current	10 Amps

### Specifications

Contact Type:	Crimp
Fiber Optic Contact:	Type F2
Vtest power/signal (AC):	2250V , 1000V
Working voltage power/signal(AC):	600V , 42V

Cable type: SMPTE 311M or EBU R100

## Others

Endurance (Shell): 5000 mating cycles  
Temp (min / max): -55°C / +200°C  
Humidity (max): ≤95% [at 60 deg C / 140 F]  
Vibration: 15 g [10 Hz - 2000 Hz]  
Shock Resistance: 100 g [ 6 ms]  
Salt Spray Corrosion: >1000 hr  
Climatical Category: 50/175/21  
Shielding (min): 95 dB (10 MHz)  
Shielding (min): 80 dB (1 GHz)  
IP Rating: 68

---

## DRAWINGS

### Draws

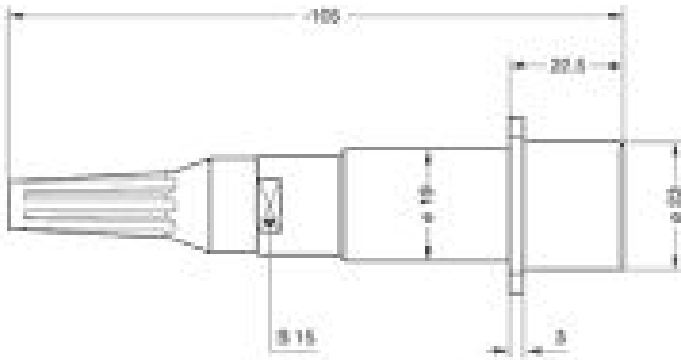

### Dimensions

	A	L
mm.	23	105
in.	0,91	4,13

---

## RECOMMENDED BY LEMO

### Tools

Crimp Tool: DPC.91.701.V  
Crimp Tool 2: DPC.91.101.A  
Crimp settings: AWG/Selector = 20-22-24 14-16-18/6-5-5 7-6-5  
Positionner: DCE.91.093.BVC

Positionner 2: DCE.91.133.BVCW  
Extractor: DCF.91.093.5LT  
Extractor 2: DCF.91.133.5LT  
Fiber Tool: WST.KI.125.34  
Fiber Tool 2: DCB.91.119.0TN  
Replacement contact: FGG.3B.560.ZZC / EGW.3K.666.ZZM  
Spanner wrench: DCD.3E.030.PA150

## Cables

CFN.3K.93C.092PNCA	PVC	Black	
CFN.3K.93C.092PNCS	PVC	Black	