



Chipsmall Limited consists of a professional team with an average of over 10 year of expertise in the distribution of electronic components. Based in Hongkong, we have already established firm and mutual-benefit business relationships with customers from,Europe,America and south Asia,supplying obsolete and hard-to-find components to meet their specific needs.

With the principle of “Quality Parts,Customers Priority,Honest Operation,and Considerate Service”,our business mainly focus on the distribution of electronic components. Line cards we deal with include Microchip,ALPS,ROHM,Xilinx,Pulse,ON,Everlight and Freescale. Main products comprise IC,Modules,Potentiometer,IC Socket,Relay,Connector.Our parts cover such applications as commercial,industrial, and automotives areas.

We are looking forward to setting up business relationship with you and hope to provide you with the best service and solution. Let us make a better world for our industry!



Contact us

Tel: +86-755-8981 8866 Fax: +86-755-8427 6832

Email & Skype: info@chipsmall.com Web: www.chipsmall.com

Address: A1208, Overseas Decoration Building, #122 Zhenhua RD., Futian, Shenzhen, China



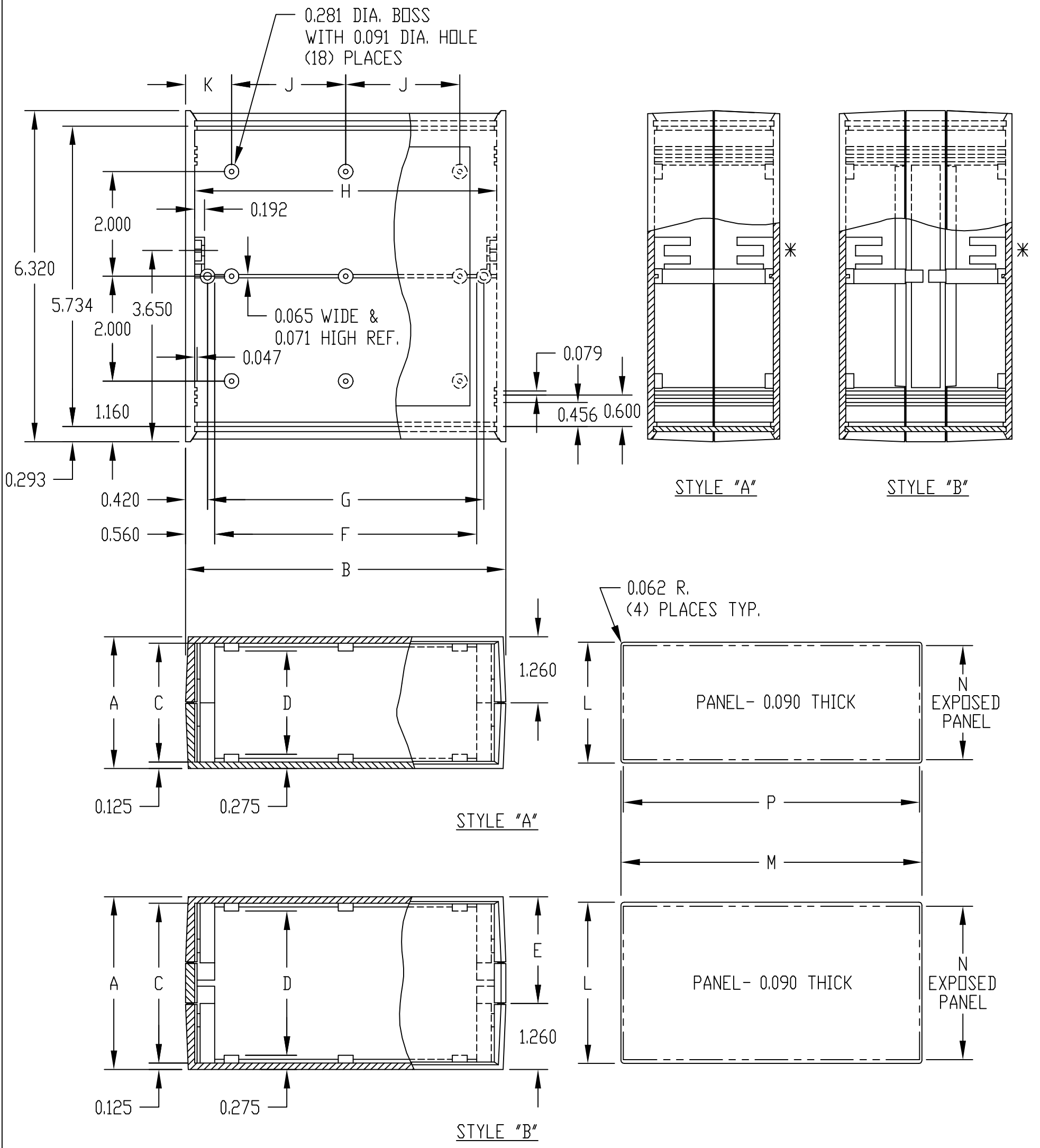

NOTE: ALL DIMENSIONS HAVE ±0.015 TOLERANCE
UNLESS OTHERWISE SPECIFIED

MATERIAL: IMPACT RESISTANT POLYSTYRENE (UL94-HB)
FINISH: DOUBLE-TEXTURED PC BONE GRAY

PC-11406 & PC-11408 SUPPLIED WITH TWO (2) #6 x 1.750" LG. SCREWS & FOUR (4) RUBBER FEET FOR ASSEMBLY
PC-11410 & PC-11412 SUPPLIED WITH TWO (2) #6 x 2.500" LG. SCREWS & FOUR (4) RUBBER FEET FOR ASSEMBLY.
PC-11414 & PC-11416 SUPPLIED WITH TWO (2) #6 x 3.250" LG. SCREWS & FOUR (4) RUBBER FEET FOR ASSEMBLY.

NOTE: MOUNTING BOSSES USE EITHER M2.5 METRIC OR #4 STD. SHEET METAL SCREWS x 0.250" LG. (NOT SUPPLIED).

* - NUT RETAINERS NOT INCLUDED IN THE BASES OF UNITS MARKED WITH ASTERICKS

PART No.	STYLE	A	B	C	D	E	F	G	H	J	K	L	M	N	P
* PC-11406	A	2.520	6.120	2.270	1.970	---	5.000	5.280	5.770	2.180	0.880	2.310	5.750	2.180	5.650
PC-11408	A	2.520	8.100	2.270	1.970	---	6.980	7.260	7.750	3.120	0.930	2.310	7.750	2.180	7.650
* PC-11410	B	3.300	6.120	3.050	2.750	2.040	5.000	5.280	5.770	2.180	0.880	3.080	5.750	2.930	5.650
PC-11412	B	3.300	8.100	3.050	2.750	2.040	6.980	7.260	7.750	3.120	0.930	3.080	7.750	2.930	7.650
* PC-11414	B	4.040	6.120	3.790	3.490	2.780	5.000	5.280	5.770	2.180	0.880	3.830	5.750	3.680	5.650
PC-11416	B	4.040	8.100	3.790	3.490	2.780	6.980	7.260	7.750	3.120	0.930	3.830	7.750	3.680	7.650