



Chipsmall Limited consists of a professional team with an average of over 10 year of expertise in the distribution of electronic components. Based in Hongkong, we have already established firm and mutual-benefit business relationships with customers from,Europe,America and south Asia,supplying obsolete and hard-to-find components to meet their specific needs.

With the principle of “Quality Parts,Customers Priority,Honest Operation,and Considerate Service”,our business mainly focus on the distribution of electronic components. Line cards we deal with include Microchip,ALPS,ROHM,Xilinx,Pulse,ON,Everlight and Freescale. Main products comprise IC,Modules,Potentiometer,IC Socket,Relay,Connector.Our parts cover such applications as commercial,industrial, and automotives areas.

We are looking forward to setting up business relationship with you and hope to provide you with the best service and solution. Let us make a better world for our industry!



Contact us

Tel: +86-755-8981 8866 Fax: +86-755-8427 6832

Email & Skype: info@chipsmall.com Web: www.chipsmall.com

Address: A1208, Overseas Decoration Building, #122 Zhenhua RD., Futian, Shenzhen, China



THIS COPY IS PROVIDED ON A RESTRICTED BASIS AND IS NOT TO BE USED IN ANY WAY DETRIMENTAL TO THE INTERESTS OF PANDUIT CORP.

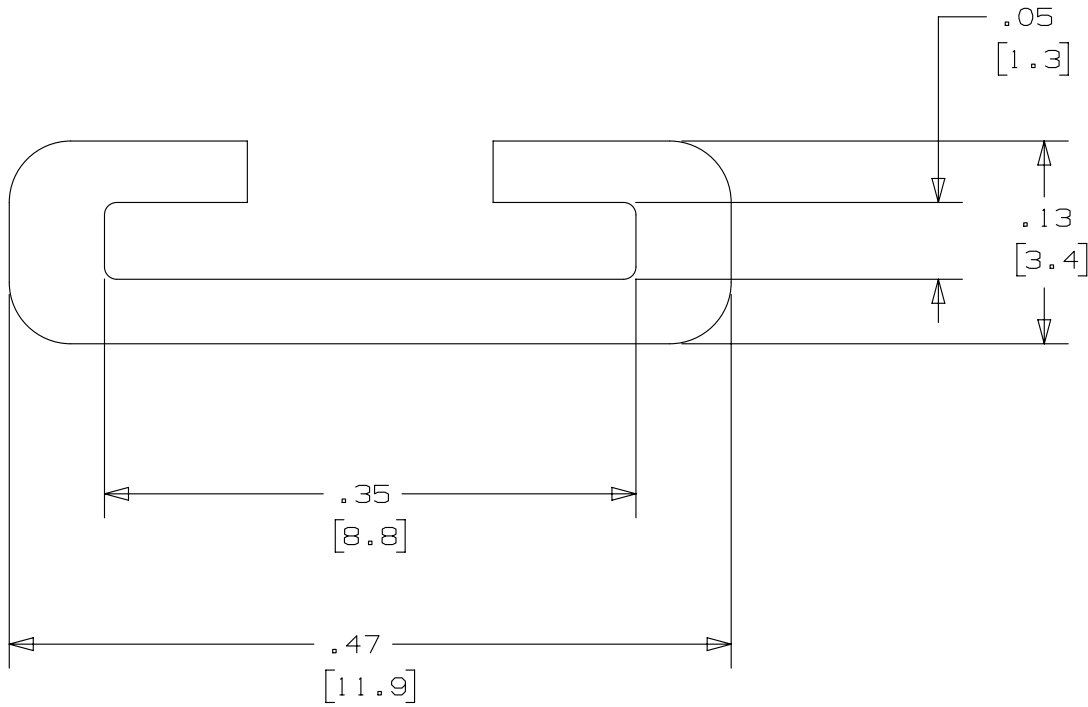

NOTES:

1. MAT'L. - NEOPRENE
2. FLAMMABILITY RATING UL94V-0
3. COLOR - BLACK
4. MATERIAL TO BE SUPPLIED IN 100' LENGTHS
5. WGT./100' - 3.0 LBS.
6. BRACKETS [] DENOTES DIMENSIONS IN MILLIMETERS

REV	DATE	BY	CHK	APR	DESCRIPTION	ECN	TITLE			MATERIAL:	
							PROTECTIVE CUSHION STRIP (HEAVY) PCSH-B-CR			SEE NOTES	
							CUSTOMER DRAWING			DRAWING NUMBER: N41015BS_DV	
03A	2/13	JAMB	MIM	RGRO	UPDATE DRAWING TO NEW PANDUIT GLOBAL TITLE BLOCK WITH PANDUIT LOGO	SSECN01031	ITEM REVISION NAME N41015BS/03			DWG	
02A	4/08	JAMB	SKB	----	CAD FILE SPEC WAS N41015BS/02. ADDED INSIDE DIMENSION TO CUSHION STRIP DIMENSION .13" [3.4] WAS .132" [3.35]	-----	DATASET FILE NAME N41015BS_DV/03A			DWG	
02	2/01	KMD	SKB	----	REDRAWN ON CAD	-----	UNLESS OTHERWISE SPECIFIED, DIMENSIONAL TOLERANCES ARE: IN [mm]			DWG	
01	9/96	JKD	JD	----	ADDED NOTE 6. ADDED mm TO DIMENSIONS	09095	.x ± .1 [2.54] .xxx ± .005 [.127] .xx ± .01 [.25] ANGLES ± 5 °			DWG	
R	3/84	MG	LA	----	DRAWING RELEASED	05048	THIRD ANGLE PROJECTION			DWG	
							CHK'D	DATE	CHK	SCALE	SIZE
							MG	3/15/84	JAC	8:1	A