



Chipsmall Limited consists of a professional team with an average of over 10 year of expertise in the distribution of electronic components. Based in Hongkong, we have already established firm and mutual-benefit business relationships with customers from,Europe,America and south Asia,supplying obsolete and hard-to-find components to meet their specific needs.

With the principle of “Quality Parts,Customers Priority,Honest Operation,and Considerate Service”,our business mainly focus on the distribution of electronic components. Line cards we deal with include Microchip,ALPS,ROHM,Xilinx,Pulse,ON,Everlight and Freescale. Main products comprise IC,Modules,Potentiometer,IC Socket,Relay,Connector.Our parts cover such applications as commercial,industrial, and automotives areas.

We are looking forward to setting up business relationship with you and hope to provide you with the best service and solution. Let us make a better world for our industry!



## Contact us

Tel: +86-755-8981 8866 Fax: +86-755-8427 6832

Email & Skype: info@chipsmall.com Web: www.chipsmall.com

Address: A1208, Overseas Decoration Building, #122 Zhenhua RD., Futian, Shenzhen, China



Requires Tripp Lite 3-phase auto-transfer switch (ATS) PDU (sold separately).

- PDU330AT6L15
- PDU330AT6L1530
- PDU330AT6L2130
- PDU330AT6H50

## 8.6/12.6kW 3-Phase Vertical PDU Strip, 208V Outlets (51 C13), 0U Rack-Mount, Required Accessory for Select ATS PDUs

MODEL NUMBER: PDU3V51

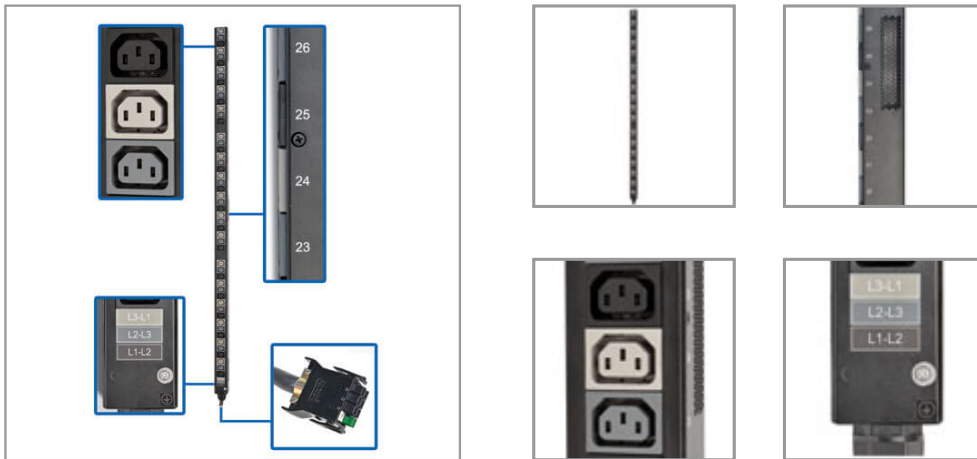

Required rack-mounted vertical outlet strip accessory for select Tripp Lite 3-phase auto-transfer switch (ATS) PDUs. Distributes AC power to high-density equipment racks in data centers and server rooms.

### Description

The PDU3V51 8.6/12.6kW 3-Phase Vertical PDU Outlet Strip is a required accessory for Tripp Lite's PDU330AT6L15, PDU330AT6L2130, PDU330AT6L1530, PDU350AT6H50 and other 3-phase ATS PDUs that specify compatibility with this model. It's ideal for high-density equipment racks in data centers and server rooms.

When used with 208V ATS PDUs with a 35A input rating, the PDU3V51 supports up to 12.6kW total output with 20A maximum full balanced load per phase combination output bank (L1-L2, L2-L3, L3-L1). When used with 208V ATS PDUs with a 24A input rating, it supports up to 8.6kW total output with 13.9A maximum full balanced load per phase combination output bank.

The 51 single-phase 12A C13 outlets receive power from the connected ATS PDU. The outlets are interlaced to help you balance loads by spreading connections across the phase combinations (L1-L2, L2-L3, L3-L1) throughout the rack. Each outlet is numbered and color-coded to help you keep track of connected devices and which phase combination powers them. The 2.5-foot power cord with eight-position plug connects directly to the ATS PDU's rear outlet.

The PDU3V51's rugged all-metal housing mounts in compatible racks in seconds with no tools needed.

### Highlights

- Required for select Tripp Lite 3-phase ATS PDUs
- 51 single-phase 12A C13 outlets
- Supports up to 8.6 or 12.6kW total output
- Simplifies load balancing with interlaced color-coded outlets
- Supports 0U toolless vertical rack mounting

### Package Includes

- PDU3V51 8.6/12.6kW 3-Phase Vertical PDU Outlet Strip, 2.5 ft. cord





Vertical 0U installation reduces cable clutter and improves airflow through the rack to keep your equipment cool and functioning at its peak.

## Features

### Required Accessory for Select Tripp Lite ATS PDUs

- Compatible with PDU330AT6L15, PDU330AT6L2130, PDU330AT6L1530, PDU350AT6H50 and other select Tripp Lite 3-phase ATS PDUs
- Ideal for high-density equipment racks in data centers and server rooms
- Supports up to 12.6kW total output with 20A maximum per output bank when connected to 208V ATS PDUs with a 35A input rating
- Supports up to 8.6kW total output with 13.9A maximum per output bank when connected to 208V ATS PDUs with a 24A input rating

### 51 Interlaced C13 Outlets

- Single-phase 12A C13 outlets balance loads by spreading connections across all phase combinations throughout the rack
- Numbered and color-coded for easy identification of connected devices and which phase combination output bank powers them

### Installs Easily in 0U of Rack Space

- Preinstalled mounting buttons for toolless vertical rack-mounting in compatible racks
- Reduces cable clutter by locating outlets closer to connected devices
- Improves airflow through the rack to keep equipment cool and functioning at its peak
- Rugged all-metal housing designed to last a long time
- 2.5 ft. power cord with 8-position plug that connects directly to ATS PDU

## Specifications

OVERVIEW	
UPC Code	037332181367
Accessories Type	0U Strip for 3-Phase ATS PDU
OUTPUT	
Output Capacity Details	Supports up to 12.6kW total output; 20A max per output phase (L1-L2, L2-L3, L3-L1) when used with 35A max 208V input ATS models (such as PDU350AT6H50); Supports up to 8.6kW total output; 13.9A max per output phase (L1-L2, L2-L3, L3-L1) when used with 24A max 208V input ATS models (such as PDU330AT6L2130, PDU330AT6L1530 and PDU330AT6L15); All configurations: 12A max per C13 outlet
Nominal Output Voltage(s) Supported	200V; 208V; 220V; 230V; 240V
Frequency Compatibility	50 / 60 Hz
Output Receptacles	(51) C13



**Tripp Lite**  
1111 W. 35th Street  
Chicago, IL 60609 USA  
Telephone: 773.869.1234  
www.tripplite.com

Overload Protection	n/a
<b>INPUT</b>	
PDU Input Voltage	200; 208; 220; 230; 240
Input Cord Details	Includes 7 conductor input plug for use with compatible Tripp Lite ATS PDU products only
Input Cord Length (ft.)	2.5
Input Cord Length (m)	0.76
Input Phase	3-Phase
<b>PHYSICAL</b>	
Shipping Dimensions (hwd / in.)	5.200 x 6.600 x 69.500
Shipping Dimensions (hwd / cm)	13.21 x 16.76 x 176.53
Shipping Weight (lbs.)	12.3000
Shipping Weight (kg)	5.58
Unit Dimensions (hwd / in.)	63 x 2.2 x 2.22
Unit Dimensions (hwd / cm)	160.0 x 5.59 x 5.64
Unit Weight (lbs.)	9.11
Unit Weight (kg)	4.13
Material of Construction	Metal
Form Factors Supported	Vertical rackmount installation supported with toolless mounting in button-mount compatible racks
PDU Form Factor	Vertical (0U)
<b>ENVIRONMENTAL</b>	
Operating Temperature Range	0 to 50C (32 to 122F)
Storage Temperature Range	-15C to 60C (5 to 140F)
Relative Humidity	5-95% non-condensing
Operating Elevation (ft.)	0-10,000
Operating Elevation (m)	0-3000
<b>CERTIFICATIONS</b>	
Certifications	Tested to UL60950-1 (USA), CSA (Canada), NOM (Mexico), FCC Class A (Emissions), ROHS
<b>WARRANTY</b>	
Product Warranty Period (Worldwide)	5-year limited warranty

© 2018 Tripp Lite. All rights reserved. All product and company names are trademarks or registered trademarks of their respective holders. Use of them does not imply any affiliation with or endorsement by them. Tripp Lite has a policy of continuous improvement. Specifications are subject to change without notice. Tripp Lite uses primary and third-party agencies to test its products for compliance with standards. See a list of Tripp Lite's testing agencies:



**Tripp Lite**  
1111 W. 35th Street  
Chicago, IL 60609 USA  
Telephone: 773.869.1234  
[www.tripplite.com](http://www.tripplite.com)

<https://www.tripplite.com/products/product-certification-agencies>