



Chipsmall Limited consists of a professional team with an average of over 10 year of expertise in the distribution of electronic components. Based in Hongkong, we have already established firm and mutual-benefit business relationships with customers from,Europe,America and south Asia,supplying obsolete and hard-to-find components to meet their specific needs.

With the principle of “Quality Parts,Customers Priority,Honest Operation,and Considerate Service”,our business mainly focus on the distribution of electronic components. Line cards we deal with include Microchip,ALPS,ROHM,Xilinx,Pulse,ON,Everlight and Freescale. Main products comprise IC,Modules,Potentiometer,IC Socket,Relay,Connector.Our parts cover such applications as commercial,industrial, and automotives areas.

We are looking forward to setting up business relationship with you and hope to provide you with the best service and solution. Let us make a better world for our industry!



Contact us

Tel: +86-755-8981 8866 Fax: +86-755-8427 6832

Email & Skype: info@chipsmall.com Web: www.chipsmall.com

Address: A1208, Overseas Decoration Building, #122 Zhenhua RD., Futian, Shenzhen, China



POWER DISCRETES
Description

Quick reference data

$$V_R = 5 - 7.5\text{kV}$$

$$I_F = 92\text{mA}$$

$$t_{rr} = 250\text{nS}$$

$$I_R = 0.5\mu\text{A}$$

Features

- ◆ Low reverse recovery time
- ◆ Very low leakage current
- ◆ Glass passivated for hermetic sealing
- ◆ Soft, non-snap off, recovery characteristics
- ◆ Avalanche capability
- ◆ Please contact factory regarding HR screening

Absolute Maximum Ratings

Electrical specifications @ $T_A = 25^\circ\text{C}$ unless otherwise specified.

| | Symbol | PFM50A | PFM75A | Units |
|-------------------------------------------------------------------------------|-------------|-------------|--------|------------------|
| Working Reverse Voltage | V_{RWM} | 5000 | 7500 | V |
| Repetitive Reverse Voltage | V_{RRM} | 5650 | 8500 | V |
| Surge Reverse Voltage | V_{RSM} | 5650 | 8500 | V |
| Average Forward Current @ 55°C , in oil | $I_{F(AV)}$ | 92 | | mA |
| Repetitive Surge Current @ 55°C in oil, lead length 0.375" | $I_{F(AV)}$ | 1.0 | | A |
| Non-Repetitive Surge Current ($t_p = 8.3\text{mS}$ @ V_R & T_{JMAX}) | I_{FSM} | 2.0 | | A |
| Storage Temperature Range | T_{STG} | -65 to +150 | | $^\circ\text{C}$ |

POWER DISCRETES

Electrical Specifications

Electrical specifications @ $T_A = 25^\circ\text{C}$ unless otherwise specified.

| | Symbol | PFM50A/PFM75A | Units |
|-----------------------------------------------------------------------------------------------------------|----------------|---------------|---------------|
| Average Forward Current max. Unstirred oil @ 55°C | $I_{F(AV)}$ | 92 | mA |
| Forward Voltage Drop max. @ $I_F = 25\text{mA}$, $T_J = 25^\circ\text{C}$ | V_F | 12.5 | V |
| Reverse Current max. @ V_{RWM} , $T_J = 25^\circ\text{C}$ @ V_{RWM} , $T_J = 100^\circ\text{C}$ | I_R I_R | 0.5 20 | μA |
| Reverse Recovery Time max. 50mA I_F , 100mA I_R , 25mA $I_{RM(REC)}$ | t_{rr} | 250 | nS |
| Junction Capacitance typ. @ $V_R = 50\text{V}$, $f = 1\text{KHz}$ | C_j | 2 | pF |

Thermal Characteristics

| | Symbol | PFM50A/PFM75A | Units |
|--------------------------------------------------------------------------|-----------------|---------------|--------------------|
| Thermal Resistance-Junction to Oil Stirred oil Unstirred oil | $R_{\theta JO}$ | 48 64 | $^\circ\text{C/W}$ |
| Thermal Resistance-Junction to Ambient On 0.06" thick pcb. 1oz copper | $R_{\theta JA}$ | 160 | $^\circ\text{C/W}$ |

POWER DISCRETES

Ordering Information

| Part Number | Description |
|---------------|-------------------------------------------------|
| PFM50A/PFM75A | Axial leaded hermetically sealed ⁽¹⁾ |

Note:

(1) Available in bulk and tape and reel packaging. Please consult factory for quantities.

Outline Drawing

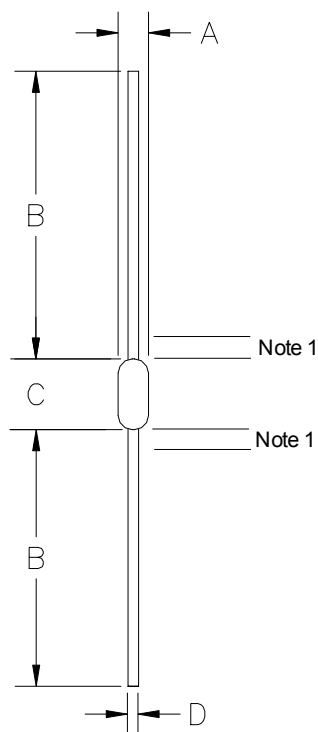

G82

| Dimensions | | | | | |
|------------------|--------|-------|-------------|------|------|
| DIM ^N | Inches | | Millimeters | | Note |
| | MIN | MAX | MIN | MAX | |
| A | - | .118 | - | 3.0 | - |
| B | 1.0 | - | 25.4 | - | - |
| C | - | .374 | - | 9.5 | - |
| D | - | 0.033 | - | 0.84 | - |

Note:

1. Lead diameter not controlled in this area.

Contact Information

Semtech Corporation
 Power Discretes Products Division
 200 Flynn Road, Camarillo, CA 93012
 Phone: (805)498-2111 FAX (805)498-3804