



Chipsmall Limited consists of a professional team with an average of over 10 year of expertise in the distribution of electronic components. Based in Hongkong, we have already established firm and mutual-benefit business relationships with customers from,Europe,America and south Asia,supplying obsolete and hard-to-find components to meet their specific needs.

With the principle of "Quality Parts,Customers Priority,Honest Operation,and Considerate Service",our business mainly focus on the distribution of electronic components. Line cards we deal with include Microchip,ALPS,ROHM,Xilinx,Pulse,ON,Everlight and Freescale. Main products comprise IC,Modules,Potentiometer,IC Socket,Relay,Connector.Our parts cover such applications as commercial,industrial, and automotives areas.

We are looking forward to setting up business relationship with you and hope to provide you with the best service and solution. Let us make a better world for our industry!



## Contact us

Tel: +86-755-8981 8866 Fax: +86-755-8427 6832

Email & Skype: [info@chipsmall.com](mailto:info@chipsmall.com) Web: [www.chipsmall.com](http://www.chipsmall.com)

Address: A1208, Overseas Decoration Building, #122 Zhenhua RD., Futian, Shenzhen, China



# Panel Actuators and Indicators

## Type PL 22

### Buzzer and Flashing Buzzer



- Ø 22mm (Ø0.87") dimension
- Buzzer
- Interrupted sound
- Flashing type
- AC and DC voltage
- cULus and CE
- IEC/EN 60947-5-1, IEC/EN 60073, IEC/EN 60529, UL 508



## Product description

Pilot lights and Buzzer are panel mounted device assemblies consisting of the housing, an internal lamp or buzzer, terminals, and a cover. Applications include industrial

control panels of all types, equipment indicator panels, status alarm indicator. The buzzer volume is 95dB @ 10cm (3.94"), the current is 20mA.

## Approvals



## Technical data

|  |                                  |
|--|----------------------------------|
| Rated imp. withstand voltage $U_{imp}$ | 2500VAC 50Hz 1min.               |
| Rated insulation Voltage $U_i$         | 500VAC                           |
| Allowable voltage fluctuation          | ±20%                             |
| Continuous operating life              | ≥100.000h                        |
| Ultrahigh brightness                   | ≥100cd/m <sup>2</sup> (≥9.29ftc) |
| Applying frequency                     | 50-60Hz                          |
| Current consumption (AC/DC)            | 15-20mA                          |
| Sound volume                           | 95dB @ 10cm (3.94")              |
| Operating temperature                  | -25 to +70°C (-13 to +158°F)     |
| Storage temperature                    | -30 to +80°C (-22 to +176°F)     |
| Degree of protection                   | IP 40                            |

## Ordering key

**PL 22S BZ R 24**

Series \_\_\_\_\_  
 Dimension \_\_\_\_\_  
 Type \_\_\_\_\_  
 Colour \_\_\_\_\_  
 Voltage \_\_\_\_\_

## Dimension and style

22S = Ø22mm (Ø0.87") standard size

## Types

BZ = Buzzer

FBZ= Flashing buzzer

## Colours

R = Red only for FBZ type

K = Black only for BZ type

## Voltages

06 = 6VAC/DC

12 = 12VAC/DC

24 = 24VAC/DC

48 = 48VAC/DC

110 = 110VAC/DC

220D = 220VDC

220A = 220VAC

380A = 380VAC

## Dimensions mm/inches

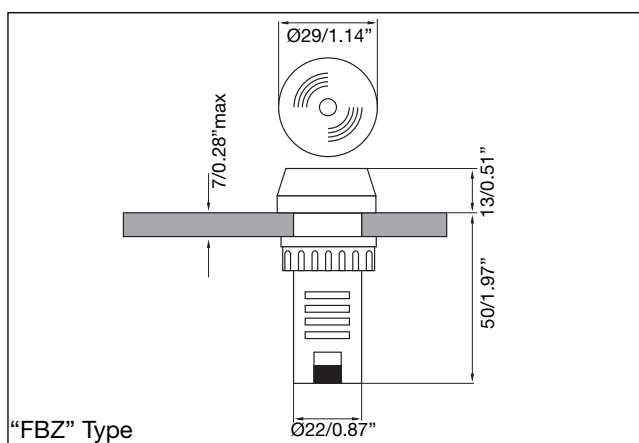
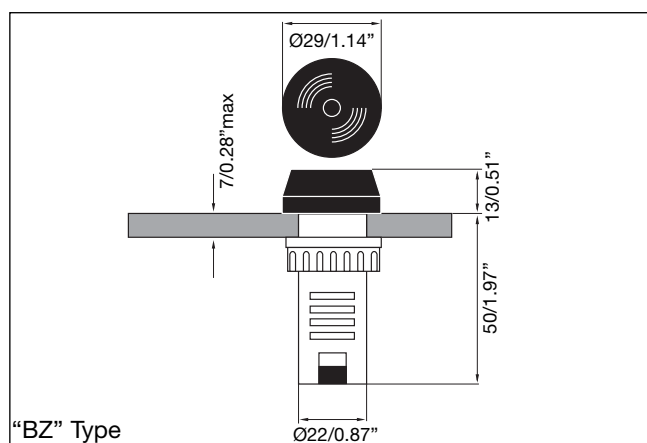

## Mounting

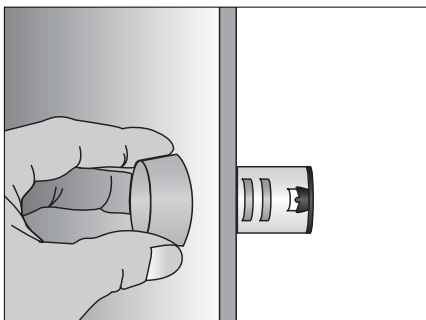

Just insert the pilot light into the hole of the pannel.

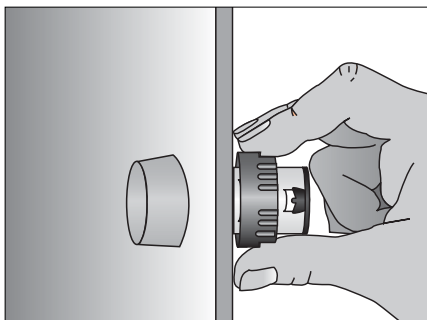

The pilot light will be secured at the back by the plastic nut

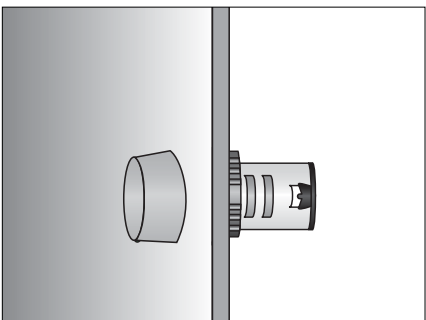

The pilot light has been installed.

## Wiring Diagram

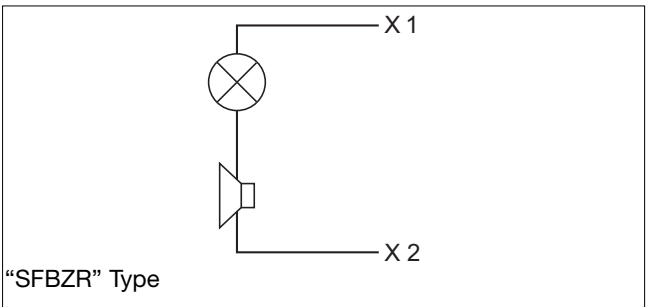
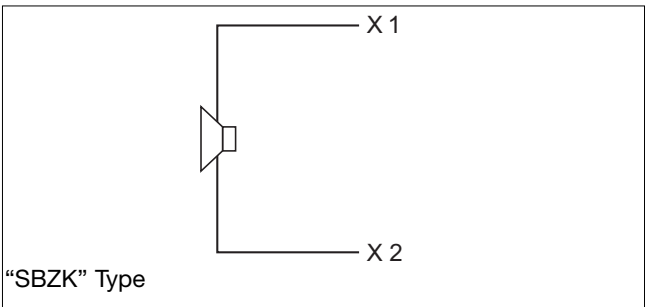

## Wiring Notes

- 1) Use 60°C or 75°C copper (CU) conductor and wire size range 18AWG, stranded or solid.
- 2) Terminal tightening torque 0.6Nm (5.3in.lb)
- 3) Recommended external fuse - listed or R/C fuses, Supplemental (JDYX, JDYX2) rated 3A mmaximum.

## Accessories for Panel Indicators



### Reducing ring for Pilot Light Ø22mm (0.87")

To mount the Ø22mm (0.87") pilot light into the hole for Ø25mm (0.98") or Ø30mm (1.18") of the panel.

ABS

Ø25mm/Ø0.98"  
Ø30mm/Ø1.18"

PA RR 2  
PA RR 3



### Fastening connector for Pilot Light Ø22mm (0.87")

Improve the quality of installation and reduce the time of installations.

PC

PA PL CONN



### Panel hole cap Ø22mm (0.87")

For blocking up prepared or useless holes on the panels.

ABS

PA PHC 22