



Chipsmall Limited consists of a professional team with an average of over 10 year of expertise in the distribution of electronic components. Based in Hongkong, we have already established firm and mutual-benefit business relationships with customers from,Europe,America and south Asia,supplying obsolete and hard-to-find components to meet their specific needs.

With the principle of “Quality Parts,Customers Priority,Honest Operation,and Considerate Service”,our business mainly focus on the distribution of electronic components. Line cards we deal with include Microchip,ALPS,ROHM,Xilinx,Pulse,ON,Everlight and Freescale. Main products comprise IC,Modules,Potentiometer,IC Socket,Relay,Connector.Our parts cover such applications as commercial,industrial, and automotives areas.

We are looking forward to setting up business relationship with you and hope to provide you with the best service and solution. Let us make a better world for our industry!



## Contact us

Tel: +86-755-8981 8866 Fax: +86-755-8427 6832

Email & Skype: info@chipsmall.com Web: www.chipsmall.com

Address: A1208, Overseas Decoration Building, #122 Zhenhua RD., Futian, Shenzhen, China



# Data Sheet

## PM202xxVBNN

### Illustration

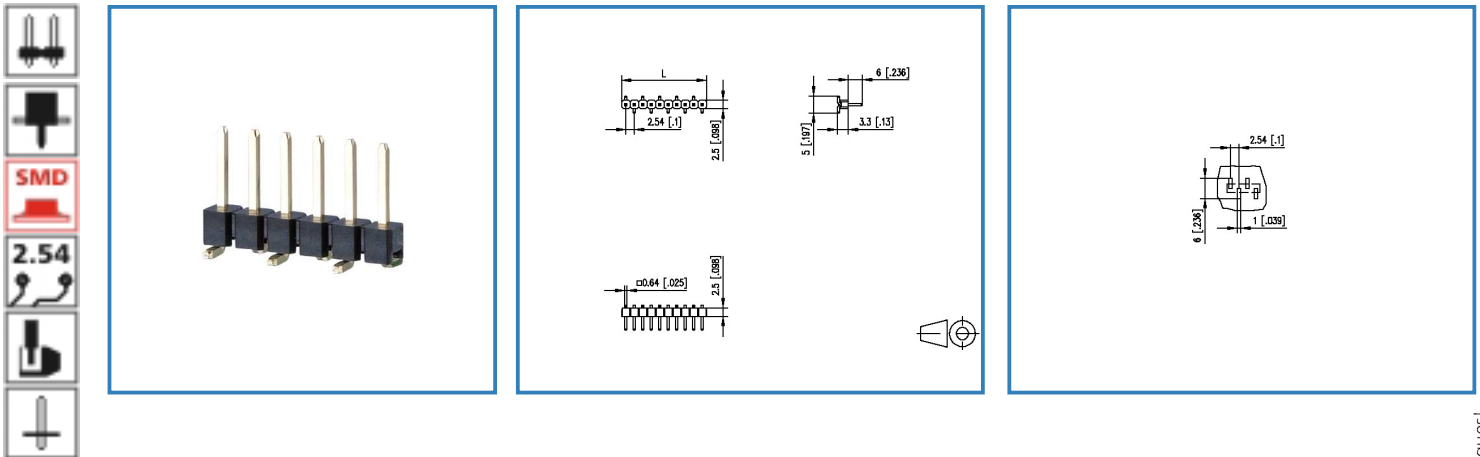

see enlarged drawing at the end of the document

### Product specification

- pin header, SMT solderable
- centerline 2.54 mm, direction of connection vertical 0°
- color black
- Tape & Reel packaging
- single row

© 2017 METZ CONNECT - Technische Änderungen vorbehalten! Subject to modifications! Sous réserve de modifications techniques!



# Data Sheet

## PM202xxVBNN

Page 2/4

P/N

PM202xxVBNN

xx=number of poles

2017/05/05

### Technical Data

#### General Data

min. number of poles	2
max. number of poles	40

#### Approvals

Rated current	3 A
---------------	-----

#### Material

insulating material	PE-HT
contact material	CuZn
Glow-Wire Flammability GWFI	-
Glow-Wire Flammability GWIT	-
contact surface	Ni + Au
contact pin material	CuZn
contact pin surface	Ni + Au Flash

#### Climatic properties

upper limit temperature	105 °C
lower limit temperature	-40 °C

#### General

solderability	Acc. to IPC/JEDEC J-STD-020D-MSL 1
Tolerance	ISO 2768 -mH



# Data Sheet

## PM202xxVBNN

### Illustration

#### Drawing

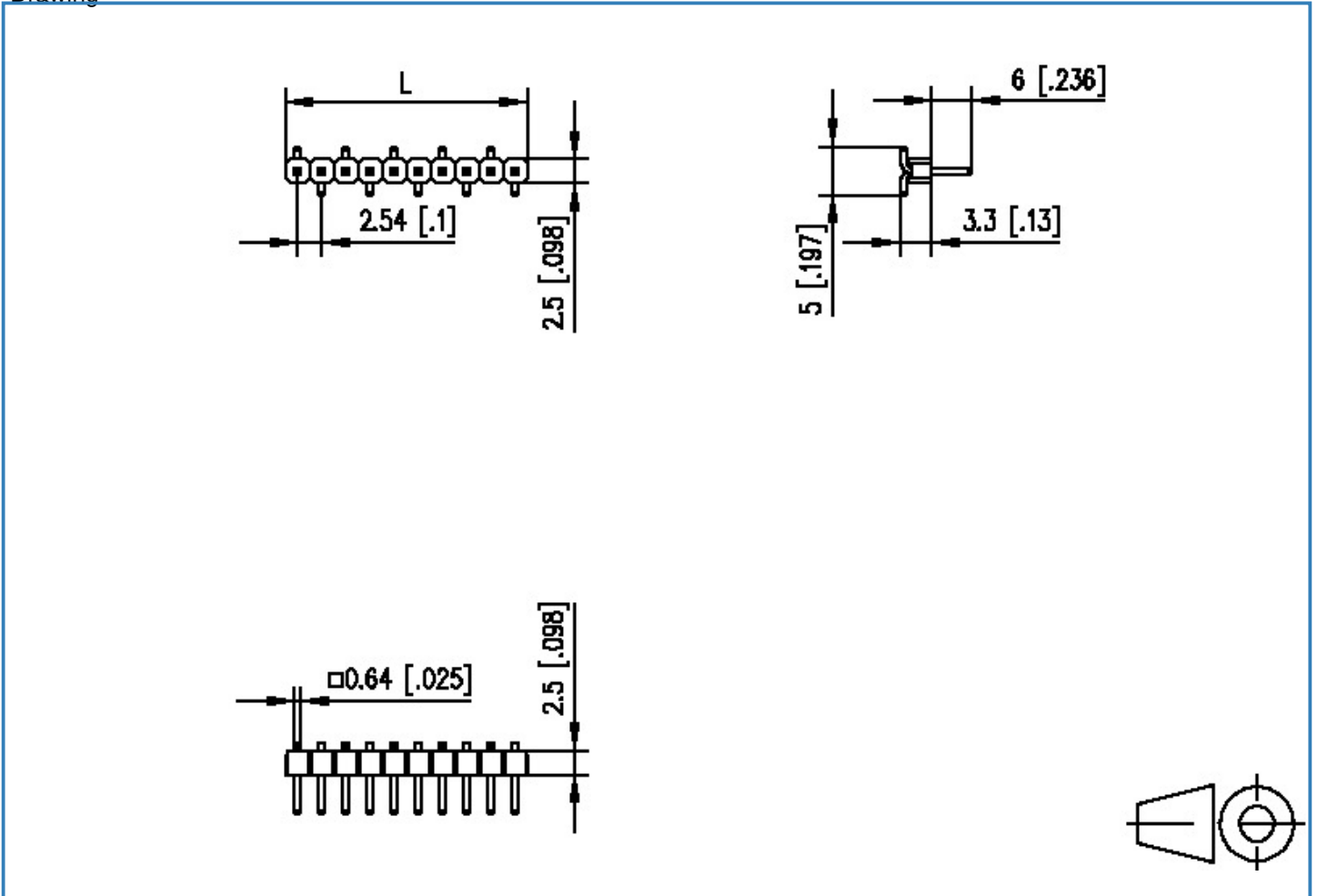

$$L = (\text{pole size} - 1) \times \text{centerline} + 2.54 [0.1]$$

**Data Sheet**  
**PM202xxVBNN**

Page 4/4

P/N

PM202xxVBNN

xx=number of poles

2017/05/05

PCB Layout

