



Chipsmall Limited consists of a professional team with an average of over 10 year of expertise in the distribution of electronic components. Based in Hongkong, we have already established firm and mutual-benefit business relationships with customers from,Europe,America and south Asia,supplying obsolete and hard-to-find components to meet their specific needs.

With the principle of “Quality Parts,Customers Priority,Honest Operation,and Considerate Service”,our business mainly focus on the distribution of electronic components. Line cards we deal with include Microchip,ALPS,ROHM,Xilinx,Pulse,ON,Everlight and Freescale. Main products comprise IC,Modules,Potentiometer,IC Socket,Relay,Connector.Our parts cover such applications as commercial,industrial, and automotives areas.

We are looking forward to setting up business relationship with you and hope to provide you with the best service and solution. Let us make a better world for our industry!



Contact us

Tel: +86-755-8981 8866 Fax: +86-755-8427 6832

Email & Skype: info@chipsmall.com Web: www.chipsmall.com

Address: A1208, Overseas Decoration Building, #122 Zhenhua RD., Futian, Shenzhen, China



THIS COPY IS PROVIDED ON A RESTRICTED BASIS AND IS NOT TO BE USED IN ANY WAY DETRIMENTAL TO THE INTERESTS OF PANDUIT CORP.

PANDUIT PART NUMBER		STUD SIZE	DIMENSIONS in.			
PREFIX	PK		A $\begin{smallmatrix} \pm .03 \\ (.76) \end{smallmatrix}$	W $\begin{smallmatrix} \pm .01 \\ (.25) \end{smallmatrix}$	C $\begin{smallmatrix} \pm .02 \\ (.51) \end{smallmatrix}$	M $\begin{smallmatrix} \pm .03 \\ (.76) \end{smallmatrix}$
PN18-610R	-C -M	#6, #8, #10	.95 (24.1)	.31 (7.9)	.25 (6.3)	.70 (17.8)

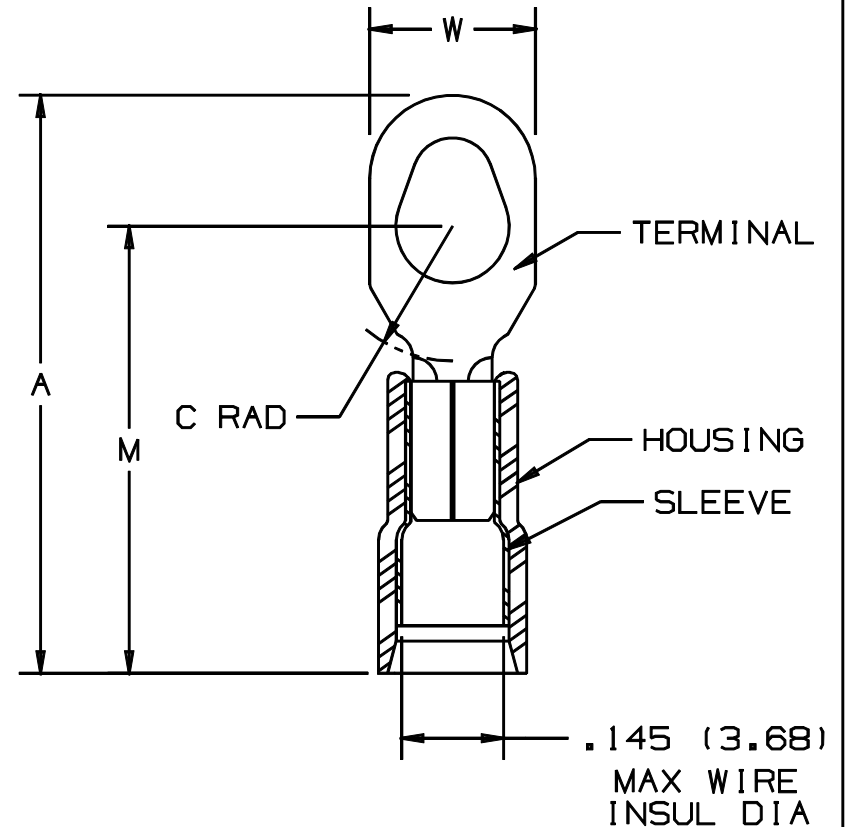

NOTES:

- UL LISTED AND CSA CERTIFIED FOR:
 - 600 V MAX VOLTAGE RATING
 - 221°F (105°C) MAX TEMP RATING
 - #22-18 AWG SOLID OR STRANDED, COPPER WIRE
- PACKAGE QUANTITY:
 - STD: C=100
 - BULK: M=1000
- MATERIAL:
 - STAMPING: .032 (.81) THK COPPER, TIN PLATED
 - HOUSING: RED NYLON
 - SLEEVE: BRASS, TIN PLATED
- WIRE STRIP LENGTH: $7/32 \begin{smallmatrix} +1/32 \\ -0 \end{smallmatrix}$ (5.6 $\begin{smallmatrix} +.8 \\ -0 \end{smallmatrix}$)
- DIMENSIONS IN BRACKETS ARE IN MILLIMETERS
- INSTALLATION TOOLS:
 - UL LISTED AND CSA CERTIFIED WITH: CT-100, CT-400(U.L. ONLY)*, CT-500*, CT-550*, CT-1551*, CT-1550*
 - PANDUIT APPROVED: CT-160, CT-260
* APPROVED FOR EXPANDED WIRE RANGE #22-16 AWG



LISTED
587H



CERTIFIED

A41483_04

04	1/01	RM		FILESPEC WAS N41483AA_PCD_03				<p>TINLEY PARK, ILLINOIS</p> <p>#22-18 BARREL, NYLON INSULATED MULTI-STUD TERMINAL</p>								
03		JKD		ADDED CT-1551 & CT-1550 TOOLS	07634											
02	3/95	MS	RS	UPDATED NOTES AND DIMENSIONS	03053	LA	KS									
01	2/92	BK	RS	UPDATED AGENCY APPROVAL STATUS	00846	LA	KS									
REV	DATE	BY	CHK	DESCRIPTION	ECN #	CUST	PM	<table border="0"> <tr> <td>DRAWN BY</td> <td>DRL</td> <td>CHK'D</td> <td>FES</td> <td>SCALE</td> <td>NONE</td> <td>DRAWING NO.</td> <td>A41483</td> </tr> </table>	DRAWN BY	DRL	CHK'D	FES	SCALE	NONE	DRAWING NO.	A41483
DRAWN BY	DRL	CHK'D	FES	SCALE	NONE	DRAWING NO.	A41483									