



Chipsmall Limited consists of a professional team with an average of over 10 year of expertise in the distribution of electronic components. Based in Hongkong, we have already established firm and mutual-benefit business relationships with customers from,Europe,America and south Asia,supplying obsolete and hard-to-find components to meet their specific needs.

With the principle of “Quality Parts,Customers Priority,Honest Operation,and Considerate Service”,our business mainly focus on the distribution of electronic components. Line cards we deal with include Microchip,ALPS,ROHM,Xilinx,Pulse,ON,Everlight and Freescale. Main products comprise IC,Modules,Potentiometer,IC Socket,Relay,Connector.Our parts cover such applications as commercial,industrial, and automotives areas.

We are looking forward to setting up business relationship with you and hope to provide you with the best service and solution. Let us make a better world for our industry!



## Contact us

Tel: +86-755-8981 8866 Fax: +86-755-8427 6832

Email & Skype: info@chipsmall.com Web: www.chipsmall.com

Address: A1208, Overseas Decoration Building, #122 Zhenhua RD., Futian, Shenzhen, China



4

3

2

1

D

D

C

C

B

B

A

A

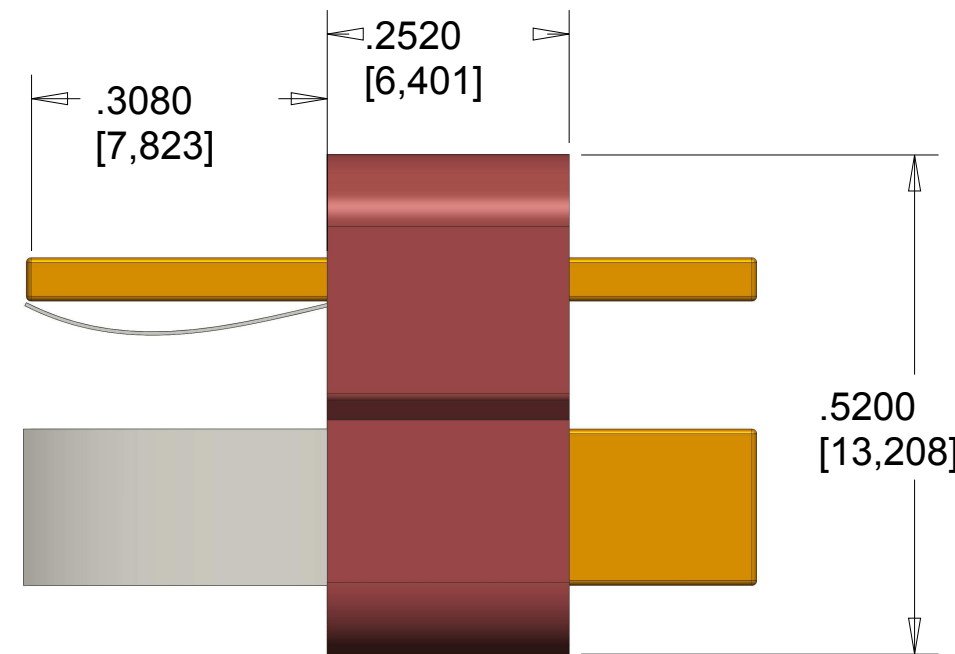
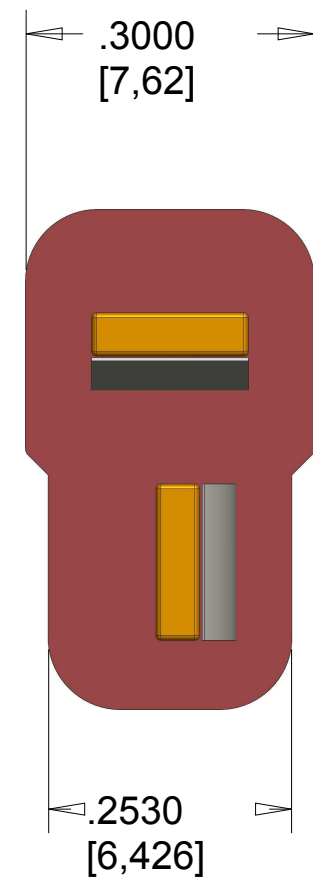

R.0750 [1,905] (all)

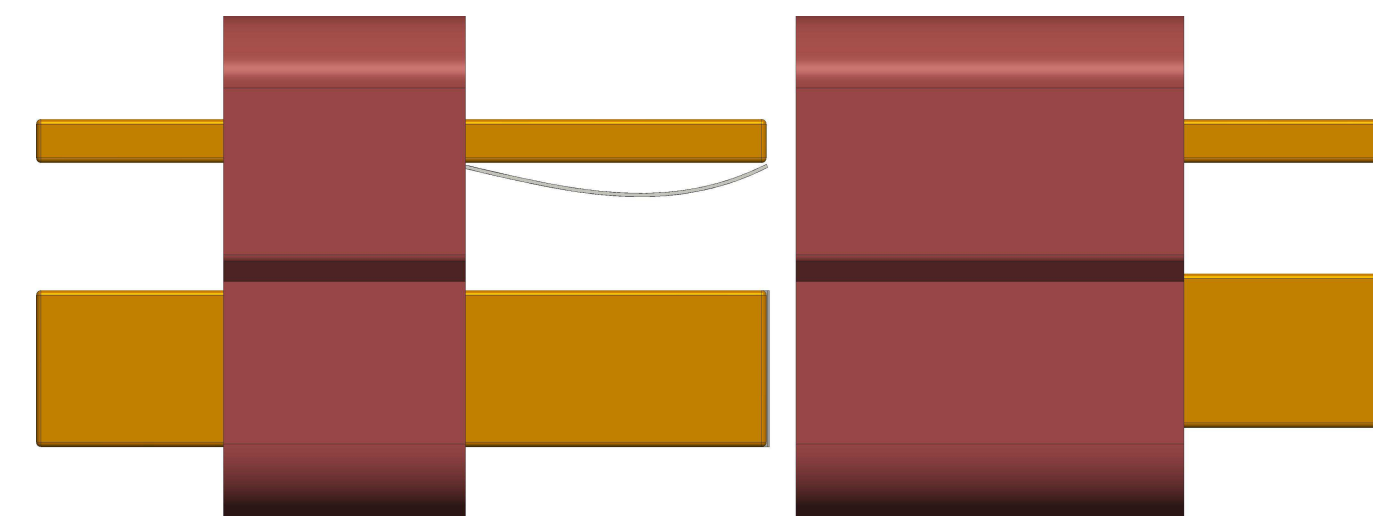
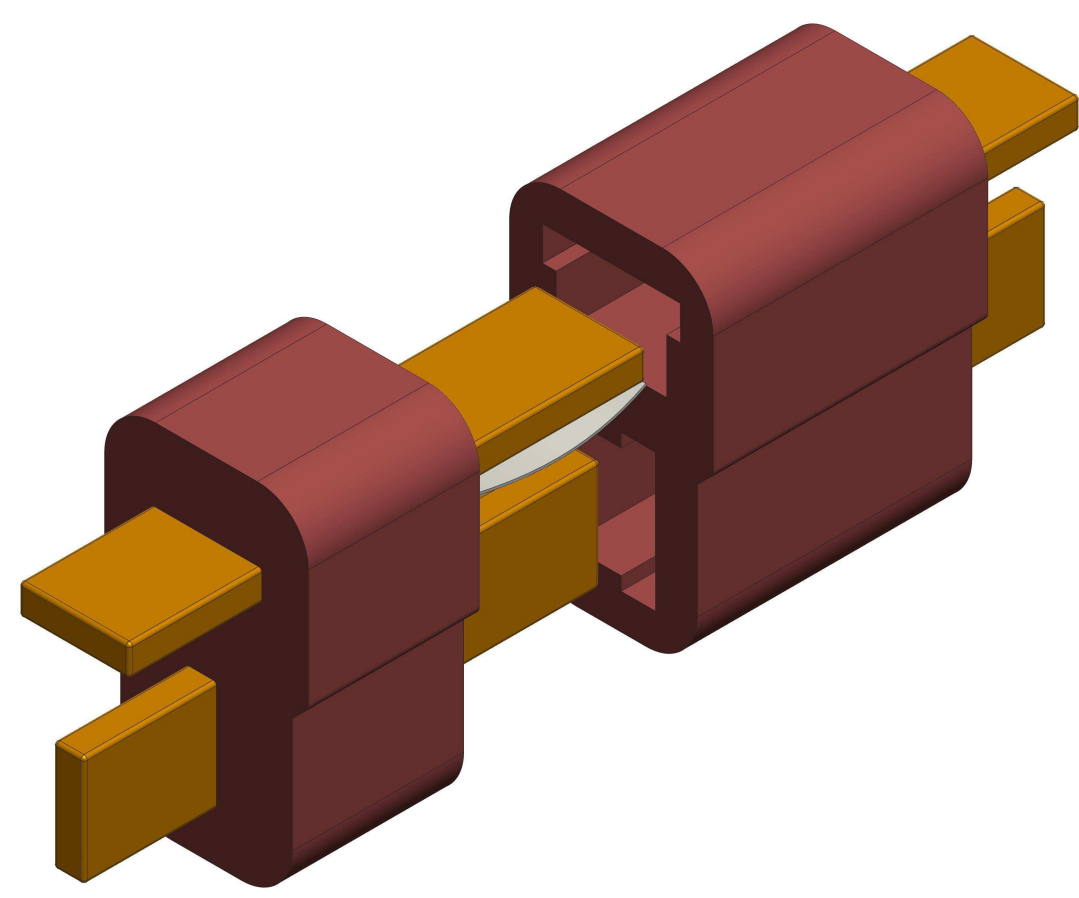
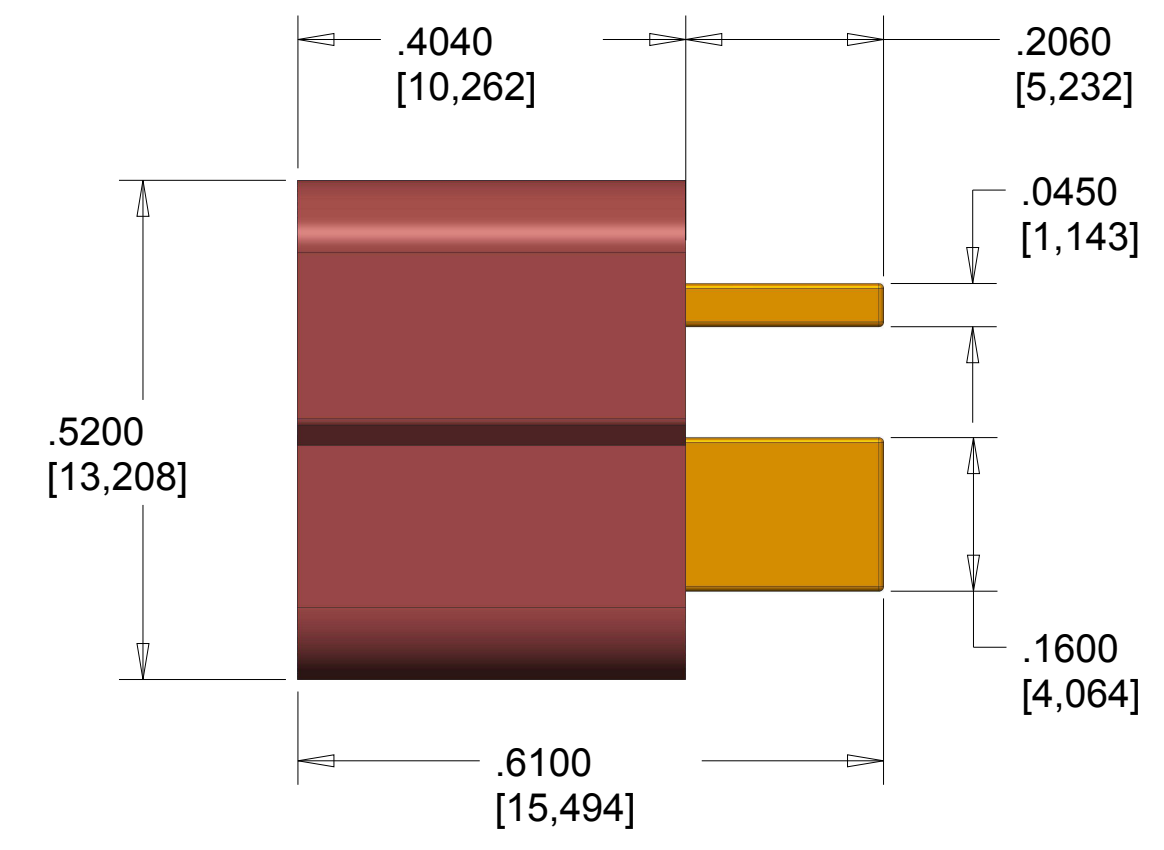
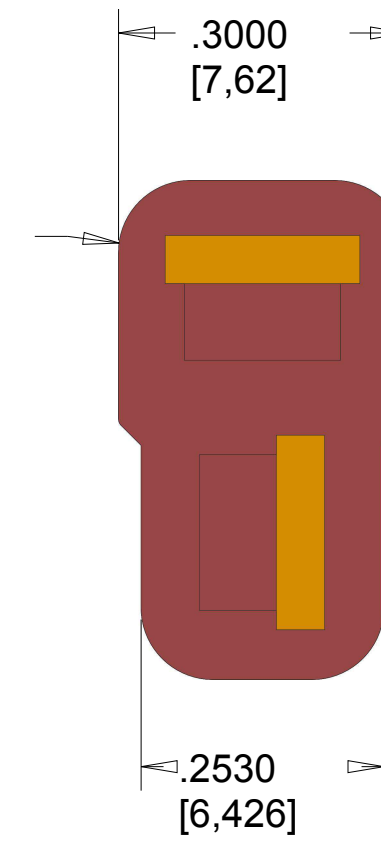

<p>Do you have an R/C vehicle battery pack that desperately needs a Deans connector? With our new M/F Deans connector pair, you'll have just what you need to safely and securely connect your battery or anything else that requires a mini T Plug. Each pack comes with one male and one female Deans connector and each can support a current of, up to, 30A.</p> <p>NOTES:</p>	MATERIAL:	Nylon + Metal		MODEL NAME:	Deans Connector	
	Deans Connector - M/F Pair PRT-11864			<a href="https://www.sparkfun.com/products/11864">https://www.sparkfun.com/products/11864</a>		
	DESCRIPTION:			PAGE SIZE C 22 x 17 INCH		
	DRAWN BY:	Paul Smith		SCALE:	5.00	
	DATE:	9 July 2013		UNITS:	inch [mm]	
CAD APPLICATION: Creo Parametric 2.0			VER:	1.0		



SHEET 1 / 1

4

3

2

1