



Chipsmall Limited consists of a professional team with an average of over 10 year of expertise in the distribution of electronic components. Based in Hongkong, we have already established firm and mutual-benefit business relationships with customers from,Europe,America and south Asia,supplying obsolete and hard-to-find components to meet their specific needs.

With the principle of “Quality Parts,Customers Priority,Honest Operation,and Considerate Service”,our business mainly focus on the distribution of electronic components. Line cards we deal with include Microchip,ALPS,ROHM,Xilinx,Pulse,ON,Everlight and Freescale. Main products comprise IC,Modules,Potentiometer,IC Socket,Relay,Connector.Our parts cover such applications as commercial,industrial, and automotives areas.

We are looking forward to setting up business relationship with you and hope to provide you with the best service and solution. Let us make a better world for our industry!



## Contact us

Tel: +86-755-8981 8866 Fax: +86-755-8427 6832

Email & Skype: info@chipsmall.com Web: www.chipsmall.com

Address: A1208, Overseas Decoration Building, #122 Zhenhua RD., Futian, Shenzhen, China



**SPECIFICATION**  
 Current Rating:3.0 Amp  
 Withstand Voltage:500V AC/DC  
 Insulator Resistance:1000 Megaohms Min.  
 Contact Resistance:20 Milliohms Max.  
 Operation Temperature:-40°C~+105°C  
 Contact:Brass,Gold Plated Over Nickel  
 ⚠ Insulator:PA6T+30%G.F(UL94V-0),Black  
 RoHS Compliant

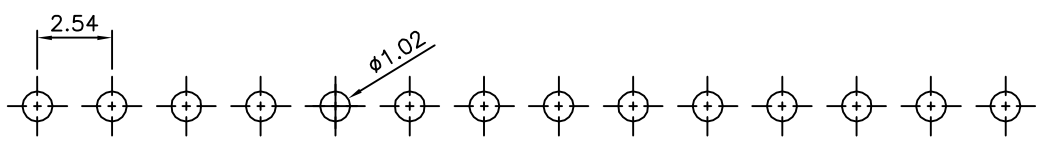

Recommended P.C.B Layout(Top Side)  
 (PCB Board Tolerance $\pm 0.05$ )

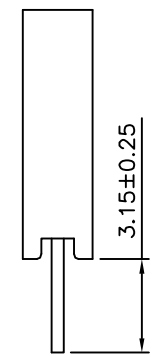
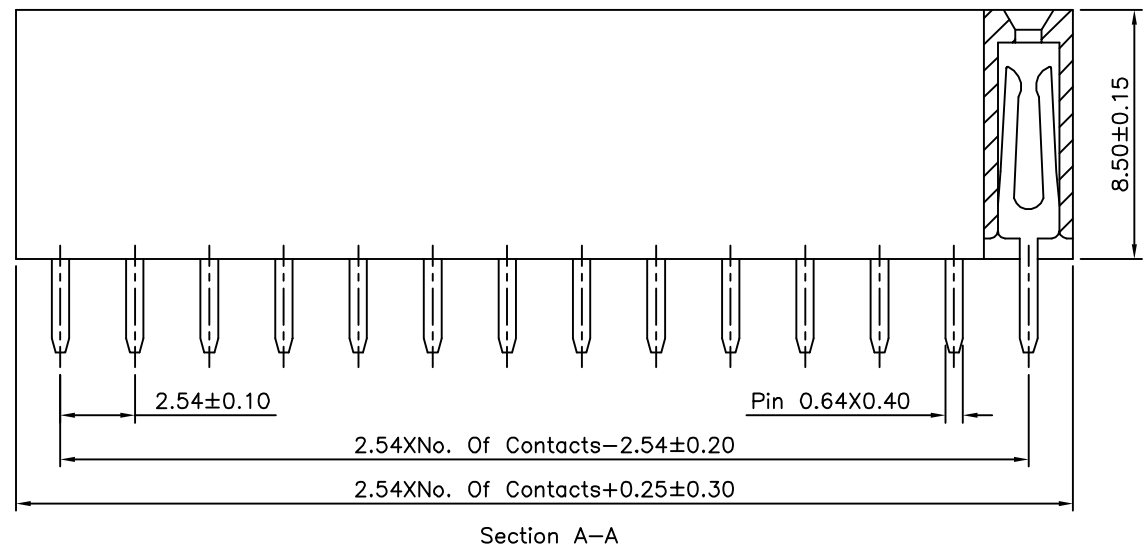
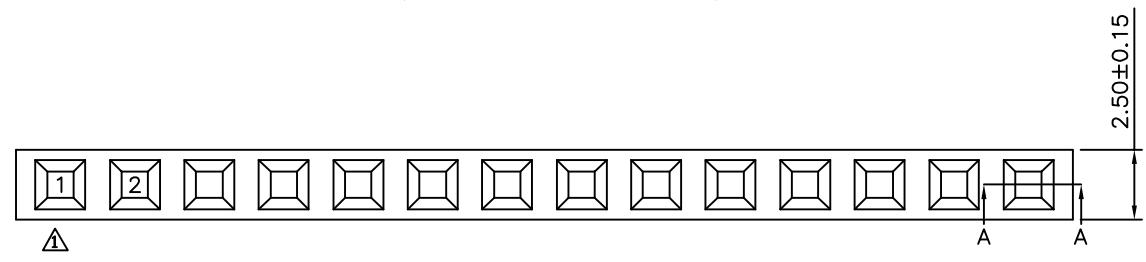

**4UCON** 元化興業股份有限公司  
 4UCON TECHNOLOGY INC.

DRAWING No.		APPROVED BY		UNLESS OTHERWISE SPECIFIED TOLERANCES ARE .X $\pm 0.40$ .XX $\pm 0.25$ .XXX $\pm 0.15$ ANG. $\pm 3^\circ$
00527		EMILY		
		CHECKED BY HZF		
		DRAWING BY SONG		
SCALE	NONE	REV.	A1	UNIT mm

NO.	REV.	REVISIONS	CHK	DATE
⚠ A1		Modify Data	HZF	07/28/2011
⚠ A0		NEW RELEASE	HZF	09/05/2008