



Chipsmall Limited consists of a professional team with an average of over 10 year of expertise in the distribution of electronic components. Based in Hongkong, we have already established firm and mutual-benefit business relationships with customers from,Europe,America and south Asia,supplying obsolete and hard-to-find components to meet their specific needs.

With the principle of “Quality Parts,Customers Priority,Honest Operation,and Considerate Service”,our business mainly focus on the distribution of electronic components. Line cards we deal with include Microchip,ALPS,ROHM,Xilinx,Pulse,ON,Everlight and Freescale. Main products comprise IC,Modules,Potentiometer,IC Socket,Relay,Connector.Our parts cover such applications as commercial,industrial, and automotives areas.

We are looking forward to setting up business relationship with you and hope to provide you with the best service and solution. Let us make a better world for our industry!



Contact us

Tel: +86-755-8981 8866 Fax: +86-755-8427 6832

Email & Skype: info@chipsmall.com Web: www.chipsmall.com

Address: A1208, Overseas Decoration Building, #122 Zhenhua RD., Futian, Shenzhen, China





**15W Universal Input, Compact PCB, 3.3 to 24V DC
PSA15LN3 Single Output OEM Open Frame**

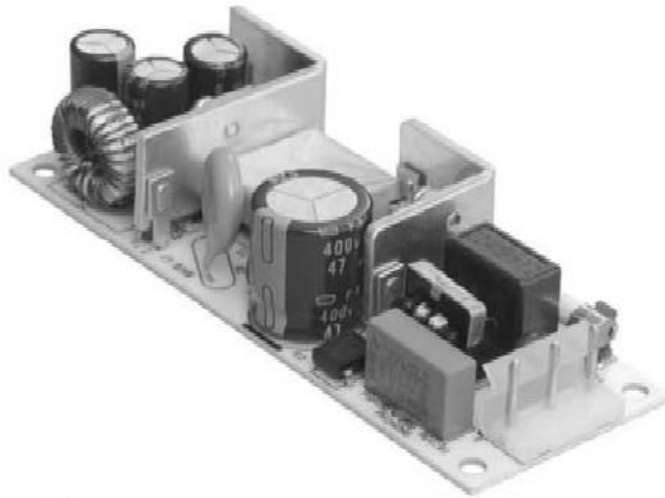

Features

- Compact 1.57 x 4.33 PCB
- Cispr 22B; FCC B EMI
- Low 1 Inch Profile
- +/-5% Voltage Adjustment

Applications

- Networking
- Compact Equipment
- Peripherals and Terminals
- Microcomputers

Safety Approvals

- cUL 1950
- CE Low Voltage Directive
- TUV EN60950

Mechanical Characteristics

- Length: 110mm (4.33in)
- Width: 40mm (1.57in)
- Height: 25.4mm (1.00in)
- Weight: 100g (3.5oz)

Output Specifications

Model (3 Wire Version)	DC Output Voltage	Load		Ripple* P-P (max.)	Regulation		Max Power
		Min.	Max.		Line	Load	
PSA15LN3-033**	3.3V	0A	3.0A	50mV	±1%	±3%	10W
PSA15LN3-050	5.0V	0A	3.0A	50mV	±1%	±2%	15W
PSA15LN3-090**	9.0V	0A	1.67A	90mV	±1%	±2%	15W
PSA15LN3-120	12V	0A	1.25A	120mV	±1%	±2%	15W
PSA15LN3-150**	15V	0A	1.00A	150mV	±1%	±2%	15W
PSA15LN3-180**	18V	0A	0.83A	180mV	±1%	±2%	15W
PSA15L3-240	24V	0A	0.63A	240mV	±1%	±2%	15W

*Measured at maximum load by using a 12-inch twisted pair, terminated with a 10mfd capacitor and 0.1mfd ceramic in parallel.

**Special Order Items. Minimum order of 1000 pieces required. Please contact Phihong USA Sales for more information.

Phihong is not responsible for any error, and reserves the right to make changes without notice. Please visit our website at www.phihong.com for the most up-to-date specifications and contact information.

Input:**AC Input Voltage Rating**

100 to 240V AC

AC Input Voltage Range

90 to 264V AC

AC Input Frequency

47 to 63Hz

Input Current

0.5A (RMS) at 120V AC

0.25A (RMS) at 240V AC

Leakage Current

0.75mA minimum at 264V AC

Inrush Current

30A maximum at 120V AC

60A maximum at 240V AC

Hold-up Time

16mS minimum at maximum load and 115V AC

Output:**Efficiency**

65% minimum at full load, 115V AC

Over-Voltage Protection

Zener Diode Clamping

Over-Current Protection

Auto Restart

Short-Circuit Protection

Output can be shorted permanently without damage

Environmental:**Temperature**

Operation 0 to 50°C

Non-operation -35 to +85°C

Humidity

10 to 90% non-condensing

Emissions

FCC Class B

EN55022 Class B

Immunity

EN50082-1: 1997

EN61000-4-2 Level 3

EN61000-4-3 Level 2

EN61000-4-4 Level 2

EN61000-4-5 Level 3

General:**Insulation Resistance**

Input to Output: 500V DC 10M Ohm minimum

Dielectric Withstand (Hi-pot) Test

Input to Output: 3000V AC for 1 min., 10mA

Input to Ground: 1500V AC for 1 min., 10mA

Switching Frequency

100 KHz (nominal)

MTBF (Full load and 110V AC, 25°C)

150K Hrs

MIL -HDBK-217F

AC Input Connector (Molex or Equivalent)

09-65-2058 (Pins 2, 4 omitted)

Mates with: 09-50-7051

Crimp Pin: 08-52-0072

DC Output Connector

Molex 09-65-2028

Mates with: 09-50-7021

Crimp Pin: 08-52-0072

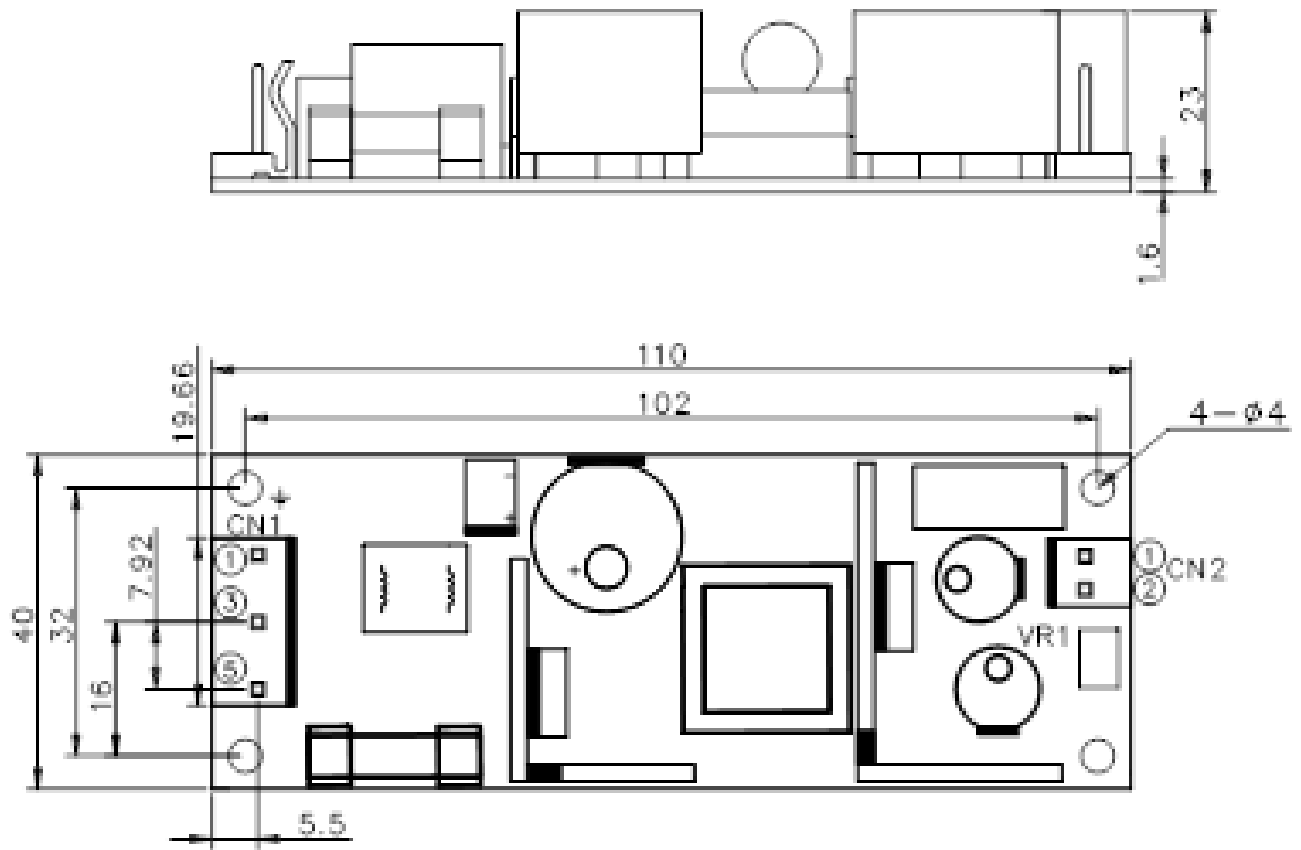

	PIN NO	DESCRIPTION
CN2	PIN-1	+Vout
	PIN-2	RTN
CN1	PIN-1	GROUND
	PIN-3	N
	PIN-5	L