



Chipsmall Limited consists of a professional team with an average of over 10 year of expertise in the distribution of electronic components. Based in Hongkong, we have already established firm and mutual-benefit business relationships with customers from,Europe,America and south Asia,supplying obsolete and hard-to-find components to meet their specific needs.

With the principle of “Quality Parts,Customers Priority,Honest Operation,and Considerate Service”,our business mainly focus on the distribution of electronic components. Line cards we deal with include Microchip,ALPS,ROHM,Xilinx,Pulse,ON,Everlight and Freescale. Main products comprise IC,Modules,Potentiometer,IC Socket,Relay,Connector.Our parts cover such applications as commercial,industrial, and automotives areas.

We are looking forward to setting up business relationship with you and hope to provide you with the best service and solution. Let us make a better world for our industry!



Contact us

Tel: +86-755-8981 8866 Fax: +86-755-8427 6832

Email & Skype: info@chipsmall.com Web: www.chipsmall.com

Address: A1208, Overseas Decoration Building, #122 Zhenhua RD., Futian, Shenzhen, China



THIS COPY IS PROVIDED ON A RESTRICTED BASIS AND IS NOT TO BE USED IN ANY WAY DETRIMENTAL TO THE INTERESTS OF PANDUIT CORPORATION.

PANDUIT PART NUMBER	USED WITH CABLE TIES	DIMENSIONS					MATERIAL	WEIGHT grams/100pcs
		'A' (REF)	'B' (REF)	'C' (REF)	'D' (REF)	'D' (REF)		
PUM-100--30	M, 1, S	16.2	6.6	16.9	10.4	HEAT STABILIZED NYLON 6/6 BLACK	70.07	

NOTES:

1. SEE CURRENT PRICE SHEET FOR PART NUMBER SUFFIX DESIGNATION FOR PACKAGE SIZE, AND COLOR.

2. (*) DIMENSIONAL VARIANCE IS POSSIBLE DUE TO MOLDING PROCESS RELATED SINK MARKS.

3. APPLICATION SPECIFICATION:
HOLE DIAMETER: 9.0 - 10.0 mm
PANEL THICKNESS: 0.8 - 7.0 mm

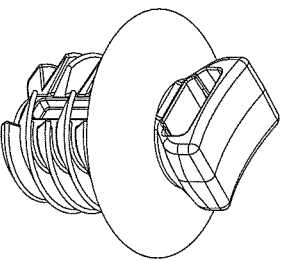
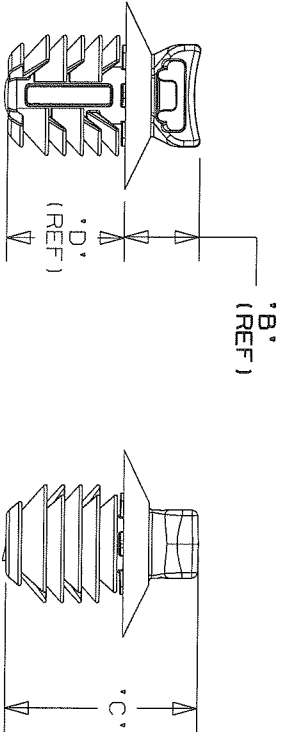

SCALE 2:1

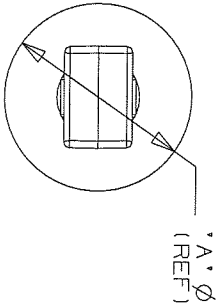

REV	DATE	BY	CHK	DESCRIPTION	ECN	R	R	CUST	SUP
06B	9-26-08	PSG	KLW	ADDED, REMOVED, & RENAMED DIMENSIONS	GB0239MM		06B	KLW	
06A	8-22-08	PSG		REMOVED 2 DIMS, REMOVED RIBS FROM HEAD, UPDATED FILE NAME AND CHANGED REV STYLE	GB0239MM		06A		
R	8-24-06	TMSA		INITIAL RELEASE	GB0239MM	R			

CAD FILENAME/LAYERS
 G03151BD_DC_GB0239MM/06B
PANDUIT
 CORP.
 TINLEY PARK, ILLINOIS
 PUM-100--30
 PUSH UMBRELLA MOUNT 100
 UNLESS OTHERWISE SPECIFIED, ALL DIMENSIONS ARE METRIC
 TOLERANCE: ±0.5MM
 DRAWN BY TMSA
 DATE 8-24-06
 CHK'D KLW
 MAT'L: SEE TABLE
 SCALE 1:1 UNLESS NOTED
 DRAWING NO. GB0239MM
 DWG SIZE A