



Chipsmall Limited consists of a professional team with an average of over 10 year of expertise in the distribution of electronic components. Based in Hongkong, we have already established firm and mutual-benefit business relationships with customers from,Europe,America and south Asia,supplying obsolete and hard-to-find components to meet their specific needs.

With the principle of “Quality Parts,Customers Priority,Honest Operation,and Considerate Service”,our business mainly focus on the distribution of electronic components. Line cards we deal with include Microchip,ALPS,ROHM,Xilinx,Pulse,ON,Everlight and Freescale. Main products comprise IC,Modules,Potentiometer,IC Socket,Relay,Connector.Our parts cover such applications as commercial,industrial, and automotives areas.

We are looking forward to setting up business relationship with you and hope to provide you with the best service and solution. Let us make a better world for our industry!



## Contact us

Tel: +86-755-8981 8866 Fax: +86-755-8427 6832

Email & Skype: [info@chipsmall.com](mailto:info@chipsmall.com) Web: [www.chipsmall.com](http://www.chipsmall.com)

Address: A1208, Overseas Decoration Building, #122 Zhenhua RD., Futian, Shenzhen, China



# PV1 SERIES ANTI-VANDAL SWITCH

ANTI-VANDAL SWITCHES  
DETECTOR SWITCHES  
DIP SWITCHES  
KEYLOCK SWITCHES  
NAVIGATION SWITCHES  
PUSHBUTTON SWITCHES  
ROCKER SWITCHES  
ROTARY SWITCHES  
SLIDE SWITCHES  
SNAP ACTION SWITCHES  
TACTILE SWITCHES  
TOGGLE SWITCHES  
CAP OPTIONS



## APPLICATIONS / MARKETS

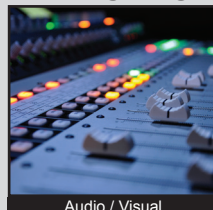

Audio / Visual



Security Devices



Industrial Controls

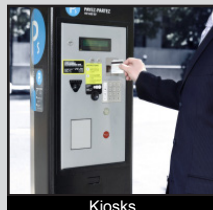

Kiosks



Electrical Housewares



Medical Equipment

# RoHS

## SPECIFICATIONS

**Electrical Rating:** 2A, 36VDC  
**Mechanical Life:** 1,000,000 Cycles  
**Electrical Life:** 200,000 Cycles  
**Contact Resistance:** 50mΩ Max.  
**Insulation Resistance:** 1000 MΩ Min.  
**Dielectric Strength:** 2,000VAC  
**Operating/Storage Temperature:** -20°C to 55°C  
**Travel:** 2.50mm  
**Moisture Protection:** IP65  
**Contact Arrangement:** SPST Off-(On)  
**Actuation Force:** 4 N  
**Panel Thickness:** 1-8mm  
**Mounting Nut Torque:** 0.8Nm

## FEATURES & BENEFITS

- 19mm panel cutout
- Solder or screw termination options
- Flat, high or domed actuator options
- IP65 rated

## PART NUMBER CONFIGURATOR

Series	Actuator Options	Terminal Options	Function Options	Rating Options	Body Finish Options	Actuator Finish Options	Contact Material Options	Marking Options
<input type="text" value="PV1"/>	<input type="text" value="F - Flat"/> F - Flat H - High S - Domed	<input type="text" value="2 - Solder"/> 2 - Solder 6 - Screw	<input type="text" value="4 - Off - (On)*"/> 4 - Off - (On)*	<input type="text" value="0 - 2A, 36VDC"/> 0 - 2A, 36VDC	<input type="text" value="G - Gold"/> G - Gold N - Nickel S - Polished Stainless B - Brushed Stainless 1 - Black Anodized	<input type="text" value="G - Gold"/> G - Gold N - Nickel S - Polished Stainless B - Brushed Stainless 1 - Black Anodized	<input type="text" value="NONE - Silver"/> NONE - Silver G - Gold	<input type="text" value="NONE - Non-Illuminated"/> NONE - Non-Illuminated M01 - Power Symbol

### NOTES:

\*(ON) Denotes function is momentary

Specifications subject to change without notice



**E-SWITCH®**

www.e-switch.com

800.867.2717

2

<b>ANTI-VANDAL SWITCHES</b>	<b>DETECTOR SWITCHES</b>	<b>DIP SWITCHES</b>	<b>KEYLOCK SWITCHES</b>	<b>NAVIGATION SWITCHES</b>	<b>PUSHBUTTON SWITCHES</b>	<b>ROCKER SWITCHES</b>	<b>ROTARY SWITCHES</b>	<b>SLIDE SWITCHES</b>	<b>SNAP ACTION SWITCHES</b>	<b>TACTILE SWITCHES</b>	<b>TOGGLE SWITCHES</b>	<b>CAP OPTIONS</b>
-----------------------------	--------------------------	---------------------	-------------------------	----------------------------	----------------------------	------------------------	------------------------	-----------------------	-----------------------------	-------------------------	------------------------	--------------------

**Technical Drawing of the SPST Switch Assembly:**

**Isometric View:** Shows the assembled switch with a white circular panel, a grey threaded body, and a blue base with a silver terminal.

**Top View:** Shows the circular panel with a diameter of  $\varnothing 22.00$  [.866 in] and a central mounting hole with a diameter of  $\varnothing 14.90$  [.587 in].

**Side View (Left):** Shows the overall height of the assembly as 24.00 [.945 in]. The mounting hole is located 1.15 [.045 in] from the bottom of the panel. The distance between the two mounting holes is 2.80 [.110 in]. The distance from the top of the panel to the center of the mounting hole is 2.65 [.104 in].

**Side View (Right):** Shows the dimensions of the mounting holes. The distance from the top of the panel to the center of the mounting hole is 2.65 [.104 in]. The distance between the two mounting holes is 2.80 [.110 in]. The distance from the bottom of the panel to the center of the mounting hole is 1.15 [.045 in].

**Panel Cutout:** Shows the required cutout diameter for the panel, which is  $\varnothing 19.00^{+.20}_{-.00}$  [.748 $^{+.008}_{-.000}$  in].

**SPST Schematic:** Shows the switch symbol with terminals labeled 1 and 2.

**3D Perspective View:** Shows the cylindrical component with a white top cap and a blue base. The top cap has a diameter of  $\phi 19.00^{+0.20}_{-0.00}$  [0.748<sup>+0.008</sup><sub>-0.000</sub> in].

**Top View:** Shows the circular top cap with a diameter of  $\phi 22.00$  [.866 in]. The inner ring has a diameter of  $\phi 14.90$  [.587 in].

**Side View:** Shows the component's profile. The total height is 24.00 [.945 in]. The base has a diameter of  $\phi 2.50$  [.098 in]. The top cap has a height of 18.0 [.71 in]. The base has a height of 9.00 [.354 in]. The base has two mounting holes, labeled 1 and 2, with a center-to-center distance of 19.9 $\pm$ 1.0 [.781 $\pm$ .039 in]. The base has an M19 x 1.0 THREAD.

**Panel Cutout:** Shows the circular cutout for the component. The diameter is  $\phi 19.00^{+0.20}_{-0.00}$  [0.748<sup>+0.008</sup><sub>-0.000</sub> in].

**SPST SCHEMATIC:** Shows the component symbol, which is a circle with a vertical line through the center, labeled 10 O 2.

ACTUATOR OPTIONS

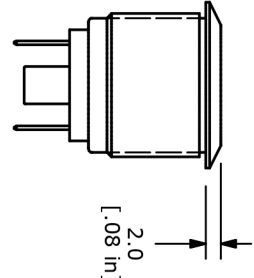
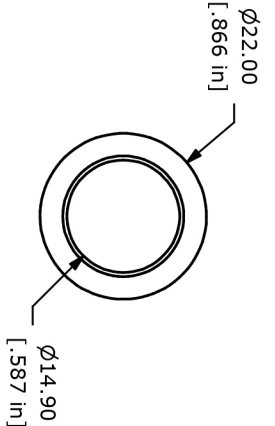

FLAT ACTUATOR

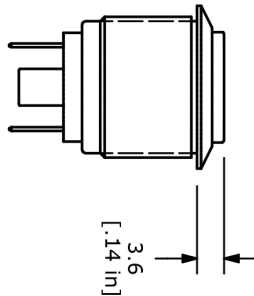
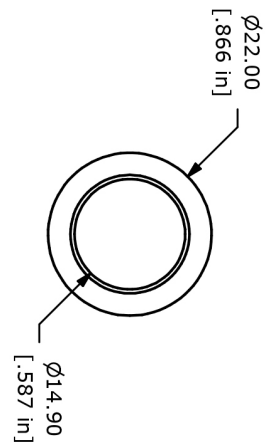

HIGH ACTUATOR

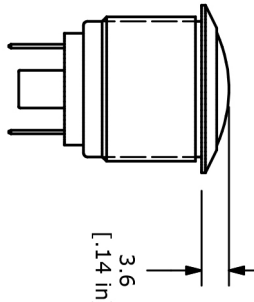
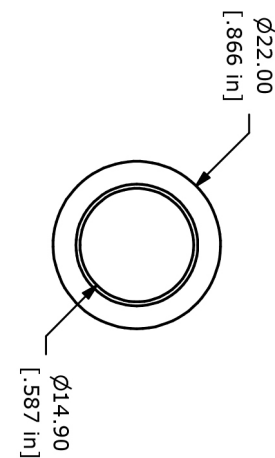

DOMED ACTUATOR

GRAPHIC OPTIONS

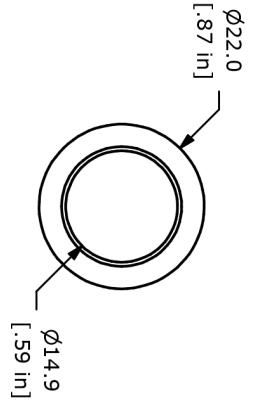

NONE

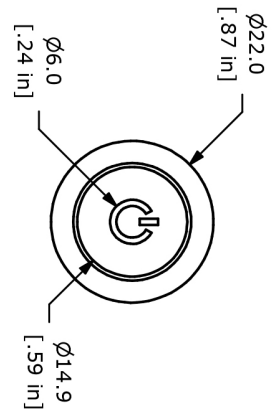

M01 POWER SYMBOL