



Chipsmall Limited consists of a professional team with an average of over 10 year of expertise in the distribution of electronic components. Based in Hongkong, we have already established firm and mutual-benefit business relationships with customers from,Europe,America and south Asia,supplying obsolete and hard-to-find components to meet their specific needs.

With the principle of “Quality Parts,Customers Priority,Honest Operation,and Considerate Service”,our business mainly focus on the distribution of electronic components. Line cards we deal with include Microchip,ALPS,ROHM,Xilinx,Pulse,ON,Everlight and Freescale. Main products comprise IC,Modules,Potentiometer,IC Socket,Relay,Connector.Our parts cover such applications as commercial,industrial, and automotives areas.

We are looking forward to setting up business relationship with you and hope to provide you with the best service and solution. Let us make a better world for our industry!



## Contact us

Tel: +86-755-8981 8866 Fax: +86-755-8427 6832

Email & Skype: info@chipsmall.com Web: www.chipsmall.com

Address: A1208, Overseas Decoration Building, #122 Zhenhua RD., Futian, Shenzhen, China



# PVA

## Short Stroke Key Switches

### Features/Benefits

- Compact design
- Short stroke to latch
- Wide variety of actuator heights and styles
- Adapted for medium power applications
- RoHS compliant and compatible

### Typical Applications

- Automotive (air conditioning, lighting)
- Video, remote controls
- Electronic games



### Construction

FUNCTION: Momentary, Push-Push  
 CONTACT ARRANGEMENT:<sup>1</sup>  
 PVA1: 2 make contacts (DPST)  
 PVA2: 2 change over contacts (DPDT)  
 SWITCHING MODE: Non-shorting  
 TERMINALS: PC pins<sup>2</sup>

### Mechanical

TOTAL TRAVEL / LATCHING TRAVEL:  
 OA: 2,4± 0,2 (0.094 ± 0.008)  
 EE: 2,4± 0,2 (0.094 ± 0.008) / 1,5 (0.059)  
 OPERATING FORCE: 1.2 ± .25 (120 grams);  
 1.7 ± .25 (170 grams); 3.5 ± .25 (350 grams)

### Process

SOLDERABILITY:  
 Wave soldering, compatible with lead free soldering profile  
 Hand soldering, 350°C for 3 seconds

**Note:** Specifications listed above are for switches with standard options.  
 For information on specific and custom switches, consult Customer Service Center.

### Electrical

SWITCHING POWER MAX.: 3 W DC  
 SWITCHING VOLTAGE MAX.: 32 V DC  
 SWITCHING CURRENT MAX.: 100 mA DC\*  
 DIELECTRIC STRENGTH (50 Hz / 1 min):  
 1000 V between open contacts, PVA2: 750 V  
 OPERATING LIFE:  
 OA (momentary): ≥ 1 x 10<sup>5</sup> operations  
 EE (push-push): ≥ 1 x 10<sup>5</sup> operations  
 CONTACT RESISTANCE: Initial ≤ 100 mΩ  
 After life: 150 mΩ  
 INSULATION RESISTANCE: ≥ 10<sup>10</sup> Ω  
 BOUNCE TIME: ≤ 3 ms

### Environmental

OPERATING TEMPERATURE: -40°C to 85°C.<sup>3</sup>

- 1) Other contact arrangements available by request
  - 2) "Snap-in" contacts on request, Version SNA with pins bent inside (standard)
  - 3) With button +70°C
- \* By 13,8 VDC, the PVA supports a peak current of 500 mA and a continuous current of 200 mA.



D

Key Switches

### How To Order

Our easy build-a-switch concept allows you to mix and match options to create the switch you need. To order, select desired option from each category and place it in the appropriate box. **Some of the configurations may not be available or could require some development.**

#### Switch

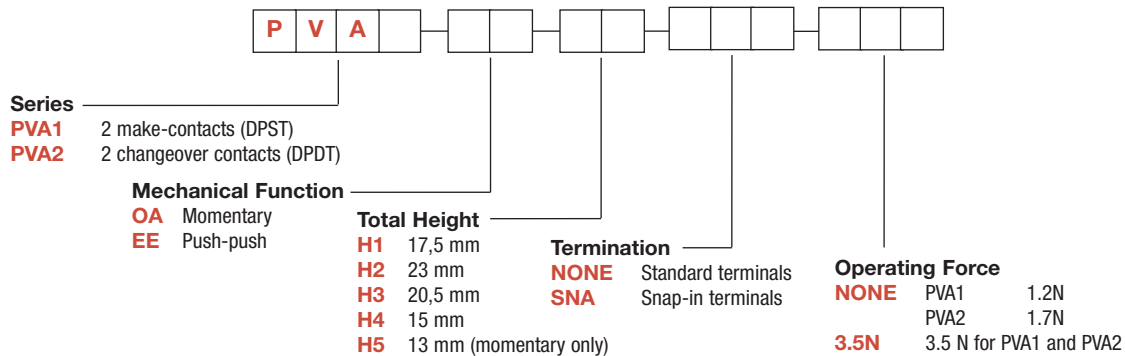

#### Button

Buttons must be ordered separately.  
 Shipped in bulk.

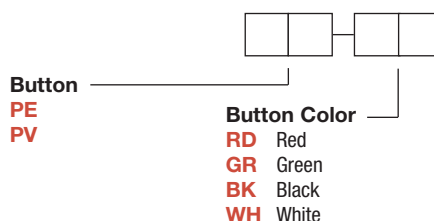

Dimensions are shown: mm  
 Specifications and dimensions subject to change

# PVA Short Stroke Key Switches

SERIES

## PVA1 (DPST)

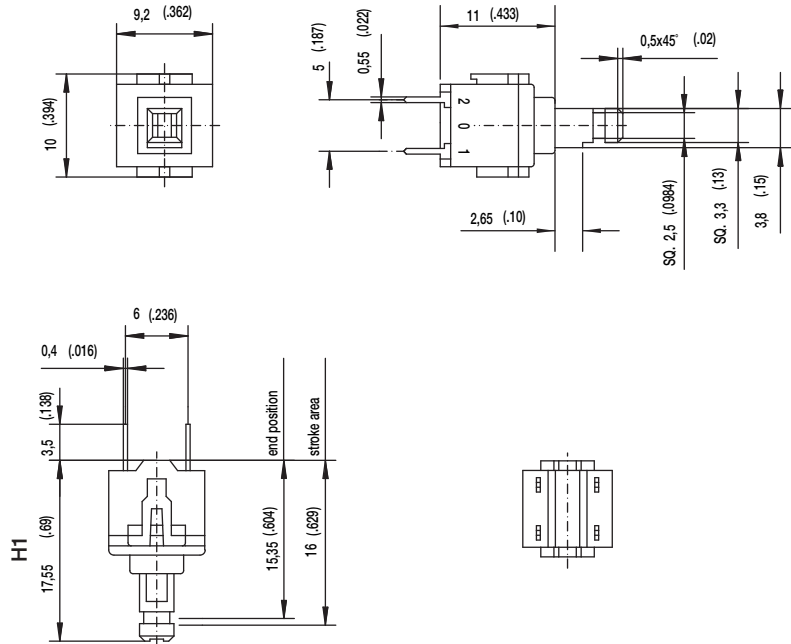
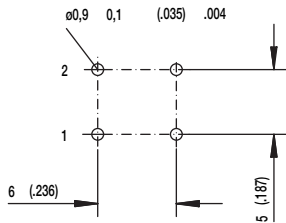

## PVA2 (DPDT)

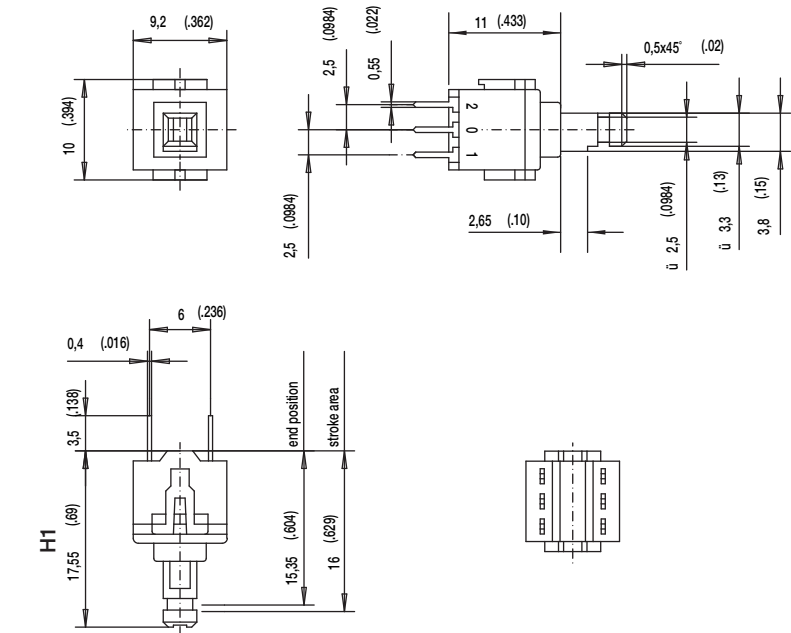
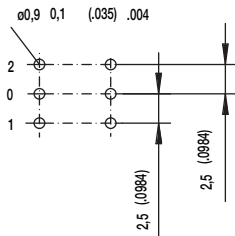

## MECHANICAL FUNCTION

OPTION CODE	FUNCTION
<b>OA</b>	Momentary
<b>EE</b>	Push-Push

**OA**

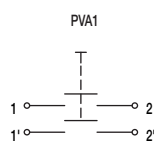

**PVA2**

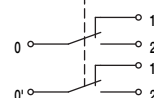

**EE**

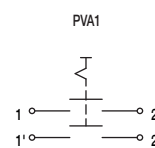

**PVA2**

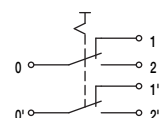

First Angle Projection

Dimensions are shown: mm  
Specifications and dimensions subject to change



# PVA Short Stroke Key Switches

## TOTAL HEIGHT

**H1** 17,5 MM

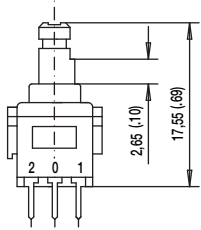

**H2** 23 MM

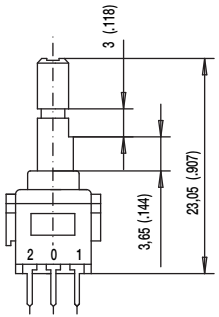

**H3** 20,5 MM

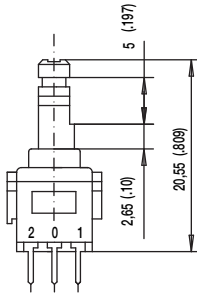

**H4** 15 MM

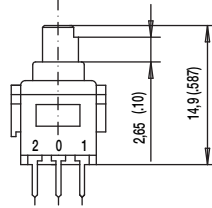

**H5** 13 MM  
(MOMENTARY ONLY)

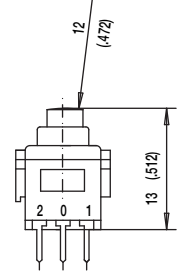

## TERMINATION

**SNA**

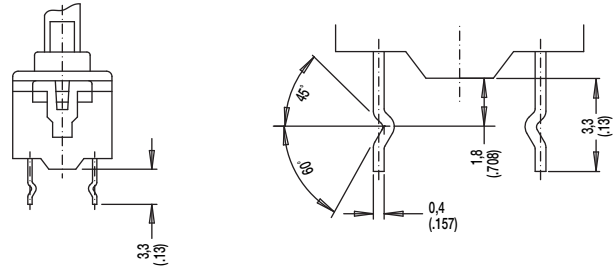

## OPERATING FORCE

**NONE** PVA1 1.2 N  
PVA2 1.7 N

**3.5N** 3.5 NEWTONS PVA1 & PVA2



D

Key Switches

## BUTTONS

BUTTONS MUST BE ORDERED SEPARATELY. SHIPPED IN BULK.

**PE**

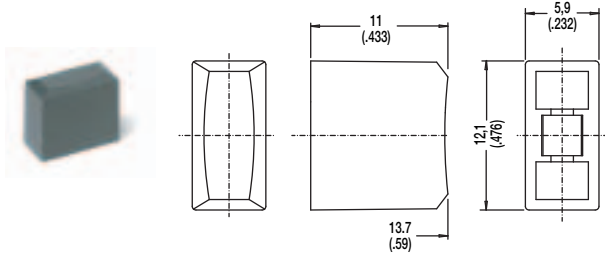

**PV**

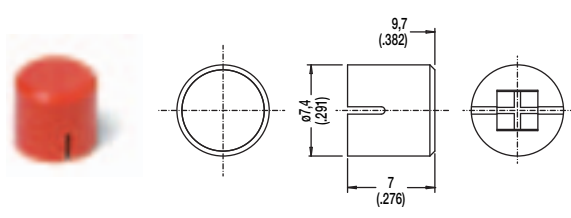

OPTION CODE	COLOR
<b>RD</b>	Red
<b>GY</b>	Gray
<b>BK</b>	Black
<b>WH</b>	White



Dimensions are shown: mm  
Specifications and dimensions subject to change

