



Chipsmall Limited consists of a professional team with an average of over 10 year of expertise in the distribution of electronic components. Based in Hongkong, we have already established firm and mutual-benefit business relationships with customers from,Europe,America and south Asia,supplying obsolete and hard-to-find components to meet their specific needs.

With the principle of “Quality Parts,Customers Priority,Honest Operation,and Considerate Service”,our business mainly focus on the distribution of electronic components. Line cards we deal with include Microchip,ALPS,ROHM,Xilinx,Pulse,ON,Everlight and Freescale. Main products comprise IC,Modules,Potentiometer,IC Socket,Relay,Connector.Our parts cover such applications as commercial,industrial, and automotives areas.

We are looking forward to setting up business relationship with you and hope to provide you with the best service and solution. Let us make a better world for our industry!



## Contact us

Tel: +86-755-8981 8866 Fax: +86-755-8427 6832

Email & Skype: [info@chipsmall.com](mailto:info@chipsmall.com) Web: [www.chipsmall.com](http://www.chipsmall.com)

Address: A1208, Overseas Decoration Building, #122 Zhenhua RD., Futian, Shenzhen, China



# PVT4 SERIES ANTI-VANDAL SWITCH

ANTI-VANDAL SWITCHES  
DETECTOR SWITCHES  
DIP SWITCHES  
KEYLOCK SWITCHES  
NAVIGATION SWITCHES  
PUSHBUTTON SWITCHES  
ROCKER SWITCHES  
ROTARY SWITCHES  
SLIDE SWITCHES  
SNAP ACTION SWITCHES  
TACTILE SWITCHES  
TOGGLE SWITCHES  
CAP OPTIONS



## APPLICATIONS / MARKETS



Consumer Electronics



Security Devices

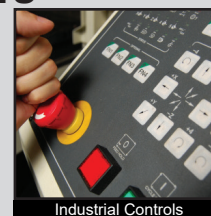

Industrial Controls



Kiosks



Electrical Housewares



Medical Equipment

**RoHS**

## SPECIFICATIONS

**Electrical Rating:** 50mA, 24VDC  
**Electrical Life:** 500,000 Cycles  
**Contact Resistance:** 50mΩ Max.  
**Insulation Resistance:** 1000 MΩ Min.  
**Dielectric Strength:** 250VAC  
**Operating/Storage Temperature:** -25°C to 55°C  
**Travel:** 0.5mm  
**Moisture Protection:** IP65  
**Contact Arrangement:** SPST Off-(On)  
**Actuation Force:** 490 grams  
**Panel Thickness:** 1-6mm  
**Mounting Nut Torque:** 0.8Nm

## FEATURES & BENEFITS

- 19mm panel cutout
- Solder or wire lead termination options
- Ring illumination
- LED color options
- Crisp tactile response
- IP65 rated

## PART NUMBER CONFIGURATOR

| Series                            | Actuator Options                      | Terminal Options                                                                     | Function Options                             | Housing Options                                      | Button Finish                                        | Lens Style                                         | LED Color                                                                                                                                 | LED Voltage Options                                                                                |
|-----------------------------------|---------------------------------------|--------------------------------------------------------------------------------------|----------------------------------------------|------------------------------------------------------|------------------------------------------------------|----------------------------------------------------|-------------------------------------------------------------------------------------------------------------------------------------------|----------------------------------------------------------------------------------------------------|
| <input type="text" value="PVT4"/> | <input type="text" value="F - Flat"/> | <input type="text" value="S - Solder Lug&lt;br/&gt;W - Wire leads&lt;br/&gt;300mm"/> | <input type="text" value="4 - Off - (On)*"/> | <input type="text" value="S - Stainless Stainless"/> | <input type="text" value="S - Stainless Stainless"/> | <input type="text" value="3 - Ring Illumination"/> | <input type="text" value="0 - White&lt;br/&gt;1 - Red&lt;br/&gt;2 - Orange&lt;br/&gt;3 - Green&lt;br/&gt;4 - Blue&lt;br/&gt;5 - Yellow"/> | <input type="text" value="1 - Base Voltage&lt;br/&gt;3 - 6V&lt;br/&gt;4 - 12V&lt;br/&gt;5 - 24V"/> |

**NOTES:**  
 \*(ON) Denotes function is momentary

Specifications subject to change without notice 6.5.2018



**E-SWITCH®**

www.e-switch.com

800.867.2717

1

# PVT4 SERIES ANTI-VANDAL SWITCH

## SOLDERLUG TERMINATION

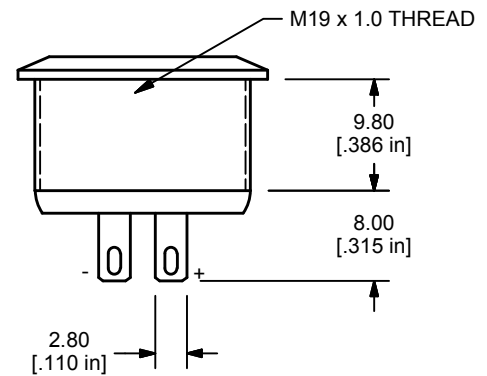
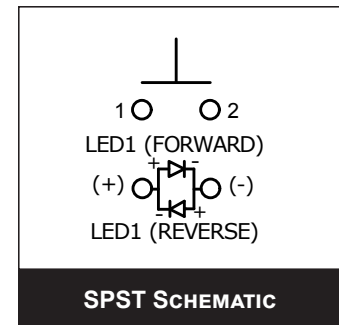
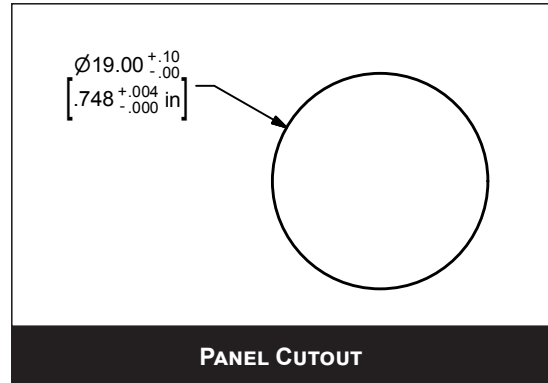
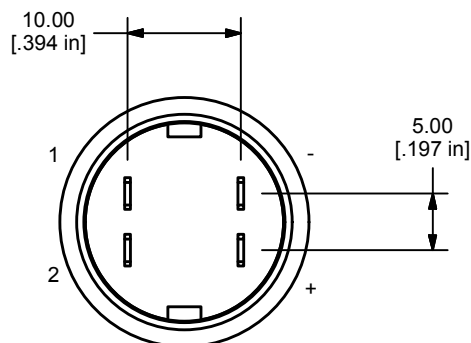
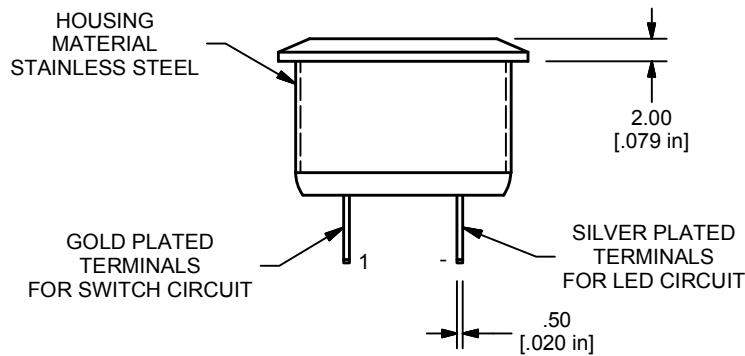
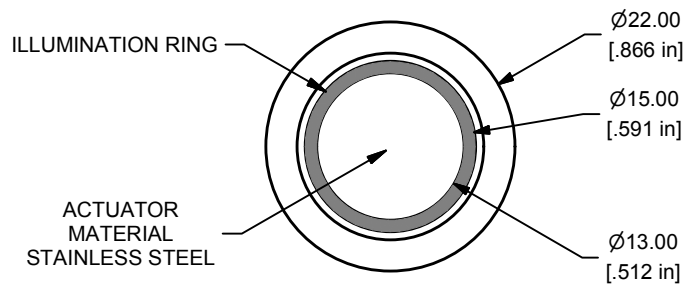



# PVT4 SERIES ANTI-VANDAL SWITCH

## WIRE LEAD TERMINATION

