



Chipsmall Limited consists of a professional team with an average of over 10 year of expertise in the distribution of electronic components. Based in Hongkong, we have already established firm and mutual-benefit business relationships with customers from,Europe,America and south Asia,supplying obsolete and hard-to-find components to meet their specific needs.

With the principle of “Quality Parts,Customers Priority,Honest Operation,and Considerate Service”,our business mainly focus on the distribution of electronic components. Line cards we deal with include Microchip,ALPS,ROHM,Xilinx,Pulse,ON,Everlight and Freescale. Main products comprise IC,Modules,Potentiometer,IC Socket,Relay,Connector.Our parts cover such applications as commercial,industrial, and automotives areas.

We are looking forward to setting up business relationship with you and hope to provide you with the best service and solution. Let us make a better world for our industry!



## Contact us

Tel: +86-755-8981 8866 Fax: +86-755-8427 6832

Email & Skype: info@chipsmall.com Web: www.chipsmall.com

Address: A1208, Overseas Decoration Building, #122 Zhenhua RD., Futian, Shenzhen, China



THIS COPY IS PROVIDED ON A RESTRICTED BASIS AND IS NOT TO BE USED IN ANY WAY DETRIMENTAL TO THE INTERESTS OF PANDUIT CORP.

PANDUIT PART NO. *	NOMINAL BUNDLE DIAMETER	MAXIMUM RECOMMENDED BUNDLE DIAMETER	DIMENSIONS			WEIGHT lbs / 100 (g) / ft.
			"A" (Ref)	"B" (Ref)	"C"	
PW38_----	0.38 (9.65)	0.43 (10.92)	0.36 (9.14)	0.125 (3.18)	0.030 (0.76)	1.68 (762.0)
PW50_----	0.50 (12.70)	0.55 (13.97)	0.47 (11.94)		0.032 (0.81)	2.01 (910.00)
PW75_----	0.75 (19.05)	0.81 (20.57)	0.72 (18.29)		0.035 (0.89)	2.87 (1301.81)
PW100_----	1.00 (25.40)	1.125 (28.58)	0.81 (20.57)		0.040 (1.02)	4.47 (2027.6)
PW150_----	1.50 (38.10)	1.625 (41.28)	1.125 (28.58)		0.042 (1.07)	7.65 (3469.9)

\* NOTES:

- SEE CURRENT PRICE SHEET FOR PART NUMBER SUFFIX DESIGNATION FOR PACKAGE SIZE. NO SPLICES ALLOWED.
- DIMENSION "A" IS STATIC INSIDE DIAMETER. DIMENSION "B" IS WIDTH OF BREAKOUT SLOTS. DIMENSION "C" IS WALL THICKNESS.
- NON FLAME RETARDANT PAN-WRAP IS OFFERED IN THE FOLLOWING COLORS:

SAMPLE PART NUMBER:

PW75F-C20

20 - NATURAL IN COLOR  
20 - BLACK

0 - 25 feet (7.62 meters)  
L - 50 feet (15.24 meters)  
C - 100 feet (30.48 meters)  
T - 200 feet (60.96 meters)  
TL - 250 feet (76.20 meters)

(REFER TO CURRENT PRODUCT OFFERING FOR OPTIONAL STANDARD PACKAGING QUANTITIES)

F - POLYETHYLENE

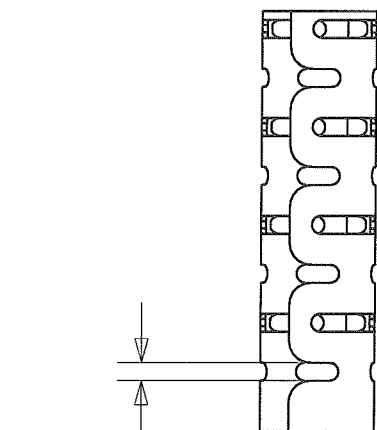

"B"

"A"  $\varnothing$

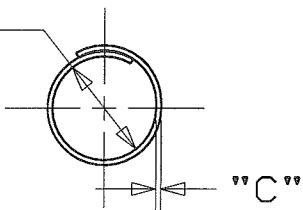

"C"

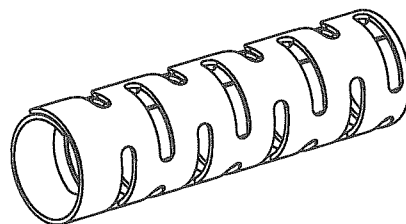

DIMENSIONS IN BRACKETS ARE METRIC [mm]

CAD FILENAME/LAYERS G03597DS\_DC\_GB2508BH/01A

**PANDUIT** CORP. TINLEY PARK, ILLINOIS

PAN-WRAP  
(PW\_\_\_F\_\_\_)

UNLESS OTHERWISE SPECIFIED,  
DIMENSIONAL TOLERANCES ARE:  
(.X)  $\pm 0.05$  (1.3) (.XXX)  $\pm 0.010$  (0.25)  
(.XX)  $\pm 0.02$  (0.5) ANGLES  $\pm 5^\circ$

UNLESS OTHERWISE SPECIFIED,  
ALL DIMENSIONS ARE GIVEN  
IN INCHES, THIRD ANGLE PROJECTION.

DRAWN BY JAD

MAT'L:

SCALE NONE

DATE 11/5/04

SEE NOTE 3

DRAWING NO.

GB2508BH

DRG  
SIZE  
A

REV	DATE	BY	CHK	DESCRIPTION	ECN	R	CUST	SUP
01A	6/17/09	JAD	SM	REVISE TO TEAMCENTER NAMING, ADDED PW38, CHANGED NOTE 3	GB2508BH	01A		