



Chipsmall Limited consists of a professional team with an average of over 10 year of expertise in the distribution of electronic components. Based in Hongkong, we have already established firm and mutual-benefit business relationships with customers from,Europe,America and south Asia,supplying obsolete and hard-to-find components to meet their specific needs.

With the principle of “Quality Parts,Customers Priority,Honest Operation,and Considerate Service”,our business mainly focus on the distribution of electronic components. Line cards we deal with include Microchip,ALPS,ROHM,Xilinx,Pulse,ON,Everlight and Freescale. Main products comprise IC,Modules,Potentiometer,IC Socket,Relay,Connector.Our parts cover such applications as commercial,industrial, and automotives areas.

We are looking forward to setting up business relationship with you and hope to provide you with the best service and solution. Let us make a better world for our industry!



Contact us

Tel: +86-755-8981 8866 Fax: +86-755-8427 6832

Email & Skype: info@chipsmall.com Web: www.chipsmall.com

Address: A1208, Overseas Decoration Building, #122 Zhenhua RD., Futian, Shenzhen, China



Power Dividers

Two Way Isolated

500 MHz - 18.0 GHz High Performance

- Full Octave, Multi-Octave, and Ultra-Wideband Performance
- Excellent Phase and Amplitude Tracking
- Small Lightweight Rugged Stripline Construction
- Meets Mil-E-5400 and Mil-E16400



Midwest Microwave's series of high performance isolated Power Dividers are small, lightweight, ruggedly constructed stripline units that possess inherently low insertion loss and VSWR with high isolation and excellent phase and amplitude tracking. Units are available in octave, multi-octave, and ultra-wideband frequency bandwidths covering the entire range of 0.5 - 18.0 GHz.

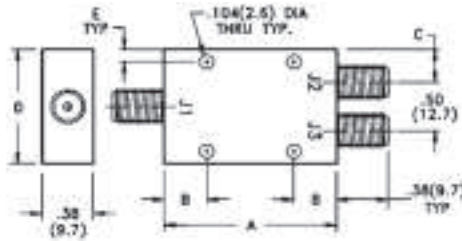

CASE STYLE 1, 2, 3 & 4

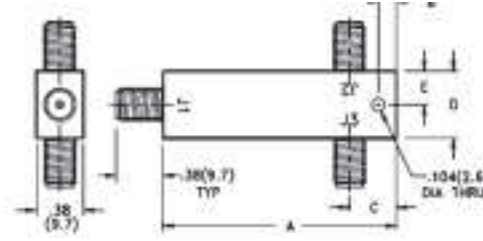

CASE STYLE 5, 6, 7, 8 & 9

ELECTRICAL SPECIFICATIONS

| FREQUENCY RANGE (GHz) | CASE STYLE | MODEL NUMBER | AMPLITUDE BALANCE (dB) | PHASE BALANCE (degrees) | INSERTION LOSS (dB) max | ISOLATION (dB) min | VSWR max | INPUT POWER max (W) | |
|-------------------------------------|------------|--------------|-------------------------------|-------------------------|-------------------------|--------------------|----------|---------------------|----|
| IN-LINE TEE** | | | OCTAVE BANDWIDTH TYPES | | | | | | |
| 1.0-2.0 | 2 | 6 | PWD-5511-02-SMA-79 | 0.2 | 2 | 0.4 | 20 | 1.25 | 3 |
| 2.0-4.0 | 2 | 7 | PWD-5512-02-SMA-79 | 0.2 | 2 | 0.4 | 20 | 1.35 | 3 |
| 4.0-8.0 | 1 | 5 | PWD-5514-02-SMA-79 | 0.2 | 3 | 0.5 | 20 | 1.35 | 3 |
| 8.0-12.4 | 1 | 5 | PWD-5515-02-SMA-79 | 0.3 | 5 | 0.5 | 20 | 1.5 | 3 |
| 12.4-18.0 | 1 | 5 | PWD-5517-02-SMA-79 | 0.3 | 5 | 0.5 | 20 | 1.5 | 3 |
| MULTI-OCTAVE BANDWIDTH TYPES | | | | | | | | | |
| .5-2.0 | 2 | 8 | PWD-5520-02-SMA-79 | 0.2 | 4 | 0.5 | 20 | 1.25 | 3 |
| 2.0-8.0 | 2 | 7 | PWD-5522-02-SMA-79 | 0.3 | 4 | 0.5 | 20 | 1.35 | 5 |
| 6.0-18.0 | 1 | 5 | PWD-5526-02-SMA-79 | 0.3 | 5 | 0.5 | 18 | 1.50 | 3 |
| 2.0-18.0 | 3 | N/A | PWD-5532-02-SMA-79 | 0.25 | 8 | 1.0 | 17 | 1.60 | 10 |
| 2.0-18.0 | 2 | 7 | PWD-5533-02-SMA-79 | 0.3 | 5 | 0.8 | 15 | 1.50 | 10 |
| 0.5-18.0 | 4 | 9 | PWD-5530-02-SMA-79 | 0.3 | 5 | 0.3+0.1f | 18 | 1.50 | 10 |

** Note: for TEE Type Case Style, substitute "T2" for "02" in Model Number

MECHANICAL SPECIFICATIONS - INCHES (mm)

| CASE STYLE | A | | B | | C | | D | | E | | WEIGHT | |
|------------|------|-------|------|------|-------|-------|-------|------|------|------|--------|----|
| | IN | MM | IN | MM | IN | MM | IN | MM | IN | MM | Oz | Gr |
| 1 | 1.00 | 25.4 | 0.50 | 12.7 | 0.250 | 6.35 | 1.00 | 25.4 | 0.08 | 1.91 | 1.00 | 27 |
| 2 | 2.00 | 50.8 | 0.50 | 12.7 | 0.250 | 6.35 | 1.00 | 25.4 | 0.08 | 1.91 | 1.60 | 44 |
| 3 | 2.25 | 57.1 | 0.50 | 12.7 | 0.250 | 6.35 | 1.00 | 25.4 | 0.08 | 1.91 | 1.70 | 46 |
| 4 | 5.50 | 139.7 | 0.75 | 19.1 | 0.250 | 6.35 | 1.00 | 25.4 | 0.20 | 5.08 | 3.50 | 96 |
| 5 | 1.00 | 25.4 | 0.50 | 12.7 | 0.22 | 5.58 | 0.050 | 12.7 | 0.08 | 1.91 | 0.60 | 16 |
| 6 | 2.00 | 50.8 | 0.50 | 12.7 | 0.22 | 5.58 | 0.070 | 17.8 | 0.08 | 1.91 | 1.20 | 33 |
| 7 | 2.00 | 50.8 | 0.50 | 12.7 | 0.22 | 5.58 | 0.050 | 12.7 | 0.08 | 1.91 | 1.10 | 30 |
| 8 | 2.00 | 50.8 | 0.50 | 12.7 | 0.22 | 5.58 | 1.00 | 25.4 | 0.08 | 1.91 | 1.40 | 38 |
| 9 | 5.50 | 139.7 | 0.75 | 19.1 | 0.40 | 10.16 | 0.050 | 12.7 | 0.08 | 1.91 | 1.80 | 49 |

Note: 1. Specifications assume that all of the outputs are terminated with a load that has a VSWR not greater than 2.0:1.
2. TNC or NType output connectors are available by substituting "TNC" or "NNN" for "SMA" in the Model Number.