



Chipsmall Limited consists of a professional team with an average of over 10 year of expertise in the distribution of electronic components. Based in Hongkong, we have already established firm and mutual-benefit business relationships with customers from,Europe,America and south Asia,supplying obsolete and hard-to-find components to meet their specific needs.

With the principle of “Quality Parts,Customers Priority,Honest Operation,and Considerate Service”,our business mainly focus on the distribution of electronic components. Line cards we deal with include Microchip,ALPS,ROHM,Xilinx,Pulse,ON,Everlight and Freescale. Main products comprise IC,Modules,Potentiometer,IC Socket,Relay,Connector.Our parts cover such applications as commercial,industrial, and automotives areas.

We are looking forward to setting up business relationship with you and hope to provide you with the best service and solution. Let us make a better world for our industry!



Contact us

Tel: +86-755-8981 8866 Fax: +86-755-8427 6832

Email & Skype: info@chipsmall.com Web: www.chipsmall.com

Address: A1208, Overseas Decoration Building, #122 Zhenhua RD., Futian, Shenzhen, China



THIS COPY IS PROVIDED ON A RESTRICTED BASIS AND IS NOT TO BE USED IN ANY WAY DETRIMENTAL TO THE INTERESTS OF PANDUIT CORP.



GROUNDING WASHER (QTY. 1)

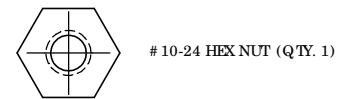

10-24 HEX NUT (QTY. 1)

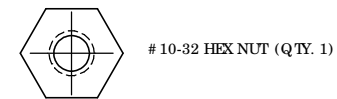

10-32 HEX NUT (QTY. 1)



10 SPLIT LOCK WASHER (QTY. 1)



ESD STICKER (QTY. 1)

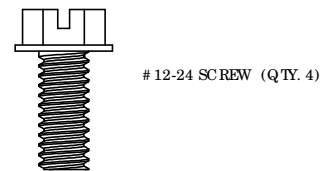

12-24 SCREW (QTY. 4)

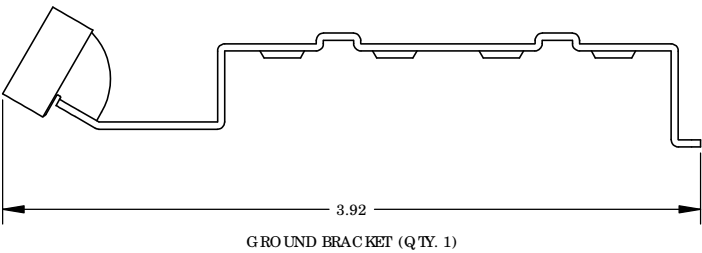
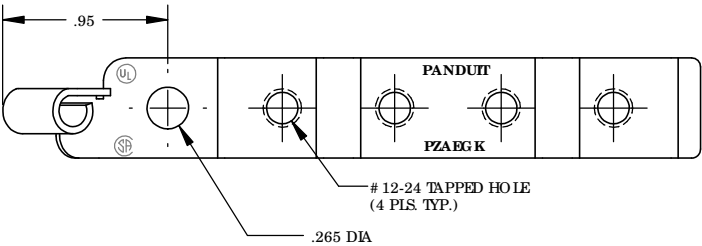

- NO TES:
1. ENCLOSURE GROUNDING KIT
PARTNUMBER: PZAEG K
 2. PACKAGING: 1 KITPER BAG
 3. ALL COMPONENTS THATMAKE UP THIS KIT
ARE Ro HS COMPLIANT

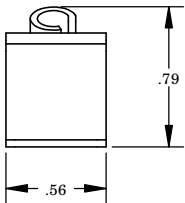

C41682_00

								PANDUIT CORP. TINEY PARK, ILLINOIS			
								ENCLOSURE GROUNDING KIT (PZAEG K) CUSTOMER DRAWING			
								UNLESS OTHERWISE SPECIFIED DIMENSIONAL TOLERANCES ARE: (.X) ± (.XX) ±		UNLESS OTHERWISE SPECIFIED, ALL DIMENSIONS ARE GIVEN IN INCHES, THIRD ANGLE PROJECTION	
								DRAWN BY JHNU DATE 11/06		SCALE NONE	
								MAT'L:		DRAWING NO / CAD FILE	
00	11/06	JHNU	RGB	DRAWING RELEASED				PC00599		C41682	
REV	DATE	BY	CHK	DESCRIPTION				ECN	PM	CUST	DWG B SIZE