



Chipsmall Limited consists of a professional team with an average of over 10 year of expertise in the distribution of electronic components. Based in Hongkong, we have already established firm and mutual-benefit business relationships with customers from,Europe,America and south Asia,supplying obsolete and hard-to-find components to meet their specific needs.

With the principle of “Quality Parts,Customers Priority,Honest Operation,and Considerate Service”,our business mainly focus on the distribution of electronic components. Line cards we deal with include Microchip,ALPS,ROHM,Xilinx,Pulse,ON,Everlight and Freescale. Main products comprise IC,Modules,Potentiometer,IC Socket,Relay,Connector.Our parts cover such applications as commercial,industrial, and automotives areas.

We are looking forward to setting up business relationship with you and hope to provide you with the best service and solution. Let us make a better world for our industry!



Contact us

Tel: +86-755-8981 8866 Fax: +86-755-8427 6832

Email & Skype: info@chipsmall.com Web: www.chipsmall.com

Address: A1208, Overseas Decoration Building, #122 Zhenhua RD., Futian, Shenzhen, China



Feature:

- Water clear lens
- Package in tape and reel
- Side View Ultra bright 1206 LED package
- InGaN technology for IB/IG/IW
- AlInGaP technology for R/AG/Y

Description:

These ultra bright 1206 LEDs have a height profile of 1.0mm. With higher packing density and smaller footprint, these LEDs are ideal for smaller equipment and miniature application.

Application:

- Status indication
- Back lighting application
- General Use

Certification & Compliance:

- TS16949
- ISO9001
- RoHS Compliant



Dimension:

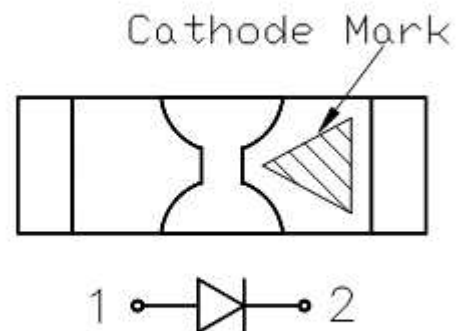
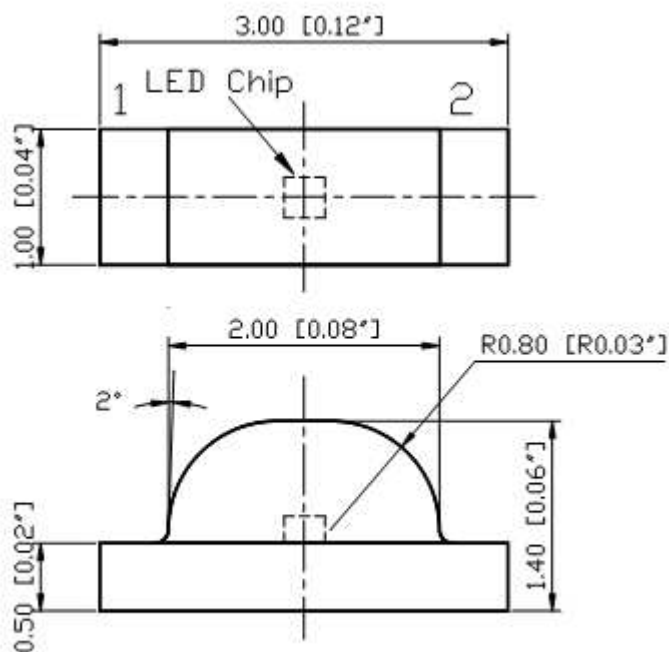

Units: mm / tolerance = +/-0.1mm

Electrical / Optical Characteristic (T=25 °C)

Product	Color	I _F (mA)	V _F (V)		λ _D (nm)			I _V (mcd)	
			Typ.	max	Min.	Typ.	Max.	Min.	Typ.
QBLP610-IW	White	20	3.1	3.6	X = 0.30 Y = 0.31	--	--	125	320
QBLP610-IB	Blue	20	3.1	3.6	465	470	475	60	100
QBLP610-IG	True Green	20	3.1	3.6	520	525	530	320	400
QBLP610-R	Red	20	2.0	2.4	625	630	635	22	85
QBLP610-AG	Yellow Green	20	2.0	2.4	564	570	576	25	50
QBLP610-Y	Yellow	20	2.0	2.4	585	590	595	80	170

Absolute Maximum Rating

Part #	P _d (mW)	I _F (mA)	I _{FP} (mA)*	V _R (V)	T _{OP} (°C)	T _{ST} (°C)	T _{SOL} (°C)**
InGaN (IW/IB/IG)	108	30	100	5	-40 ~ +85	-40 ~ +100	260
AlInGaP (R/AG/Y)	75	30	100	5	-40 ~ +85	-40 ~ +100	260

*Duty 1/10 @ 10KHz

** IR Reflow for no more than 10 sec @ 260 °C

Characteristic Curves(IF/IB/IG):

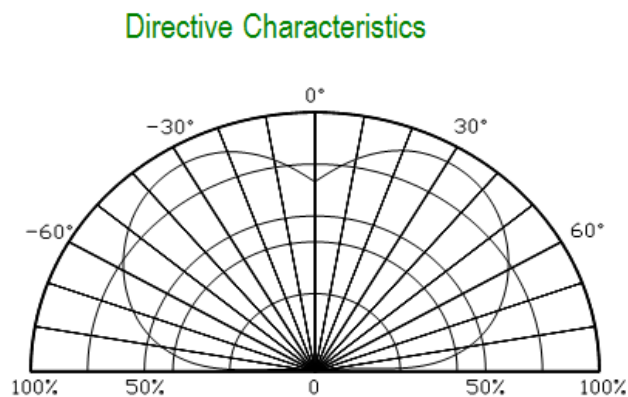
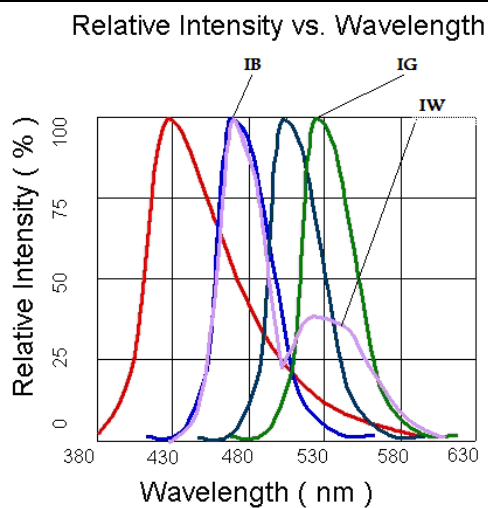
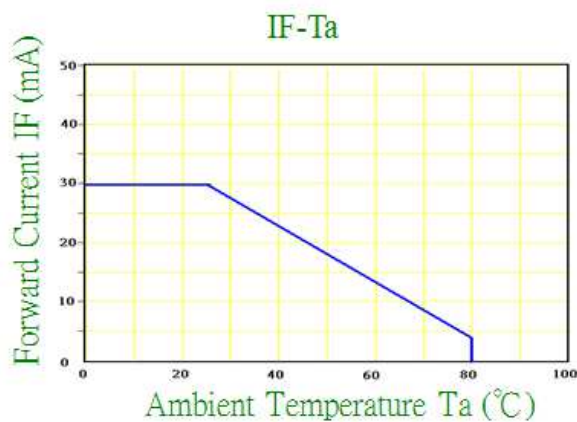
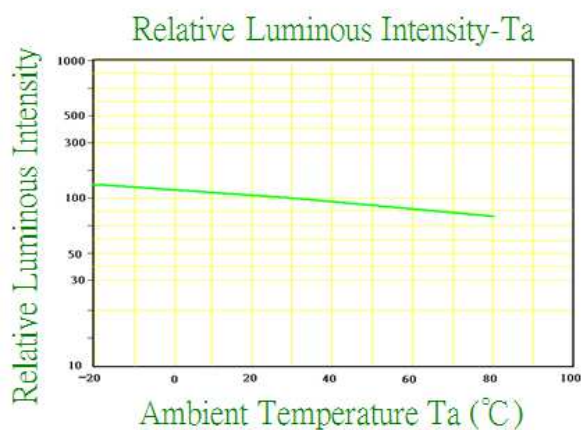
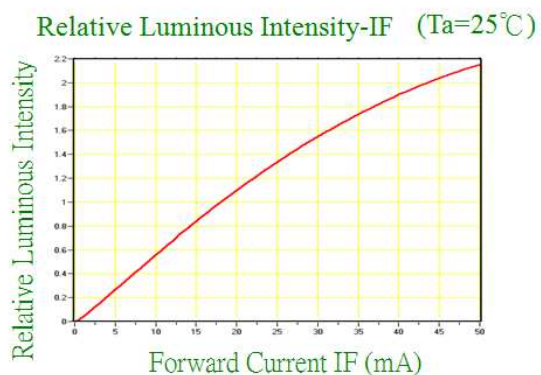
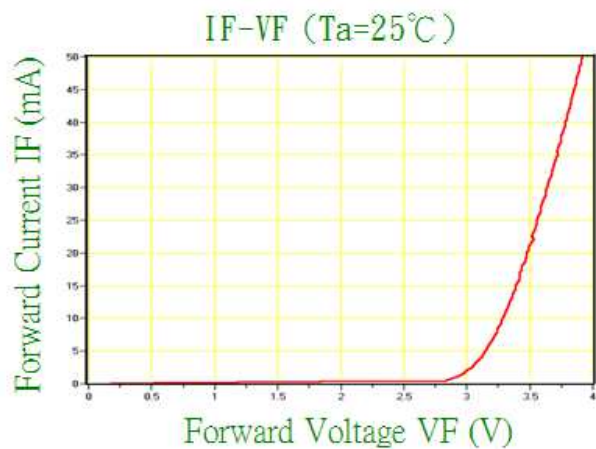

Characteristic Curves(R/AG/Y):

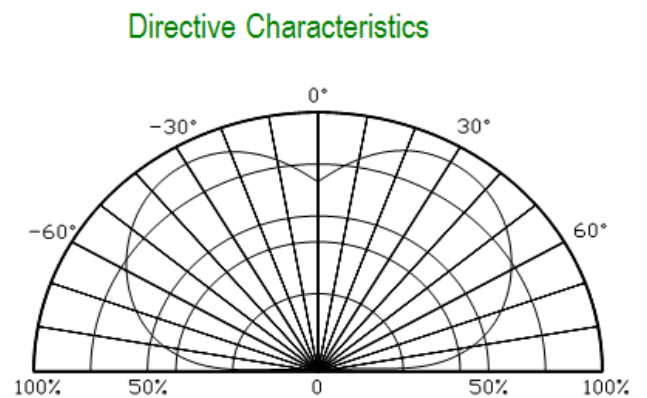
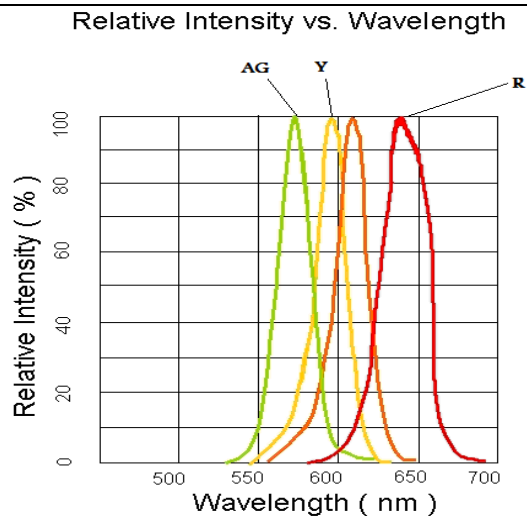
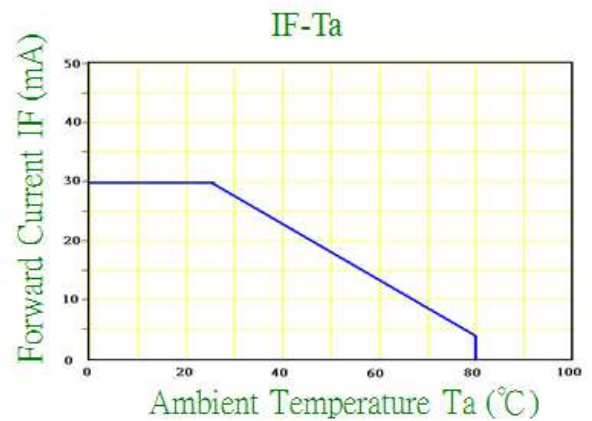
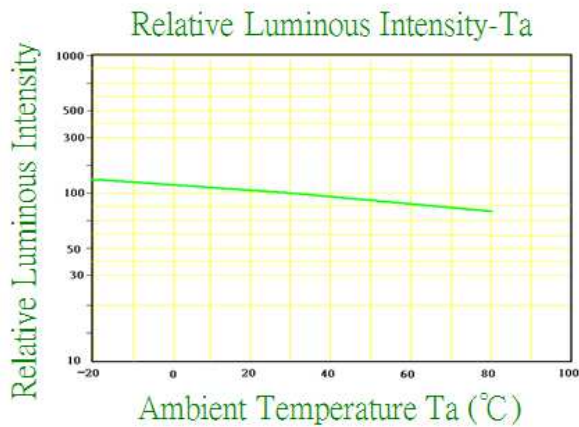
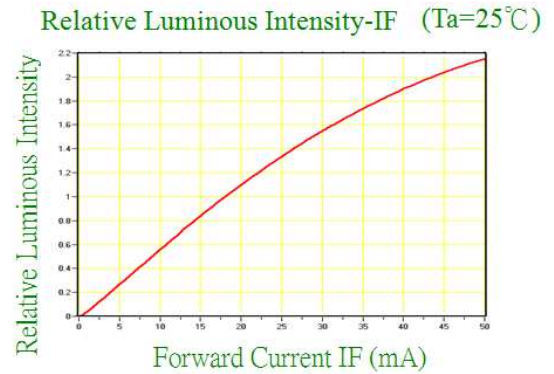
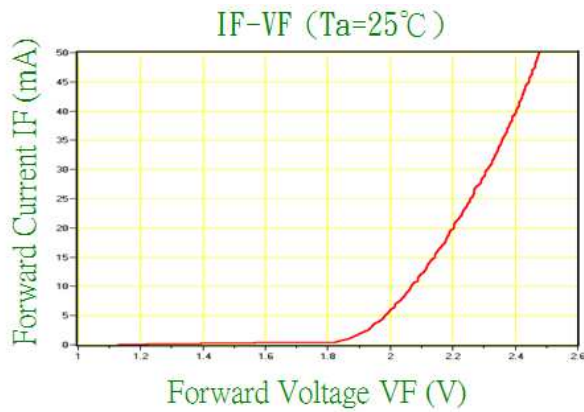

Solder Profile & Footprint:

- Recommended tin glue specifications: melting temperature in the range of 178~192 °C
- The recommended reflow soldering profile is as follows (temperatures indicated are as measured on the surface of the LED resin):

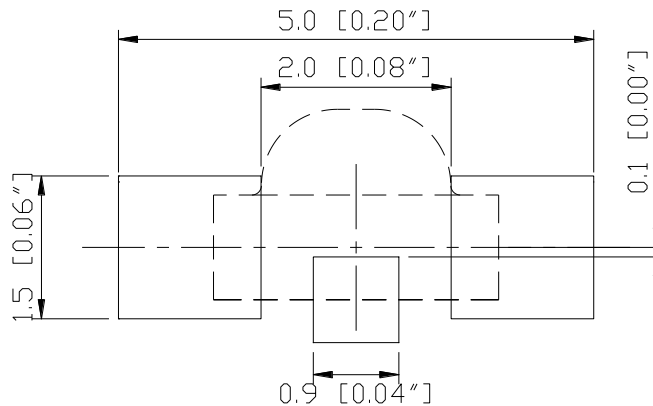
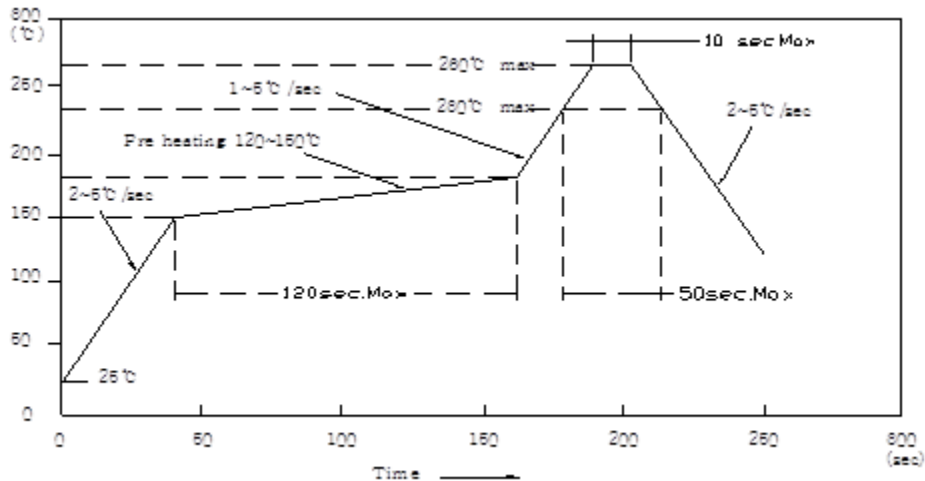

(Proposed Solder footprint)

Units: mm

tolerance: +/- 0.1mm

Product: QBL610_series	Date: June 25, 2011	Page 5 of 8
	Version# 2.2	

Packing:

Reel Dimension:

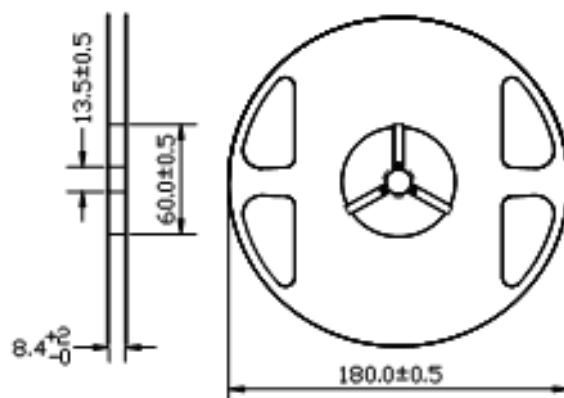

Tape Dimension:

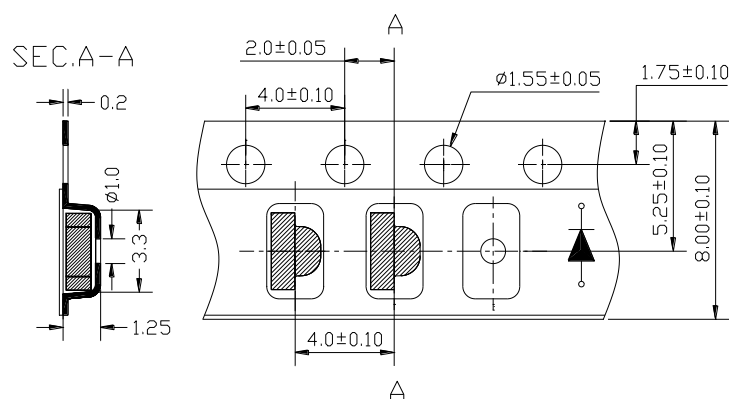

Units: mm / tolerance = +/-0.1mm

Product: QBL610_series	Date: June 25, 2011	Page 6 of 8
	Version# 2.2	

Labeling:

QT-Brightek
Part No: _____
Customer P/N: _____
Item: _____
Q'ty: _____
Vf: _____
Iv: _____
WI: _____
Date: _____
Made in China

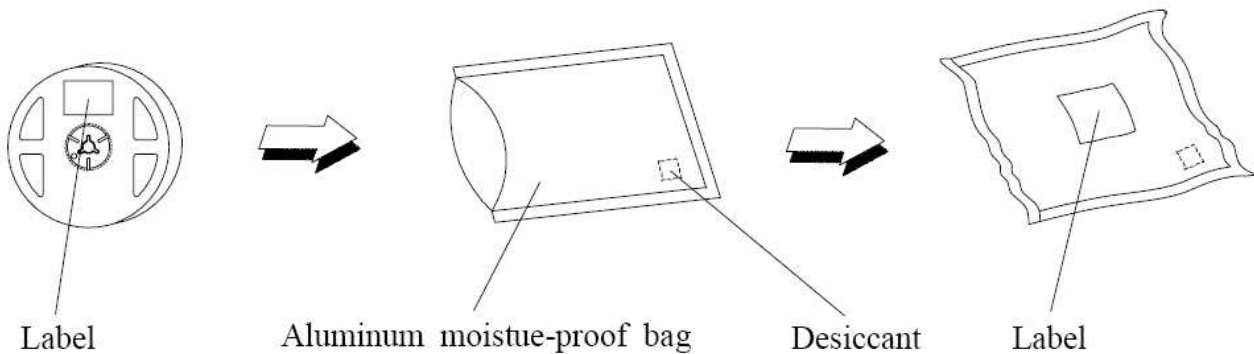

Ordering Information:

Part #	Orderable Part #	Spec Range	Quantity per reel
QBLP610-IW	QBLP610-IW	Iv = 320mcd typ. / (X = 0.30, Y = 0.31)	3,000 units
QBLP610-IB	QBLP610-IB	Iv = 100 mcd typ. / Color = 470nm	3,000 units
QBLP610-IG	QBLP610-IG	Iv = 400 mcd typ. / Color = 525nm	3,000 units
QBLP610-R	QBLP610-R	Iv = 85 mcd typ. / Color = 630nm	3,000 units
QBLP610-AG	QBLP610-AG	Iv = 50 mcd typ. / Color= 575nm	3,000 units
QBLP610-Y	QBLP610-Y	Iv = 170 mcd typ. / Color = 590nm	3,000 units

Revision History:

Description:	Revision #	Revision Date
New Release of QBLP610 _series	V1.0	02/02/2011
Information Updates	V2.0	03/02/2011
Amend Dimension/ label/ Brightness	V2.1	05/04/2011
Add white color specification	V2.2	06/25/2011