



Chipsmall Limited consists of a professional team with an average of over 10 year of expertise in the distribution of electronic components. Based in Hongkong, we have already established firm and mutual-benefit business relationships with customers from,Europe,America and south Asia,supplying obsolete and hard-to-find components to meet their specific needs.

With the principle of "Quality Parts,Customers Priority,Honest Operation,and Considerate Service",our business mainly focus on the distribution of electronic components. Line cards we deal with include Microchip,ALPS,ROHM,Xilinx,Pulse,ON,Everlight and Freescale. Main products comprise IC,Modules,Potentiometer,IC Socket,Relay,Connector.Our parts cover such applications as commercial,industrial, and automotives areas.

We are looking forward to setting up business relationship with you and hope to provide you with the best service and solution. Let us make a better world for our industry!



Contact us

Tel: +86-755-8981 8866 Fax: +86-755-8427 6832

Email & Skype: info@chipsmall.com Web: www.chipsmall.com

Address: A1208, Overseas Decoration Building, #122 Zhenhua RD., Futian, Shenzhen, China



THIS COPY IS PROVIDED ON A RESTRICTED BASIS AND IS NOT TO BE USED IN ANY WAY DETRIMENTAL TO THE INTERESTS OF PANDUIT CORP.

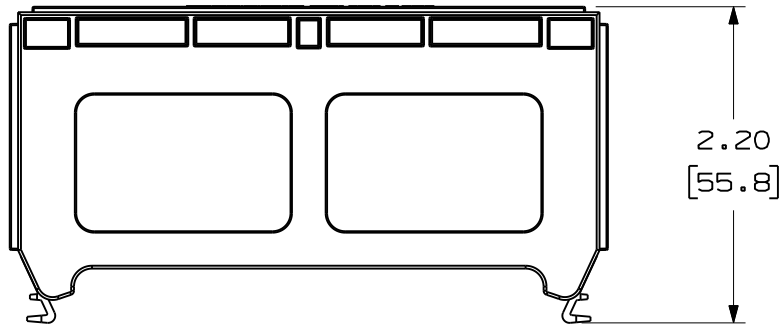
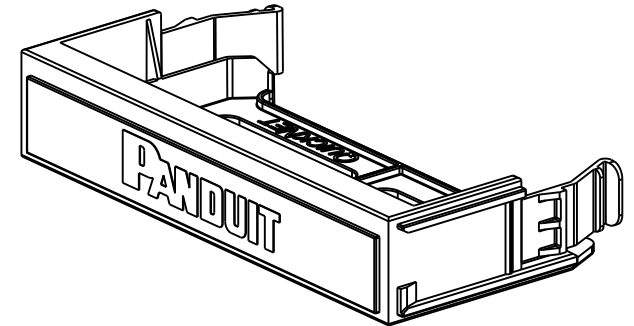
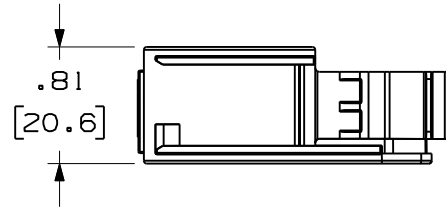
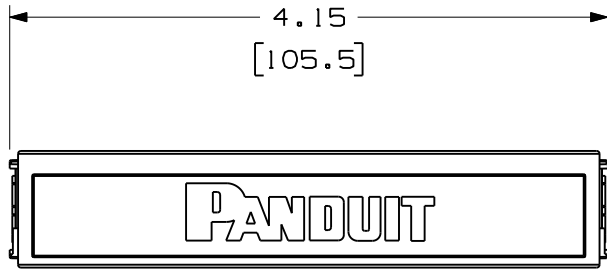

NOTES:

1. SEE CURRENT CATALOG FOR VARIOUS APPLICATIONS.
2. THE 6 PORT PANEL ADAPTER IS DESIGNED FOR USE WITH QuickNET QPP24 AND QPP48 SERIES STRAIGHT AND ANGLED PATCH PANELS.
3. DIMENSIONS IN BRACKETS ARE IN METRIC.

PANDUIT PART NUMBER	WEIGHT (APPOX.)
QPPBBL	0.04 lbs (20.0 g)



MODEL FILENAME	10F094BD/01	SIZE
DRAWING FILENAME	M02582CJ_DC43/04C	A

QuickNET PATCH PANEL
BLANK CUSTOMER DRAWING



I.I. NUMBER
PRODUCT SPEC/ PKG SPEC
ASSY METHOD/ TEST METHOD
SCALE .75 TO 1
PART NO. QPPBBL
DRAWING NO. 02582-43

THIRD ANGLE PROJECTION	ALL DIMENSIONS ARE GIVEN IN INCHES, UNLESS OTHERWISE SPECIFIED. DIMENSIONAL TOLERANCES ARE: (.X) ±.03 (.XXX) ±.005 (.XX) ±.01 ANGLES ± 1°
DRAWN BY KSM	REVIEW DRAWING NUMBERS
DATE 1-03-07	MAT'L BLACK POLYCARBONATE
CHK'D WFMI	

REV	DATE	BY	CHK	DESCRIPTION	ECN	R	CUST	SUP	OTH
2	3-11-11	BJN	WFMI	B. UPDATED MODEL TO 10F094BD/01	02582-43		JPMC		
1	5-25-07	MDJr	WFMI	A. UPDATED MODEL TO REVISION 04	02582-43		TRW		
R	1-31-07	MDJr	WFMI	RELEASED FOR PRODUCTION	02582-43				