



Chipsmall Limited consists of a professional team with an average of over 10 year of expertise in the distribution of electronic components. Based in Hongkong, we have already established firm and mutual-benefit business relationships with customers from,Europe,America and south Asia,supplying obsolete and hard-to-find components to meet their specific needs.

With the principle of “Quality Parts,Customers Priority,Honest Operation,and Considerate Service”,our business mainly focus on the distribution of electronic components. Line cards we deal with include Microchip,ALPS,ROHM,Xilinx,Pulse,ON,Everlight and Freescale. Main products comprise IC,Modules,Potentiometer,IC Socket,Relay,Connector.Our parts cover such applications as commercial,industrial, and automotives areas.

We are looking forward to setting up business relationship with you and hope to provide you with the best service and solution. Let us make a better world for our industry!



## Contact us

Tel: +86-755-8981 8866 Fax: +86-755-8427 6832

Email & Skype: info@chipsmall.com Web: www.chipsmall.com

Address: A1208, Overseas Decoration Building, #122 Zhenhua RD., Futian, Shenzhen, China



DO NOT SCALE FROM THIS PRINT

DESIGNED & DIMENSIONED IN MILLIMETERS [INCHES]

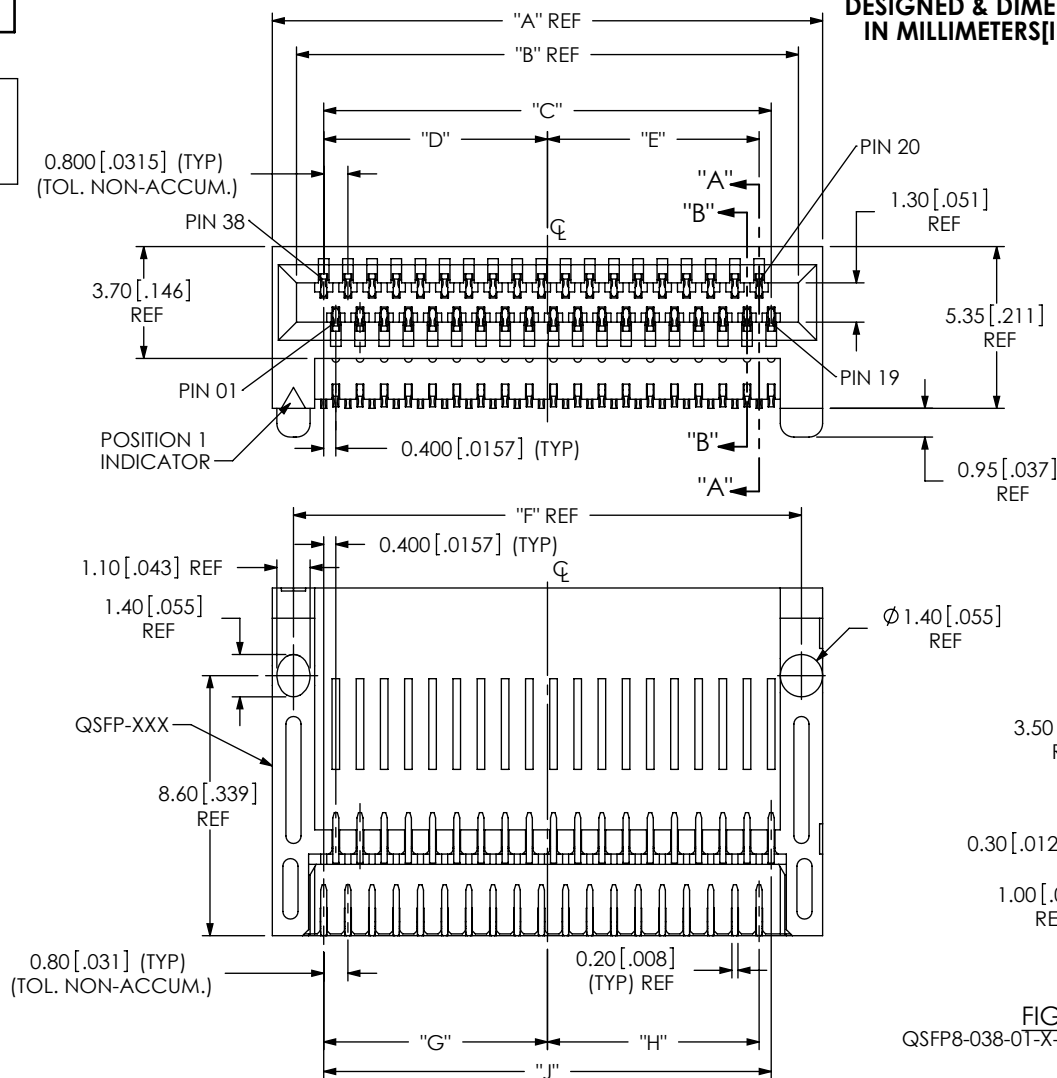

QSFP8-XXX-01-X-D-RA1-XX

No. OF POSITIONS  
\*-020, -038, \*-100  
(TOTAL NUMBER OF POSITIONS)

LEAD STYLE  
-01

PLATING SPECIFICATION  
-L: 10U" MIN AU/50U"Ni IN CONTACT, TIN ON TAIL

OPTIONS  
-TR: TAPE & REEL (LEAVE BLANK FOR TUBE PACKAGING)

SMT TYPE  
-RA1: RIGHT ANGLE

ROW SPECIFICATION  
-D: DOUBLE ROW

(\* = NOT TOOLED)

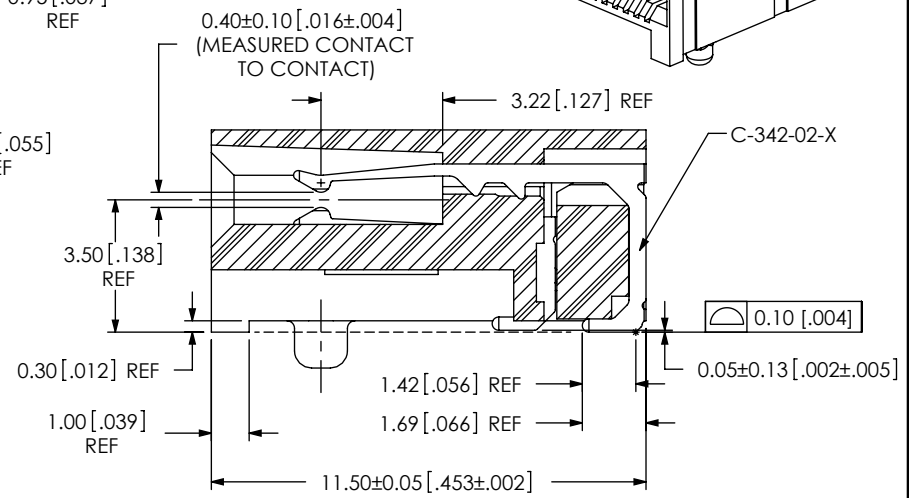
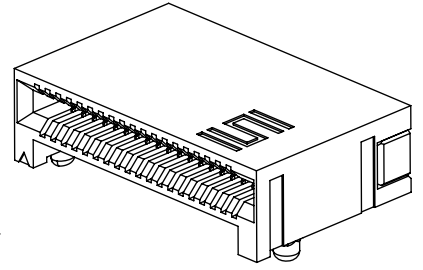

FIG 1 QSFP8-038-01-X-D-RA1 SHOWN

TABLE 2

No. OF POS	"G"	"H"	"J"
*-020	3.80 [0.150]	3.40 [0.134]	7.60 [0.299]
-038	7.40 [0.291]	7.00 [0.276]	14.80 [0.583]
*-100	19.80 [0.780]	19.40 [0.764]	39.60 [1.559]

(\* = NOT TOOLED)

TABLE 1

No. OF POS	"A"	"B"	"C"	"D"	"E"	"F"
*-020	11.00 [0.433]	9.40 [0.370]	7.60 [0.299]	3.80 [0.150]	3.40 [0.134]	9.60 [0.378]
-038	18.20 [0.717]	16.60 [0.654]	14.80 [0.583]	7.40 [0.291]	7.00 [0.276]	16.80 [0.661]
*-100	43.00 [1.693]	41.40 [1.630]	39.60 [1.559]	19.80 [0.780]	19.40 [0.764]	41.60 [1.638]

(\* = NOT TOOLED)

NOTES:

- ⊙ REPRESENTS A CRITICAL DIMENSION.
- MINIMUM PUSHOUT FORCE: 1.11N [0.25 LB].
- NOTE DELETED.

UNLESS OTHERWISE SPECIFIED, DIMENSIONS ARE IN MILLIMETERS. TOLERANCES ARE:  
DECIMALS ANGLES  
X.X: ±0.3 [.01] 2°  
X.XX: ±0.13 [.005]  
X.XXX: ±0.051 [.0020]

PROPRIETARY NOTE  
THIS DOCUMENT CONTAINS INFORMATION CONFIDENTIAL AND PROPRIETARY TO SAMTEC, INC. AND SHALL NOT BE REPRODUCED OR TRANSFERRED TO OTHER DOCUMENTS OR DISCLOSED TO OTHERS OR USED FOR ANY PURPOSE OTHER THAN THAT WHICH IT WAS OBTAINED WITHOUT THE EXPRESSED WRITTEN CONSENT OF SAMTEC, INC.

**samtec**  
520 PARK EAST BLVD., NEW ALBANY, IN 47150  
PHONE: 812-944-6733 FAX: 812-948-5047  
e-Mail: info@SAMTEC.com code 53322

MATERIAL: DO NOT SCALE DRAWING SHEET SCALE: 4:1  
INSULATOR: LCP, COLOR: BLACK  
CONTACT: PHOS BRONZE  
F:\DWG\MISC\MKTG\QSFP8-XXX-01-X-D-RA1-XX-MKT.SLDDRW

DESCRIPTION: QSFP8 ASM  
DWG. NO. QSFP8-XXX-01-X-D-RA1-XX  
BY: ROY LUO 7/20/2010 SHEET 1 OF 2

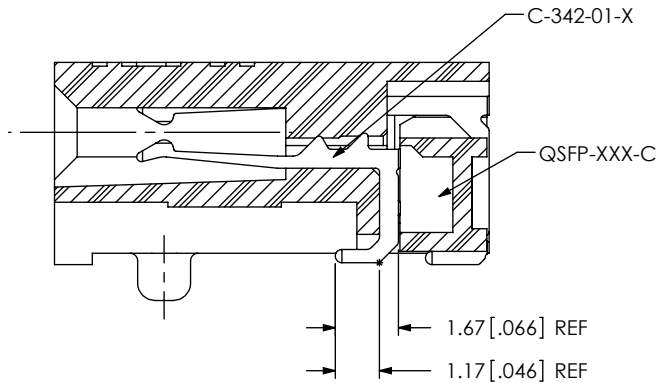

SECTION "B"-"B"  
SCALE 5:1

(SAME AS SECTION "A"-"A", EXCEPT AS SHOWN)

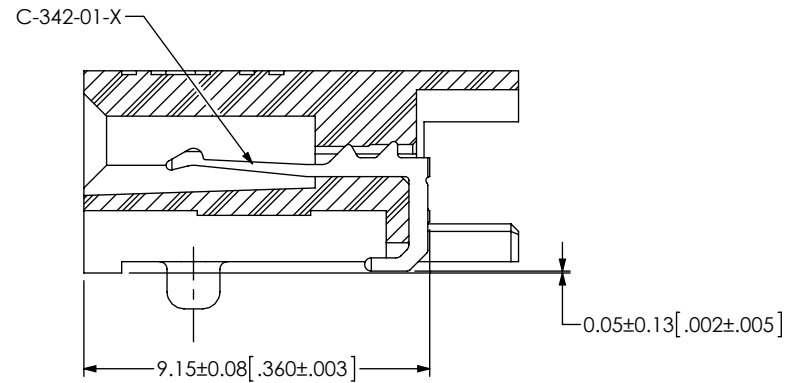
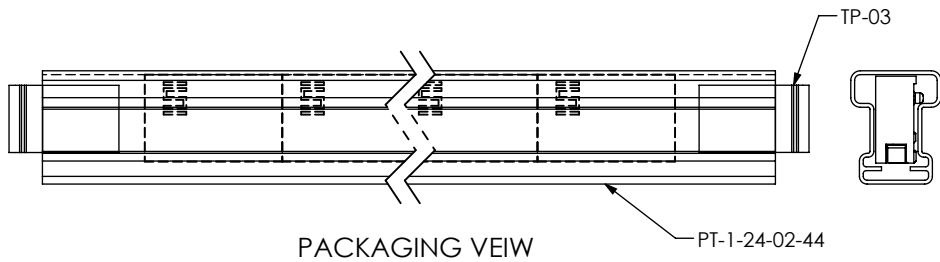

IN-PROCESS 1  
(FILL QSFP-XXX-C)

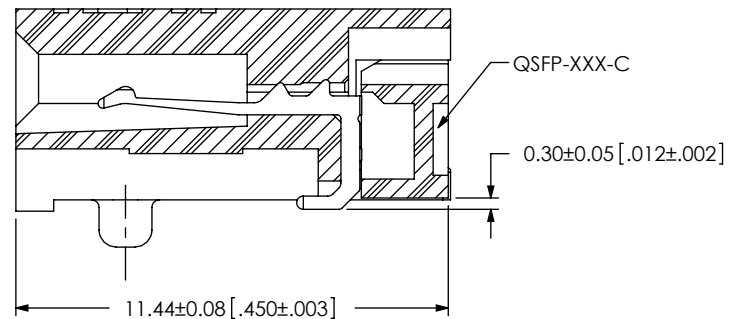

IN-PROCESS 2  
(FILL QSFP-XXX-C)

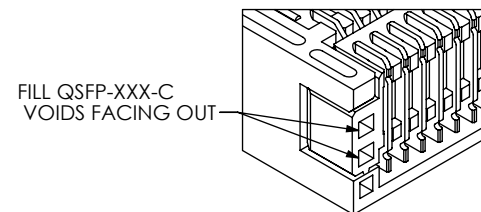

PROPRIETARY NOTE

THIS DOCUMENT CONTAINS INFORMATION CONFIDENTIAL AND PROPRIETARY TO SAMTEC, INC. AND SHALL NOT BE REPRODUCED OR TRANSFERRED TO OTHER DOCUMENTS OR DISCLOSED TO OTHERS OR USED FOR ANY PURPOSE OTHER THAN THAT WHICH IT WAS OBTAINED WITHOUT THE EXPRESSED WRITTEN CONSENT OF SAMTEC, INC.

DO NOT SCALE DRAWING

SHEET SCALE: 4:1

**samtec**

520 PARK EAST BLVD, NEW ALBANY, IN 47150  
PHONE: 812-944-6733 FAX: 812-948-5047  
e-Mail info@SAMTEC.com code 55322

DESCRIPTION: QSFP8 ASM

DWG. NO. QSFP8-XXX-01-X-D-RA1-XX

BY: ROY LUO 7/20/2010 SHEET 2 OF 2