



Chipsmall Limited consists of a professional team with an average of over 10 year of expertise in the distribution of electronic components. Based in Hongkong, we have already established firm and mutual-benefit business relationships with customers from,Europe,America and south Asia,supplying obsolete and hard-to-find components to meet their specific needs.

With the principle of “Quality Parts,Customers Priority,Honest Operation,and Considerate Service”,our business mainly focus on the distribution of electronic components. Line cards we deal with include Microchip,ALPS,ROHM,Xilinx,Pulse,ON,Everlight and Freescale. Main products comprise IC,Modules,Potentiometer,IC Socket,Relay,Connector.Our parts cover such applications as commercial,industrial, and automotives areas.

We are looking forward to setting up business relationship with you and hope to provide you with the best service and solution. Let us make a better world for our industry!



Contact us

Tel: +86-755-8981 8866 Fax: +86-755-8427 6832

Email & Skype: info@chipsmall.com Web: www.chipsmall.com

Address: A1208, Overseas Decoration Building, #122 Zhenhua RD., Futian, Shenzhen, China



THIS COPY IS PROVIDED ON A RESTRICTED BASIS AND IS NOT TO BE USED IN ANY WAY DETRIMENTAL TO THE INTERESTS OF PANDUIT CORP.

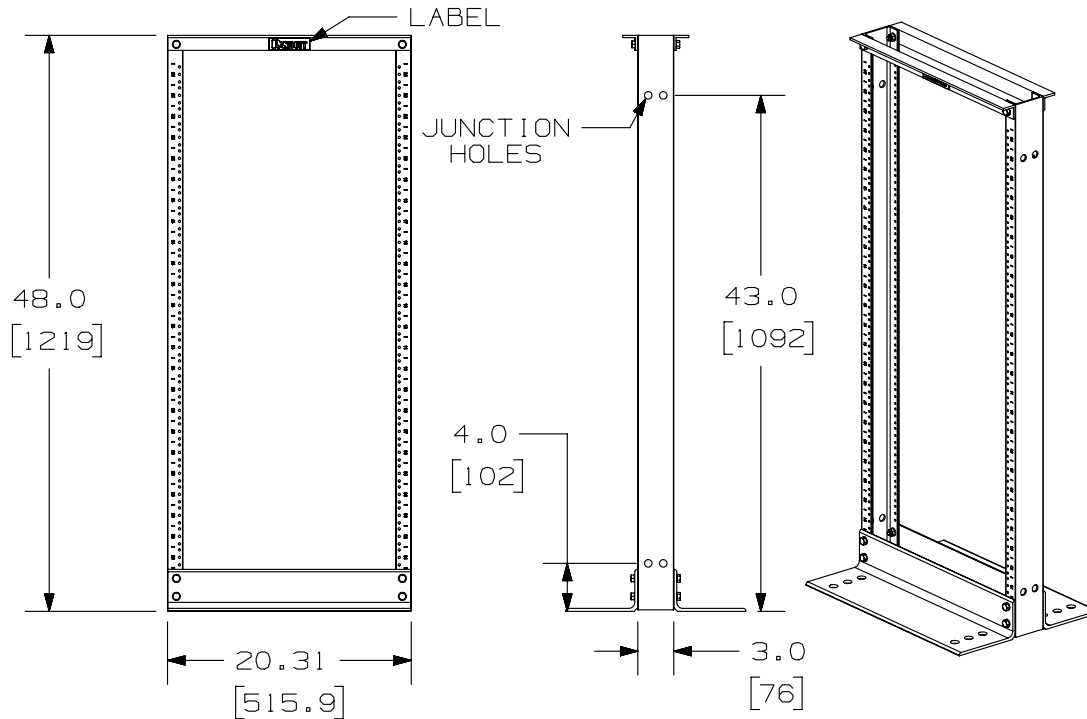

12X .75 DIA (REF.)
[19.0]
FLOOR MOUNTING HOLE
(6 PLACES ON EACH
BASE BRACKET)

CLOSE UP
OF VERTICAL
CHANNEL

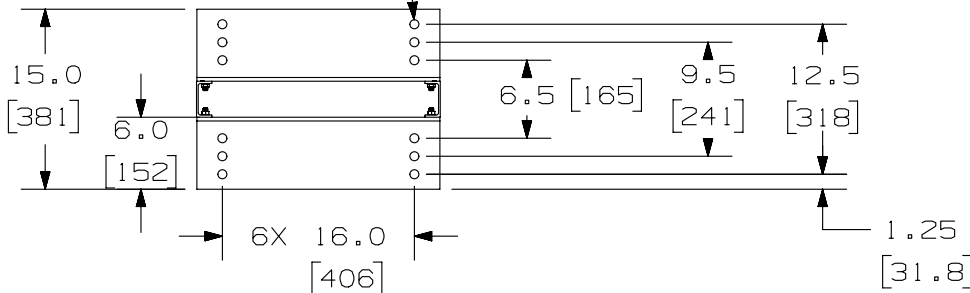

NOTES:

- CAN BE USED WITH ANY INDUSTRY STANDARD 19" COMPONENTS IN ADDITION TO ALL PANDUIT CABLE MANAGEMENT AND PATCH PANEL PRODUCTS.
- WILL HOLD UP TO 24 SINGLE RACK SPACINGS.
- UNIVERSAL SPACING ON RACK: I.E., REF. HOLE SPACING ON UPRIGHT CHANNELS: .625, .625, .500, .625, .625, .500, ETC.
- ASSEMBLY IS REQUIRED.
- RACK PART THICKNESSES:
 - UPRIGHT CHANNELS: WEB; .14 \pm .03
FLANGE; .19 \pm .03
 - TOP BRACKET: .19 \pm .03
 - BASE BRACKET: .25 \pm .03
- DIMENSIONS IN PARENTHESES ARE IN METRIC.
- ALL ASSEMBLY HARDWARE INCLUDED:
 - (12) 3/8-16 X 1" BLACK HEX HEAD CAP SCREW.
 - (24) 3/8" PAINT PIERCING GROUNDING WASHER.
 - (1) TUBE OF ANTI-OXIDIZING PASTE.
 - (12) 3/8-16 BLACK HEX NUTS.
 - (24) 12-24 X .5" SLOTTED PAN HEAD STEEL SCREWS.
- LOAD RATING-300 LBS.
- RU SPACINGS ARE CLEARLY MOUNTED ON MOUNTING RAILS. RU NUMBERING IS BOTTOM-UP, WITH RU #1 AT BOTTOM AND RU #24 AT TOP.

TITLE					
4 FT CABLE MANAGEMENT RACK (R2P48)					
CUSTOMER DRAWING					
ITEM REVISION NAME			09V064AB/01		
DATASET FILE NAME			09V064AB_DC/01A		
MATERIAL:			PANDUIT		
DRAWING NUMBER:			09V064AB-DC		
THIRD ANGLE PROJECTION					
DRAWN BY	DATE	CHK	SCALE	SIZE	
BAME	5-26-10	DPN	NONE	A	

REV	DATE	BY	CHK	APR	DESCRIPTION	ECN
01A	11-14-13	BAME	PM	CMK	REVISED VIEWS AND TITLE BLOCK	09V064AB-DC
00A	5-26-10	BAME	DPN	CMK	DRAWING RELEASED	09V064AB-DC