



Chipsmall Limited consists of a professional team with an average of over 10 year of expertise in the distribution of electronic components. Based in Hongkong, we have already established firm and mutual-benefit business relationships with customers from,Europe,America and south Asia,supplying obsolete and hard-to-find components to meet their specific needs.

With the principle of “Quality Parts,Customers Priority,Honest Operation,and Considerate Service”,our business mainly focus on the distribution of electronic components. Line cards we deal with include Microchip,ALPS,ROHM,Xilinx,Pulse,ON,Everlight and Freescale. Main products comprise IC,Modules,Potentiometer,IC Socket,Relay,Connector.Our parts cover such applications as commercial,industrial, and automotives areas.

We are looking forward to setting up business relationship with you and hope to provide you with the best service and solution. Let us make a better world for our industry!



Contact us

Tel: +86-755-8981 8866 Fax: +86-755-8427 6832

Email & Skype: info@chipsmall.com Web: www.chipsmall.com

Address: A1208, Overseas Decoration Building, #122 Zhenhua RD., Futian, Shenzhen, China



ROCKER SWITCHES

SERIES RA1066

RA 1066

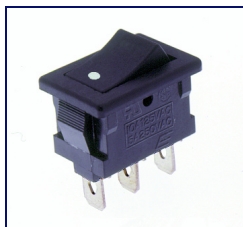
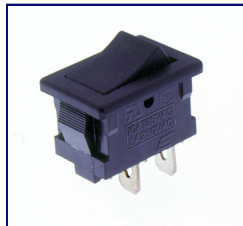

SPECIFICATIONS

CONTACT RESISTANCE: 100mΩ max.

DIELECTRIC STRENGTH: AC2000V for 1 minute

LIFE EXPECTANCY: Electrical/10,000 cycle (R-L o a d)
Mechanical/25,000 cycle

RATING: 10A/125VAC/5A/250VAC

OPERATING FORCE: 400±200gf

SAFETY STANDARD APPROVAL: UL (JRA), CSA, VDE, NEMKO,
SEMKO, FIMKO, DEMKO

MATERIALS

CONTACTS: Silver plated copper alloy



HOW TO ORDER

Series	Circuit	Termination	Marking
RA1066			
	A=SPST On-Off C=SPDT On-On	F=Faston S=Solder Lug	X A B C D F G H J K (See Next Page For Description)

Example:

RA1066 → A → F → H

SPECIFICATIONS SUBJECT TO CHANGE WITHOUT NOTICE.

A SPST

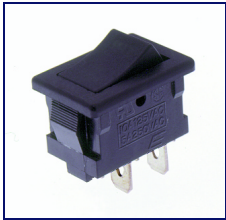

Circuit Code	POS 1	POS 2
A	ON	OFF
Term. Comm.	2-1	OPEN

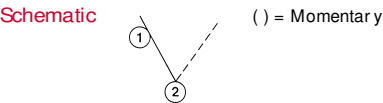

C SPDT

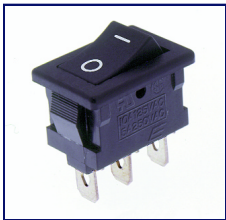

Circuit Code	POS 1	POS 2
C	ON	ON
Term. Comm.	2-1	2-3

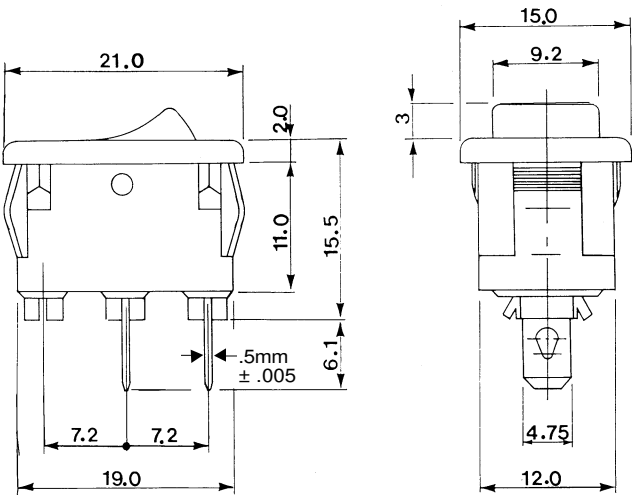
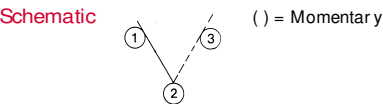

All dimensions in mm.

PANEL MOUNTING

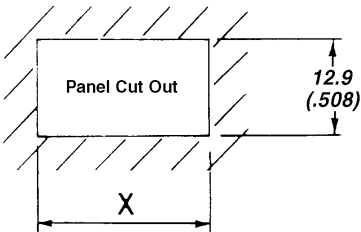

Panel Thickness	'X' Dim.
.75 - 1.25 (.030)-(.049)	19.2 (.756)
1.25 - 2.00 (.049)-(.079)	19.4 (.764)

TERMINATION OPTIONS

F Faston

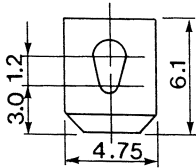

S Solder Lug

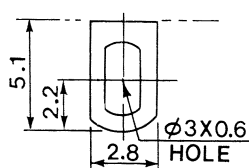

0.508 (.020) THK terminals designed for Quick Connect connectors available from AMP Industries, Harrisburg, PA 17105. (Or equivalent).

(F) Termination Rating:
10A, 125VAC

(S) Termination Rating:
5A, 250V AC

MARKING OPTIONS

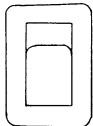

X

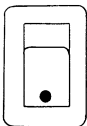

A

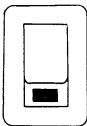

B

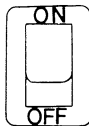

C

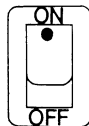

D

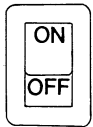

F

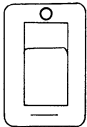

G

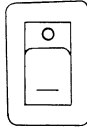

H

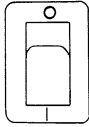

J

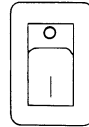

K

SPECIFICATIONS SUBJECT TO CHANGE WITHOUT NOTICE.