



Chipsmall Limited consists of a professional team with an average of over 10 year of expertise in the distribution of electronic components. Based in Hongkong, we have already established firm and mutual-benefit business relationships with customers from,Europe,America and south Asia,supplying obsolete and hard-to-find components to meet their specific needs.

With the principle of "Quality Parts,Customers Priority,Honest Operation,and Considerate Service",our business mainly focus on the distribution of electronic components. Line cards we deal with include Microchip,ALPS,ROHM,Xilinx,Pulse,ON,Everlight and Freescale. Main products comprise IC,Modules,Potentiometer,IC Socket,Relay,Connector.Our parts cover such applications as commercial,industrial, and automotives areas.

We are looking forward to setting up business relationship with you and hope to provide you with the best service and solution. Let us make a better world for our industry!



Contact us

Tel: +86-755-8981 8866 Fax: +86-755-8427 6832

Email & Skype: info@chipsmall.com Web: www.chipsmall.com

Address: A1208, Overseas Decoration Building, #122 Zhenhua RD., Futian, Shenzhen, China



THIS COPY IS PROVIDED ON A RESTRICTED BASIS AND IS NOT TO BE USED IN ANY WAY DETRIMENTAL TO THE INTERESTS OF PANDUIT CORP.

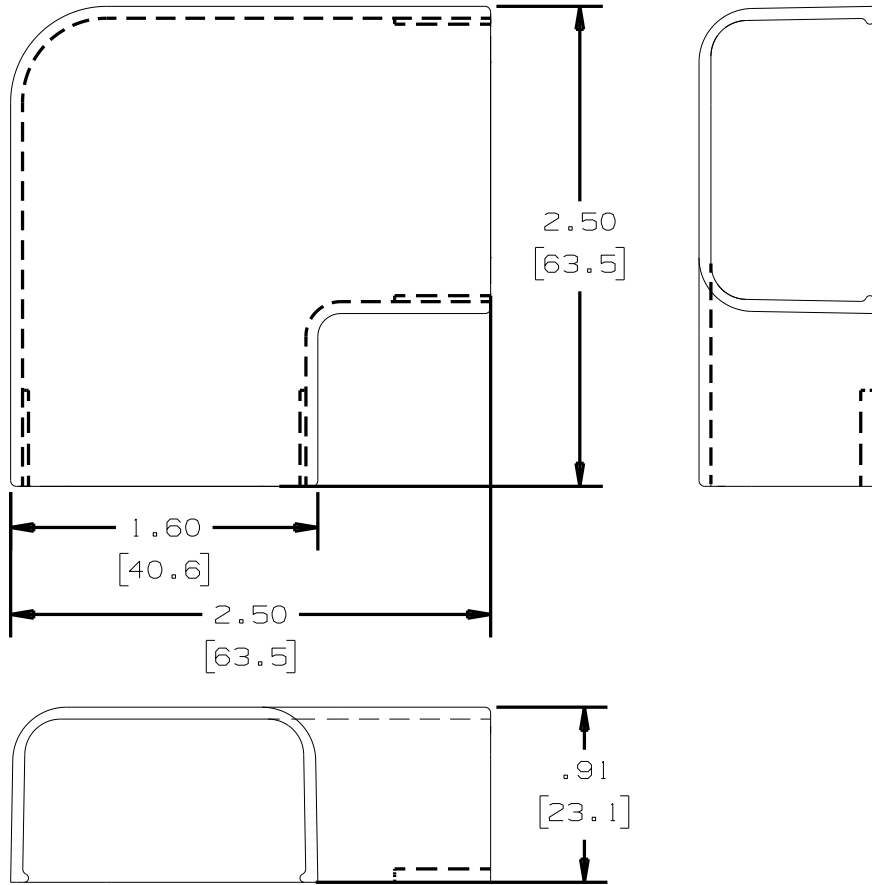

PANDUIT P/N	WEIGHT
RAF10	.03 LB/ EACH [13 g/ EACH]



NOTES:

1. SEE CURRENT CATALOG FOR ADDITIONAL PART SUFFIXES TO INDICATE COLOR AND OR PACKAGE QUANTITY.
2. DIMENSIONS IN PARENTHESIS ARE IN METRIC.

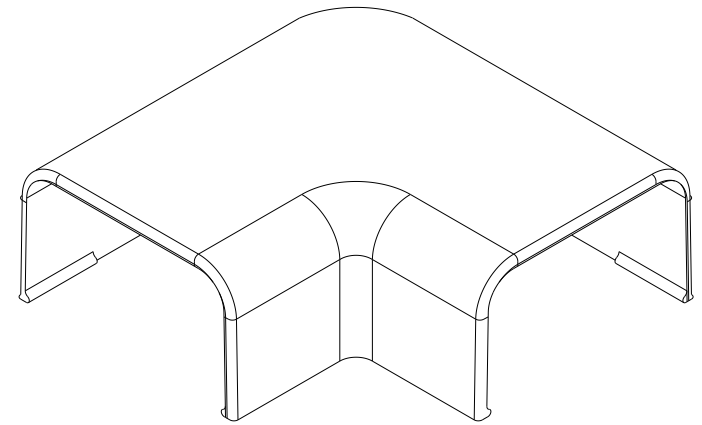

REV	DATE	BY	CHK	DESCRIPTION	ECN	R	CUST	SUP
--	--	--	RELEASED TO PRODUCTION	--	--	
8	06-11-08	BDK	RMH	I. REVISED TO CURRENT CAD STANDARDS DRAWING NUMBER WAS SS-1776	1776		RTFI	RTFI
7	7-3-02	JHNU	RMH	H. REVISED MATERIAL IN DRAWING TITLE BLOCK.	1776		RGRO	RGRO
6	5-18-01	REWE	BKR	G. REVISED WEIGHT QUANTITY F. REVISED TITLE: WAS REDUCER FITTING	1776		BKR	HIW
5	8-30-00	JHNU	HIW	E. REVISED AND REDRAWN.	1776		HIW	HIW
4	9-30-91	DW	CF	D. REV'D NOTE AND REMOVED COLOR FROM DWG.	1776		CF	CF
3	2-28-91	DW	CF	C. REV'D COLORS: OMIT BLACK, BEIGE, LIGHT IVORY, AND LIGHT GREY. ADDED INT. WHITE AND INT. GREY.	1776		CF	WJB/CF
2	12-2-87	LDB	WJB	B. ADDED P/N RAF10EI AND RAF10LI.	1776		WJB	WJB
1	10-1-84	CEK	HMP	A. REVISED MAT'L.	1776		HMP	AJC
R	11-2-82	SS	HMP	DRAWING RELEASED	1776		HMP	JKR

CAD FILENAME/LAYERS D34116BB_DC_RAF10_01D.PRT

PANDUIT CORP. TINLEY PARK, ILLINOIS

RIGHT ANGLE FITTING (RAF10)
CUSTOMER DRAWING



UNLESS OTHERWISE SPECIFIED,
DIMENSIONAL TOLERANCES ARE:
(.X) ± (.XXX) ±
(.XX) ± .031(.8) ANGLES ±

UNLESS OTHERWISE SPECIFIED,
ALL DIMENSIONS ARE GIVEN
IN INCHES, THIRD ANGLE PROJECTION.

DRAWN BY
SARGIS

MAT'L:

SCALE FULL

DATE
11-2-82

ABS

DRAWING NO.

DWG

CHK'D
JVL



34116-12

A

SIZE