



Chipsmall Limited consists of a professional team with an average of over 10 year of expertise in the distribution of electronic components. Based in Hongkong, we have already established firm and mutual-benefit business relationships with customers from,Europe,America and south Asia,supplying obsolete and hard-to-find components to meet their specific needs.

With the principle of "Quality Parts,Customers Priority,Honest Operation,and Considerate Service",our business mainly focus on the distribution of electronic components. Line cards we deal with include Microchip,ALPS,ROHM,Xilinx,Pulse,ON,Everlight and Freescale. Main products comprise IC,Modules,Potentiometer,IC Socket,Relay,Connector.Our parts cover such applications as commercial,industrial, and automotives areas.

We are looking forward to setting up business relationship with you and hope to provide you with the best service and solution. Let us make a better world for our industry!



## Contact us

Tel: +86-755-8981 8866 Fax: +86-755-8427 6832

Email & Skype: info@chipsmall.com Web: www.chipsmall.com

Address: A1208, Overseas Decoration Building, #122 Zhenhua RD., Futian, Shenzhen, China





# RB1 Series

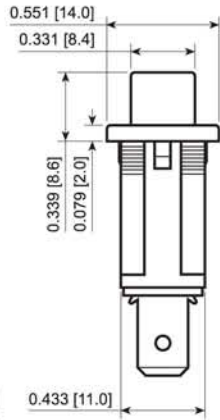
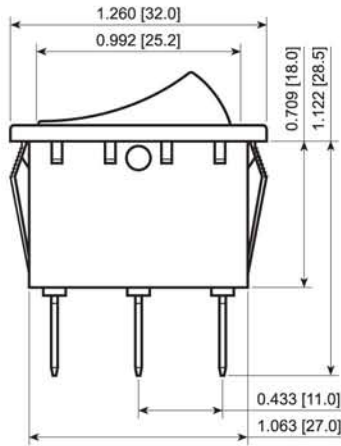

Dimensions of Some Versions May Vary From Above

### Illumination Options

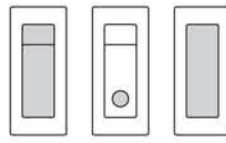

Full Round Lens Signal Light

### Actuator Options



Flat

### Terminal Options

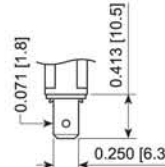

6.3mm Tab (Small Hole)

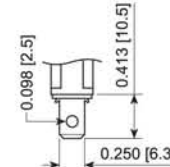

6.3mm Tab (Large Hole)

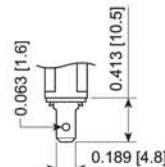

4.8mm Tab

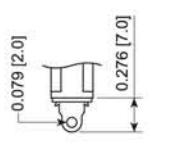

Solder

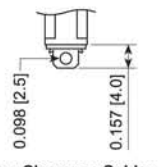

Low Clearance Solder

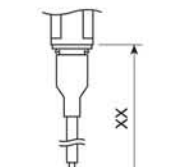

Wire Leads (xx in Inches)

### Panel Cutout

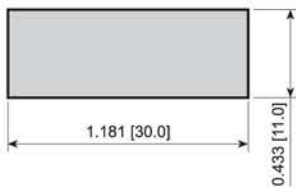

### Water Protection Option

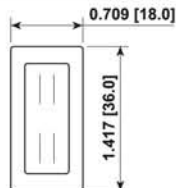

PVC Cap

### FEATURES:

- High Quality and Reliable Switch
- Industry Standard 11mm x 30mm Cutout
- Illuminated and Signal Light Versions
- Multiple Terminal and Actuator Options
- PVC Cap for Dust and Water Protection

### SPECIFICATIONS:

#### RATING: RATING OPTION C:

- 15A 125VAC T55 [cURus]
- 7.5A 250VAC T55 [cURus]
- 16(4)A 250V- 1E4 T125/55 [ENEC]

#### RATING OPTION D (2 Pos. Functions):

- 20A 125VAC T65 [cURus]
- 1/4HP 125VAC T65 [cURus]
- 3/4HP 250VAC T65 [cURus]
- 20(8)A 250V- 1E4 T125 [ENEC]
- 10(2)A 250V- 5E4 T85/55 [ENEC]
- 16(4)A 250V- 1E4 T85/55 [ENEC]

#### RATING OPTION E (3 Pos. Functions):

- 16A 125VAC T65 [cURus]
  - 16A 250VAC T65 [cURus]
- European Rating Pending

TEMPERATURE: -20°C to 65°C Min.

ELECTRICAL LIFE: 10,000 Cycles

CONTACT RESISTANCE: 35mΩ Max. at 50VAC

INSULATION RESISTANCE: 100MΩ Min. at 500VAC

DIELECTRIC STRENGTH: 1,500VAC for 1 Minute

INGRESS PROTECTION: IP54 with PVC Cap

### MATERIALS:

BODY: Polyamide 6/6, UL94 V-2

ACTUATOR: Polyamide 6/6, UL94 V-2

Polycarbonate, UL94 V-2

CONTACTS: Silver Plated Copper



RB141D1000-136 / ACC-F01-1



RB141D1100-216



RB1C5E1100

Series	Terminal	Function	Rating	Body Color	Actuator Color	Marking Color	Marking Type	Lens Style	Lens Color	Lamp Voltage
RB1 - Curved or Signal Light	1 - 4.8mm Tab	0 - Signal	0 - Signal	1 - Black	0 - Full /	0 - None	0 - None	1 - Full	0 - Clear	3 - 6V
RB1F - Flat	4 - 6.3mm Tab (Small Hole)	1 - Off-On	C - 15A 125V	2 - White	Signal	1 - Black	1 - I/O Vert.	2 - Round	1 - Red	4 - 12V
	5 - Solder	3 - On-Off	D - 20A 125V	3 - Almond	1 - Black	2 - White	2 - ON/OFF/ON Vert.		2 - Amber	5 - 24V
	9 - 6.3mm Tab (Large Hole)	4 - Off-(On)	E - 16A 125V	4 - Grey	2 - White	8 - Red	3 - ON/OFF Vert.		3 - Green	6 - 125V
	A - On-(Off)	5 - On-Off-On		9 - Red	3 - Almond		4 - ON/OFF Horiz.		4 - Blue	7 - 250V
	C - Low Clear. Solder	A - On-(Off)			4 - Grey		9 - I/O/II Horiz.		5 - Yellow	
	Wxx - Wire Leads	B - On-(On)			5 - Orange		S - I/O/II Vert.			
		C - On-Off-(On)			7 - Blue		R - I/O Horiz.			
		D - (On)-Off-(On)			8 - Green					
					9 - Red					

Custom Colors and Markings Available Upon Request For Illuminated Switches Only

### EXAMPLE PART NUMBERS:

RB141D1100 1P Off-On  
Black Body, Red Illum. Actuator, I/O Vert.

RB141D1000-116 1P Off-On  
Black Body/Actuator, No Marking



E-SWITCH®

www.e-switch.com

800.867.2717