



Chipsmall Limited consists of a professional team with an average of over 10 year of expertise in the distribution of electronic components. Based in Hongkong, we have already established firm and mutual-benefit business relationships with customers from,Europe,America and south Asia,supplying obsolete and hard-to-find components to meet their specific needs.

With the principle of “Quality Parts,Customers Priority,Honest Operation,and Considerate Service”,our business mainly focus on the distribution of electronic components. Line cards we deal with include Microchip,ALPS,ROHM,Xilinx,Pulse,ON,Everlight and Freescale. Main products comprise IC,Modules,Potentiometer,IC Socket,Relay,Connector.Our parts cover such applications as commercial,industrial, and automotives areas.

We are looking forward to setting up business relationship with you and hope to provide you with the best service and solution. Let us make a better world for our industry!



## Contact us

Tel: +86-755-8981 8866 Fax: +86-755-8427 6832

Email & Skype: info@chipsmall.com Web: www.chipsmall.com

Address: A1208, Overseas Decoration Building, #122 Zhenhua RD., Futian, Shenzhen, China



THIS DRAWING IS A CONTROLLED DOCUMENT FOR SOURIAU USA, INC. IT IS SUBJECT TO CHANGE WITHOUT NOTIFICATION. CONTACT THE DOCUMENT CONTROL CENTER FOR THE LATEST REVISION.

BOEING PART NO., SOURIAU CATALOG NO., CAGE NO., DATE CODE, AND PART NAME, INK STAMPED COLOR BLACK AS ILLUSTRATED. SEE TABLE 1-1

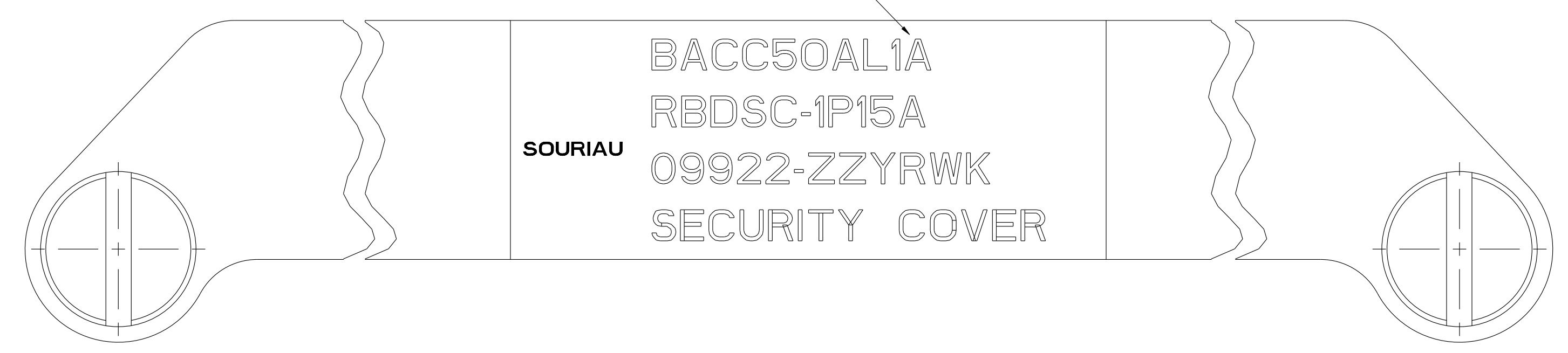

BACC50AL1A  
RBDSC-1P15A  
SOURIAU  
09922-ZZYRWK  
SECURITY COVER

SWITCH COMPARTMENT SECURITY COVER PLATE RBDSC-1P15A SHOWN (.024 [0.61] THICK STAINLESS STEEL) WITH MOUNTING SCREWS.

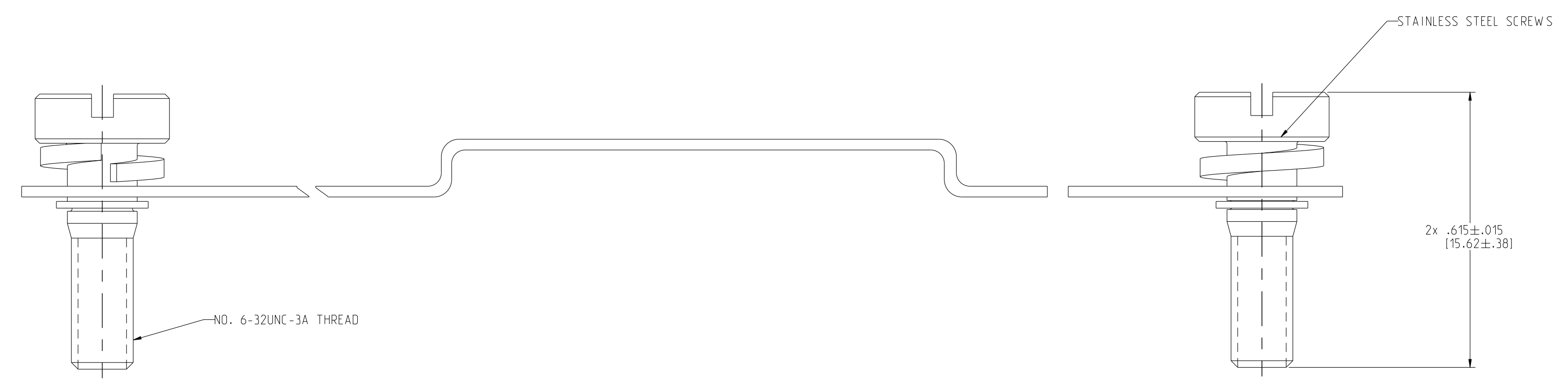

STAINLESS STEEL SCREWS

2x .615±.015  
[15.62±.38]

NO. 6-32UNC-3A THREAD

PLATE SCREWS, AND RETAINING RINGS ASSEMBLED RBDSC-1P15A SHOWN

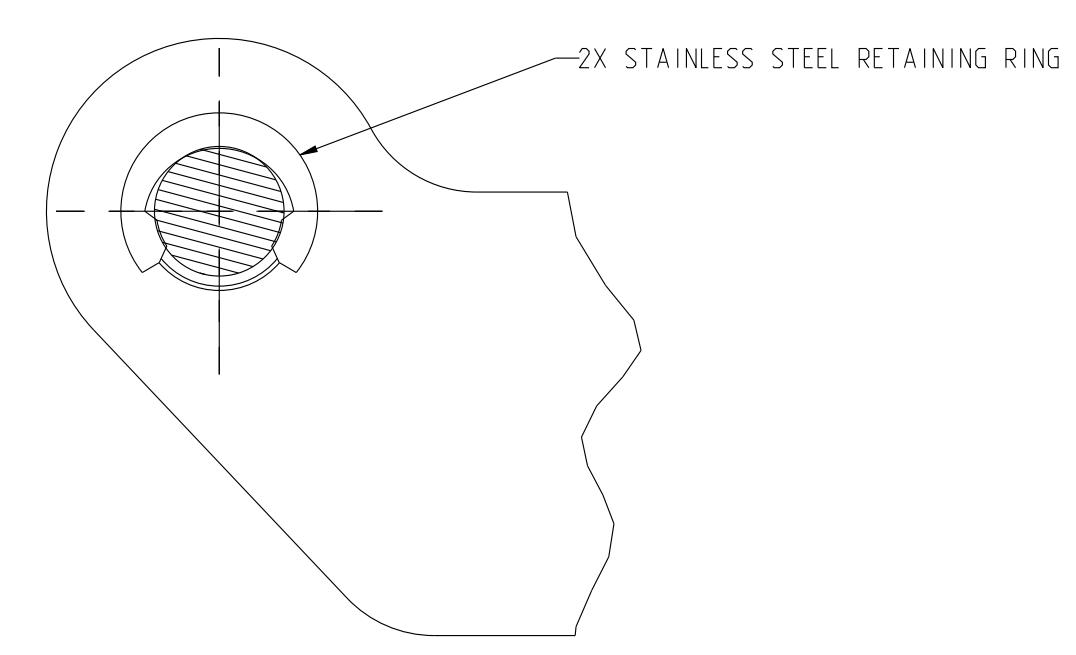

2X STAINLESS STEEL RETAINING RING

| TABLE 1-1  |       |
|------------|-------|
| COVER      | SCREW |
| RBDSC-1P15 | X     |

A- WITH LOCK WASHERS (BACC50AL1A)  
BASIC COVER WITH SCREWS (BACC50AL1)

TO INSTALL SECURITY COVER PLATE:

1. FASTEN PROGRAM SWITCH MODULE IN PLACE USING (2) SECURITY COVER/MODULE MOUNTING STUDS AND (2) ELASTIC LOCK NUTS (PURCHASED SEPARATELY)
2. THREAD SCREWS INTO UPPER END OF MOUNTING STUDS, TURN EQUALLY TO MAINTAIN SECURITY COVER PLATE LEVEL WITH SEALING PLUGS.
3. TIGHTEN SCREWS EQUALLY TO BUTT COVER PLATE ON SEALING PLUGS. CONTINUE TO TIGHTEN UNTIL COVER PLATE BOTTOMS FIRMLY ON UPPER END OF MOUNTING STUD.

TO ACCESS DIP SWITCHES:

1. LOOSEN ONE SCREW COUNTERCLOCKWISE 2 TURNS. REMOVE THE OTHER SCREW.
2. SWING THE SECURITY COVER PLATE TO UNCOVER THE SEALING PLUGS. PULL PLUGS TO ACCESS SWITCHES.

NOTES: UNLESS OTHERWISE SPECIFIED

1. PROGRAM SWITCH MODULE WITH SEALING PLUGS PURCHASED SEPARATELY. SEE DRAWING BRSD95231 FOR DETAILS.
  2. SWITCH MOUNTING STUD PURCHASED SEPARATELY. SEE DRAWING SC95769 FOR DETAILS.
  3. SECURITY COVER ASSEMBLIES ARE PACKAGED ONE ASSEMBLY PER BAG.
- FEATURES:
1. THE COVER PLATE APPLIES DOWNWARD PRESSURE ON THE SEALING PLUGS, HOLDING THEM IN THE SEALED POSITION.
  2. THE SECURITY COVER SYSTEM DOES NOT INCREASE THE OVERALL LENGTH, HEIGHT OR WIDTH OF THE PROGRAM SWITCH MODULE.
  3. ALL COMPONENTS ARE SECURED WHILE SETTING SWITCHES. NO DROPPED OR MISPLACED PARTS.

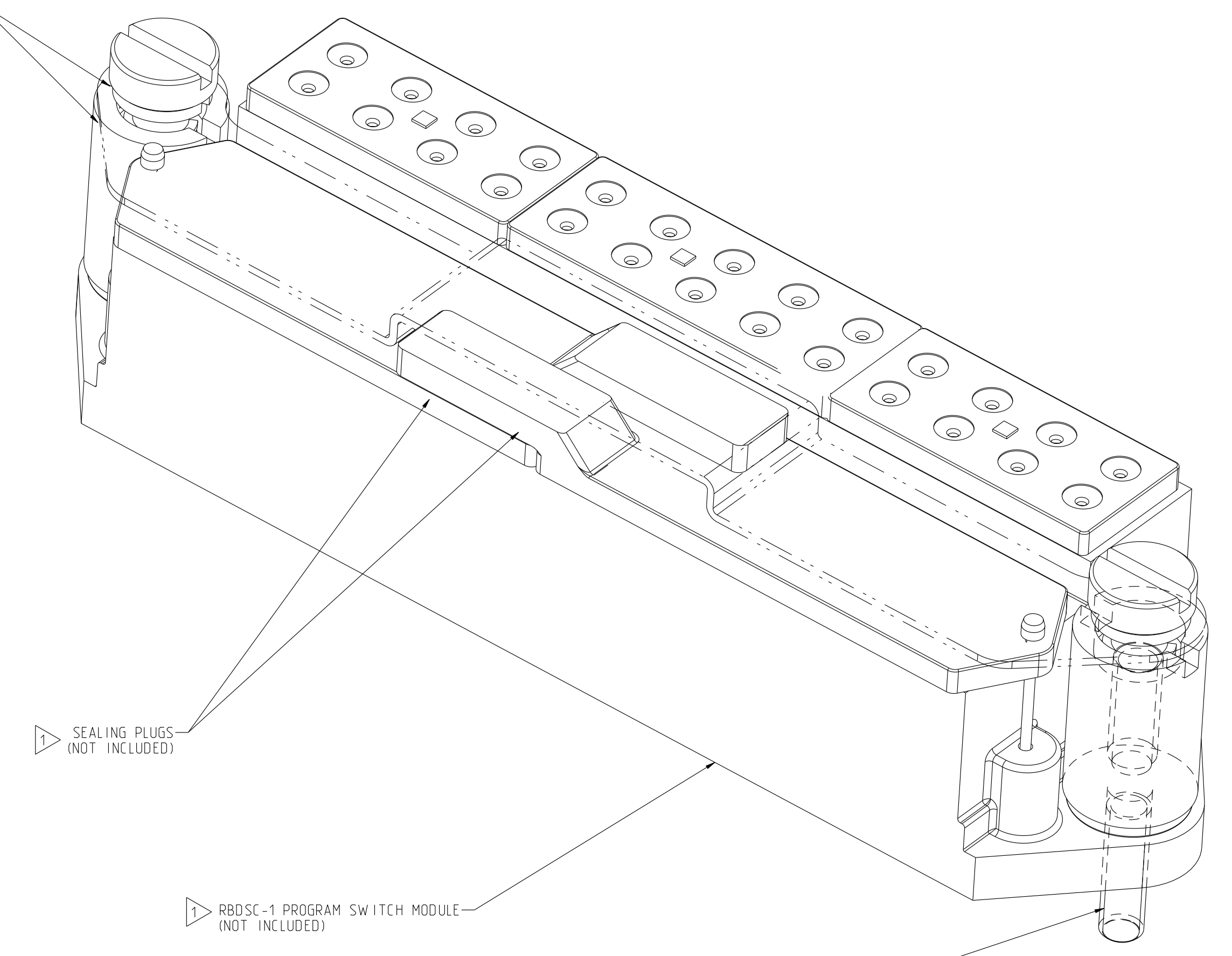

1 SEALING PLUGS (NOT INCLUDED)

1 RBDSC-1 PROGRAM SWITCH MODULE (NOT INCLUDED)

2 RBDSC-1P12 OR RBDSC-2P12 SECURITY COVER/MODULE MOUNTING STUD (NOT INCLUDED)

SECURITY COVER INSTALLED ON PROGRAM SWITCH MODULE  
SCALE: NONE

| REV | DESCRIPTION  | DATE     | BY  | CHKD | DATE     |
|-----|--|----------|-----|------|----------|
| K   | REVISED PER ECN 12046  | 08-22-13 | RSK | SDH  | 08-22-13 |
| J   | REVISED PER ECN10531   | 04-28-08 | RWD | SDH  | 04-28-08 |
| I   | REVISED PER ECN10405   | 01-23-08 | LY  | SDH  | 01-23-08 |
| H   | REVISED PER ECN10307   | 10-12-07 | SDH | SDH  | 10-12-07 |
| G   | REVISED PER ECN8399  | 07-27-04 | SDH | SDH  | 07-27-04 |
| F   | REVISED PER ECN4792  | 09-17-01 | RD  | SDH  | 09-17-01 |
| 5   | ADDED CAT NO. RBDSC-2P12 TO THE NOTE IN FIELD OF DRAWING. (ECN 3234) | 03-06-95 | RPS | CWL  | 03-06-95 |
| 4   | CHANGED SCREW THREAD FROM 6-32 UNC-2A TO 6-32 UNC-3A. (ECN 3061)     | 08-04-94 | CWL | CCP  | 08-04-94 |
| 3   | REPOSITIONED INK STAMP ON UNDERSIDE OF COVER PLATE. (ECN 15008)      | 03-11-94 | CCP | CCP  | 03-11-94 |
| 2   | SEE REV REF PRINT. (ECN 15005)                                       | 03-02-94 | CCP | CCP  | 03-02-94 |
| 1   | SEE REV REF PRINT. (ECN 2378)  | 10-28-93 | DLB | VEE  | 10-28-93 |

|                                       |                           |
|---------------------------------------|---------------------------|
| LINEAR MEASURE:                       | $\frac{NCH}{mm}$ NCH (mm) |
| THIRD ANGLE PROJECTION                |                           |
| TOLERANCES UNLESS OTHERWISE SPECIFIED |                           |
| ONE PLACE                             | ±.1 [±.3]                 |
| TWO PLACES                            | ±.02 [±0.5]               |
| THREE PLACES                          | ±.010 [±0.25]             |
| ANGLES                                | ±1°                       |

DRAWING TITLE  
**SECURITY COVER - PROGRAM SWITCH MODULE**

CAT NO.: RBDSC-1P15 (SEE TABLE 1-1)  
CAGE NO: 09922 SIZE: D

CUSTOMER: **SOURIAU**

INTERPRET THIS DRAWING IN ACCORDANCE WITH ASME Y14.5M - 1994.

www.souriau.com

DRAWN: LY 01.21.08  
CHKD: SDH 01.21.08  
DSGN: SDH 09.14.93  
MFG: NV 09.14.93  
QC: SJ 09.14.93  
DRAWING SCALE: 5:1  
DRAWING NO.: REV  
SE95607 K  
1 OF 1