



Chipsmall Limited consists of a professional team with an average of over 10 year of expertise in the distribution of electronic components. Based in Hongkong, we have already established firm and mutual-benefit business relationships with customers from,Europe,America and south Asia,supplying obsolete and hard-to-find components to meet their specific needs.

With the principle of “Quality Parts,Customers Priority,Honest Operation,and Considerate Service”,our business mainly focus on the distribution of electronic components. Line cards we deal with include Microchip,ALPS,ROHM,Xilinx,Pulse,ON,Everlight and Freescale. Main products comprise IC,Modules,Potentiometer,IC Socket,Relay,Connector.Our parts cover such applications as commercial,industrial, and automotives areas.

We are looking forward to setting up business relationship with you and hope to provide you with the best service and solution. Let us make a better world for our industry!



Contact us

Tel: +86-755-8981 8866 Fax: +86-755-8427 6832

Email & Skype: info@chipsmall.com Web: www.chipsmall.com

Address: A1208, Overseas Decoration Building, #122 Zhenhua RD., Futian, Shenzhen, China



PART NO.	"d2"	"h1"	"d1" NOMINAL DIA.	"h2" ±.039 (±1)	"D"	"d3"
RGS1-60466	.343 (8.7)	.063 (1.6)	.201 (5.1)	1.654 (42.0)	.559 (14.2)	.280 (7.1)

AVAILABLE BY SPECIAL ORDER.

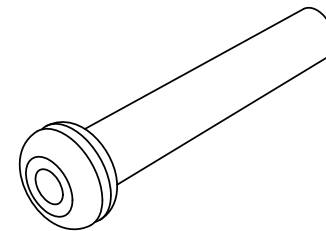
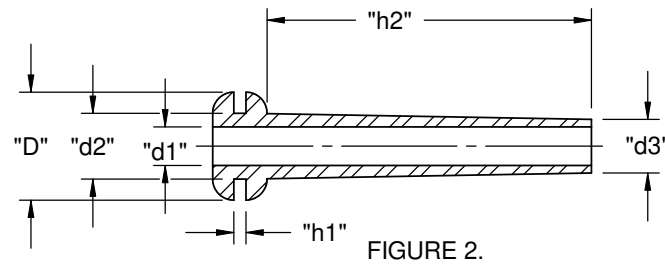

NOTES:
 1. MATERIAL: PVC (RMS-25)
 2. COLOR: BLACK

REV.			TITLE: RICHCO GROMMET SLEEVE - TYPE 1			DWG IN IN [MM]		FINAL		PRINT TYPE		
F	SEE CO 200609 FOR CHANGES	SK 12.16.10	CREATED USING SOLIDWORKS TOLERANCES UNLESS NOTED .XX=±.020 .XXX=±.015 FRAC.=±1/32 ANG.=±1°			FILE #: RGS1	DWN: S.J.	APP:	PART # SEE TABLE		CA	
E	SEE CO 200604 FOR CHANGES	SK 12.01.10				SHEET: 1 OF 1	SHEET SIZE: A	DT: 07.15.02				CHKD:
D	CHANGED TOL ON "h2" DIMENSION, CO 200538	SK 06/10/10				RE: RICHCO, INC.		RICHCO, INC. ENG@RICHCO-INC.COM (773) 539-4060				
C	SEE ECN #1242 FOR CHANGES	SK 10/31/06										
B	SEE ECN #606 FOR CHANGES	SM 03.31.03										
A	SEE ECN #541 FOR CHANGES	SM 12.12.02										
REV.	DESCRIPTION	ENGR. DATE										