



Chipsmall Limited consists of a professional team with an average of over 10 year of expertise in the distribution of electronic components. Based in Hongkong, we have already established firm and mutual-benefit business relationships with customers from,Europe,America and south Asia,supplying obsolete and hard-to-find components to meet their specific needs.

With the principle of “Quality Parts,Customers Priority,Honest Operation,and Considerate Service”,our business mainly focus on the distribution of electronic components. Line cards we deal with include Microchip,ALPS,ROHM,Xilinx,Pulse,ON,Everlight and Freescale. Main products comprise IC,Modules,Potentiometer,IC Socket,Relay,Connector.Our parts cover such applications as commercial,industrial, and automotives areas.

We are looking forward to setting up business relationship with you and hope to provide you with the best service and solution. Let us make a better world for our industry!



Contact us

Tel: +86-755-8981 8866 Fax: +86-755-8427 6832

Email & Skype: info@chipsmall.com Web: www.chipsmall.com

Address: A1208, Overseas Decoration Building, #122 Zhenhua RD., Futian, Shenzhen, China



REVISIONS				
SYM	ZONE	ECN, ERN NO.	DATE	APPRD.
A		PROPOSAL	Mar.29/06	L.CHAN

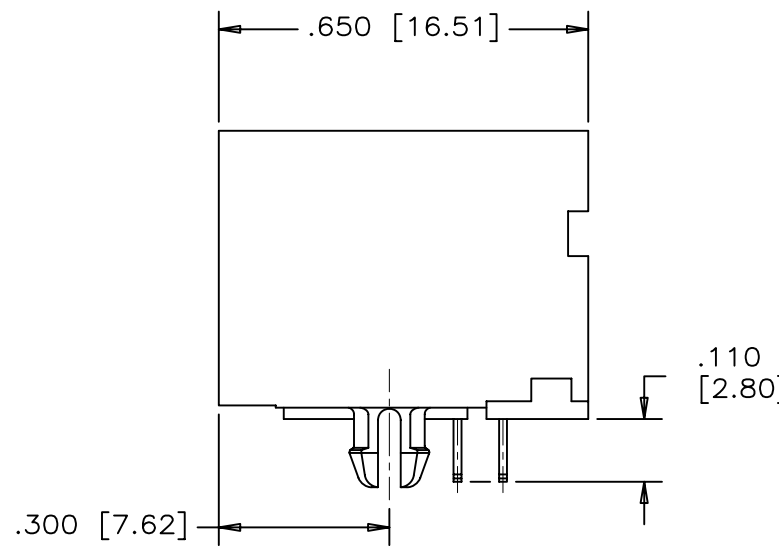
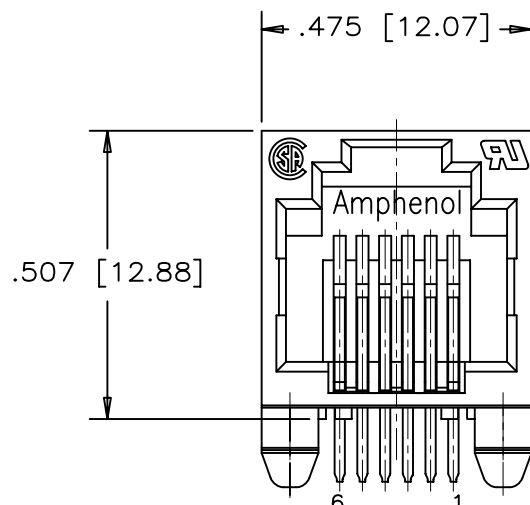

MATERIALS:

PLASTIC HOUSING: HIGH TEMPERATURE RESISTANT NYLON
UL FLAMMABILITY RATING 94V-0.
INFRA-RED OVEN COMPATIBLE

CONTACTS: PHOSPHOR BRONZE

CONTACT PLATING: 50 MICROINCHES [1.27 MICRONS] MINIMUM NICKEL.
50 MICROINCHES [1.27 MICRONS] MINIMUM GOLD
ON MATING SURFACES
100 MICROINCHES [2.54 MICRONS] MATTE TIN
ON CONTACT TAILS.

RECOMMENDED SOLDERING TEMPERATURE:
WAVE SOLDERING OR REFLOW SOLDERING AT 260°C
MAXIMUM FOR 5 SEC MAXIMUM.

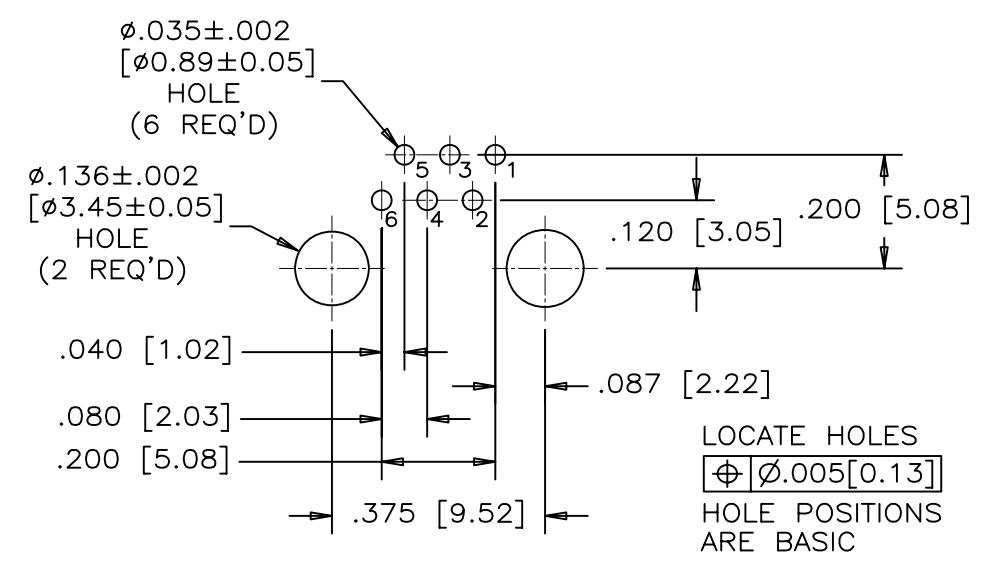

RECOMMENDED P.C.B. LAYOUT
(COMPONENT SIDE OF BOARD)

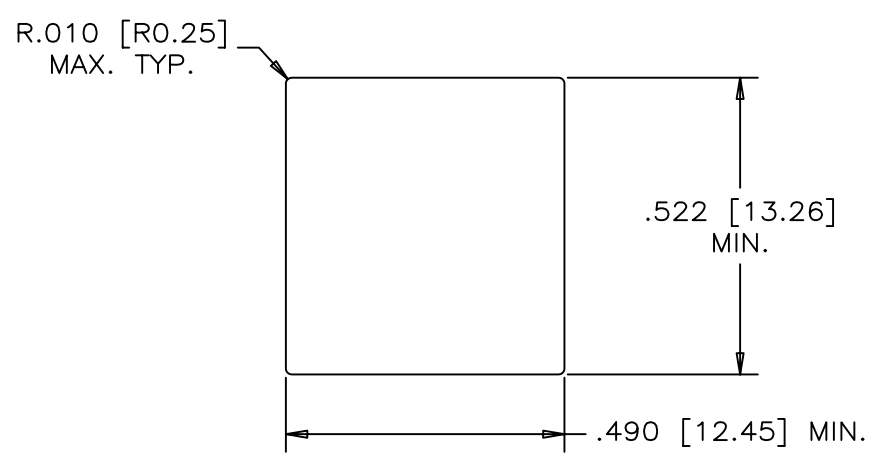

RECOMMENDED PANEL CUTOUT

PART NUMBER: RJE01-6X0-01

CONTACT QTY.
2=2 CONTACTS
4=4 CONTACTS
6=6 CONTACTS

DRAWN PAUL WANG	DATE 06/03/29	Amphenol Canada Corp.		
DESIGNED				
CHECKED CHIGOW	DATE 06/03/29	TITLE HIGH SPEED MODULAR JACK,1 PORT, 6 POSITIONS,OPTIONAL CONTACTS, WITHOUT SHIELD - RoHS COMPLIANT		
I. E. APPRD.				
Q. A. APPRD.		DWG C	DRAWING NO. P-RJE01-6X0-01	REV. A
DWG. APPRD.		SCALE		
ENG. REL. NO.		WT. -----	SURF. -----	SHEET 1 OF 1
REF.		CODE ID. NO. 03554		

THIS DOCUMENT CONTAINS PROPRIETARY INFORMATION AND SUCH INFORMATION MAY NOT BE DISCLOSED TO OTHERS FOR ANY PURPOSE OR USED FOR MANUFACTURING PURPOSES WITHOUT WRITTEN PERMISSION FROM AMPHENOL CANADA CORP.