



Chipsmall Limited consists of a professional team with an average of over 10 year of expertise in the distribution of electronic components. Based in Hongkong, we have already established firm and mutual-benefit business relationships with customers from,Europe,America and south Asia,supplying obsolete and hard-to-find components to meet their specific needs.

With the principle of “Quality Parts,Customers Priority,Honest Operation,and Considerate Service”,our business mainly focus on the distribution of electronic components. Line cards we deal with include Microchip,ALPS,ROHM,Xilinx,Pulse,ON,Everlight and Freescale. Main products comprise IC,Modules,Potentiometer,IC Socket,Relay,Connector.Our parts cover such applications as commercial,industrial, and automotives areas.

We are looking forward to setting up business relationship with you and hope to provide you with the best service and solution. Let us make a better world for our industry!



Contact us

Tel: +86-755-8981 8866 Fax: +86-755-8427 6832

Email & Skype: info@chipsmall.com Web: www.chipsmall.com

Address: A1208, Overseas Decoration Building, #122 Zhenhua RD., Futian, Shenzhen, China



Now you're connected!

About Amphenol Commercial Products

Amphenol's commercial connector products are used in a variety of end user applications including networking, telecom, server & computer, storage & HDD, consumer electronics and entertainment, professional audio & Industrial & Military/Aerospace.

Related Products

RJSSE



P/N RJSSE-5381 SHOWN
SINGLE PORT, 8 POSITION,
WITH SHIELD AND LIGHT PIPE

RJHSE



P/N RJHSE-3081 SHOWN
SINGLE PORT VERTICAL MOUNT,
NO SHIELD, WITH LEDs

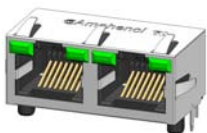

P/N RJHSE-5385-02 SHOWN
TWO PORT REGULAR MOUNT,
WITH SHIELD AND LEDs

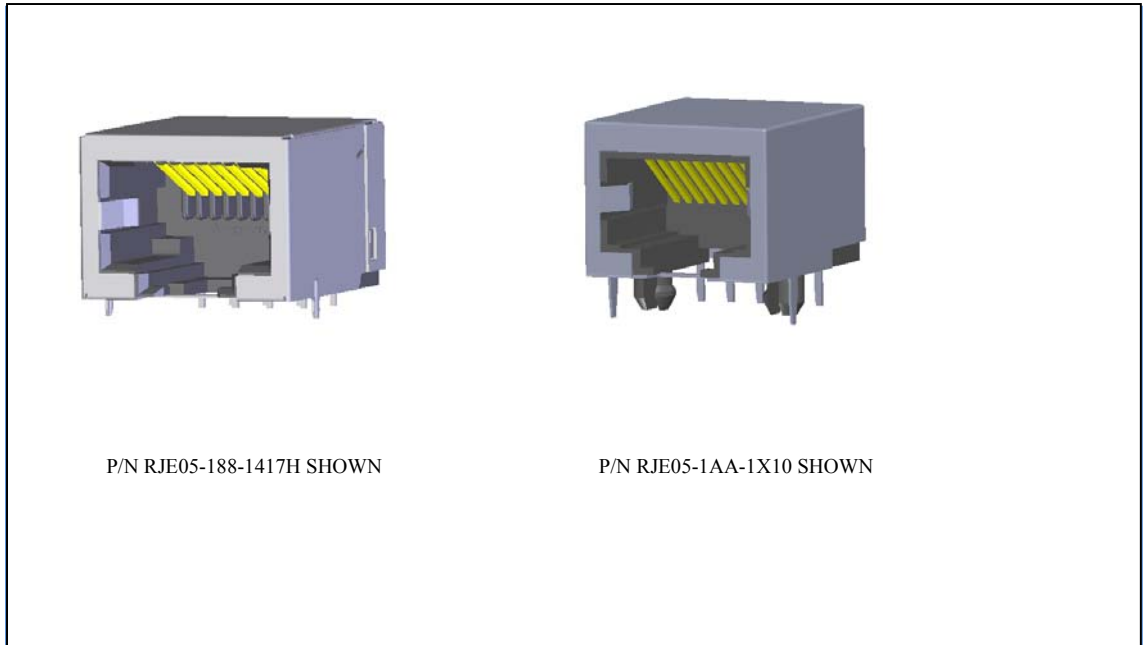

Overview

This product specification defines the general use and performance parameters for Amphenol's RJE05 series of modular jacks.

Availability: Single port available with shielding options.

Usage

The RJE05 series of modular jacks supports Ethernet Protocols. Shielding available for increased EMI performance and LEDs for Link Activity and Network Speed verification.

Applications

Intended for use in applications such as:
Networking & Telecom

- Wireless (WiMAX)
- Network servers
- Hubs, routers, switches

Office & Home Equipment

- PC's, Laptops, Copiers/Printers
- Telephones, modems
- Surge Protectors
- ATMs, Vending Machines

- Security Systems
- Set Top Boxes
- Video Game Systems

Miscellaneous

- Multi-Media Equipment
- Industrial Equipment
- POS Terminals

Now you're connected!

About Amphenol Commercial Products

Amphenol's commercial connector products are used in a variety of end user applications including networking, telecom, server & computer, storage & HDD, consumer electronics and entertainment, professional audio & Industrial & Military/Aerospace.

Related Products

RJLE

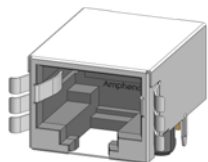

P/N RJLE-4X182-01 SHOWN
SINGLE PORT REGULAR MOUNT,
STANDARD SHIELD WITH SMT

FRJAE



P/N FRJAE-418 SHOWN
SINGLE PORT, 8 POSITION,
WITH FERRITE FILTER AND
SHIELD (FRONT TABS)

RJLSE

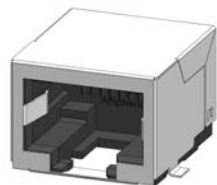

P/N RJLSE-41181-01 SHOWN
SINGLE PORT REGULAR MOUNT,
STANDARD SHIELD WITH SMT

Electrical Characteristics

| | |
|------------------------|--|
| Contact resistance: | 20 mΩ max. |
| Insulation resistance: | 500 MΩ minimum at 500V DC for 2 minutes max. |
| Current rating: | 1.5 Amps |
| Voltage rating: | 125 Volts AC |
| DWV | 1000 VAC, 60 Hz. 1 min. |

Mechanical Characteristics

Mating connector insertion force: 5.0 lbs. Maximum.
Mating connector pull retention force: 20 lbs Minimum.
Durability: 750 mating & unmating cycles
Recommended soldering temperature: Wave soldering peaked at 260° C for 5 seconds maximum.
Connectors with high temp. material are suitable for IR Reflow

Operating temperature: -40° C to +85° C

Material Requirements

RJE05 connectors are RoHS compliant.

Unless otherwise specified, the materials for each component shall be:

Insulator:

- Engineering thermoplastic. Complies with UL 94V-0, Black color.

Contacts:

- Phosphor Bronze hard temper with gold thickness options (6μ", 15μ", 30μ", 50μ") over S50μ" minimum Nickel on contact mating area.
- 100μ" minimum matte tin plating on soldering tail

Shield:

- Copper alloy, Nickel plated with tin dipped tail.

Available Documents

Drawing Numbers:

| | |
|-------------------|---|
| P-RJE05-166-1417H | Single port modular jack, shielded, 6 position, 6 contacts. |
| P-RJE05-188-1417H | Single port modular jack, shielded, 8 position, 8 contacts. |
| P-RJE05-166-0X10 | Single port modular jack, 6 position, 6 contacts. |
| P-RJE05-188-1X10 | Single port modular jack, shielded, 8 position, 8 contacts. |
| P-RJE05-1AA-1X10 | Single port modular jack, shielded, 10 position, 10 contacts. |

Contact factory or Authorized Amphenol representative for additional configurations