



Chipsmall Limited consists of a professional team with an average of over 10 year of expertise in the distribution of electronic components. Based in Hongkong, we have already established firm and mutual-benefit business relationships with customers from,Europe,America and south Asia,supplying obsolete and hard-to-find components to meet their specific needs.

With the principle of “Quality Parts,Customers Priority,Honest Operation,and Considerate Service”,our business mainly focus on the distribution of electronic components. Line cards we deal with include Microchip,ALPS,ROHM,Xilinx,Pulse,ON,Everlight and Freescale. Main products comprise IC,Modules,Potentiometer,IC Socket,Relay,Connector.Our parts cover such applications as commercial,industrial, and automotives areas.

We are looking forward to setting up business relationship with you and hope to provide you with the best service and solution. Let us make a better world for our industry!



## Contact us

Tel: +86-755-8981 8866 Fax: +86-755-8427 6832

Email & Skype: info@chipsmall.com Web: www.chipsmall.com

Address: A1208, Overseas Decoration Building, #122 Zhenhua RD., Futian, Shenzhen, China



REVISIONS			
REV	DESCRIPTION, ECN, EAR NO.	DATE	APP'D
A	PROPOSAL DRAWING	MAR25/14	L.CHAN

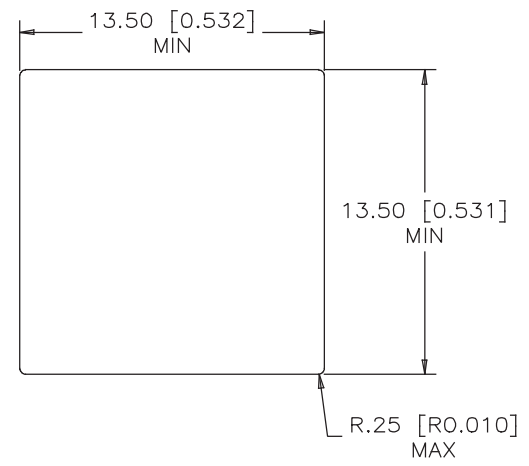
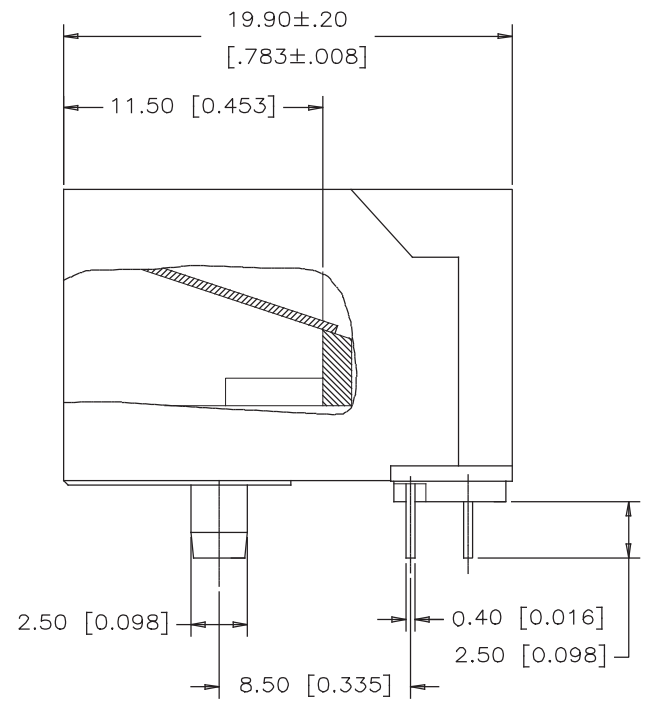
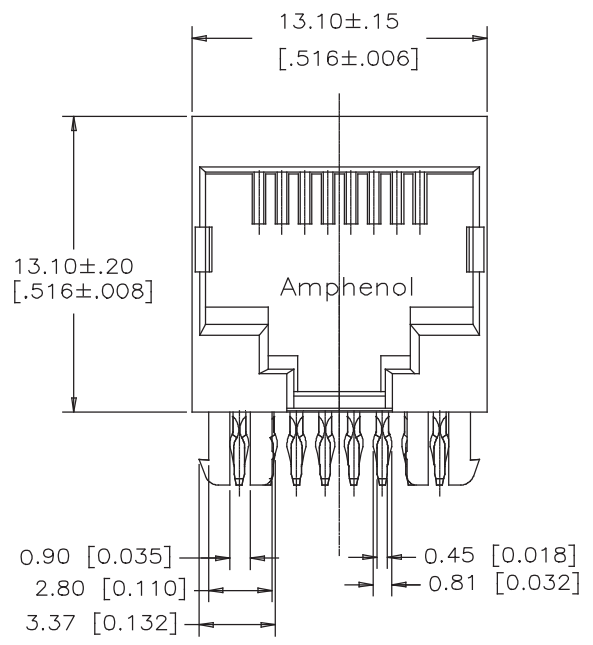

RECOMMENDED PANEL CUTOUT

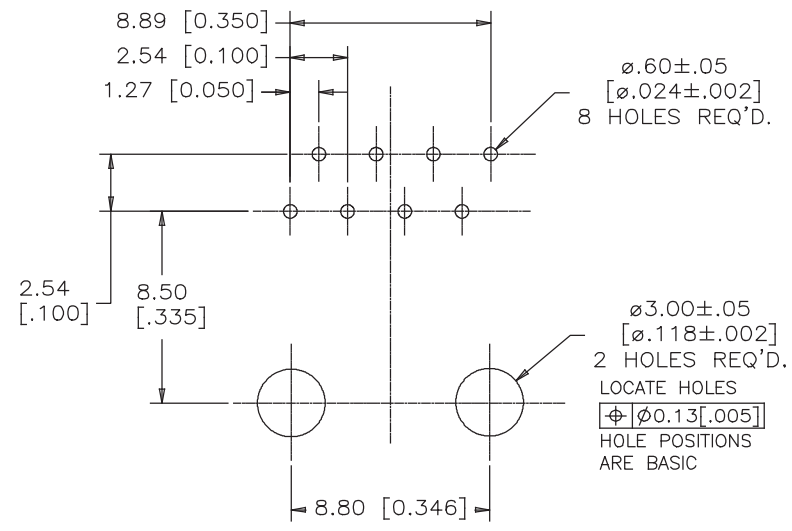

RECOMMENDED P.C.B LAYOUT  
(COMPONENT SIDE OF BOARD)  
TOLERANCES: +/-.05[.002]



1. MATERIALS:

PLASTIC HOUSING: ENGINEERING THERMOPLASTIC  
FLAMMABILITY RATING UL94V-0  
COLOR: BLACK

CONTACTS: PHOSPHOR BRONZE  
PLATING: 50 μ" [1.27 MICRONS] MIN. GOLD PLATE  
ON MATING SURFACE  
50 μ" [1.27 MICRONS] MIN. NICKEL UNDERPLATE.  
100 μ" [2.54 MICRONS] MIN. MATTE TIN  
ON CONTACT TAILS.

2. THE REMOVAL FORCE OF PRESS FIT CONTACT SHOULD BE  
IN RANGE OF 10N PER PIN.

UNLESS SPECIFIED OTHERWISE	DRAWN	J.FENG	MAR25/14
PRIMARY UNITS MILLIMETERS	CHECKED	L.CHAN	MAR25/14
SECONDARY INCH	M.E. APP'D		
REFERENCE IN PARENTHESES	Q.A. APP'D		
GENERAL TOLERANCES IN MM	DWG APP'D	L.CHAN	MAR25/14
1 DECIMAL PLACE ±0.38	ENG. REL. NO.		
2 DECIMAL PLACES ±0.25	REF.		
3 DECIMAL PLACES	THIRD ANGLE PROJECTION		
ANGULAR DEGREES ±1.5°	DO NOT SCALE DRAWING		

Amphenol Canada Corp.			
TITLE			
RJE56 SERIES, 8 POSITION, 8 CONTACTS, RoHS COMPLIANT			
DWG NO.			REV
P-RJE56-188-0410			A
CODE ID NO. 03554	DWG SIZE C	SCALE N/A	SHEET 1 OF 2

REVISIONS			
REV	DESCRIPTION, ECN, EAR NO.	DATE	APP'D
A	PROPOSAL DRAWING	MAR25/14	L.CHAN

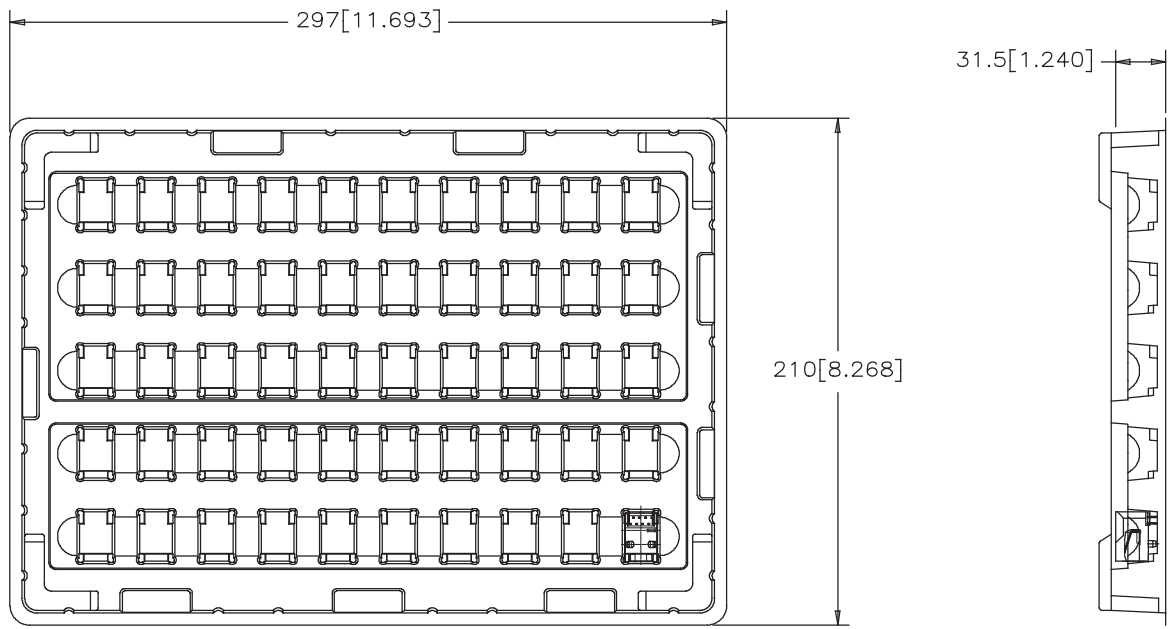

PACKAGING NOTES:

1. ONE TRAY SHOULD HOLD 50 CONNECTORS.
2. A FULLY LOADED CARTON SHOULD CONTAIN 10 TRAY (500 PCS) OF CONNECTORS.

UNLESS SPECIFIED OTHERWISE	DRAWN	J.FENG	MAR25/14	Amphenol Canada Corp.
PRIMARY UNITS MILLIMETERS	CHECKED	L.CHAN	MAR25/14	
SECONDARY INCH	M.E. APP'D			
REFERENCE IN PARENTHESES	Q.A. APP'D			
GENERAL TOLERANCES IN MM	DWG APP'D	L.CHAN	MAR25/14	TITLE
1 DECIMAL PLACE ±0.38	ENG. REL. NO.			RJE56 SERIES, 8 POSITION, 8 CONTACTS, RoHS COMPLIANT
2 DECIMAL PLACES ±0.25	REF.			
3 DECIMAL PLACES	THIRD ANGLE PROJECTION			
ANGULAR DEGREES ±1.5°	DO NOT SCALE DRAWING			DWG NO.
				P-RJE56-188-0410
				REV
				A
				CODE ID NO. 03554   DWG SIZE C   SCALE N/A   SHEET 2 OF 2

THIS DOCUMENT CONTAINS PROPRIETARY INFORMATION AND SUCH INFORMATION MAY NOT BE DISCLOSED TO OTHERS FOR ANY PURPOSE OR USED FOR MANUFACTURING PURPOSES WITHOUT WRITTEN PERMISSION FROM AMPHENOL CANADA CORP.