



Chipsmall Limited consists of a professional team with an average of over 10 year of expertise in the distribution of electronic components. Based in Hongkong, we have already established firm and mutual-benefit business relationships with customers from,Europe,America and south Asia,supplying obsolete and hard-to-find components to meet their specific needs.

With the principle of “Quality Parts,Customers Priority,Honest Operation,and Considerate Service”,our business mainly focus on the distribution of electronic components. Line cards we deal with include Microchip,ALPS,ROHM,Xilinx,Pulse,ON,Everlight and Freescale. Main products comprise IC,Modules,Potentiometer,IC Socket,Relay,Connector.Our parts cover such applications as commercial,industrial, and automotives areas.

We are looking forward to setting up business relationship with you and hope to provide you with the best service and solution. Let us make a better world for our industry!



Contact us

Tel: +86-755-8981 8866 Fax: +86-755-8427 6832

Email & Skype: info@chipsmall.com Web: www.chipsmall.com

Address: A1208, Overseas Decoration Building, #122 Zhenhua RD., Futian, Shenzhen, China



NOTES:

- 1. CONNECTOR MATERIALS:
HOUSING: THERMOPLASTIC UL94 V-0
CONTACTS/SHIELD: COPPER ALLOY
SHIELD PLATING: NICKEL
CONTACT PLATING: SELECTIVE PLATING IN CONTACT AREA
SEE CHART FOR DETAILS
LIGHT PIPE: CLEAR POLYCARBONATE

△ LOGO, PART NUMBER AND DATE CODE LOCATED APPROX. IN THIS AREA

3. RECOMMENDED MIN PCB THICKNESS .062" (1.50MM).

△ DATUM AND BASIC DIMENSION ESTABLISHED BY CUSTOMER

△ FOR HOLE SIZE AND PLATINGS, SEE SHEET 3.

△ RECOMMENDED SMT LED MANUFACTURERS AND PN:
EVERLIGHT P/N: 18-225/R6G6C-A01/3T OR
PARALIGHT P/N: L-C185KFKGWT

7. REFER TO PRODUCT SPECIFICATION PR036-01.

DATE	REV.	ECN	APP'D BY
6-29-16	A0	10709	ADB

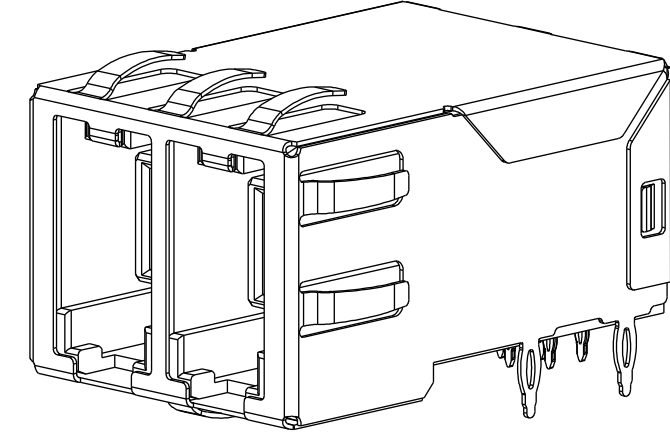
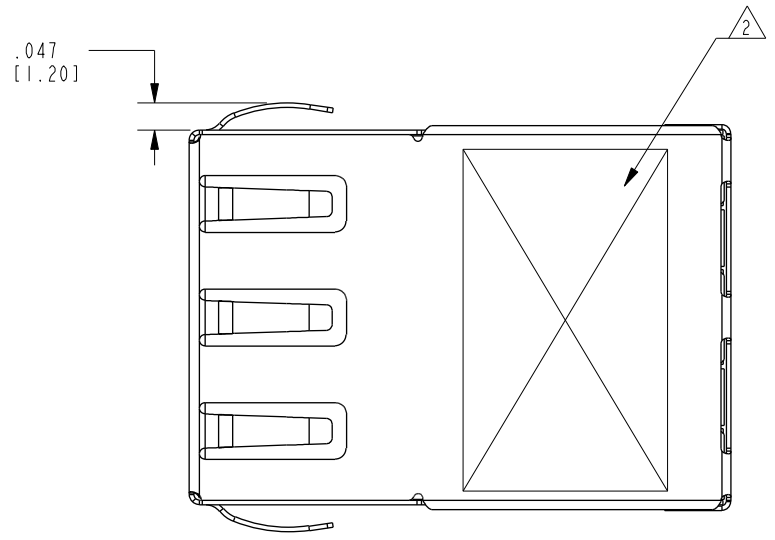

3D VIEW

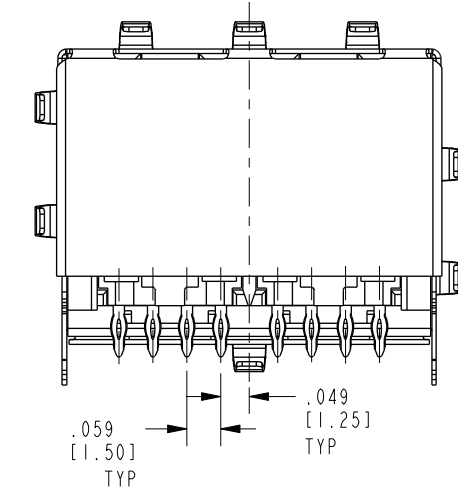
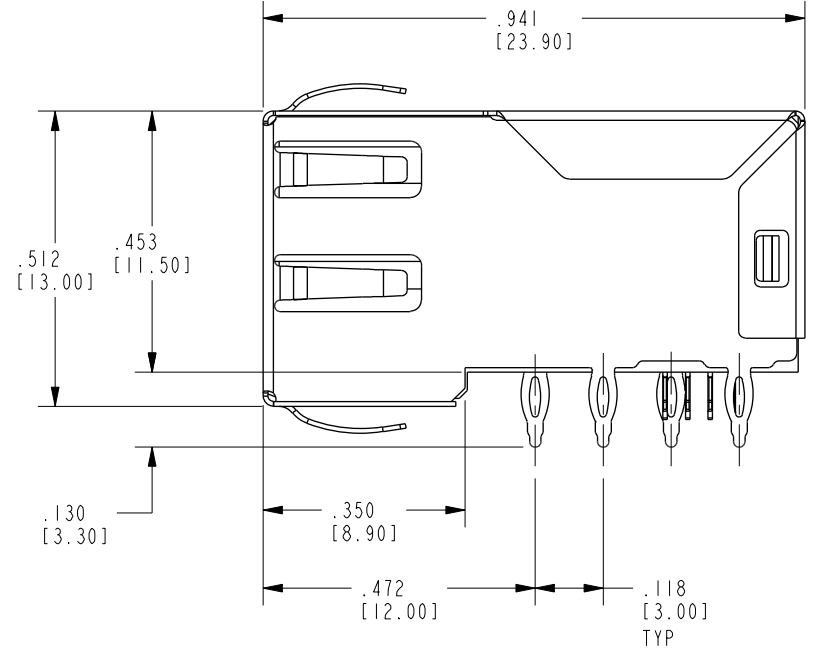
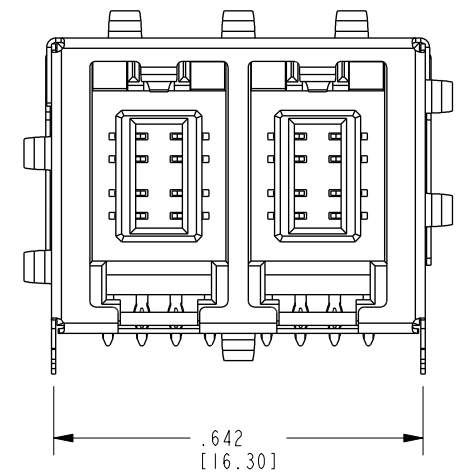

50 MICRO-INCHES [1.27um] NICKEL UNDERPLATE WITH 50 MICRO-INCHES [1.27um] Au OR WITH 5 MICRO-INCHES [0.13um] Au OVER 30 MICRO-INCHES [0.76um] PdNi	RJP5-10-0010
CONTACT PLATING IN MATING AREA	PART NUMBER

B

B

A

A

RJ POINT FIVE IS A TRADEMARK OF TE CONNECTIVITY USED HERE BY PERMISSION

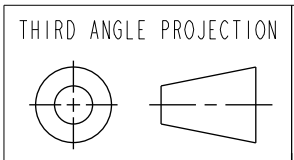

11118 Susquehanna Trail South
Glen Rock, PA 17327-9199
(717) 235-7512
<http://www.stewartconnector.com>

DO NOT SCALE DRAWING DRAWING IS SUBJECT TO CHANGE WITHOUT NOTICE	TITLE: RJ POINT FIVE, JACK, PoE+, HORIZONTAL, 1X2 PORT, TAB DOWN, SHIELDED, PG4
DIMENSIONS: INCHES [METRIC]	THIS DRAWING AND THE SUBJECT MATTER SHOWN THEREON ARE CONFIDENTIAL AND THE PROPRIETARY PROPERTY OF STEWART CONNECTOR AND SHALL NOT BE REPRODUCED, COPIED, OR USED IN ANY MANNER WITHOUT PRIOR WRITTEN CONSENT OF STEWART CONNECTOR. ONE OR MORE U.S. PATENTS MAY APPLY TO THIS PRODUCT. FOR DETAILS, PLEASE VISIT: HTTP://BELFUSE.COM/STEWART/STEWART_PATENTS/
UNLESS OTHERWISE SPECIFIED TOLERANCES ARE ±.005 [0.13] ANGLES ARE ±1°	DRN BY: RICK LI DATE 9-16-15
SHEET NO. 1 OF 3	APPD BY: ANDREW BAUM DATE 9-16-15
	DWG. NO. 2250336 REV. A0

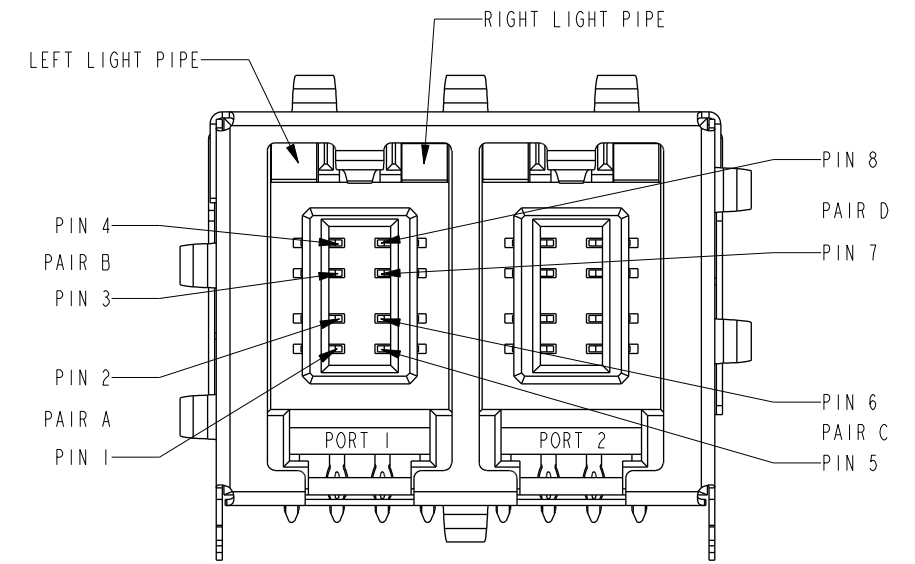
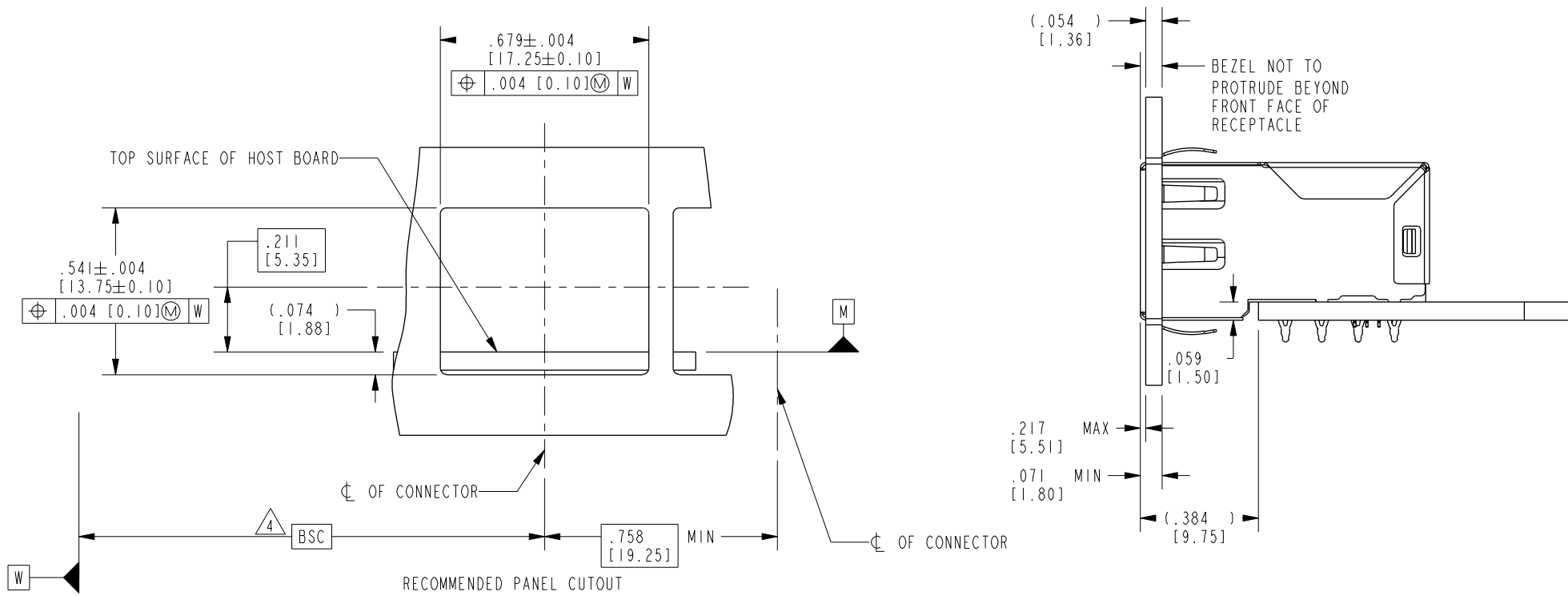

NOTE:
 SUGGESTED PANEL OPENING AND LOCATION IS INTENDED TO GIVE THE USER THE ABILITY TO HAVE REASONABLE JACK/PANEL CLEARANCES, YET MAINTAIN GROUNDING CAPABILITY. THESE VARIABLES CAN BE ADJUSTED BUT MAY RESULT IN LOWER MATING FORCES OR TIGHTER ASSEMBLY TOLERANCES.

B

B

A

A

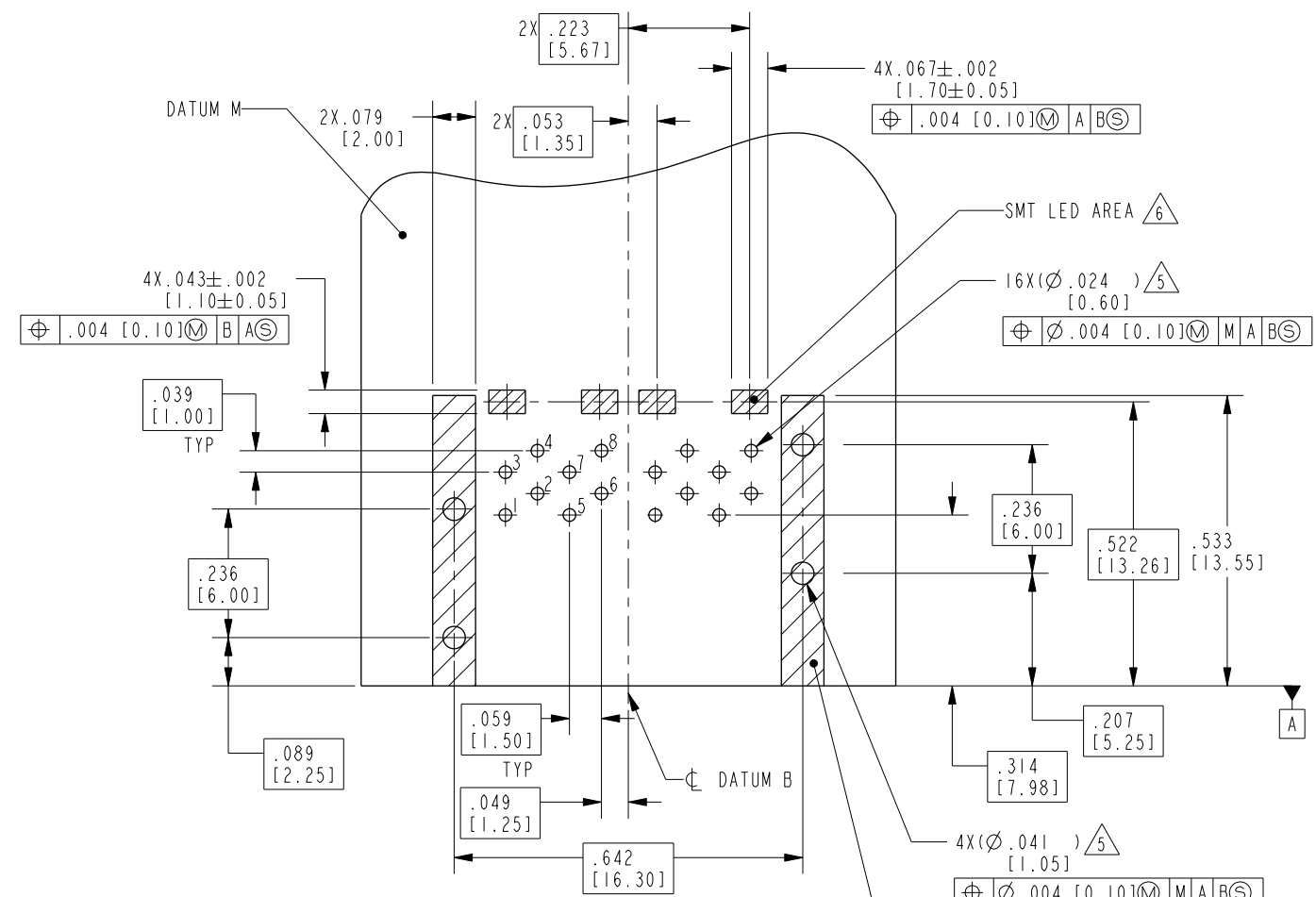

THIRD ANGLE PROJECTION	
DO NOT SCALE DRAWING	
DRAWING IS SUBJECT TO CHANGE WITHOUT NOTICE	
DIMENSIONS: INCHES [METRIC]	
UNLESS OTHERWISE SPECIFIED TOLERANCES ARE ±.005 [0.13] ANGLES ARE ±1°	
SHEET NO. 2 OF 3	

<p>11118 Susquehanna Trail South Glen Rock, PA 17327-9199 (717) 235-7512 http://www.stewartconnector.com</p>	TITLE: RJ POINT FIVE, JACK, PoE+, HORIZONTAL, 1X2 PORT, TAB DOWN, SHIELDED, PG4	
	DRN BY: RICK LI APPD BY: ANDREW BAUM DWG. NO. 2250336	DATE: 9-16-15 DATE: 9-16-15 REV. A0

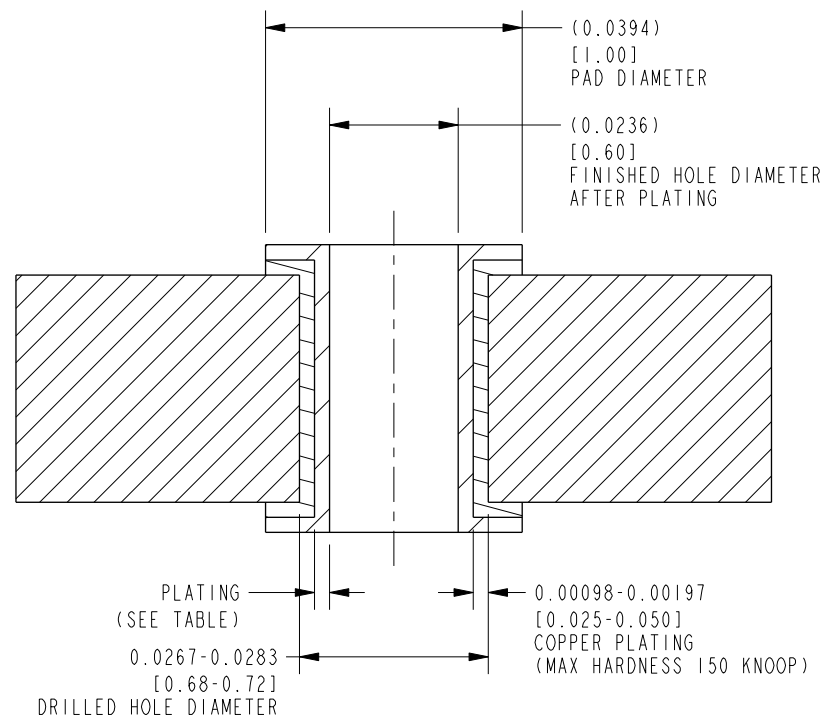

RECOMMENDED HOLE DIMENSIONS FOR SIGNAL CONTACTS

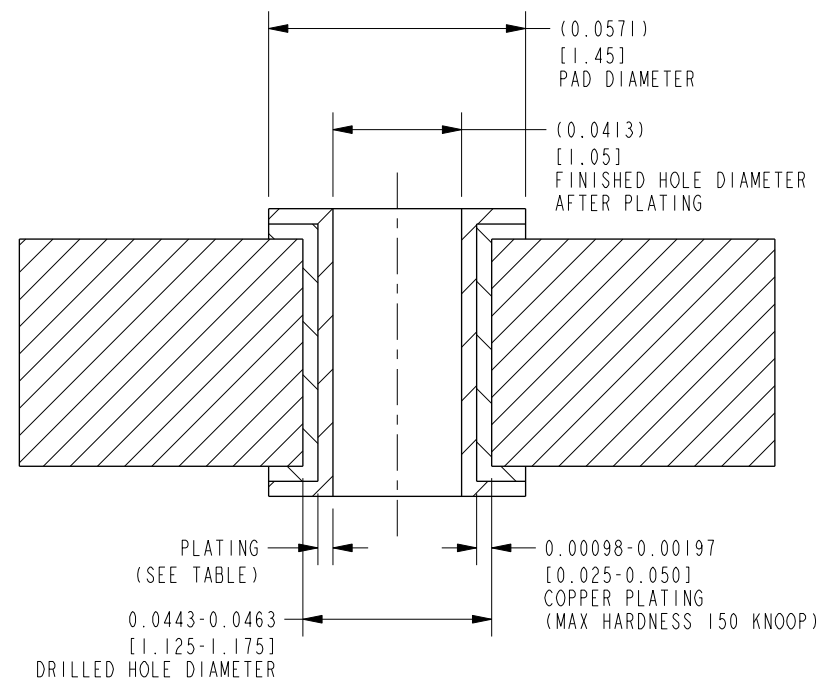

RECOMMENDED HOLE DIMENSIONS FOR SHIELD PINS

SUGGESTED HOLE CONSTRUCTION

THICKNESS (MIL INCH)	THICKNESS (MM)	PLATING
0.1575-0.3937	0.004-0.010	HOT AIR SOLDER LEVELING (HASL) TIN-LEAD (Sn Pb)
0.0197-0.0394	0.0005-0.001	IMMERSION TIN (Sn)
0.0079-0.0197	0.0002-0.0005	ORGANIC SOLDERABILITY PRESERVATIVE (OSP)
0.0039-0.0197 Au, 0.1575-0.2992 Ni	0.0001-0.0005 Au, 0.004-0.0076 Ni	IMMERSION GOLD (Au) OVER NICKEL (Ni) (ENIG)
0.3937-0.9843	0.010-0.025	TIN LEAD PLATING (Sn Pb)
0.0039-0.0059	0.0001-0.00015	IMMERSION SILVER (Ag)

THIRD ANGLE PROJECTION

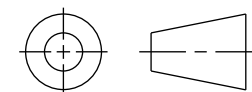

11118 Susquehanna Trail South
Glen Rock, PA 17327-9199
(717) 235-7512

<http://www.stewartconnector.com>

DO NOT SCALE DRAWING
DRAWING IS SUBJECT TO
CHANGE WITHOUT NOTICE

TITLE: RJ POINT FIVE, JACK, PoE+, HORIZONTAL,
1X2 PORT, TAB DOWN, SHIELDED, PG4

DIMENSIONS: INCHES [METRIC]
UNLESS OTHERWISE SPECIFIED
TOLERANCES ARE ±.005 [0.13]
ANGLES ARE ±1°

THIS DRAWING AND THE SUBJECT MATTER SHOWN THEREON
ARE CONFIDENTIAL AND THE PROPRIETARY PROPERTY OF
STEWART CONNECTOR AND SHALL NOT BE REPRODUCED,
COPIED, OR USED IN ANY MANNER WITHOUT PRIOR WRITTEN
CONSENT OF STEWART CONNECTOR. ONE OR MORE U.S. PATENTS
MAY APPLY TO THIS PRODUCT. FOR DETAILS, PLEASE
VISIT: [HTTP://BELFUSE.COM/STEWART/STEWART_PATENTS/](http://BELFUSE.COM/STEWART/STEWART_PATENTS/)

DRN BY: RICK LI DATE 9-16-15

APPD BY: ANDREW BAUM DATE 9-16-15

DWG. NO. 2250336 REV. A0



SHEET NO. 3 OF 3