



Chipsmall Limited consists of a professional team with an average of over 10 year of expertise in the distribution of electronic components. Based in Hongkong, we have already established firm and mutual-benefit business relationships with customers from,Europe,America and south Asia,supplying obsolete and hard-to-find components to meet their specific needs.

With the principle of “Quality Parts,Customers Priority,Honest Operation,and Considerate Service”,our business mainly focus on the distribution of electronic components. Line cards we deal with include Microchip,ALPS,ROHM,Xilinx,Pulse,ON,Everlight and Freescale. Main products comprise IC,Modules,Potentiometer,IC Socket,Relay,Connector.Our parts cover such applications as commercial,industrial, and automotives areas.

We are looking forward to setting up business relationship with you and hope to provide you with the best service and solution. Let us make a better world for our industry!



## Contact us

Tel: +86-755-8981 8866 Fax: +86-755-8427 6832

Email & Skype: info@chipsmall.com Web: www.chipsmall.com

Address: A1208, Overseas Decoration Building, #122 Zhenhua RD., Futian, Shenzhen, China



THIS DRAWING IS A CONTROLLED DOCUMENT FOR ELECTRONICS. ANY CHANGES MUST BE MADE TO THE ORIGINAL DRAWING. CONTROL COPIES SHOULD BE CONTAINED FOR THE USER'S RECORD.

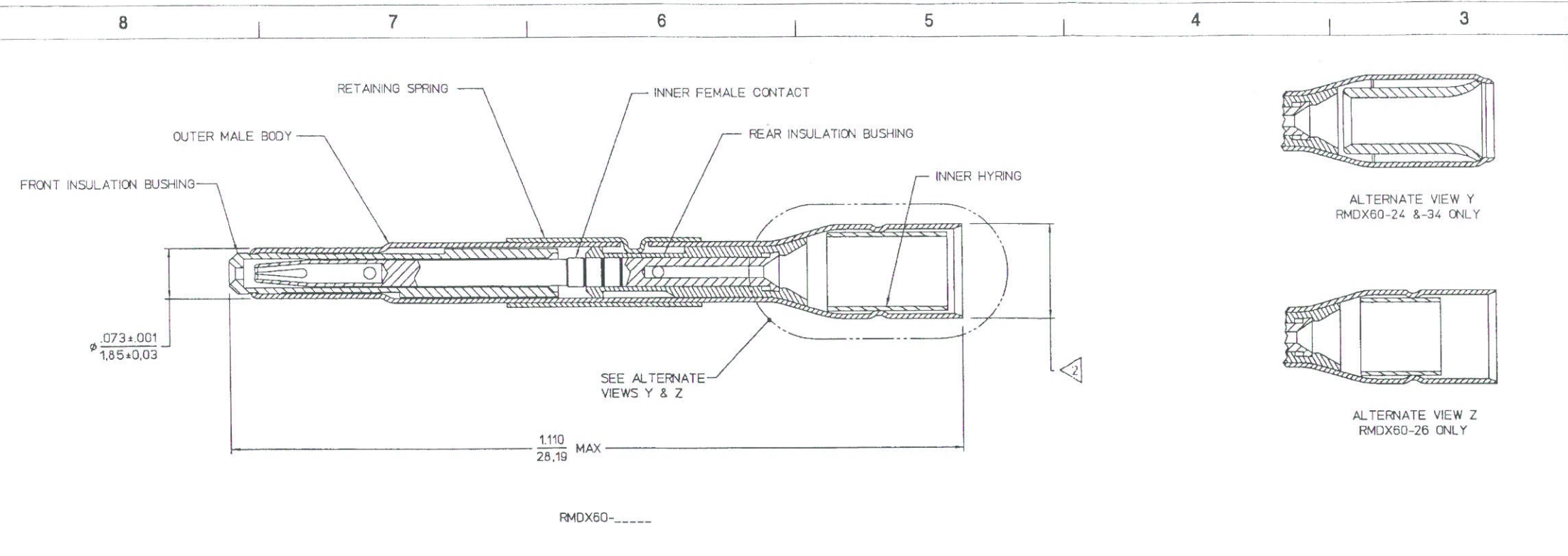

NOTES: UNLESS OTHERWISE SPECIFIED,  
 1. INTERPRET THIS DRAWING IN ACCORDANCE WITH ANSI Y14.5M-1982.

- ENGINEERING REQUIREMENTS:
- THERE SHALL BE NO ARCING OR FLASHOVER WHEN A 450 VAC(RMS) IS APPLIED BETWEEN THE INNER AND OUTER CONTACTS IN THE FOLLOWING MANNER: VOLTAGE TO INCREASE FROM 0-450 VAC AT A RATE OF 100 VOLTS PER SECOND AND THEN MAINTAINED FOR ONE MINUTE. THIS IS A DESTRUCTIVE TEST.
  - AFTER CRIMPING A TERMINATED CONTACT MUST PASS THROUGH A .1270  $^{+0.0000}_{-0.0002}$  [3.226  $^{+0.0000}_{-0.0005}$ ] DIA X .750 [19.05] THK RING GAGE WITH A 5 LB. MAX. FORCE
  - THE INNER MALE CONTACT IS TO BE RECESSED WITHIN THE OUTER FEMALE BODY A MINIMUM OF .005 [0.13] BEFORE CRIMPING AND .005 [0.13] TO .040 [1.02] AFTER CRIMPING.
  - CONTACT RETENTION AFTER 5 INSERTION AND WITHDRAWAL CYCLES SHALL BE 15 LBS. MINIMUM.
  - ORANGE PEELING DUE TO CRIMPING IS ACCEPTABLE.
  - WIRE ACCOMMODATIONS SEE SHEET 2.

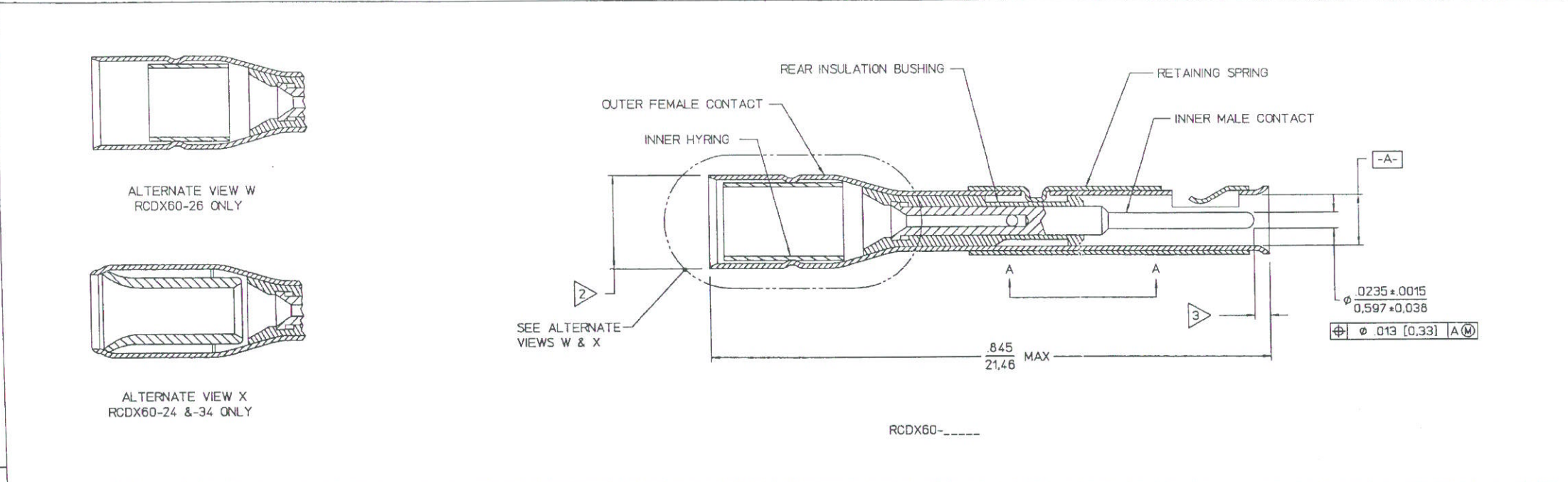

MATERIAL:  
 OUTER CONTACTS- BRASS PER FED SPEC QQ-B-626  
 INNER CONTACTS- BRASS PER FED SPEC QQ-B-626 OR BERYLLIUM COPPER PER FED SPEC QQ-C-533  
 FRONT INSULATION BUSHING- NYLON, COLOR-RED  
 REAR INSULATION BUSHING- NYLON, COLOR-NATURAL  
 RETAINING SPRING- BERYLLIUM COPPER PER FED SPEC QQ-C-533  
 INNER HYRING- BRASS PER FED SPEC QQ-B-626

FINISH:  
 CONTACTS- SEE PLATING TABLE  
 RETAINING SPRING- NICKEL PLATED  
 INNER HYRING- SOLDER PLATED

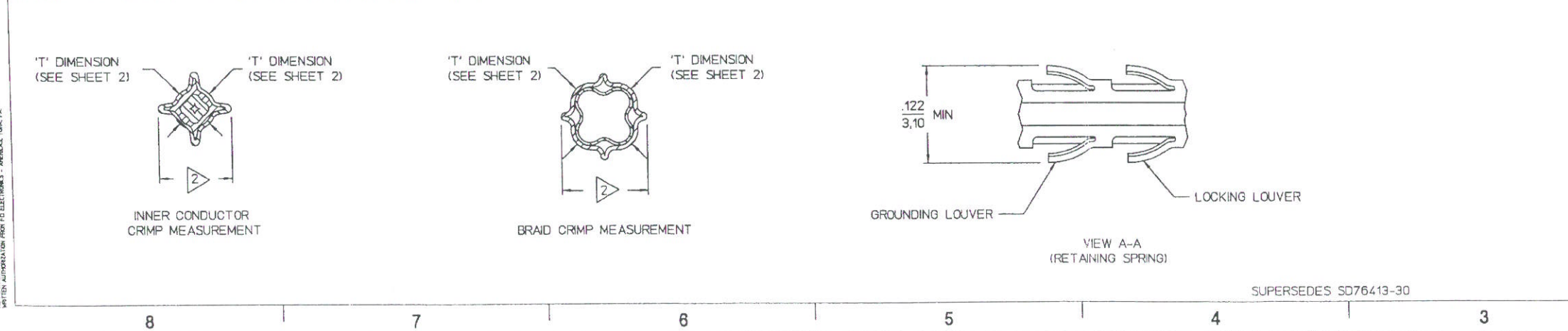

REV	DESCRIPTION	BY	DATE	CHKD	DATE	SHEET	ZONE
34	RAYCHEM 5026E1614 AWG SIZE 26 WAS 26. OUTER JACKET 083 N24 WAS 083. INNER CONDUCTOR SIZE 7/.0067 WAS 19/.0065. LUDO C15019070502 OUTER JACKET 087 WAS 083. INNER CONDUCTOR SIZE 7/.0067 WAS 19/.0065. (ECN 4382)	SAF	8-23-99	DAF	8-23-99	NO.2	ZONE
33	ADDED RAYCHEM 5026E1614 & LUDO 15013010902 CABLE PER (ECN 4355)	DAF	8-28-99	SH	8-28-99	NO.2	ZONE
32	ADDED CONN AWG SIZE 24 CA W/RAYCHEM 5024A3111.1 & DIMS. PER (ECN 3351)	SAF	7-29-99	RKS	7-29-99	NO.2	ZONE
31	REDRAWN ON E SIZE NO CHANGE (ECN3155)	NET	12-16-94	RKS	12-16-94	NO.2	ZONE

LINEAR MEASURE	INCH (mm)
THIRD ANGLE PROJECTION	

NO. OF PLACES	INCH (mm)
ONE PLACE	+1 (+.03)
TWO PLACES	+0.02 (+0.51)
THREE PLACES	+0.03 (+0.76)

  

CAT NO.	RC/RMDX60- (SEE TABLE)
ECN NO.	3158
PC #25	SIZE: D
FCI Electronics Systems Division	
DRAWING SCALE: NONE1	
DRAWING NO. REV	
SE76413 34	
SHEET 1 OF 3	

SUPERSEDES SD76413-30

THIS DRAWING IS THE PROPERTY OF FCI ELECTRONICS, INC. AND IS TO BE KEPT IN CONFIDENCE. IT IS TO BE USED ONLY FOR THE PURPOSES SPECIFIED HEREIN. ANY REPRODUCTION OR TRANSMISSION OF THIS DRAWING WITHOUT THE WRITTEN AUTHORIZATION OF FCI ELECTRONICS, INC. IS PROHIBITED.

WIRE ACCOMMODATION TABLE											INSTALLATION TOOLING DATA (USE M10S, BM10S)							
INNER CONDUCTOR AWG SIZE	CABLE	OUTER JACKET MAX DIA (φD)	DIELECTRIC DIA (φ F)	INNER CONDUCTOR SIZE (φ G)	OUTER BRAID DIA (φ E)	CABLE STRIP LENGTH			COAX CONTACT ASSEMBLY (SEE PLATING TABLE SHT 2)		DIE SET	STOP BUSHING	INNER CONDUCTOR CRIMP		BRAID CRIMP		MIN INNER PULL OUT AFTER CRIMPING	MIN BRAID PULL OUT AFTER CRIMPING
						A	B	C	MALE	FEMALE			G DIM	T DIM	G DIM	T DIM		
30	CDC PIN 22939200	.090 [2.29]	.048 [1.22]	7/004 .012 [0.30] DIA	.064 [1.63]	.165 [4.19]	.235 [5.97]	.335 [8.51]	RMDX60-46	RCDX60-16	S-87	SL-105	.051/.046 [1.30/1.17]	.055/.048 [1.40/1.22]	.109/.104 [2.77/2.64]	.119/.112 [3.02/2.84]	4.1 LBS.	18 LBS.
30	CDC PIN 22939200	.090 [2.29]	.048 [1.22]	7/004 .012 [0.30] DIA	.064 [1.63]	.165 [4.19]	.235 [5.97]	.335 [8.51]	RMDX60-50	RCDX60-16	S-87	SL-105	.051/.046 [1.30/1.17]	.055/.048 [1.40/1.22]	.109/.104 [2.77/2.64]	.119/.112 [3.02/2.84]	4.1 LBS.	18 LBS.
30	CDC PIN 245670000	.104 [2.64]	.067 [1.70]	7/004 .012 [0.30] DIA	.083 [2.11]	.200 [5.08]	.250 [6.35]	.350 [8.89]	RMDX60-50	RCDX60-16	S-80	SL-105	.051/.046 [1.30/1.17]	.055/.048 [1.40/1.22]	.117/.112 [2.97/2.84]	.123/.116 [3.12/2.95]	4.1 LBS.	18 LBS.
30	KX21TVT (EUROPE) RG176 B/U	.075 [1.91]	.034 [0.86]	7/004 .012 [0.30] DIA	.054 [1.37]	.200 [5.08]	.250 [6.35]	.350 [8.89]	RMDX60-34	RCDX60-34	S-84	SL-105	.051/.046 [1.30/1.17]	.052/.046 [1.32/1.17]	.112/.108 [2.84/2.74]	.121/.114 [3.07/2.90]	4.7 LBS.	11 LBS.
30	RG178 B/U	.075 [1.91]	.034 [0.86]	7/004 .012 [0.30] DIA	.054 [1.37]	.200 [5.08]	.250 [6.35]	.350 [8.89]	RMDX60-50	RCDX60-16	S-87	SL-105	.051/.046 [1.30/1.17]	.055/.048 [1.40/1.22]	.109/.104 [2.77/2.64]	.119/.112 [3.02/2.84]	4.1 LBS.	8 LBS.
28	AMPEX	.114 [2.90]	.075 [1.91]	7/005 .015 [0.38] DIA	.090 [1.29]	.200 [5.08]	.250 [6.35]	.460 [11.68]	RMDX60-32	RCDX60-32	S-80	SL-105	.051/.046 [1.30/1.17]	.055/.048 [1.40/1.22]	.117/.112 [2.97/2.84]	.123/.116 [3.12/2.95]	3.7 LBS.	18 LBS.
26	T.I. PN 920580	.070 [1.78]	.038 [0.96]	7/0063 .019 [0.48] DIA	.054 [1.37]	.200 [5.08]	.250 [6.35]	.350 [8.89]	RMDX60-24	RCDX60-24	S-82	SL-105	.053/.047 [1.35/1.19]	.056/.050 [1.42/1.27]	.113/.108 [2.87/2.74]	.121/.114 [3.07/2.90]	5.8 LBS.	14 LBS.
26	RG174/U	.115 [2.92]	.060 [1.52]	7/0063 .019 [0.48] DIA	.088 [2.24]	.200 [5.08]	.250 [6.35]	.460 [11.68]	RMDX60-32	RCDX60-32	S-80	SL-105	.051/.046 [1.30/1.17]	.055/.048 [1.40/1.22]	.117/.112 [2.97/2.84]	.123/.116 [3.12/2.95]	8.0 LBS.	14 LBS.
26	HONEYWELL PN 58000062	.120 [3.05]	.077 [1.96]	.016 [0.41] DIA SOLID	.096 [2.44]	.200 [5.08]	.250 [6.35]	.350 [8.89]	RMDX60-26	RCDX60-26	S-82	SL-105	.053/.047 [1.35/1.19]	.056/.050 [1.42/1.27]	.113/.108 [2.87/2.74]	.121/.114 [3.07/2.90]	10.5 LBS.	18 LBS.
26	RG188A/U	.110 [2.79]	.060 [1.52]	7/0067 .020 [0.51] DIA	.078 [1.98]	.200 [5.08]	.250 [6.35]	.460 [11.68]	RMDX60-36	RCDX60-36	S-80	SL-105	.051/.046 [1.30/1.17]	.055/.048 [1.40/1.22]	.117/.112 [2.97/2.84]	.123/.116 [3.12/2.95]	10.5 LBS.	18 LBS.
26	RG316/U	.107 [2.72]	.060 [1.52]	7/0067 .020 [0.51] DIA	.078 [1.98]	.200 [5.08]	.250 [6.35]	.460 [11.68]	RMDX60-36	RCDX60-36	S-80	SL-105	.051/.046 [1.30/1.17]	.055/.048 [1.40/1.22]	.117/.112 [2.97/2.84]	.123/.116 [3.12/2.95]	10.5 LBS.	18 LBS.
26	PRD PN 247AS-C1123-001	.103 [2.62]	.060 [1.52]	7/0067 .020 [0.51] DIA	.078 [1.98]	.200 [5.08]	.250 [6.35]	.350 [8.89]	RMDX60-18	RCDX60-18	M10S08 ASSY TOOL DIE SET STOP BUSHING M10S-1 TOOL		.048/.046 [1.22/1.17]	.053/.048 [1.35/1.22]	.115/.110 [2.92/2.79]	.123/.117 [3.12/2.97]	10.5 LBS.	18 LBS.
24	PRD PN 247AS-C1251	.092 [2.34]	.050 [1.27]	19/005 .025 [0.64] DIA	.067 [1.70]	.200 [5.08]	.250 [6.35]	.350 [8.89]	RMDX60-18	RCDX60-18	M10S08 ASSY TOOL DIE SET STOP BUSHING M10S-1 TOOL		.048/.046 [1.22/1.17]	.053/.048 [1.35/1.22]	.115/.110 [2.92/2.79]	.123/.117 [3.12/2.97]	9.0 LBS.	18 LBS.
24	RAYCHEM 5024A3111	.120 [3.05]	.083 [2.11]	19/005 .025 [0.64] DIA	.097 [2.46]	.200 [5.08]	.250 [6.35]	.460 [11.68]	RMDX60-52	RCDX60-52	S-88	SL-105	.054/.050 [1.37/1.27]	.057/.052 [1.45/1.32]	.115/.110 [2.92/2.79]	.117/.112 [2.97/2.84]	9.0 LBS.	20 LBS.
26	RAYCHEM 5026E1614	.083 [2.11] NOM.	.050 [1.27]	7/0067 .019 [0.48] DIA	.067 [1.70]	.200 [5.08]	.250 [6.35]	.350 [8.89]	RMDX60-36	RCDX60-36	M10S08 ASSY TOOL DIE SET STOP BUSHING M10S-1 TOOL		.048/.046 [1.22/1.17]	.053/.048 [1.35/1.22]	.115/.110 [2.92/2.79]	.123/.117 [3.12/2.97]	12.5 LBS.	8.1 LBS.
26	JUDD C15013010902	.087 [2.13]	.050 [1.27]	7/0067 .019 [0.48] DIA	.066 [1.67]	.200 [5.08]	.250 [6.35]	.350 [8.89]	RMDX60-36	RCDX60-36	M10S08 ASSY TOOL DIE SET STOP BUSHING M10S-1 TOOL		.048/.046 [1.22/1.17]	.053/.048 [1.35/1.22]	.115/.110 [2.92/2.79]	.123/.117 [3.12/2.97]	12.5 LBS.	9.6 LBS.

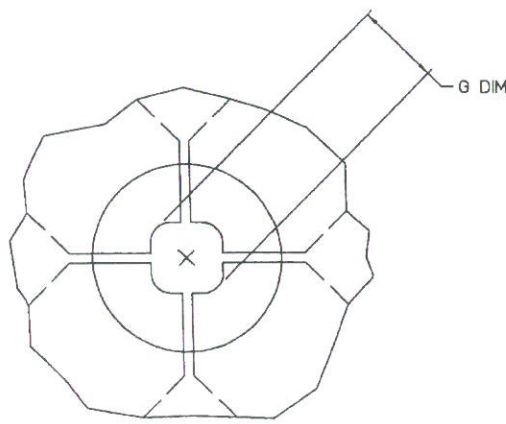

BRAID CRIMP (G DIM) TO BE MEASURED WITH DIE SET FULLY CLOSED

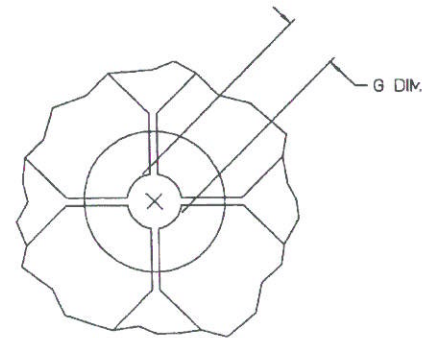

INNER CONDUCTOR CRIMP (G DIM) TO BE MEASURED WITH DIE SET FULLY CLOSED

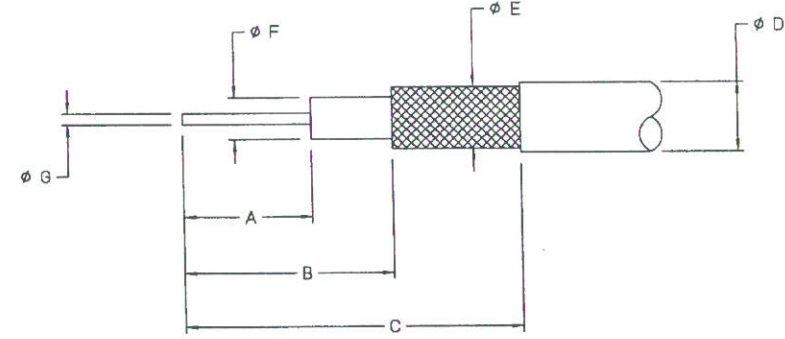

WIRE DIMENSIONS

REV	DESCRIPTION	BY	CHKD	SHEET	ZONE
	REVISION	DATE	DATE	NO.	
MONOCRIMP SUBMIN COAX CONTACTS					
CAT NO. RC/RMDX60-... (SEE TABLE)					
DWG RELEASED TO CENTRAL FILE					
GAGE NO. ECN 3158 P.O. 828 SIZE: D					
FCI Electronics Systems Division					
SOURIAU					
DRAWING NO. SE76413					
SHEET 2 OF 3					

THIS DRAWING IS THE PROPERTY OF FCI ELECTRONICS, INC. AND IS TO BE KEPT IN CONFIDENCE. IT IS TO BE USED ONLY FOR THE PURPOSES SPECIFIED HEREIN. ANY REPRODUCTION OR TRANSMISSION OF THIS DRAWING WITHOUT THE WRITTEN AUTHORIZATION OF FCI ELECTRONICS, INC. IS PROHIBITED.

THIS DRAWING IS CONTROLLED DOCUMENT AND IS THE PROPERTY OF FCI. IT IS TO BE KEPT IN THE ORIGINAL FILE. ANY REVISIONS TO THIS DRAWING MUST BE APPROVED BY THE ORIGINAL DESIGNER AND THE CONTROLLING OFFICE. THE CONTROLLING OFFICE SHOULD BE CONTACTED FOR THE LATEST REVISION.

MONOCRIMP SUBMIN COAX CONTACT AND CABLE INSTALLATION PROCEDURE

1. SELECT THE APPROPRIATE MONOCRIMP SUBMIN COAX CONTACT AND CABLE COMBINATION AS SPECIFIED ON SHEET 2.
2. SELECT THE APPROPRIATE CRIMP TOOLING, M10S HAND TOOL, S-DIE, AND STOP BUSHING FOR THE CONTACT AND CABLE DESIGNATION AS PREVIOUSLY SELECTED.
3. STRIP COAX CABLE TO THE DESIGNATED WIRE STRIP LENGTHS FOR THE SELECTED CABLE AS DESCRIBED ON SHEET 2.
4. INSERT THE PREVIOUSLY STRIPPED COAX CABLE INTO THE REAR OF THE CONTACT ASSEMBLY.
5. INSERT THE RCDX60-\_\_\_\_\_ OR RMDX60-\_\_\_\_\_ CONTACT INTO THE PROPER CRIMP TOOL ASSEMBLY AND TERMINATE.

TYPICAL CATALOG NUMBER DESCRIPTION

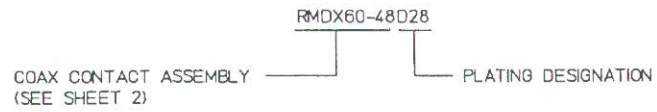

PLATING TABLE	
CATALOG NUMBER	PLATE PER BURNDY SPEC F450
RC/RMDX60-___D45	TYPE D45-.000050 [0.00127] MIN HARD GOLD OVER .000075 [0.00191] MIN NICKEL
RC/RMDX60-___D28	TYPE D28-.000030 [0.00076] MIN HARD GOLD OVER .000075 [0.00191] MIN NICKEL

FOR SUGGESTED CABLE STRIP LENGTHS SEE SHEET 2

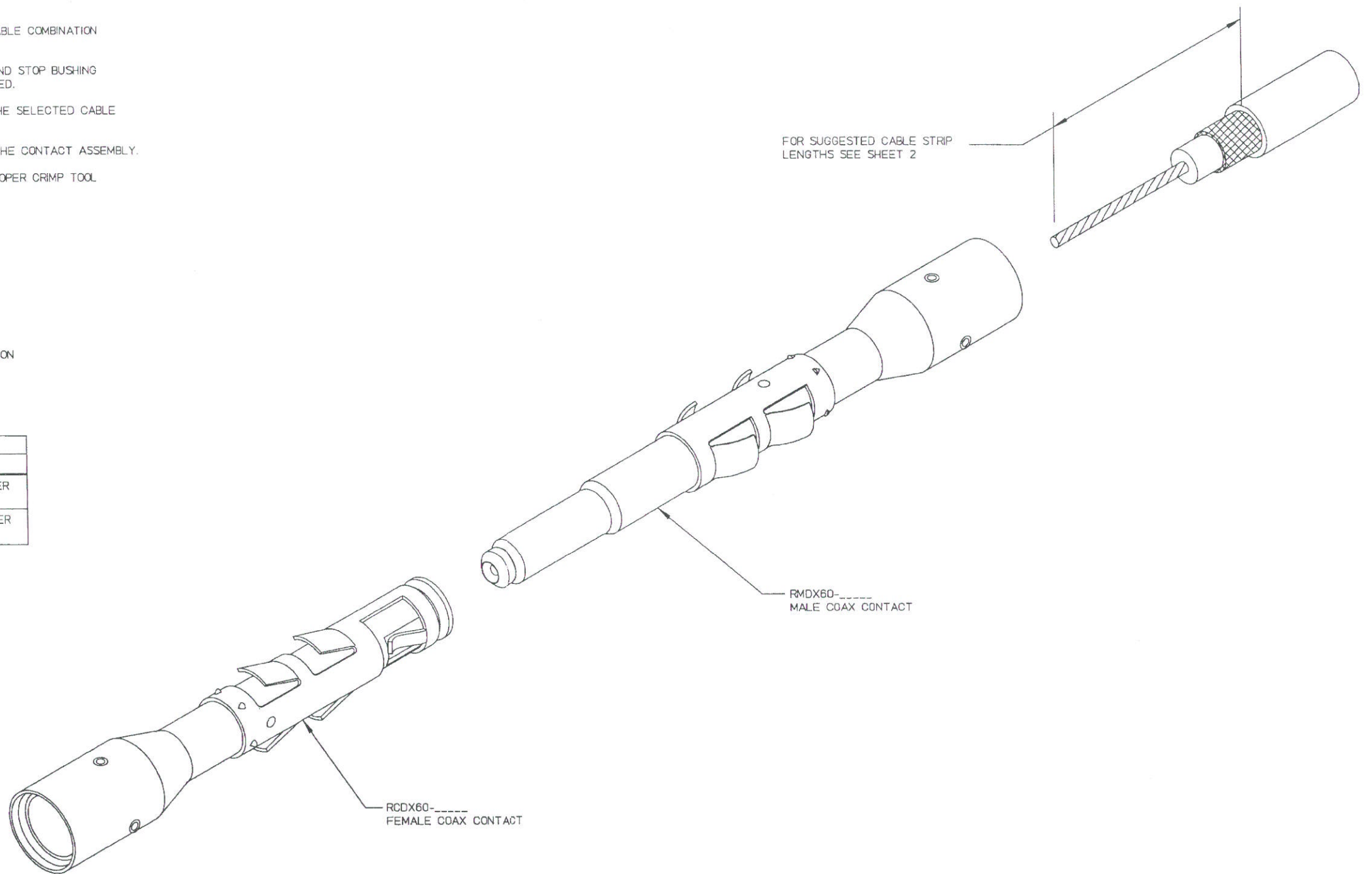

RCDX60-\_\_\_\_\_ FEMALE COAX CONTACT

RMDX60-\_\_\_\_\_ MALE COAX CONTACT

THIS DRAWING IS CONTROLLED DOCUMENT AND IS THE PROPERTY OF FCI. IT IS TO BE KEPT IN THE ORIGINAL FILE. ANY REVISIONS TO THIS DRAWING MUST BE APPROVED BY THE ORIGINAL DESIGNER AND THE CONTROLLING OFFICE. THE CONTROLLING OFFICE SHOULD BE CONTACTED FOR THE LATEST REVISION.

REV	DESCRIPTION	BY	CHKD	SHEET	ZONE
	REVISION	DATE	DATE	NO.	
MONOCRIMP SUBMIN COAX CONTACTS					
CAT NO. RC/RMDX60-_____ (SEE TABLE)					
DRAWN: POP 12-18-73					
CHKD: LAS 11-12-74					
DSGN: LAS 11-12-74					
MFG: NO 12-22-84					
CD: BH 12-22-74					
DRAWING NO. 34					
SHEET 3 OF 3					

**FCI Electronics Systems Division**  
  
 SOURIAU