



Chipsmall Limited consists of a professional team with an average of over 10 year of expertise in the distribution of electronic components. Based in Hongkong, we have already established firm and mutual-benefit business relationships with customers from,Europe,America and south Asia,supplying obsolete and hard-to-find components to meet their specific needs.

With the principle of “Quality Parts,Customers Priority,Honest Operation,and Considerate Service”,our business mainly focus on the distribution of electronic components. Line cards we deal with include Microchip,ALPS,ROHM,Xilinx,Pulse,ON,Everlight and Freescale. Main products comprise IC,Modules,Potentiometer,IC Socket,Relay,Connector.Our parts cover such applications as commercial,industrial, and automotives areas.

We are looking forward to setting up business relationship with you and hope to provide you with the best service and solution. Let us make a better world for our industry!



## Contact us

Tel: +86-755-8981 8866 Fax: +86-755-8427 6832

Email & Skype: info@chipsmall.com Web: www.chipsmall.com

Address: A1208, Overseas Decoration Building, #122 Zhenhua RD., Futian, Shenzhen, China



NOTES: UNLESS OTHERWISE SPECIFIED;

1 INTERPRET THIS DRAWING IN ACCORDANCE WITH ANSI Y14.5M-1982.

2 MATERIAL: NYLON

3 APPROXIMATE WEIGHT: 2.3 GRAMS

4 THIS PART SNAP FITS INTO CATALOG NUMBER RSMDEX-1 AND WILL SEPARATE FROM IT WITH A FORCE NOT GREATER THAN 11 POUNDS (48.9 N) AND NOT LESS THAN 3 POUNDS (13.3 N).

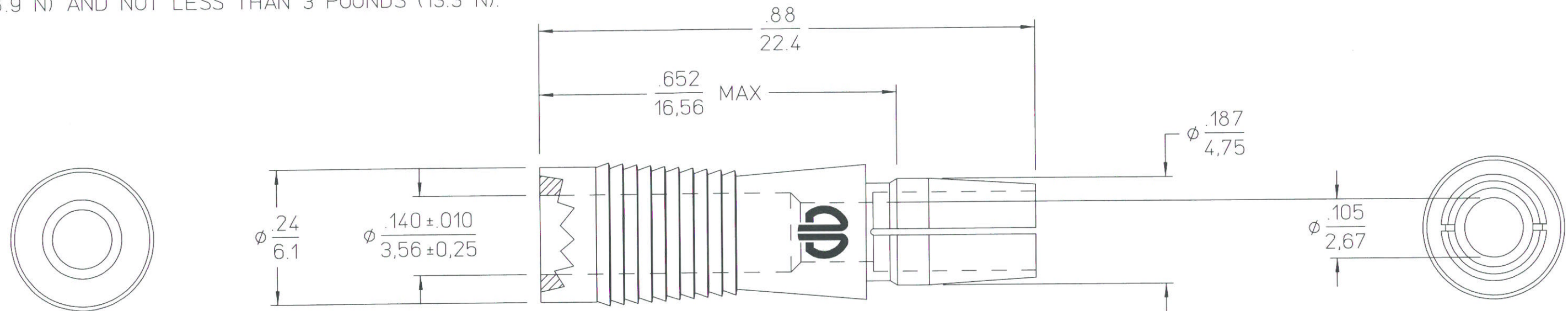

COLOR TABLE

| CATALOG NO. | COLOR                    |
|-------------|--------------------------|
| RSCDEX-2    | NATURAL (CLEAR TO WHITE) |
| RSCDEX-5    | BLACK                    |
| RSCDEX-6    | BLUE                     |
| RSCDEX-7    | BROWN                    |
| RSCDEX-8    | RED                      |
| RSCDEX-9    | GREEN                    |
| RSCDEX-10   | YELLOW                   |
| RSCDEX-11   | VIOLET (PURPLE)          |
| RSCDEX-12   | GRAY                     |
| RSCDEX-13   | ORANGE                   |

REFERENCE:

SC55386 - RSMDEX-\_\_\_  
 SE52918 - SUB-MINIATURE COAX HYFEN  
 SD57870 - SUB-MINIATURE COAX  
 SD61512 - TRIM TRIO

ACCOMMODATES:

RCDX60-2 (SE52918)

SUPERSEDES:

SC55388  
 AND SC60760-3

|     |   |     |      |          |
|-----|---|-----|------|----------|
| 4   | REDRAWN ON CAD WITHOUT CHANGE (ECN3129) | SMM | PJB  | 10/28/94 |
| REV | REVISION DESCRIPTION                    | BY  | CHKD | DATE     |

|  |          |        |          |
|--|----------|--------|----------|
| SUB-MINIATURE COAX SPLICE (PLUG) (SEPARABLE) |          |        |          |
| CAT NO RSCDEX-___ (SEE TABLE)                |          |        |          |
| DWG RELEASED TO CENTRAL FILE 11-1-94         |          |        |          |
| CAGE NO 09922                                | ECN 3129 | PC 830 |          |
| © BURNDY CORPORATION 1994                    |          |        |          |
| APPROVAL                                     | DRWN     | NF     | 9-13-67  |
|  | CHKD     | CAR    | 9-21-67  |
|  | DSGN     | MP     | 9-21-67  |
|  | MKT      | MG     | 10-28-94 |
|  | QC       | SJ     | 10-28-94 |
| DRAWING SCALE 5 : 1                          |          |        |          |
| DRAWING NO                                   |          |        | REV      |
| SC60760                                      |          |        | 4        |
| SHEET 1 OF 1                                 |          |        |          |

|  |               |
|--|---------------|
| LINEAR MEASURE: INCH mm INCH [mm]            |               |
| THIRD ANGLE PROJECTION                       |               |
|  |               |
| - TOLERANCES -<br>UNLESS OTHERWISE SPECIFIED |               |
| NO OF DECIMAL PLACES IN INCHES               | INCH [mm]     |
| ONE PLACE                                    | ±.1 [±3]      |
| TWO PLACES                                   | ±.02 [±0.5]   |
| THREE PLACES                                 | ±.005 [±0.13] |
| ANGLES ±1°                                   |               |

