



Chipsmall Limited consists of a professional team with an average of over 10 year of expertise in the distribution of electronic components. Based in Hongkong, we have already established firm and mutual-benefit business relationships with customers from,Europe,America and south Asia,supplying obsolete and hard-to-find components to meet their specific needs.

With the principle of "Quality Parts,Customers Priority,Honest Operation,and Considerate Service",our business mainly focus on the distribution of electronic components. Line cards we deal with include Microchip,ALPS,ROHM,Xilinx,Pulse,ON,Everlight and Freescale. Main products comprise IC,Modules,Potentiometer,IC Socket,Relay,Connector.Our parts cover such applications as commercial,industrial, and automotives areas.

We are looking forward to setting up business relationship with you and hope to provide you with the best service and solution. Let us make a better world for our industry!



Contact us

Tel: +86-755-8981 8866 Fax: +86-755-8427 6832

Email & Skype: info@chipsmall.com Web: www.chipsmall.com

Address: A1208, Overseas Decoration Building, #122 Zhenhua RD., Futian, Shenzhen, China



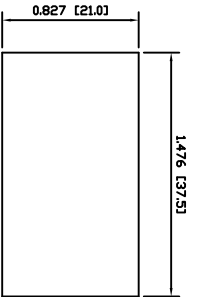
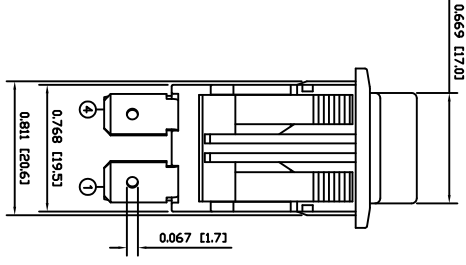
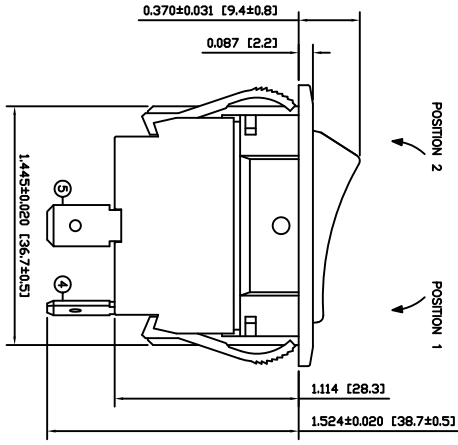
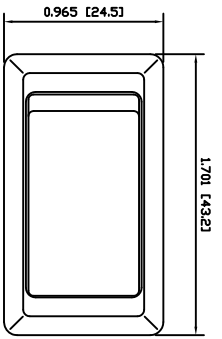

SUGGESTED PANEL CUTOUT

MATERIALS

BODY:
Polyamide 6/6 (PA66), UL94 V-2

ACTUATOR:
Polyamide 6/6 (PA66), UL94 V-2

SEALING MEMBRANE:
Polyvinyl Chloride (PVC)

SPRING:
Phono wire

MOBILE CONTACT BAR:
Copper

CONTACT PADS:
Silver Clad Copper

RIFETS:
Copper

TERMINALS:
Brass

SPECIFICATIONS

FUNCTION:
2PTT OFF-ON

RATINGS:
ANSI/UL 508 and CAN/CSA C22.2 No.14 (E198908):
20A 125VAC [cULRu]
15A 277VAC [cULRu]
2HP 110/250VAC [cULRu]

CONTACT RESISTANCE:
Initial: 50mΩ Max.
Electrical Life: 6,000 Cycles [cULRu]

TEMPERATURE:
Operating: -20°C to 55°C [cULRu]

INGRESS PROTECTION:
IP54



COLORS AND MARKINGS

BODY COLOR:
Black

ACTUATOR COLOR:
Black

MARKING:
None

MARKING COLOR:
None

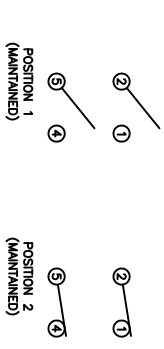
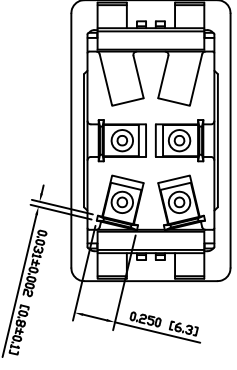

SCHEMATIC



RWW42D1100

ACTUATOR BODY	REV.	DATE	BY
B	10/09/28	CAB	
A	09/06/15	CAB	
C	10/03/01	CAB	

THE INFORMATION CONTAINED IN THIS DOCUMENT IS PROPRIETARY TO E-SWITCH AND IS NOT TO BE COPIED OR TRANSMITTED

CONNECTED SPECIFICATIONS	REV.	DATE	BY
INITIAL RELEASE	A		
DESCRIPTION	B		

DIMENSIONS	INCHES [MILLIMETERS]	SCALE	PROJECTION
GENERAL TOLERANCES	±0.008 [±0.2] / ±1'	1:1	DRIVING NUMBER
DRAWING NOT TO SCALE			34-RWW42D1100

DATE	REVISION
DECEMBER 9, 2009	B