



Chipsmall Limited consists of a professional team with an average of over 10 year of expertise in the distribution of electronic components. Based in Hongkong, we have already established firm and mutual-benefit business relationships with customers from,Europe,America and south Asia,supplying obsolete and hard-to-find components to meet their specific needs.

With the principle of “Quality Parts,Customers Priority,Honest Operation,and Considerate Service”,our business mainly focus on the distribution of electronic components. Line cards we deal with include Microchip,ALPS,ROHM,Xilinx,Pulse,ON,Everlight and Freescale. Main products comprise IC,Modules,Potentiometer,IC Socket,Relay,Connector.Our parts cover such applications as commercial,industrial, and automotives areas.

We are looking forward to setting up business relationship with you and hope to provide you with the best service and solution. Let us make a better world for our industry!



## Contact us

Tel: +86-755-8981 8866 Fax: +86-755-8427 6832

Email & Skype: info@chipsmall.com Web: www.chipsmall.com

Address: A1208, Overseas Decoration Building, #122 Zhenhua RD., Futian, Shenzhen, China



## 202 Series Plugs and Sockets

The 202 Series make ideal microphone cable connectors.

### Materials

**Body Material:** Brass  
**Body Plating:** Nickel  
**Insulation Material:** Phenolic

### Ordering Information

Type	Part No.
Plug with cable clamps and knurled nut	P-202-CCT
Socket with cable clamps and knurled nut	S-202-CCT
Socket with threaded mounting base	S-202-B
Plug with threaded mounting base	P-202-B
Socket with cable clamps and threaded body for attaching to a P-202-CCT	S-202-CCT-THR
Plug with cable clamps and threaded body for attaching to a S-202-CCT	P-202-CCT-THR

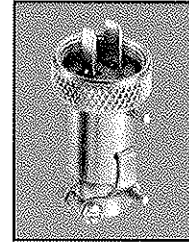

P-202-CCT

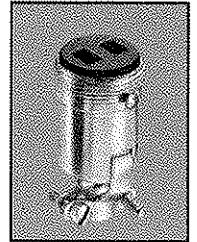

S-202-CCT-THR

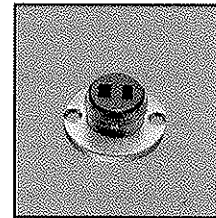

S-202-B

### Dimensions

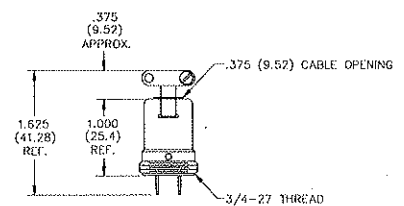
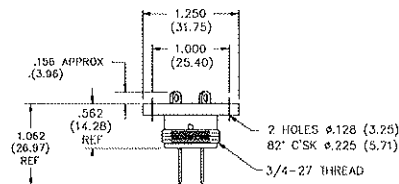
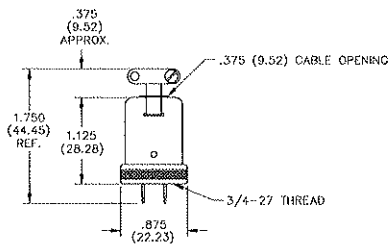
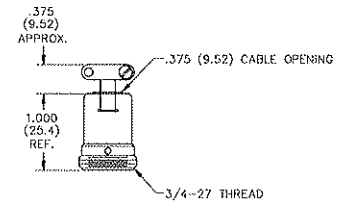
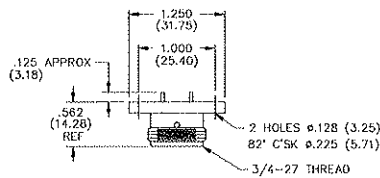
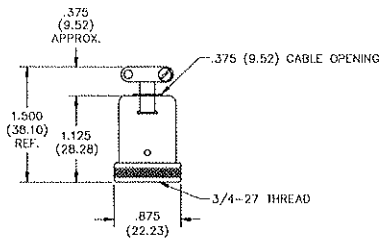

CCT

B

CCT-THR

Marketed exclusively through distribution.