



Chipsmall Limited consists of a professional team with an average of over 10 year of expertise in the distribution of electronic components. Based in Hongkong, we have already established firm and mutual-benefit business relationships with customers from,Europe,America and south Asia,supplying obsolete and hard-to-find components to meet their specific needs.

With the principle of “Quality Parts,Customers Priority,Honest Operation,and Considerate Service”,our business mainly focus on the distribution of electronic components. Line cards we deal with include Microchip,ALPS,ROHM,Xilinx,Pulse,ON,Everlight and Freescale. Main products comprise IC,Modules,Potentiometer,IC Socket,Relay,Connector.Our parts cover such applications as commercial,industrial, and automotives areas.

We are looking forward to setting up business relationship with you and hope to provide you with the best service and solution. Let us make a better world for our industry!



## Contact us

Tel: +86-755-8981 8866 Fax: +86-755-8427 6832

Email & Skype: info@chipsmall.com Web: www.chipsmall.com

Address: A1208, Overseas Decoration Building, #122 Zhenhua RD., Futian, Shenzhen, China



# Customer Information Sheet

DRAWING No.: SOX-46

SHEET 2 OF 2

IF IN DOUBT - ASK

Ⓒ

NOT TO SCALE

THIRD ANGLE PROJECTION

ALL DIMENSIONS IN mm

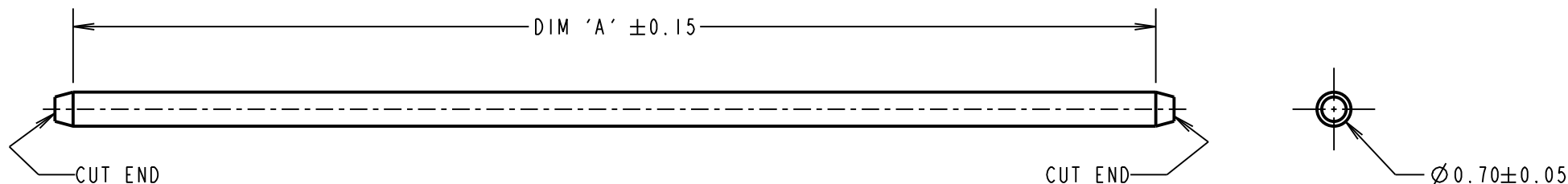

**NOTES:**

1. THIS PRODUCT IS RECOMMENDED FOR USE WITH S8071-46R AND S8081-46R SMT CLIPS.
3. MAXIMUM BURR ON CUTTING AREA = 0.05mm.
4. ALL PRODUCT IS RoHS AND REACH COMPLIANT.
5. PACKAGING = 100 COMPONENTS PER BAG.
6. CURRENT RATING IS DEPENDANT ON USAGE. SEE TEST REPORT HT055XX (LATEST ISSUE) FOR MORE INFORMATION ON CURRENT RATING.

**SPECIFICATIONS:**

MATERIAL = PHOSPHOR BRONZE  
 FINISH = 2-6 $\mu$  TIN OVER 1-4 $\mu$  NICKEL

ELECTRICAL:  
 CURRENT RATING = 3A - 13A  
 (SEE NOTE 6)

VOLTAGE RATING = 250V AC/DC  
 CONTACT RESISTANCE = 20m $\Omega$  MAX

ENVIRONMENTAL:  
 OPERATING TEMPERATURE = -40°C TO +85°C

PART No.	DIM 'A'
S07-46	23.00
S08-46	15.00

**ORDER CODE:**

**SOX-46**

**PIN LENGTH:**

7 = 23.00  
 8 = 15.00

**FINISH:**

46 = 2-6 $\mu$  TIN OVER  
 1-4 $\mu$  NICKEL

MSP	4	19.04.17	20428
NAME	ISS.	DATE	C/NOTE
APPROVED: M.PERREN			
CHECKED: S.BENNETT			
DRAWN: S.BENNETT			
CUSTOMER REF.:			
ASSEMBLY DRG:			

**HARWIN**

www.harwin.com  
 technical@harwin.com

THIS DRAWING AND ANY INFORMATION OR DESCRIPTIVE MATTER SET OUT HEREON ARE CONFIDENTIAL AND COPYRIGHT PROPERTY OF THE HARWIN GROUP AND MUST NOT BE DISCLOSED, LOANED, COPIED OR USED FOR MANUFACTURING, TENDERING OR FOR ANY OTHER PURPOSE WITHOUT THEIR WRITTEN PERMISSION.

**TOLERANCES**  
 X. =  $\pm 1$ mm  
 X.X =  $\pm 0.50$ mm  
 X.XX =  $\pm 0.10$ mm  
 X.XXX =  $\pm 0.01$ mm  
 ANGLES =  $\pm 5^\circ$   
 UNLESS STATED

**MATERIAL:**  
 SEE ABOVE  
**FINISH:** SEE ABOVE  
**S/AREA:** mm<sup>2</sup>

**TITLE:**  
 BRIDGE PIN  
**DRAWING NUMBER:**  
**SOX-46**

SHT  
 2 OF  
 2