



Chipsmall Limited consists of a professional team with an average of over 10 year of expertise in the distribution of electronic components. Based in Hongkong, we have already established firm and mutual-benefit business relationships with customers from,Europe,America and south Asia,supplying obsolete and hard-to-find components to meet their specific needs.

With the principle of “Quality Parts,Customers Priority,Honest Operation,and Considerate Service”,our business mainly focus on the distribution of electronic components. Line cards we deal with include Microchip,ALPS,ROHM,Xilinx,Pulse,ON,Everlight and Freescale. Main products comprise IC,Modules,Potentiometer,IC Socket,Relay,Connector.Our parts cover such applications as commercial,industrial, and automotives areas.

We are looking forward to setting up business relationship with you and hope to provide you with the best service and solution. Let us make a better world for our industry!



## Contact us

Tel: +86-755-8981 8866 Fax: +86-755-8427 6832

Email & Skype: [info@chipsmall.com](mailto:info@chipsmall.com) Web: [www.chipsmall.com](http://www.chipsmall.com)

Address: A1208, Overseas Decoration Building, #122 Zhenhua RD., Futian, Shenzhen, China



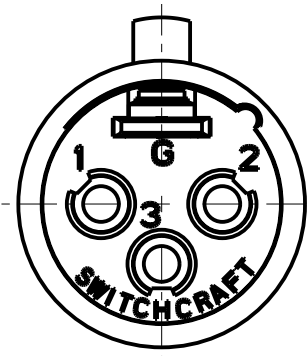

S3FM  
3 PIN

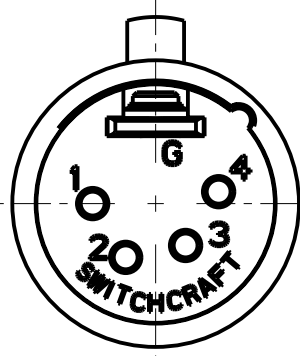

S4FM  
4 PIN

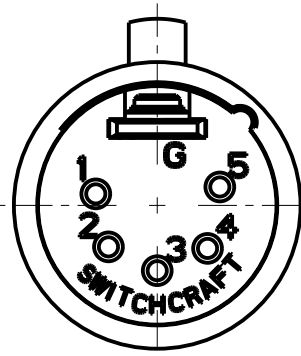

S5FM  
5 PIN

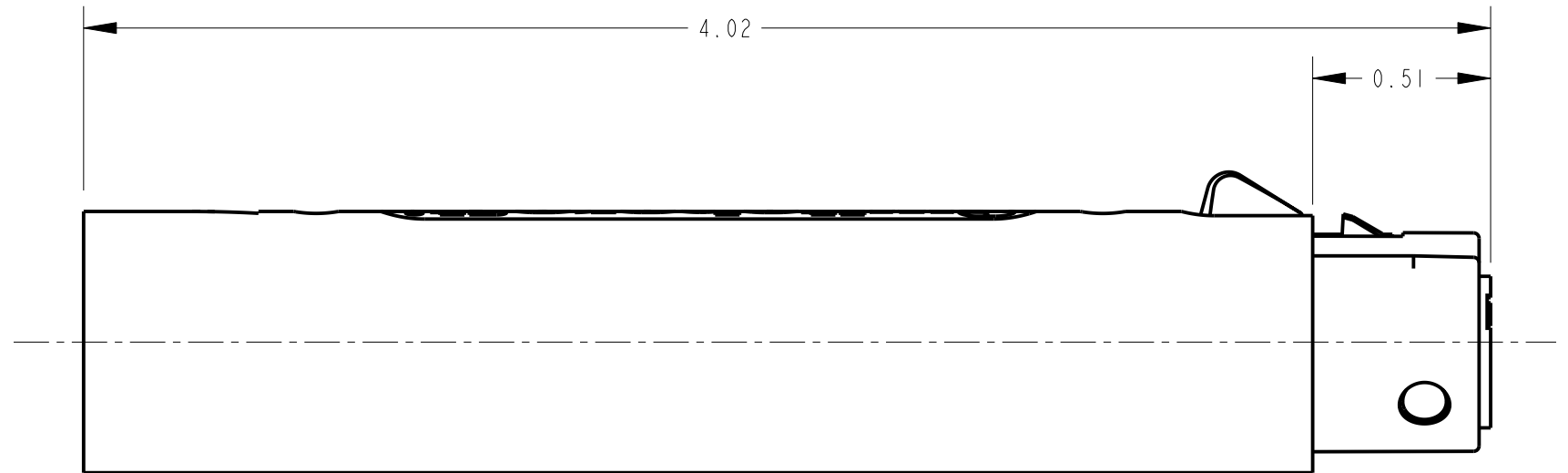
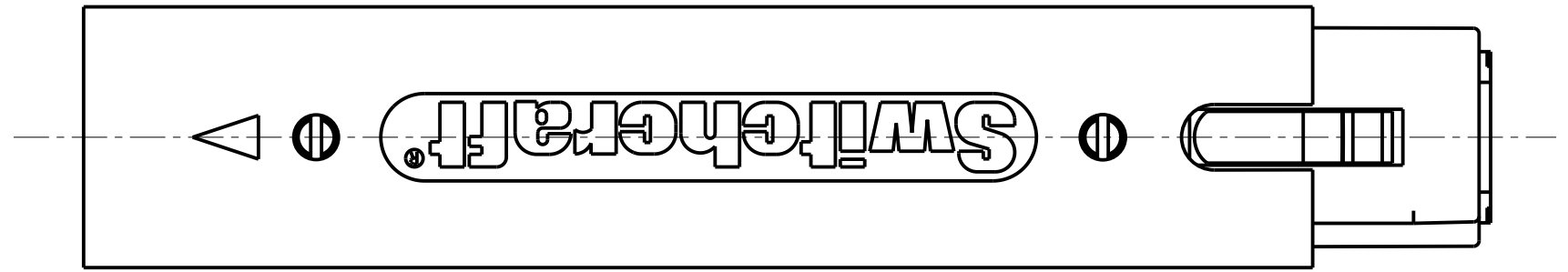
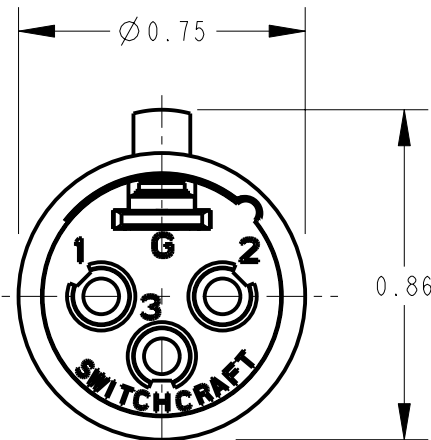

STANDARD SERIES

SCREWS - STAINLESS STEEL  
SHELL - STAINLESS STEEL  
HOUSING - ZINC, NICKEL PLATED  
SOLDER TERMINALS - BRASS, ELECTRO TIN PLATED  
INSULATORS - POLYESTER, GREEN  
CONTACT PINS - BRASS, SILVER PLATED  
RECEPTACLE PINS - BRONZE, SILVER PLATED  
CONTACTOR - COPPER, NICKEL PLATED  
LATCH SPRING - STAINLESS STEEL  
LATCH BUTTON - ZINC, NICKEL PLATED  
TUBULAR INSULATOR - MYLAR

S - F M

NO. OF CONTACTS:  
3 = 3 CONTACTS  
4 = 4 CONTACTS  
5 = 5 CONTACTS

NOTES:

1. ALL DIMENSIONS REFERENCE UNLESS OTHERWISE SPECIFIED.

CUSTOMER DRAWING

					★ STAR SYMBOL DENOTES CRITICAL DIMENSION	THIS DRAWING DESCRIBES A DESIGN CONSIDERED PROPRIETARY IN NATURE, DEVELOPED AND MANUFACTURED BY SWITCHCRAFT INC. AND IS RELEASED ON A CONFIDENTIAL BASIS FOR IDENTIFICATION PURPOSES ONLY.									
					UNLESS OTHERWISE SPECIFIED	SIZE		WIDTH		MULT		LBS/M		TEMPER	
M	27096	2-7-13	TO	TJK	1. ALL DIMENSIONS IN INCHES -TWO PLACE DECIMALS ±0.01 -THREE PLACE DECIMALS ±0.005 -FRACTIONAL DIMENSIONS ±1/64 -ANGLES ±1° -ALL DIA. CONCENTRIC WITHIN 0.005 T.I.R.	FINISH						MATERIAL			
L	ECO #21378	1-29-97	MM	RB		SPEC No.						SPEC No.			
K	ECO #21057	1-29-97	MM	RB		FIRST USED ON				SCALE 2:1		<div>Switchcraft®</div>			
J	ECO #21034	1-28-97	MM	RB		DATE DRAWN		BY	CHKD		APVD				
H	20627	3-6-96	SG	SG		28-Aug-94		SG	SG 8-29-94		GHJ 8-29-94				
REV					2. FEATURES ON THE SAME CENTERLINE MUST BE ALIGNED WITHIN ±0.002							SHEET   OF			
REV					3. REMOVE ALL BURRS	NAME						PART No.			
						S SERIES OG ADAPTOR MALE/FEMALE						S_FM SERIES			
REVISIONS					DO NOT SCALE DRAWING							REV M			