



Chipsmall Limited consists of a professional team with an average of over 10 year of expertise in the distribution of electronic components. Based in Hongkong, we have already established firm and mutual-benefit business relationships with customers from,Europe,America and south Asia,supplying obsolete and hard-to-find components to meet their specific needs.

With the principle of “Quality Parts,Customers Priority,Honest Operation,and Considerate Service”,our business mainly focus on the distribution of electronic components. Line cards we deal with include Microchip,ALPS,ROHM,Xilinx,Pulse,ON,Everlight and Freescale. Main products comprise IC,Modules,Potentiometer,IC Socket,Relay,Connector.Our parts cover such applications as commercial,industrial, and automotives areas.

We are looking forward to setting up business relationship with you and hope to provide you with the best service and solution. Let us make a better world for our industry!



Contact us

Tel: +86-755-8981 8866 Fax: +86-755-8427 6832

Email & Skype: info@chipsmall.com Web: www.chipsmall.com

Address: A1208, Overseas Decoration Building, #122 Zhenhua RD., Futian, Shenzhen, China



GENERAL SPECIFICATIONS FOR S800s ~ S732

Electrical Capacity (Resistive & Inductive Load)

Power Level: Shown in the following tables

Other Ratings

| | |
|-------------------------------|--|
| Contact Resistance: | 10 milliohms maximum |
| Insulation Resistance: | 1,000 megohms minimum @ 500V DC |
| Dielectric Strength: | 2,000V AC minimum for 1 minute minimum for S800s & S800Ds 3,000V AC minimum for 1 minute minimum for S732 |
| Mechanical Life: | 50,000 operations minimum |
| Electrical Life: | 10,000 operations minimum for S800Ds 25,000 operations minimum for S800s & S732 |

Materials & Finishes

| | |
|---|--|
| Toggle: | Brass with nickel plating for S732 Brass with chrome plating for S800s & S800Ds |
| Bushing: | Brass with chrome plating |
| Case: | Phenolic resin for S732; melamine phenol for S800s |
| Case Cover: | Steel with chromate plating over zinc plating |
| Movable Contactor Plate: | Copper with silver plating |
| Movable & Stationary Contacts: | Silver alloy capped on copper with silver plating |
| Common Terminals: | Brass |
| Contact Terminals: | Brass with silver or nickel plating |

Environmental Data

Operating Temp Range: -10°C through +70°C (+14°F through +158°F)

Installation

| | |
|---------------------------------|---|
| Mounting Torque: | 2.94Nm (26 lb•in) for double nut |
| Maximum Panel Thickness: | Shown beneath panel cutout in switch dimension drawings |

Standards & Certifications

| | |
|-------------|--|
| UL: | File No. E44145 - Recognized only when ordered with marking on switch. Add "/U" or "/CUL" to end of part number to order UL recognized switch. UL or cULus recognition designated beside part numbers on following pages. See Supplement section to find UL or cULus rating details. |
| CSA: | File No. 023535_0_000 - Certified only when ordered with marking on switch. Add "/C" to end of part number to order CSA certified switch. CSA certification designated beside part numbers on following pages. See Supplement section to find CSA rating details. |

A
Toggles

Rockers

Pushbuttons

Illuminated PB

Programmable

Keylocks

Rotaries

Slides

Tactiles

Tilt



Touch

Indicators

Accessories

Supplement

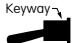
DOUBLE POLE WITH SCREW LUG

| * UL, cULus & CSA recognized only when ordered with marking on switch (see General Specs) | | | | Toggle Position/Connected Terminals | | | | Electrical Capacity | | | | | | |
|---|-------------|-------|-----|-------------------------------------|---|---|---|---------------------|---------|--------|---------|----------------|----------------|------------|
| Model | * Approvals | | | Pole & Throw | Down  | Center  | Up  | Resistive | | | | Inductive | | Motor Load |
| | UL | cULus | CSA | | | | | AC 125V | AC 250V | DC 30V | DC 125V | AC 125V PF 0.6 | AC 250V PF 0.6 | AC 125V |
| S821 | ✓ | ✓ | ✓ | DPST | ON 2-3 5-6 | NONE | OFF — | 30A | 30A | 30A | 1A | 30A | 15A | 750W |
| S822 | ✓ | ✓ | ✓ | DPDT | ON 2-3 5-6 | NONE | ON 2-1 5-4 | 30A | 30A | 30A | 1A | 30A | 15A | — |
| S823 | ✓ | ✓ | ✓ | DPDT | ON 2-3 5-6 | OFF | ON 2-1 5-4 | 30A | 30A | 30A | 1A | 30A | 15A | — |



Notes: Standard Hardware: AT503M Face Hex Nut, AT506M Locking Ring, AT508 Lockwasher, AT527M Backup Hex Nut. See Accessories & Hardware section.
Optional Splashproof Boot Assembly: AT401 boot plus hex nut & o-ring. See Accessories & Hardware section.

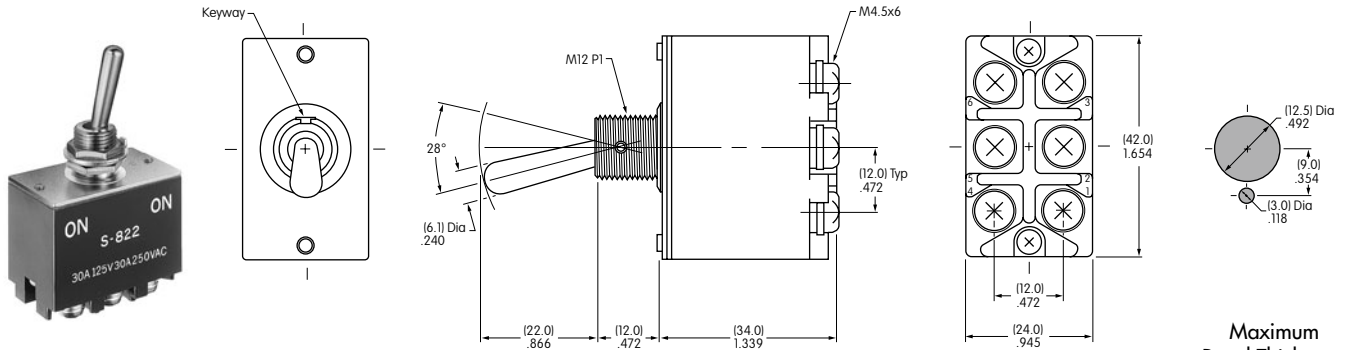



S822

S821 does not have terminals 1 & 4

Maximum Panel Thickness: .177" (4.5mm)

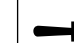
THREE POLE WITH SCREW LUG

| * UL, cULus & CSA recognized only when ordered with marking on switch (see General Specs) | | | | Toggle Position/Connected Terminals | | | | Electrical Capacity | | | | | |
|---|-------------|-------|-----|-------------------------------------|---|---|---|---------------------|---------|--------|---------|----------------|----------------|
| Model | * Approvals | | | Pole & Throw | Down  | Center  | Up  | Resistive | | | | Inductive | |
| | UL | cULus | CSA | | | | | AC 125V | AC 250V | DC 30V | DC 125V | AC 125V PF 0.6 | AC 250V PF 0.6 |
| S831 | ✓ | ✓ | ✓ | 3PST | ON 2-3 5-6 8-9 | NONE | OFF — | 30A | 30A | 30A | 1A | 30A | 15A |
| S832 | ✓ | ✓ | ✓ | 3PDT | ON 2-3 5-6 8-9 | NONE | ON 2-1 5-4 8-7 | 30A | 30A | 30A | 1A | 30A | 15A |
| S833 | ✓ | ✓ | ✓ | 3PDT | ON 2-3 5-6 8-9 | OFF | ON 2-1 5-4 8-7 | 30A | 30A | 30A | 1A | 30A | 15A |

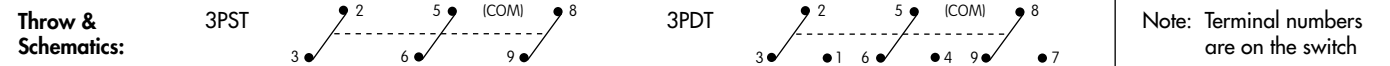

Notes: Standard Hardware: AT503M Face Hex Nut, AT506M Locking Ring, AT508 Lockwasher, AT527M Backup Hex Nut. See Accessories & Hardware section.
Optional Splashproof Boot Assembly: AT401 boot plus hex nut & o-ring. See Accessories & Hardware section.

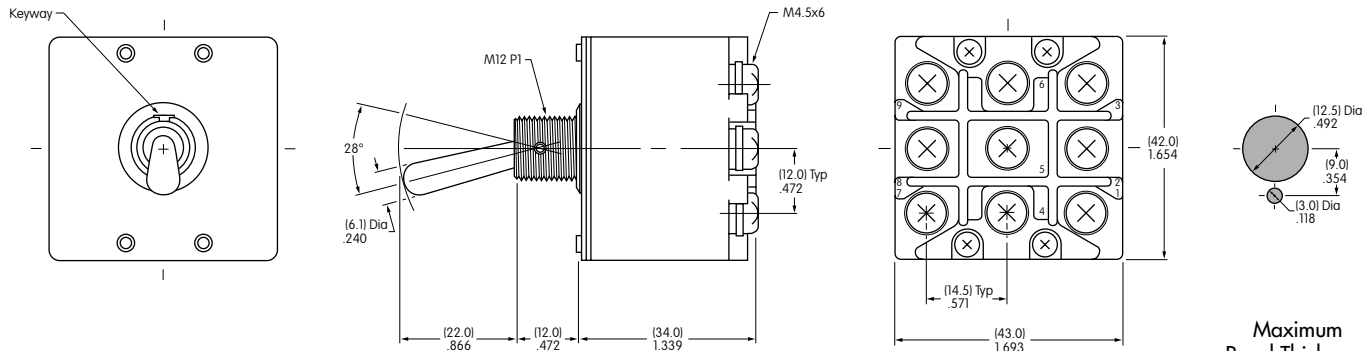



S833

S831 does not have terminals 1, 4 & 7

Maximum Panel Thickness: .177" (4.5mm)

DOUBLE POLE WITH SCREW LUG & FLATTED LEVER

* UL, cULus & CSA recognized only when ordered with marking on switch (see General Specs)

| Model | *Approvals UL cULus CSA | Pole & Throw | Toggle Position/Connected Terminals | | | | | | Electrical Capacity | | | | | | | | | | | |
|-------|----------------------------|--------------|---|------|-----|---|-----|---|---------------------|--------|---------|---------|---------------------|--------|----------|---------|---------|-----|----|----|
| | | | Down  | | | Center  | | Up  | Resistive | | | | Inductive L/R = 3ms | | | | | | | |
| | | | ON | 2-3 | 5-6 | NONE | OFF | — | DC 30V | DC 48V | DC 125V | DC 250V | DC 400V | DC 24V | DC 48V | DC 125V | DC 250V | | | |
| S821D | ✓ | ✓ | ✓ | DPST | ON | 2-3 | 5-6 | NONE | OFF | — | 30A | 30A | 20A | 15A | 4A (10A) | 15A | 10A | 6A | 3A | |
| S822D | ✓ | ✓ | ✓ | DPDT | ON | 2-3 | 5-6 | NONE | ON | 2-1 | 5-4 | 30A | 30A | 20A | 15A | 4A | 15A | 10A | 6A | 3A |
| S823D | ✓ | ✓ | ✓ | DPDT | ON | 2-3 | 5-6 | OFF | ON | 2-1 | 5-4 | 30A | 30A | 15A | 7.5A | — | 15A | 10A | 6A | 3A |

() capacity is due to wiring. Refer to instructions below.

Throw & Schematics:

DPST

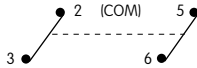

DPDT

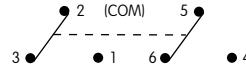

Note: Terminal numbers are on the switch

Notes: Standard Hardware: AT503M Face Hex Nut, AT506M Locking Ring, AT508 Lockwasher, AT527M Backup Hex Nut. See Accessories & Hardware section.

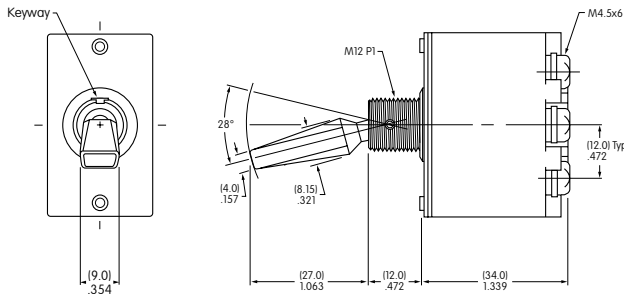

Double Pole

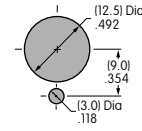
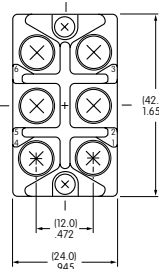

Maximum Panel Thickness: .177" (4.5mm)



S822D

S821D does not have terminals 1 & 4

400V DC WIRING INSTRUCTIONS

1. DC switch use

- Middle terminal shall be the minus pole when using DC circuit. Switch case is marked with (+) and (-).
- Do not store near (5cm) highly magnetic items.
- If actuation is interrupted when switching from ON to OFF, arcing may continue and switch could be burned.

2. Wiring for DC400V 10A

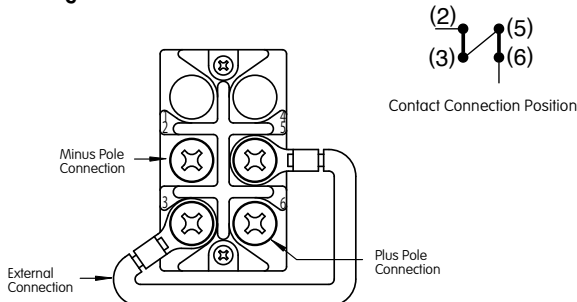

3. Inductive load

Inductive loads produce an arc caused by counter-electromotive force when opening the circuit. Recommend inserting spark elimination circuit. Contact factory for details.

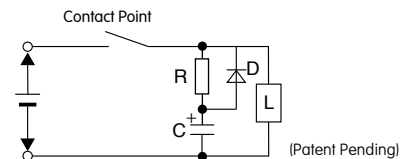

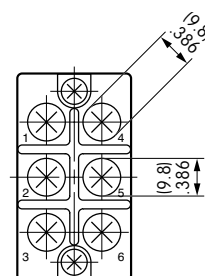

4. Compressed terminal connection

When connecting screw terminal with compressed terminal, select compressed terminal using drawing below.

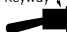

THREE POLE WITH SCREW LUG & FLATTED LEVER

* UL, cULus & CSA recognized only when ordered with marking on switch (see General Specs)

| Model | * Approvals | | | Pole & Throw | Toggle Position/Connected Terminals | | | Electrical Capacity | | | | | | | |
|-------|-------------|-------|-----|--------------|---|---|---|---------------------|--------|---------|---------|---------------------|--------|---------|---------|
| | UL | cULus | CSA | | Down  | Center  | Up  | Resistive | | | | Inductive L/R = 3ms | | | |
| | | | | | | | | DC 30V | DC 48V | DC 125V | DC 250V | DC 24V | DC 48V | DC 125V | DC 250V |
| S831D | ✓ | ✓ | ✓ | 3PST | ON 2-3 5-6 8-9 | NONE | OFF — | 30A | 30A | 15A | 7.5A | 15A | 10A | 6A | 3A |
| S832D | ✓ | ✓ | ✓ | 3PDT | ON 2-3 5-6 8-9 | NONE | ON 2-1 5-4 8-7 | 30A | 30A | 15A | 7.5A | 15A | 10A | 6A | 3A |
| S833D | ✓ | ✓ | ✓ | 3PDT | ON 2-3 5-6 8-9 | OFF | ON 2-1 5-4 8-7 | 30A | 30A | 15A | 7.5A | 15A | 10A | 6A | 3A |

Throw & Schematics:



Note: Terminal numbers are on the switch

Notes: Standard Hardware: AT503M Face Hex Nut, AT506M Locking Ring, AT508 Lockwasher, AT527M Backup Hex Nut. See Accessories & Hardware section.

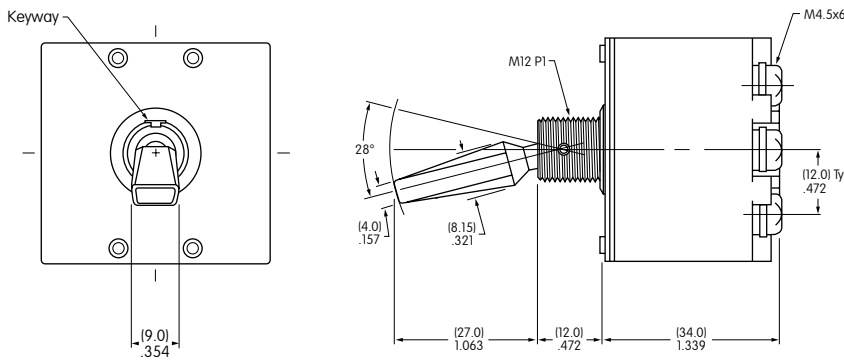

Three Pole

S831D does not have terminals 1, 4 & 7.
Positive (+) must be connected to end terminals & negative to common terminals



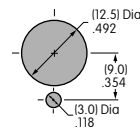

S832D



Maximum Panel Thickness: .177" (4.5mm)

Toggles
 Rockers
 Pushbuttons
 Illuminated PB
 Programmable
 Keylocks
 Rotaries
 Slides
 Tactiles
 Tilt
 Touch
 Indicators
 Accessories
 Supplement

DOUBLE POLE WITH SCREW LUG

| Model | Approvals UL SP | Pole & Throw | Toggle Position/Connected Terminals | | | Electrical Capacity | | | |
|-------|--------------------|--------------|---|---|---|---------------------|-----|-----------|-----|
| | | | Down  | Center  | Up  | Resistive | | Inductive | |
| | | | AC 125V | AC 250V | DC 30V | AC 125V PF 0.6 | | | |
| S732 | — — | DPDT | ON 2-3 5-6 | NONE | ON 2-1 5-4 | 50A | 30A | 50A | 25A |

Throw & Schematics:

DPDT

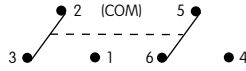

Note: Terminal numbers are on the switch

Notes: Standard Hardware: AT503M Face Hex Nut, AT506M Locking Ring, AT508 Lockwasher, AT527M Backup Hex Nut. See Accessories & Hardware section.

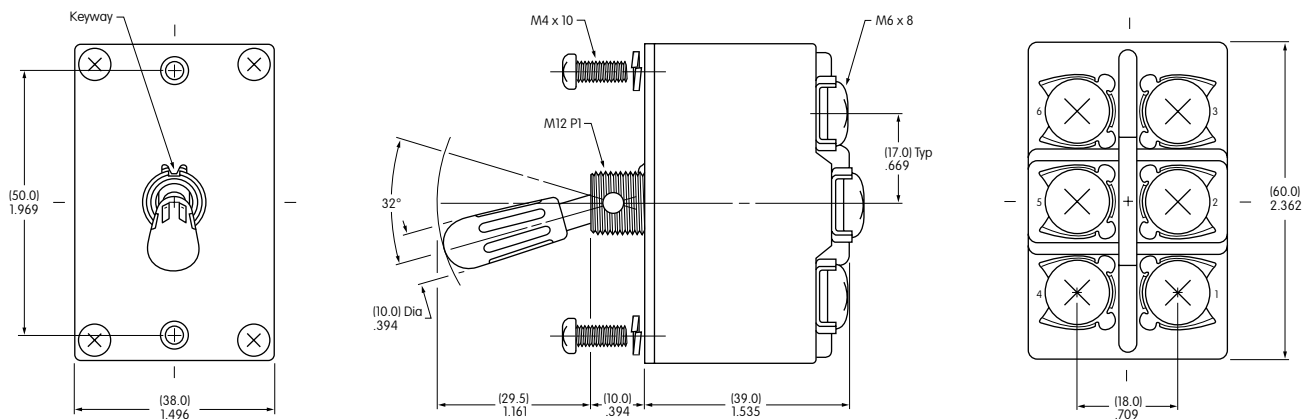

Cap of phenolic resin is black

Panel Mount with Mounting Screws

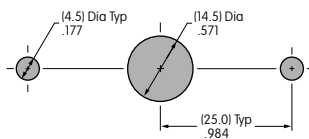

Maximum Panel Thickness: .158" (4.0mm)

Panel Mount with Bushing Hardware

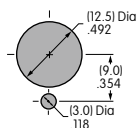

Maximum Panel Thickness: .079" (2.0mm)

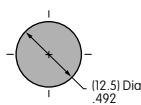

Maximum Panel Thickness: .118" (3.0mm)

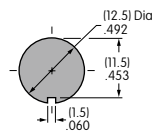

Maximum Panel Thickness: .118" (3.0mm)



S732