



Chipsmall Limited consists of a professional team with an average of over 10 year of expertise in the distribution of electronic components. Based in Hongkong, we have already established firm and mutual-benefit business relationships with customers from,Europe,America and south Asia,supplying obsolete and hard-to-find components to meet their specific needs.

With the principle of "Quality Parts,Customers Priority,Honest Operation,and Considerate Service",our business mainly focus on the distribution of electronic components. Line cards we deal with include Microchip,ALPS,ROHM,Xilinx,Pulse,ON,Everlight and Freescale. Main products comprise IC,Modules,Potentiometer,IC Socket,Relay,Connector.Our parts cover such applications as commercial,industrial, and automotives areas.

We are looking forward to setting up business relationship with you and hope to provide you with the best service and solution. Let us make a better world for our industry!



Contact us

Tel: +86-755-8981 8866 Fax: +86-755-8427 6832

Email & Skype: info@chipsmall.com Web: www.chipsmall.com

Address: A1208, Overseas Decoration Building, #122 Zhenhua RD., Futian, Shenzhen, China





REVISIONS				
DRAWN	REV	DESCRIPTION	DATE	APPROVED
PAM	-	ORIGINAL	12-5-03	JS
PAM	A	E DIMENSION ADDED, SB-4105 WAS .215-.185	1-14-04	JS
PAM	B	M3-0.5 WAS M3, REMOVED NOTE	2-2-04	JS
PAM	C	ADDED SB-4107 & SB 4114	2-17-04	JS
PAM	D	"NO CR6" NOTE ADDED	2-18-04	JS
PAM	E	.196± .006 WAS .194	7-12-04	JS
PAM	F	ITEM CODE CHANGES	6-07-05	JS
PAM	G	QC NOTE ADDED	9-1-06	JS
PAM	H	HEAD GEOMETRY BETTER DEFINED	8-15-07	JS
TC	09	UPDATED DRAWING AND REV FORMAT, CHANGED TO DUAL DIM, SHOULDER AND THREAD GEOMETRY BETTER DEFINED, REMOVED US AND ASIA ITEM CODES	6-18-12	MS

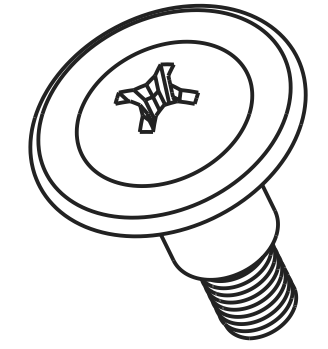
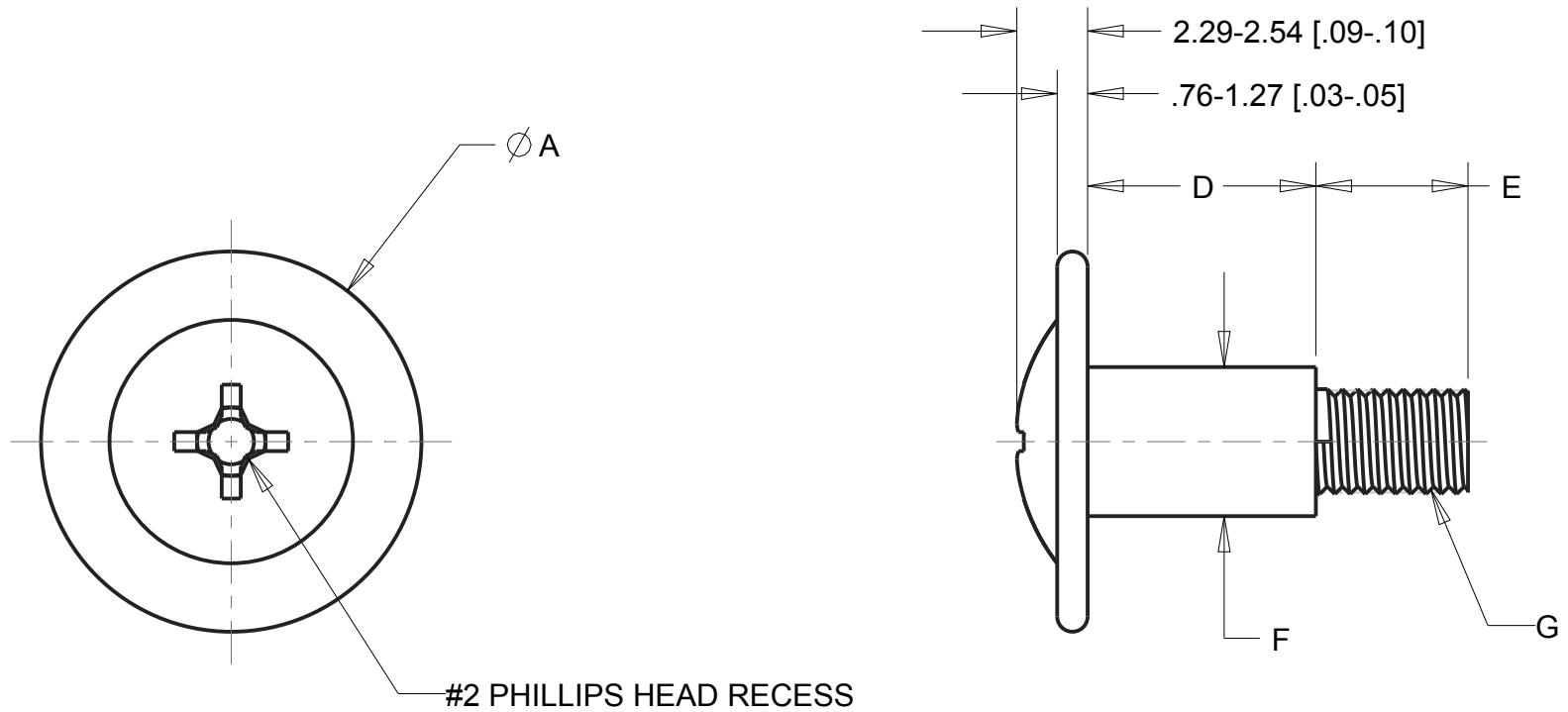

PART #	A: HEAD Ø	D: SHOULDER LENGTH	E: THREAD LENGTH	F: SHOULDER Ø	G: THREAD TYPE
SB-4102	8.89± .50 [.350± .020]	5.44± .13 [.214± .005]	4.70-5.46 [.185-.215]	4.09± .06 [.161± .0025]	6-32 UNC-2A
SB-4105	8.89± .50 [.350± .020]	5.44± .13 [.214± .005]	3.20-3.81 [.126-.150]	4.09± .06 [.161± .0025]	M3-0.5
SB-4107	8.89± .50 [.350± .020]	5.44± .13 [.214± .005]	4.70-5.46 [.185-.215]	4.09± .06 [.161± .0025]	M3-0.5
SB-4112	12.7± .50 [.500± .020]	7.62± .13 [.300± .005]	4.70-5.46 [.185-.215]	4.98± .15 [.196± .006]	6-32 UNC-2A
SB-4114	12.7± .50 [.500± .020]	7.62± .13 [.300± .005]	4.70-5.46 [.185-.215]	4.93± .06 [.194± .0025]	M4-0.7
SB-4118	12.7± .50 [.500± .020]	6.35± .13 [.250± .005]	4.70-5.46 [.185-.215]	4.78± .06 [.188± .0025]	6-32 UNC-2A

1. Zn COATING, Cr6 FREE, ASTM B-117 (72 HOURS).

NOTES:

UNLESS OTHERWISE SPECIFIED UNITS ARE: MM [IN] TOLERANCE FOR ANGLES: ±1.0°	MATERIAL: LOW CARBON STEEL	AEARO TECHNOLOGIES LLC * a 3M company		
	ALLOWABLE FLASH: N/A	QUALITY CONTROL: MUST COMPLY WITH E-A-R SPECIALTY COMPOSITES SUPPLIER QUALITY MANUAL REQUIREMENTS	TITLE MACHINE SCREW - PHILLIPS - WITH SHOULDER	
GATE: N/A	NOTES: ANY FEATURE NOT DIMENSIONED IN PRINT MUST BE VISIBLY PRESENT, UTILIZE 3D CAD FOR CREATION	SIZE B	DRAWING NO. SB-41XX	PAGE NO. 1 OF 1
CALC WT.				