



Chipsmall Limited consists of a professional team with an average of over 10 year of expertise in the distribution of electronic components. Based in Hongkong, we have already established firm and mutual-benefit business relationships with customers from,Europe,America and south Asia,supplying obsolete and hard-to-find components to meet their specific needs.

With the principle of "Quality Parts,Customers Priority,Honest Operation,and Considerate Service",our business mainly focus on the distribution of electronic components. Line cards we deal with include Microchip,ALPS,ROHM,Xilinx,Pulse,ON,Everlight and Freescale. Main products comprise IC,Modules,Potentiometer,IC Socket,Relay,Connector.Our parts cover such applications as commercial,industrial, and automotives areas.

We are looking forward to setting up business relationship with you and hope to provide you with the best service and solution. Let us make a better world for our industry!



Contact us

Tel: +86-755-8981 8866 Fax: +86-755-8427 6832

Email & Skype: info@chipsmall.com Web: www.chipsmall.com

Address: A1208, Overseas Decoration Building, #122 Zhenhua RD., Futian, Shenzhen, China



THIS COPY IS PROVIDED ON A RESTRICTED BASIS AND IS NOT TO BE USED IN ANY WAY DETRIMENTAL TO THE INTERESTS OF PANDUIT CORP.

NOTES:

- HIGH STRENGTH ELECTROLYTIC COPPER HIGHLY RESISTANT TO CORROSION AND SEASON CRACKING.
- ELECTRO-TIN PLATED BOLT. NUT SPACER AND PRESSURE BAR.
- WHEN CONNECTING ALUMINUM OR ACSR WIRE, USE OF PANDUIT OXIDE JOINT COMPOUND CMP-100 IS RECOMMENDED.
- UL LISTED & CSA CERTIFIED (FOR APPLICABLE PARTS) WITH COPPER AND ALUMINUM CABLE.
- *THE CONDUCTOR SIZES SHOWN ARE FOR EQUAL RUN AND TAP COMBINATIONS FOR BOTH SOLID AND STRANDED WIRE UNLESS OTHERWISE LISTED.



AL9CU LISTED



LISTED 47FL



CERTIFIED

CATALOG NUMBER	COPPER & ALUMINUM		MIN. TAP WITH ONE MAX RUN	APPROXIMATE DIMENSIONS - INCHES				INSTALLATION TORQUE
	RANGE OF EQUAL RUN & TAP			A	B	C	D	
	MIN.	MAX						
SBCT8-C	8 STR	6 SOL	14 STR	0.16	0.41	0.63	1.06	165
SBCT6-C	6 STR	10 STR	10 STR	0.21	0.49	0.68	1.10	165
SBCT3-C	8 STR	4 STR	10 STR	0.27	0.58	0.81	1.24	275.00
SBCT2-C	6 STR	2 STR	14 STR	0.31	0.60	0.86	1.45	275
SBCT1/0-L	4 STR	1/0 STR	10 STR	0.37	0.75	0.93	1.73	385
SBCT2/0-L	2 STR	2/0 STR	8 STR	0.42	0.79	1.05	1.71	385.00

CATALOG NUMBER	COPPER		MIN. TAP WITH ONE MAX RUN	APPROXIMATE DIMENSIONS - INCHES				INSTALLATION TORQUE
	RANGE OF EQUAL RUN & TAP			A	B	C	D	
	MIN.	MAX						
SBCT3/0-Q	1 STR	3/0 STR	8 STR	0.53	0.95	1.25	2.12	500
SBCT250-Q	1 STR	250 kcmil	8 STR	0.58	1.03	1.36	2.22	650
SBCT350-1	2/0 STR	350 kcmil	1/0 STR	0.7	1.17	1.49	2.55	650
SBCT500-1	300 kcmil	500 kcmil	2/0 STR	0.82	1.32	1.74	2.95	825

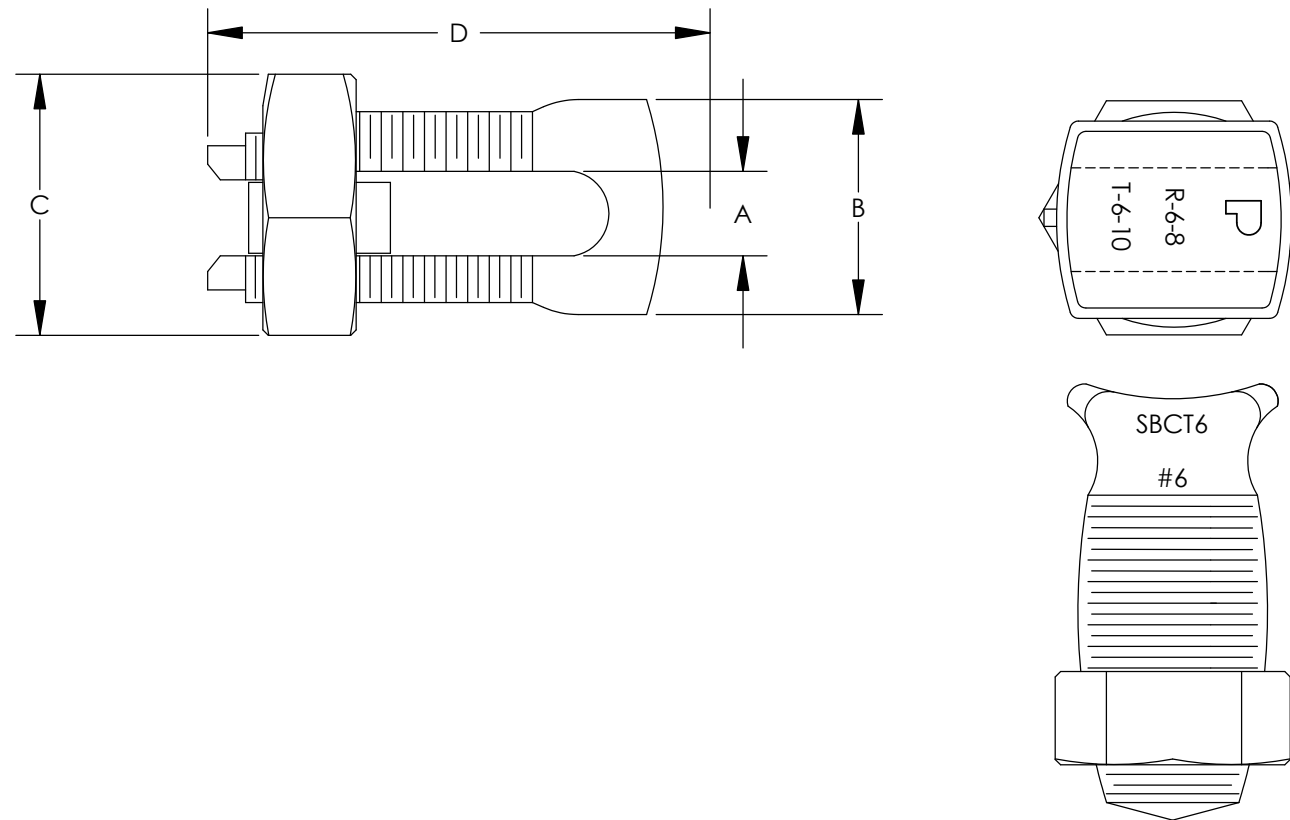

								PANDUIT CORP. TINLEY PARK, ILLINOIS	
								SBCT SERIES - COPPER DUAL RATED SPLIT BOLT CONNECTOR CUSTOMER DRAWING	
								UNLESS OTHERWISE SPECIFIED DIMENSIONAL TOLERANCES ARE: (.X) ± (.XXX) ± (.XX) ± ANGLES ±	
								UNLESS OTHERWISE SPECIFIED, ALL DIMENSIONS ARE GIVEN IN INCHES, THIRD ANGLE PROJECTION	
03	11/07	JHNU	JHNU	REVISED WIRE RANGE TABLE TO MATCH CATALOG				DRAWN BY JHNU	MAT'L: SEE NOTE 1 ABOVE
02	7/07	JHNU	JAC	REVISED UL LOGO				DATE 5/07	SCALE NONE
01	7/07	JHNU	JAC	REVISED RUN AND TAP COLUMN TO REFLECT SPEC.				CHK'D	DRAWING NO / CAD FILE C41511_03
00	5/07	JHNU	SRBI	DRAWING RELEASED					DWG B SIZE
REV	DATE	BY	CHK	DESCRIPTION	ECN	CUST	QA	APP	