



Chipsmall Limited consists of a professional team with an average of over 10 year of expertise in the distribution of electronic components. Based in Hongkong, we have already established firm and mutual-benefit business relationships with customers from,Europe,America and south Asia,supplying obsolete and hard-to-find components to meet their specific needs.

With the principle of “Quality Parts,Customers Priority,Honest Operation,and Considerate Service”,our business mainly focus on the distribution of electronic components. Line cards we deal with include Microchip,ALPS,ROHM,Xilinx,Pulse,ON,Everlight and Freescale. Main products comprise IC,Modules,Potentiometer,IC Socket,Relay,Connector.Our parts cover such applications as commercial,industrial, and automotives areas.

We are looking forward to setting up business relationship with you and hope to provide you with the best service and solution. Let us make a better world for our industry!



Contact us

Tel: +86-755-8981 8866 Fax: +86-755-8427 6832

Email & Skype: info@chipsmall.com Web: www.chipsmall.com

Address: A1208, Overseas Decoration Building, #122 Zhenhua RD., Futian, Shenzhen, China



REVISIONS				
REV	ECO	DESCRIPTION	DATE	BY APPR
B1	-	RELEASE NEW DWG FORMAT	06/16/14	TOD TOMMY
B2	-	UPDTAED SPECIFICATION	09/14/15	TOD TOMMY

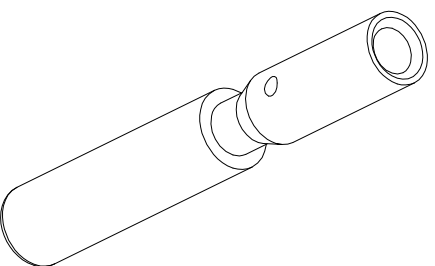
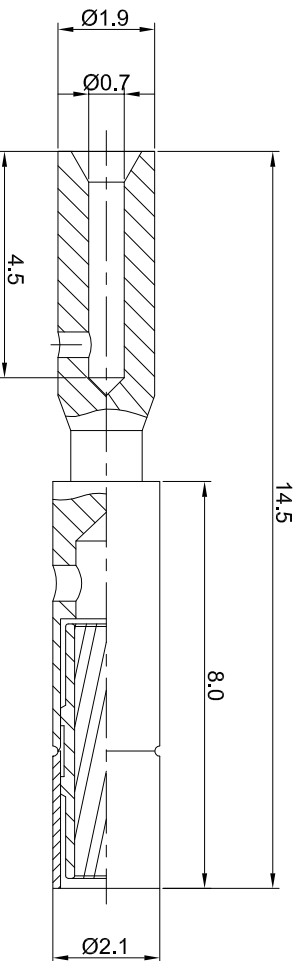

- NOTES: UNLESS OTHERWISE SPECIFIED
- MATERIAL: COPPER ALLOY, GOLD PLATED
 - SPECIFICATIONS:
 - 2.1 RATED CURRENT: 10 AMPS
 - 2.2 CONTACT RESISTANCE: <5 milliohm
 - 2.3 AVAILABLE WIRE RANGE: 28AWG~24AWG
 - 2.4 ROHS COMPLANT
 - ALL DIMENSIONS ARE FOR REFERENCE USE ONLY.

TITLE:

Socket contact,20#,Chmp 28-24AWG

DWG NO:

SC000030

REV: B2

SH: 1

OF: 1

QUANTITY	SEE PART NUMBER CHART	PART NUMBER	DESCRIPTION	ITEM
MATERIALS LIST				
UNLESS OTHERWISE SPECIFIED				
1) All dimensions are in millimeters.				
2) Tolerances are as follows:				
1 Pt. DEC 20.030 Fractions 1/164				
2 Pt. DEC 20.030 Fractions 1/164				
3 Pt. DEC 20.030 Fractions 1/164				
3) Note reference = A				
MATERIAL SPECIFICATIONS:				
CUSTOMER:				
THE DRAWING IS SUPPLIED FOR INFORMATION ONLY. DESIGN FEATURES, SPECIFICATIONS AND PERFORMANCE DATA ARE SUBJECT TO CHANGE WITHOUT NOTICE. THE APPLICABLE CORPORATION HAS RIGHTS OF REPRODUCTION AND ALL RIGHTS OF REPRODUCTION ARE RESERVED. ALL MANUFACTURING VARIATIONS.				
PROCESS SPECIFICATIONS:				
NEXT ASSY:				
DRAWN: tod		DATE: 09/14/15		
CHECKED:				
ENGINEER:				
APPROVAL:				
SIZE: B		TYPE: C-		DWG NO: SC000030
SCALE: NONE				REVISION: B2
		Socket contact,20#,Chmp 28-24AWG		SHEET 1 OF 1

Amphenol

Sine Systems - www.amphenol-sine.com
44724 Motley Drive
Clifton Township, MI 48036

Socket contact,20#,Chmp 28-24AWG