



Chipsmall Limited consists of a professional team with an average of over 10 year of expertise in the distribution of electronic components. Based in Hongkong, we have already established firm and mutual-benefit business relationships with customers from,Europe,America and south Asia,supplying obsolete and hard-to-find components to meet their specific needs.

With the principle of “Quality Parts,Customers Priority,Honest Operation,and Considerate Service”,our business mainly focus on the distribution of electronic components. Line cards we deal with include Microchip,ALPS,ROHM,Xilinx,Pulse,ON,Everlight and Freescale. Main products comprise IC,Modules,Potentiometer,IC Socket,Relay,Connector.Our parts cover such applications as commercial,industrial, and automotives areas.

We are looking forward to setting up business relationship with you and hope to provide you with the best service and solution. Let us make a better world for our industry!



Contact us

Tel: +86-755-8981 8866 Fax: +86-755-8427 6832

Email & Skype: info@chipsmall.com Web: www.chipsmall.com

Address: A1208, Overseas Decoration Building, #122 Zhenhua RD., Futian, Shenzhen, China



THIS DRAWING IS UNPUBLISHED
 VERTRAULICHE UNVERÖFFENTLICHTE ZEICHNUNG
 © COPYRIGHT - By -
 RELEASED FOR PUBLICATION
 FREI FUER VERÖFFENTLICHUNG
 ALL RIGHTS RESERVED.
 ALLE RECHTE VORBEHALTEN

| | | | | | | | | |
|--|-----------|-----------|-------------------------|-----|-------------------------------|---------|-------|---------|
| MATED WITH PASSEND ZU: DIN 46247 | LOC A1 | DIST - | REVISIONS ÄNDERUNGEN | | | | | |
| PROJEKT NR: E97-9621 | | | P | LTR | DESCRIPTION BESCHREIBUNG | DATE | DWN | APVD |
| | | | | C | NEW CAD-DRAWING | 04JAN97 | STOLZ | FELDMER |
| | | | | D1 | MIN.2.5µm Cu WAS MIN.1.5µm Cu | 25FEB03 | STOLZ | FELDMER |
| | | | | D2 | ECR-10-022530 | 07JAN11 | KK | HMR |

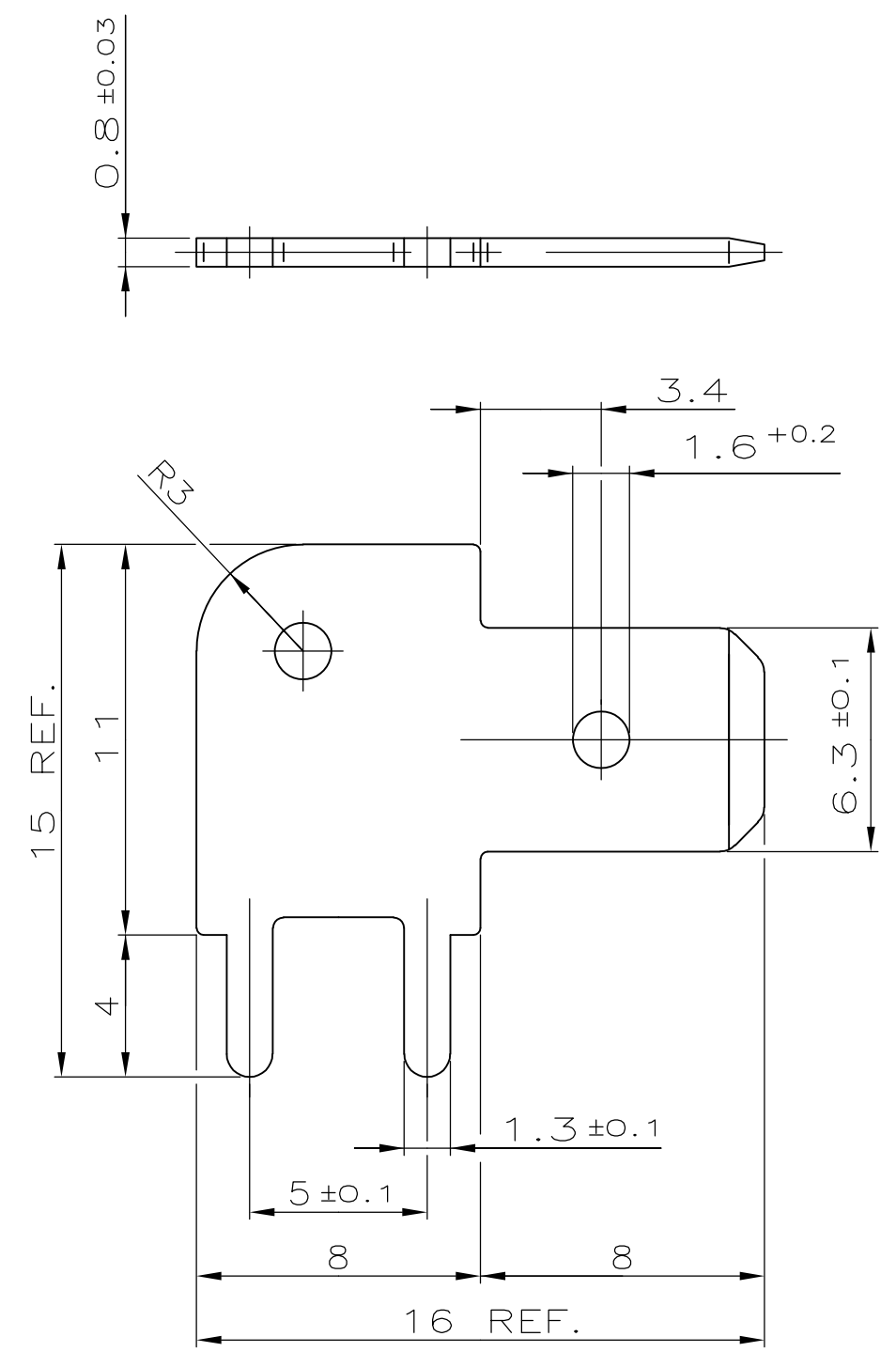

- ① MIN. 4.5 µm Sn OVER MIN. 2.5 µm Cu
 - ② PACKING: MAX. 3000 PIECES
PACKED INTO CARDBOARD BOX
 - ③ RECOMMENDED DIA. FOR PCB: Ø1.4 -0.1
-
- ① MIN. 4.5 µm Sn ÜBER MIN. 2.5 µm Cu
 - ② VERPACKUNG: MAX. 3000 TEILE
IN KARTON VERPACKT
 - ③ EMPFOHLENE LEITERPLATTENBOHRUNG: Ø1.4 -0.1

| | | | |
|----------|--------------------------------|-----------------------|----------|
| | 726387-2 | ① | CuZn |
| OBSOLETE | -726387-1- | PLAIN BLANK | CuZn |
| | TE ORDER NO. BESTELL-NR. | SURFACE OBERFLÄCHE | MATERIAL |
| | | COLOUR/FARBE | |

| | | | | | | | |
|--|--|---|-----------|--|-----------|------------------------------|--|
| THIS DRAWING IS A CONTROLLED DOCUMENT. DIESE ZEICHNUNG IST EIN KONTROLLIERTES DOKUMENT. | | DWN RICHTER | 01-DEC-86 | TE Connectivity | | | |
| DIMENSIONS: mm | | CHK | - | | | | |
| TOLERANCES UNLESS OTHERWISE SPECIFIED: ALLGEMEINTOLERANZEN n. Tolerierung ISO 8015 | | APVD | - | FASTON TAB 6.3 x 0.8 FLACHSTECKER 6.3 x 0.8 | | | |
| 0 PLC ± 0.2 | | PRODUCT SPEC PRODUKTSPEZ. | - | DRAWING NO ZEICHNUNGS-NR. | | | |
| 1 PLC ± - | | ACCORDING TO DIN 46244 | - | SIZE | CAGE CODE | DRAWING NO ZEICHNUNGS-NR. | |
| 2 PLC ± - | | APPLICATION SPEC VERARBEITUNGSSPEZ. | - | A3 | 00779 | G-726387 | |
| 3 PLC ± - | | | - | RESTRICTED TO NUR FUER | | - | |
| 4 PLC ± - | | | - | SCALE MASSTAB 5:1 | | | |
| ANGLES / WINKEL ± - | | WEIGHT GEWICHT | - | SHEET BLATT 1 OF 1 | | REV D2 | |
| MATERIAL SEE TABLE SIEHE TABELLE | | FINISH / OBERFLÄCHE / FARBE SEE TABLE SIEHE TABELLE | | CUSTOMER DRAWING / KUNDENZEICHNUNG | | | |