



Chipsmall Limited consists of a professional team with an average of over 10 year of expertise in the distribution of electronic components. Based in Hongkong, we have already established firm and mutual-benefit business relationships with customers from,Europe,America and south Asia,supplying obsolete and hard-to-find components to meet their specific needs.

With the principle of “Quality Parts,Customers Priority,Honest Operation,and Considerate Service”,our business mainly focus on the distribution of electronic components. Line cards we deal with include Microchip,ALPS,ROHM,Xilinx,Pulse,ON,Everlight and Freescale. Main products comprise IC,Modules,Potentiometer,IC Socket,Relay,Connector.Our parts cover such applications as commercial,industrial, and automotives areas.

We are looking forward to setting up business relationship with you and hope to provide you with the best service and solution. Let us make a better world for our industry!



## Contact us

Tel: +86-755-8981 8866 Fax: +86-755-8427 6832

Email & Skype: info@chipsmall.com Web: www.chipsmall.com

Address: A1208, Overseas Decoration Building, #122 Zhenhua RD., Futian, Shenzhen, China



THIS COPY IS PROVIDED ON A RESTRICTED BASIS AND IS NOT TO BE USED IN ANY WAY DETRIMENTAL TO THE INTERESTS OF PANDUIT CORP.

PANDUIT PART NUMBER	COPPER CONDUCTOR SIZE	EXPANDED WIRE RANGE**	BARREL		OVERALL LENGTH "A" ± .12	WIRE STRIP LENGTH	PANDUIT CRIMP TOOL PART NUMBERS			
			I.D. ± .01	O.D. ± .01			CT-720	CT-920, CT-920CH, CT-930, CT-930CH, CT-940CH, CT-2920, CT-2940*	CT-2001	CT-2950*** CT-2980 CT-980 CT-980CH
							DIE PART NO./ DIE SET COLOR & INDEX NO./ NUMBER OF CRIMPS			
SCL300-X	300 MCM	#2/0-300 MCM	.650	.813	4.12	2	CD-720-4 WHITE P66 4 CRIMPS	CD-920-300 WHITE P66 3 CRIMPS	CD-2001-300 WHITE P66 3 CRIMPS	STD 3 CRIMPS
SCL350-X	350 MCM	#3/0-350 MCM	.700	.875	4.12	2	CD-720-5 RED P71 4 CRIMPS	CD-920-350 RED P71 3 CRIMPS	CD-2001-350 RED P71 3 CRIMPS	STD 3 CRIMPS
SCL400-6	400 MCM	#4/0-400 MCM	.762	.950	4.37	2-1/8	CD-720-6 BLUE P76 4 CRIMPS	CD-920-400 BLUE P76 3 CRIMPS	CD-2001-400 BLUE P76 4 CRIMPS	STD 3 CRIMPS
SCL500-6	500 MCM	#4/0-500 MCM	.836	1.059	4.62	2-1/4	CD-720-7 BROWN P87 4 CRIMPS	CD-920-500 BROWN P87 3 CRIMPS	CD-2001-500 BROWN P87 4 CRIMPS	STD 3 CRIMPS
SCL600-6	600 MCM	250-600 MCM	.923	1.187	5.50	2-11/16	—	CD-920-600 GREEN P94 4 CRIMPS	—	STD 4 CRIMPS
SCL750-6	750 MCM	500-750 MCM	1.031	1.299	5.87	2-7/8	—	CD-920-750 BLACK P106 4 CRIMPS	—	STD 4 CRIMPS
SCL1000-3	1000 MCM	—	1.173	1.500	6.12	3	—	—	—	—

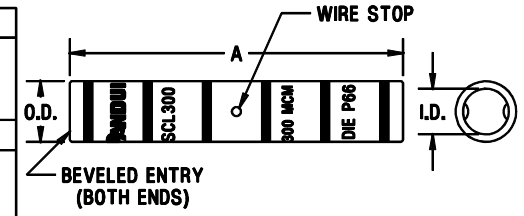

**NOTES:**

1. MATERIAL - HIGH CONDUCTIVITY SEAMLESS COPPER TUBING.
2. ELECTRO-TIN PLATED.
3. BARREL COLOR CODED WITH DIE SET INDEX NUMBER.
4. UL LISTED WITH CODE COPPER CONDUCTORS FOR APPLICATIONS UP TO 35 KV, FILE E52164.
5. CONSULT CABLE MANUFACTURER FOR VOLTAGE STRESS RELIEF INSTRUCTIONS WITH APPLICATIONS GREATER THAN 2000 VOLTS.
6. CSA CERTIFIED FOR APPLICATIONS UP TO 600 V, FILE LR31212.
7. FOR USE WITH COPPER CABLES ONLY.

\* CD-920 DIES CAN BE USED WITH CT-940CH AND CT-2940 TOOLS WITH CD-940-DA ADAPTER  
 \*\* WITH CT-980, CT-980CH, CT-2950 & CT-2980  
 \*\*\* MAX SIZE 500 MCM



CAD FILENAME/LAYERS										C41132_03		
<b>PANDUIT</b> CORP. TINLEY PARK, ILLINOIS												
<b>SCL STANDARD BARREL #300 THRU 1000 COPPER SPLICES</b>												
03	4/01	BDK	ADD THE LETTER "M" TO THE DIE INDEX NUMBER. ADD TO CT-2950, CT-2980, CT-980 & CT-980CH. CHANGE NUMBER WHO WITH SCL 300 TO 350. REWORK ALTERNATE DIE INDEX NUMBER NOTE. REVISED UL/CSA LOGOS. ADD EXPANDED WIRE RANGE.						UNLESS OTHERWISE SPECIFIED, DIMENSIONAL TOLERANCES ARE: 1.X1 ± 1.XX1 ± ANGLES ±		UNLESS OTHERWISE SPECIFIED, ALL DIMENSIONS ARE GIVEN IN INCHES, THIRD ANGLE PROJECTION	
02	3.94	WB	ADDITIONAL NOTES ADDED.						KS			
01	11-93	PWS	FILESPEC WAS C41106 & DWG WAS C41106						01884	RM	LA	SCALE N/A
00	3-93	PWS	RELEASED						01415			DATE 3-10-93
REV	DATE	BY	CHK	DESCRIPTION				ECN	PM	CUST	DRYD GRM	SEE NOTES ABOVE
												C41132