



Chipsmall Limited consists of a professional team with an average of over 10 year of expertise in the distribution of electronic components. Based in Hongkong, we have already established firm and mutual-benefit business relationships with customers from,Europe,America and south Asia,supplying obsolete and hard-to-find components to meet their specific needs.

With the principle of "Quality Parts,Customers Priority,Honest Operation,and Considerate Service",our business mainly focus on the distribution of electronic components. Line cards we deal with include Microchip,ALPS,ROHM,Xilinx,Pulse,ON,Everlight and Freescale. Main products comprise IC,Modules,Potentiometer,IC Socket,Relay,Connector.Our parts cover such applications as commercial,industrial, and automotives areas.

We are looking forward to setting up business relationship with you and hope to provide you with the best service and solution. Let us make a better world for our industry!



Contact us

Tel: +86-755-8981 8866 Fax: +86-755-8427 6832

Email & Skype: info@chipsmall.com Web: www.chipsmall.com

Address: A1208, Overseas Decoration Building, #122 Zhenhua RD., Futian, Shenzhen, China



THIS COPY IS PROVIDED ON A RESTRICTED BASIS AND IS NOT TO BE USED IN ANY WAY DETRIMENTAL TO THE INTERESTS OF PANDUIT CORP.

ALL DIMENSIONS ARE IN mm									
Part Number	Class 2r Wire Size	Class 5f & 6f Wire Size	Wire Strip Length	Panduit Die Index No. For Class 2r Wire Circumferential Dies	Panduit Die Index No. For Class 5f & 6f Wire Circumferential Dies	Panduit Die Index No. For Class 5f & 6f Wire Nest/Indentor Dies	$l \pm 2.76$	$o \pm .50$	$i \pm .50$
SCMS10-C	10mm ²	----	16.5	P21	----	----	30.0	6.20	4.50
SCMS16-C	16mm ²	10mm ²	19.0	P24	P21	P29/1	35.0	7.20	5.50
SCMS25-L	25mm ²	16mm ²	19.5	P29	P21	P29/1	36.0	8.80	6.90
SCMS35-L	35mm ²	25mm ²	19.5	P29	P29	P42/2	36.0	10.40	8.20
SCMS50-L	50mm ²	35mm ²	26.0	P37	P33	P50/2	49.0	12.30	9.80
SCMS70-L	70mm ²	50mm ²	27.5	P45	P37	P50/2	52.0	14.20	11.50
SCMS95-Q	95mm ²	70mm ²	28.5	P54	P45	P62/4	54.0	16.50	13.50
SCMS120-Q	120mm ²	95mm ²	30.0	P62	P50	P76/4	57.0	18.60	15.20
SCMS150-X	150mm ²	120mm ²	30.0	P66	----	P76/4	57.0	21.00	16.50
SCMS185-X	185mm ²	150mm ²	32.0	P76	----	P76/4	61.0	23.00	18.60
SCMS240-X	240mm ²	185mm ²	37.5	P87	----	P87/4	72.0	26.00	20.80
SCMS300-5	300mm ²	240mm ²	39.0	P94	----	P106/6	75.0	29.00	23.50
SCMSX300-5	----	300mm ²	49.0	----	----	P32/6	95.0	33.00	26.20
SCMS400-5	400mm ²	----	49.0	P106	----	----	95.0	34.50	27.00
SCMS500-6	500mm ²	----	49.5	P125	----	----	96.0	40.00	31.00
SCMS630-6	630mm ²	----	67.0	P125	----	----	131.0	44.00	34.50

NOTES:

1. Material: High conductivity seamless copper tube.
2. Plating: Parts are annealed and tin plated.
3. Wire Type: Class 2r, 5f & 6f Stranded Copper per DIN VDE 0295, IEC 60228 and HD 383.
4. UL Listed Wire Connector: Yes, for applications up to 35kv. Consult cable manufacturer for voltage stress relief instruction with applications greater than 2000 volts.
5. UL Temperature Rating: 90° C
6. C.S.A. Certified Wire Connector: Yes
7. Parts are CE and tested per EN 61238-1:2003/IEC 61238-1:2003 Class B, with Class 2r wire 10mm² - 240mm².

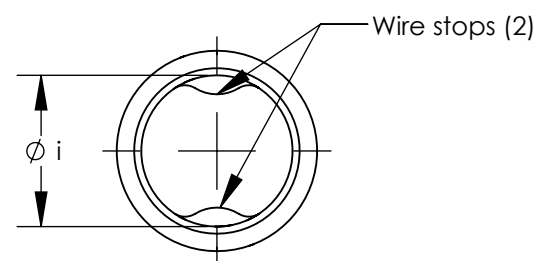
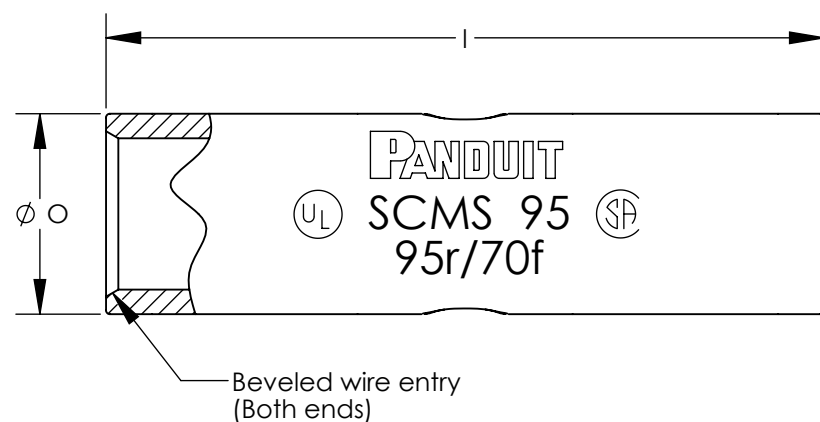

LISTED Wire Connector



CERTIFIED

REV	DATE	BY	CHK	APR	DESCRIPTION	ECN
00	6/14	JHNU	TLCO	RGB	DRAWING RELEASED	13J059BI-JC

TITLE METRIC SPLICES - SCMS SERIES 10-630mm CUSTOMER DRAWING	
ITEM REVISION NAME 12J059BI/00	PANDUIT
DATASET FILE NAME 12J059BI-JC/00.SLDDRW	
UNLESS OTHERWISE SPECIFIED, DIMENSIONAL TOLERANCES ARE: IN [mm] .X ± .XXX ± .XX ± ANGLES ±	
THIRD ANGLE PROJECTION	MATERIAL SEE NOTES
DRAWN BY JHNU	DRAWING NUMBER 12J059BI-JC
DATE 6/14	SIZE B
CHK TLCO	SHEET 1 OF 1
SCALE NONE	