



Chipsmall Limited consists of a professional team with an average of over 10 year of expertise in the distribution of electronic components. Based in Hongkong, we have already established firm and mutual-benefit business relationships with customers from,Europe,America and south Asia,supplying obsolete and hard-to-find components to meet their specific needs.

With the principle of “Quality Parts,Customers Priority,Honest Operation,and Considerate Service”,our business mainly focus on the distribution of electronic components. Line cards we deal with include Microchip,ALPS,ROHM,Xilinx,Pulse,ON,Everlight and Freescale. Main products comprise IC,Modules,Potentiometer,IC Socket,Relay,Connector.Our parts cover such applications as commercial,industrial, and automotives areas.

We are looking forward to setting up business relationship with you and hope to provide you with the best service and solution. Let us make a better world for our industry!



Contact us

Tel: +86-755-8981 8866 Fax: +86-755-8427 6832

Email & Skype: info@chipsmall.com Web: www.chipsmall.com

Address: A1208, Overseas Decoration Building, #122 Zhenhua RD., Futian, Shenzhen, China



PART NAME

RELAY RACK PANELS

PART NO.

PA-1101 THRU PA-1112 / PS-1250 THRU PS-1261
SFA-1831 THRU SFA-1842

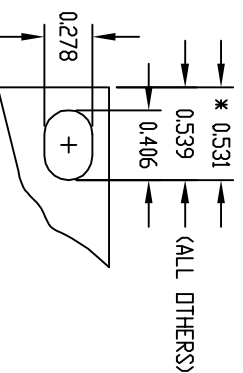
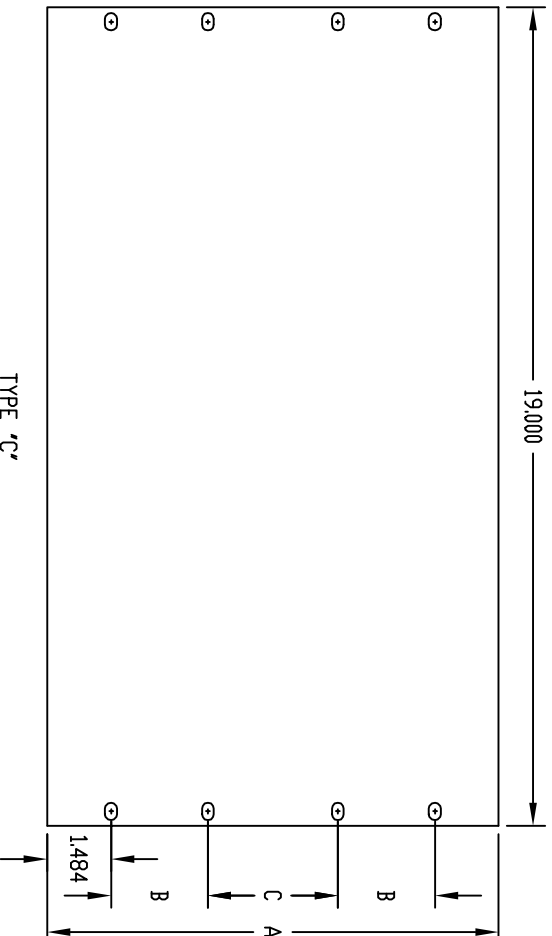
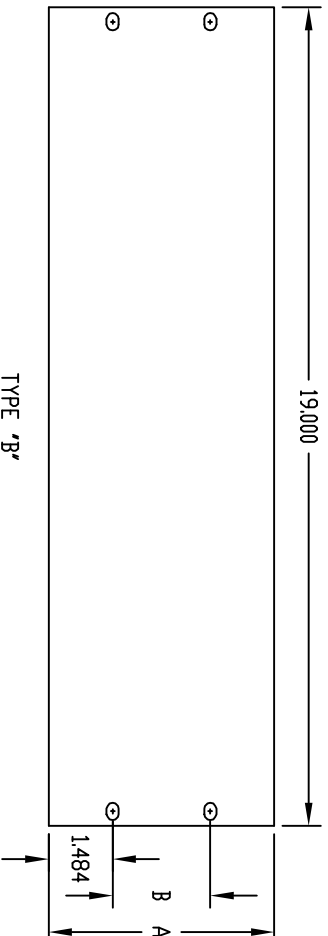
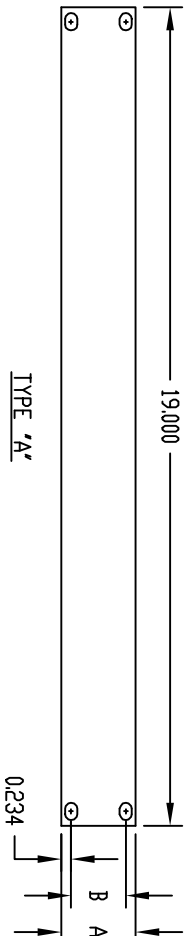

'PA' SERIES:
MATERIAL: 0,125 ALUMINIUM
FINISH: METALLIC GRAY
WHITE TEXTURED
BLACK TEXTURED

'PS' SERIES:
MATERIAL: 11 GA. STEEL
FINISH: METALLIC GRAY
WHITE TEXTURED

'SFA' SERIES:
MATERIAL: 0,125 ALUMINIUM
ONE SIDE TAPED
FINISH: NATURAL

* - THIS DIMENSION APPLIES TO ONLY
PA-1101 & PA-1102
SFA-1831 & SFA-1832

'PA' SERIES	'PS' SERIES	'SFA' SERIES	TYPE	A	B	C
PA-1101	PS-1250	SFA-1831	A	1,750	1,250	-
PA-1102	PS-1251	SFA-1832	A	3,500	3,000	-
PA-1103	PS-1252	SFA-1833	B	5,250	2,250	-
PA-1104	PS-1253	SFA-1834	B	7,000	4,000	-
PA-1105	PS-1254	SFA-1835	B	8,750	5,750	-
PA-1106	PS-1255	SFA-1836	C	10,500	2,250	3,000
PA-1107	PS-1256	SFA-1837	C	12,250	3,500	2,250
PA-1108	PS-1257	SFA-1838	C	14,000	4,000	3,000
PA-1109	PS-1258	SFA-1839	C	15,750	4,000	4,750
PA-1110	PS-1259	SFA-1840	C	17,500	4,000	6,500
PA-1111	PS-1260	SFA-1841	C	19,250	5,250	5,750
PA-1112	PS-1261	SFA-1842	C	21,000	5,250	7,500