



Chipsmall Limited consists of a professional team with an average of over 10 year of expertise in the distribution of electronic components. Based in Hongkong, we have already established firm and mutual-benefit business relationships with customers from,Europe,America and south Asia,supplying obsolete and hard-to-find components to meet their specific needs.

With the principle of “Quality Parts,Customers Priority,Honest Operation,and Considerate Service”,our business mainly focus on the distribution of electronic components. Line cards we deal with include Microchip,ALPS,ROHM,Xilinx,Pulse,ON,Everlight and Freescale. Main products comprise IC,Modules,Potentiometer,IC Socket,Relay,Connector.Our parts cover such applications as commercial,industrial, and automotives areas.

We are looking forward to setting up business relationship with you and hope to provide you with the best service and solution. Let us make a better world for our industry!



## Contact us

Tel: +86-755-8981 8866 Fax: +86-755-8427 6832

Email & Skype: info@chipsmall.com Web: www.chipsmall.com

Address: A1208, Overseas Decoration Building, #122 Zhenhua RD., Futian, Shenzhen, China



# PART NUMBER CODING

SFH210-PP C-D -ID-BK-M181

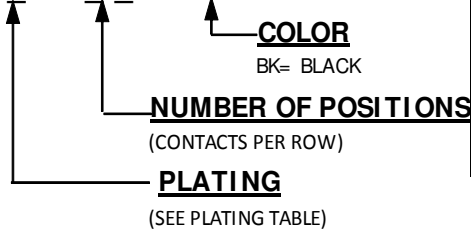

PLATING TABLE	
(.000030" MIN NICKEL UNDERPLATE)	
CONTACT SURFACE	TERMINATION
P = GOLD FLASH	GOLD FLASH
V = GOLD FLASH	NICKEL
K = .000015" GOLD	NICKEL
J = .000015" GOLD	GOLD FLASH
E = .000100" PURE TIN, MATTE	.000100" PURE TIN, MATTE

REVISIONS				
REV.	ECO. NO	DESCRIPTION	DATE	BY
C	2818	UPDATE POSITION 04 FRONT VIEW	02/18/2014	LH
D	3374	UPDATE POSITION 03 VIEW AND REMOVE 30 AND 32 POSITION OF DIMENSION .047[1.20] ON PAGE 2	02/01/2016	LH
E	3697	ADD 30 AND 32 POSITIONS DIM B TOLERANCE	06/16/2017	LH

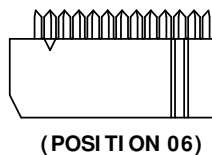
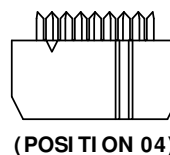
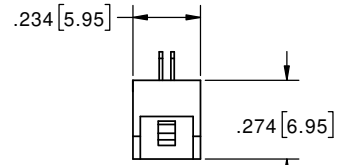
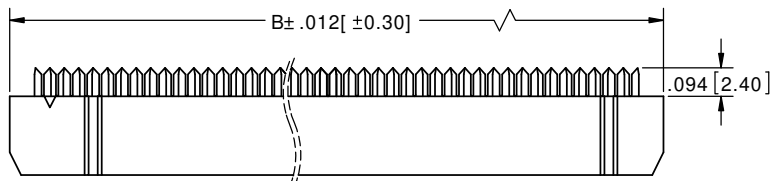
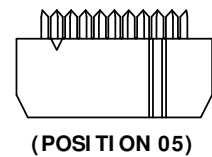
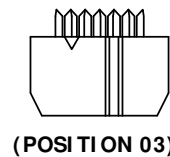
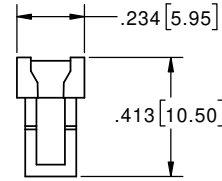
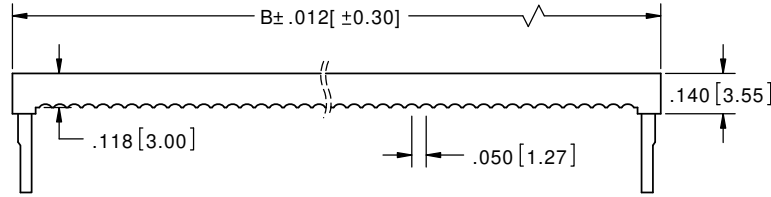

(POSITION 07 THRU 25)

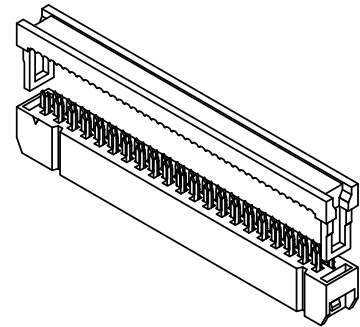
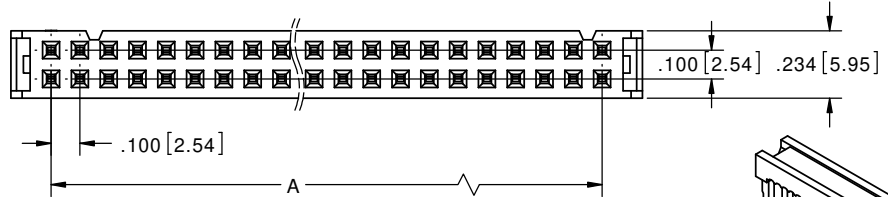

- NOTES:
- INSULATOR MATERIAL: PBT 30% GLASS FIBER.
  - CONTACT MATERIAL: PHOSPHOR BRONZE.
  - OPERATING TEMPERATURE: -40 °C TO +105 °C.
  - UL FLAMMABILITY RATING: 94V-0.
  - CURRENT RATING: 1 AMP
  - INSULATION RESISTANCE: 3,000 MEGOMHS MIN.
  - CONTACT RESISTANCE: 30m OHMS MAX.
  - DIELECTRIC WITHSTANDING: 500 V AC.
  - MATES WITH SBH11 SERIES
  - FOR .050" [1.27mm] PITCH FLAT RIBBON CABLE, 26 - 28 AWG WIRE RANGE.
  - M181 DENOTES PART W/O POLARIZING KEY.

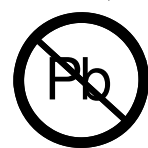

RoHS COMPLIANT

PART NUMBER	POSITIONS/ CONTACTS	A		B	
		INCH	MM	INCH	MM
SFH210-PP_C-D03-ID-BK-M181	03/06	0.200	5.08	0.480	12.18
SFH210-PP_C-D04-ID-BK-M181	04/08	0.300	7.62	0.580	14.72
SFH210-PP_C-D05-ID-BK-M181	05/10	0.400	10.16	0.680	17.26
SFH210-PP_C-D06-ID-BK-M181	06/12	0.500	12.70	0.780	19.80
SFH210-PP_C-D07-ID-BK-M181	07/14	0.600	15.24	0.880	22.34
SFH210-PP_C-D08-ID-BK-M181	08/16	0.700	17.78	0.980	24.88
SFH210-PP_C-D09-ID-BK-M181	09/18	0.800	20.32	1.080	27.42
SFH210-PP_C-D10-ID-BK-M181	10/20	0.900	22.86	1.180	29.96
SFH210-PP_C-D12-ID-BK-M181	12/24	1.100	27.94	1.380	35.04
SFH210-PP_C-D13-ID-BK-M181	13/26	1.200	30.48	1.480	37.58
SFH210-PP_C-D15-ID-BK-M181	15/30	1.400	35.56	1.680	42.66
SFH210-PP_C-D17-ID-BK-M181	17/34	1.600	40.64	1.880	47.74
SFH210-PP_C-D20-ID-BK-M181	20/40	1.900	48.26	2.180	55.36
SFH210-PP_C-D25-ID-BK-M181	25/50	2.400	60.96	2.680	68.06
POSITION 30 & 32:		30/60		SEE SHEET 2 FOR DIMENSIONS	
SEE SHEET 2 FOR P/N		32/64		SEE SHEET 2 FOR DIMENSIONS	

UNLESS OTHERWISE SPECIFIED:  
DIMENSIONS ARE IN INCHES (MM)

TOLERANCES:  
ANGULAR:  
DECIMALS  
.XX = ± .012 [3]  
.XXX = ± .008 [20]  
.XXXX = ± .0040 [100]

DRAWN	DATE	NAME
	3/17/2009	JH

THE INFORMATION HEREIN CONTAINS PROPRIETARY INFORMATION OF SULLINS ELECTRONICS AND IS NOT TO BE REPRODUCED, USED OR DISCLOSED TO OTHERS FOR ANY PURPOSE EXCEPT AS SPECIFICALLY AUTHORIZED IN WRITING BY AN OFFICER OF SULLINS ELECTRONICS.

**SULLINS**  
CONNECTOR SOLUTIONS

TITLE  
IDC SOCKET, .100" CC/RS, w/o KEY

PART NUMBER  
SFH210-PP\_C-D -ID-BK-M181

SIZE	CAGE CODE	DWG. NO.	REV
C	54453	11226	E

SCALE: 2:1

SHEET 1 OF 2

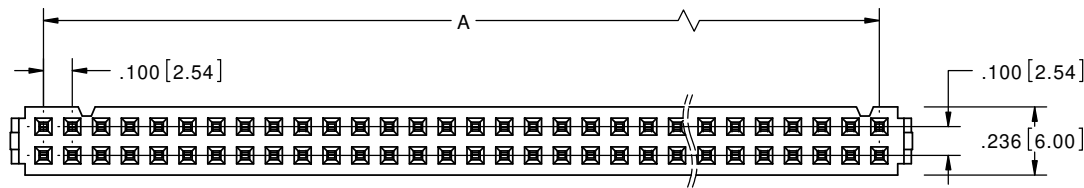
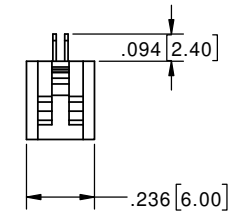
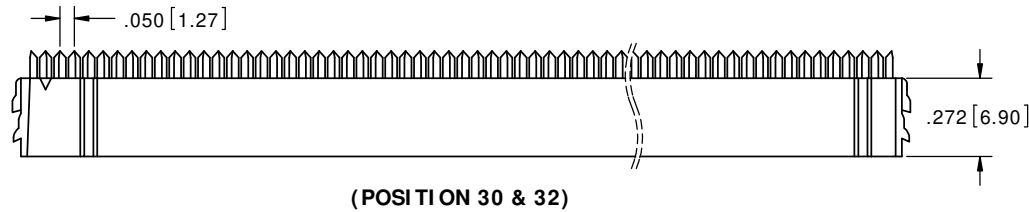
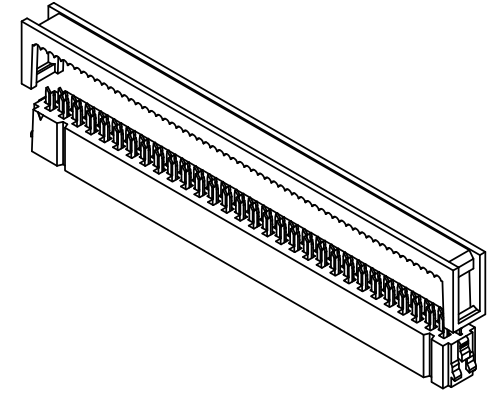
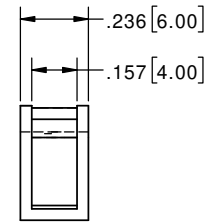
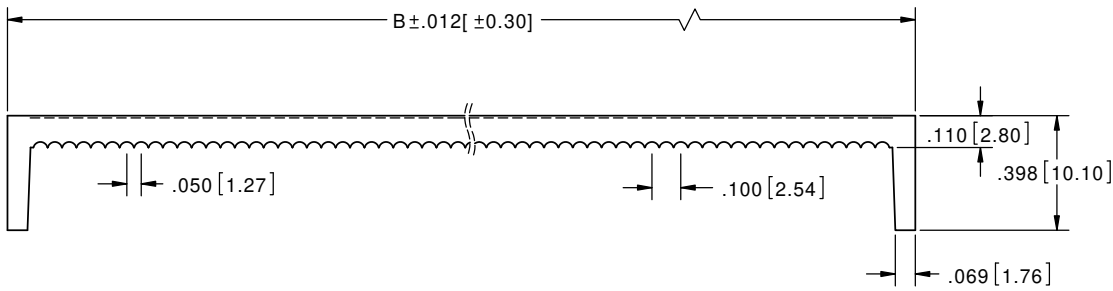

- NOTES:
1. INSULATOR MATERIAL: PBT 30% GLASS FIBER.
  2. CONTACT MATERIAL: PHOSPHOR BRONZE.
  3. OPERATING TEMPERATURE: -40 °C TO +105 °C.
  4. UL FLAMMABILITY RATING: 94V-0.
  5. CURRENT RATING: 1 AMP
  6. INSULATION RESISTANCE: 3,000 MEGOMHS MIN.
  7. CONTACT RESISTANCE: 30m OHMS MAX.
  8. DIELECTRIC WITHSTANDING: 500 V AC.
  9. MATES WITH SBH11 SERIES
  10. FOR .050" [1.27mm] PITCH FLAT RIBBON CABLE, 26 - 28 AWG WIRE RANGE.
  11. M181 DENOTES PART W/O POLARIZING KEY.

PART NUMBER	POSITIONS/ CONTACTS	A		B	
		INCH	MM	INCH	MM
POSITION 03 THRU 25: SEE SHEET 1 FOR PART NUMBERS	03/06	SEE SHEET 1 FOR DIMENSIONS			
	04/08				
	05/10				
	06/12				
	07/14				
	08/16				
	09/18				
	10/20				
	12/24				
	13/26				
	15/30				
	17/34				
20/40					
25/50					
SFH210-PP_C-D30-ID-BK-M181	30/60	2.900	73.66	3.179	80.74
SFH210-PP_C-D32-ID-BK-M181	32/64	3.100	78.74	3.379	85.82

UNLESS OTHERWISE SPECIFIED:  
DIMENSIONS ARE IN INCHES (MM)

TOLERANCES:  
ANGULAR:  
DECIMALS  
XX=±.012 [3]  
.XXX=±.008 [20]  
.XXXX=±.0040 [100]

DRAWN: 3/17/2009 JH

DATE: 3/17/2009

NAME: JH

THE INFORMATION HEREIN CONTAINS PROPRIETARY INFORMATION OF SULLINS ELECTRONICS AND IS NOT TO BE REPRODUCED, USED OR DISCLOSED TO OTHERS FOR ANY PURPOSE EXCEPT AS SPECIFICALLY AUTHORIZED IN WRITING BY AN OFFICER OF SULLINS ELECTRONICS.

**SULLINS**  
CONNECTOR SOLUTIONS

TITLE: HEADER FEMALE, .100" CC/RS, w/o KEY

PART NUMBER: SFH210-PP\_C-D\_-ID-BK-M181

SIZE: C CAGE CODE: 54453 DWG. NO.: 11226 REV: E

SCALE: 2:1 SHEET 2 OF 2



RoHS COMPLIANT