



Chipsmall Limited consists of a professional team with an average of over 10 year of expertise in the distribution of electronic components. Based in Hongkong, we have already established firm and mutual-benefit business relationships with customers from,Europe,America and south Asia,supplying obsolete and hard-to-find components to meet their specific needs.

With the principle of “Quality Parts,Customers Priority,Honest Operation,and Considerate Service”,our business mainly focus on the distribution of electronic components. Line cards we deal with include Microchip,ALPS,ROHM,Xilinx,Pulse,ON,Everlight and Freescale. Main products comprise IC,Modules,Potentiometer,IC Socket,Relay,Connector.Our parts cover such applications as commercial,industrial, and automotives areas.

We are looking forward to setting up business relationship with you and hope to provide you with the best service and solution. Let us make a better world for our industry!



Contact us

Tel: +86-755-8981 8866 Fax: +86-755-8427 6832

Email & Skype: info@chipsmall.com Web: www.chipsmall.com

Address: A1208, Overseas Decoration Building, #122 Zhenhua RD., Futian, Shenzhen, China



PART NUMBER CODING

SFH213-PP C-D -ID-BK

COLOR

BK= BLACK

NUMBER OF POSITIONS

(CONTACTS PER ROW)

PLATING

(SEE PLATING TABLE)

PLATING TABLE

(.000030" MIN NICKEL UNDERPLATE)

CONTACT SURFACE	TERMINATION
P = GOLD FLASH	GOLD FLASH
V = GOLD FLASH	NICKEL
K = .000015" GOLD	NICKEL
J = .000015" GOLD	GOLD FLASH
E = .000100" PURE TIN, MATTE	.000100" PURE TIN, MATTE

REVISIONS

REV.	ECO. NO	DESCRIPTION	DATE	BY
B	2159	UPDATE NOTE 10 FOR FLAT RIBBON CABLE SPEC	07/05/2010	LH
C	3374	UPDATE DIMENSION TABLE 'C' OF 03 AND 04 POSITION .526[13.35] (WAS .516[13.10]), REMOVE 30 AND 32 POSITION OF DIMENSION .047[1.20] ON PAGE 2	02/01/2015	LH
D	3697	ADD 30 AND 32 POSITIONS DIM B TOLERANCE	06/16/2017	LH

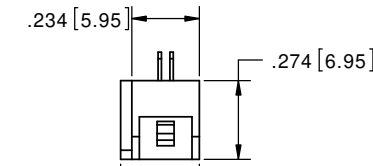
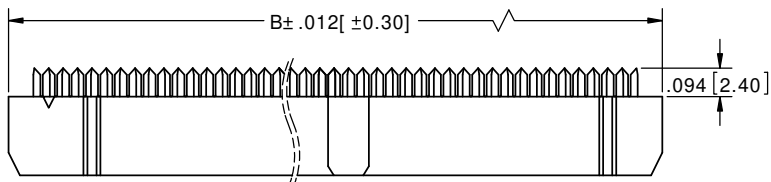
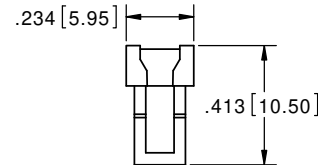
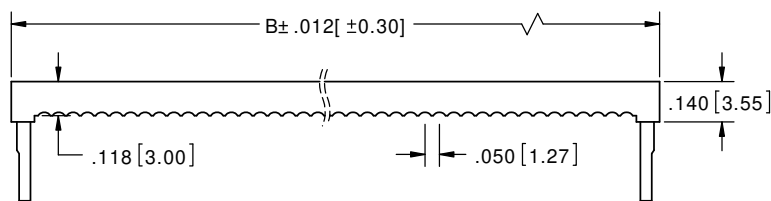
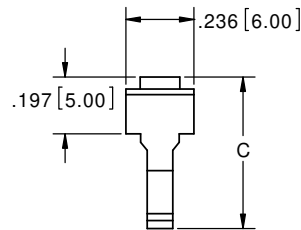
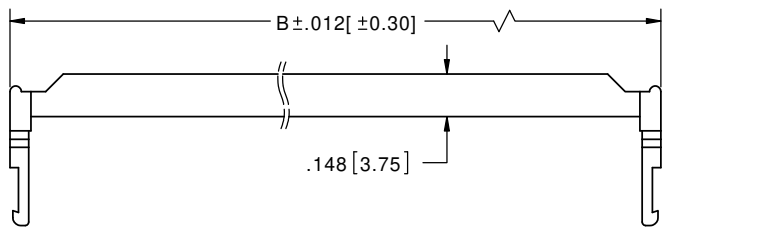

(POSITION 07 THRU 25)

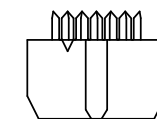
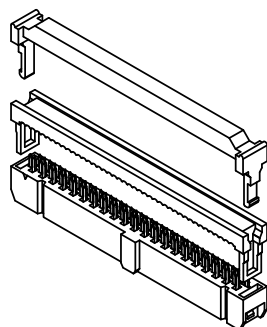
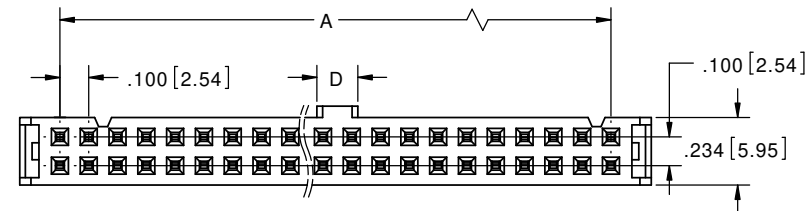

(POSITION 03)

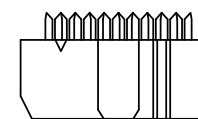

(POSITION 05)

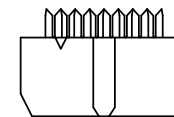

(POSITION 04)

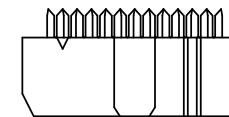

(POSITION 06)

PART NUMBER	POSITIONS/ CONTACTS	A		B		C		D	
		INCH	MM	INCH	MM	INCH	MM	INCH	MM
SFH213-PP C-D03-ID-BK	03/06	0.200	5.08	0.480	12.18	0.526	13.35	0.075	1.90
SFH213-PP C-D04-ID-BK	04/08	0.300	7.62	0.580	14.72				
SFH213-PP C-D05-ID-BK	05/10	0.400	10.16	0.680	17.26				
SFH213-PP C-D06-ID-BK	06/12	0.500	12.70	0.780	19.80	0.526	13.35	0.142	3.60
SFH213-PP C-D07-ID-BK	07/14	0.600	15.24	0.880	22.34				
SFH213-PP C-D08-ID-BK	08/16	0.700	17.78	0.980	24.88	0.526	13.35	0.142	3.60
SFH213-PP C-D09-ID-BK	09/18	0.800	20.32	1.080	27.42				
SFH213-PP C-D10-ID-BK	10/20	0.900	22.86	1.180	29.96				
SFH213-PP C-D12-ID-BK	12/24	1.100	27.94	1.380	35.04	0.526	13.35	0.142	3.60
SFH213-PP C-D13-ID-BK	13/26	1.200	30.48	1.480	37.58				
SFH213-PP C-D15-ID-BK	15/30	1.400	35.56	1.680	42.66	0.526	13.35	0.142	3.60
SFH213-PP C-D17-ID-BK	17/34	1.600	40.64	1.880	47.74				
SFH213-PP C-D20-ID-BK	20/40	1.900	48.26	2.180	55.36	0.526	13.35	0.142	3.60
SFH213-PP C-D25-ID-BK	25/50	2.400	60.96	2.680	68.06				
POSITION 30 & 32:	30/60								
SEE SHEET 2 FOR P/N	32/64								

SEE SHEET 2 FOR DIMENSIONS

NOTES:

1. INSULATOR MATERIAL: PBT 30% GLASS FIBER.
2. CONTACT MATERIAL: PHOSPHOR BRONZE.
3. OPERATING TEMPERATURE: -40 °C TO +105 °C.
4. UL FLAMMABILITY RATING: 94V-0.
5. CURRENT RATING: 1 AMP
6. INSULATION RESISTANCE: 3,000 MEGOHMS MIN.
7. CONTACT RESISTANCE: 30m OHMS MAX.
8. DIELECTRIC WITHSTANDING: 500 V AC.
9. MATES WITH SBH11 SERIES
10. FOR .050"[1.27mm] PITCH FLAT RIBBON CABLE, 26 - 28 AWG WIRE RANGE.



RoHS COMPLIANT

UNLESS OTHERWISE SPECIFIED:
DIMENSIONS ARE IN INCHES (MM)

TOLERANCES:

ANGULAR: ± 30'

DECIMALS
XX=± .012 [3]
XXX=± .008 [20]
XXXX=± .0040 [100]

DRAWN	DATE	NAME
JH	3/24/2009	JH

THE INFORMATION HEREIN CONTAINS PROPRIETARY INFORMATION OF SULLINS ELECTRONICS AND IS NOT TO BE REPRODUCED, USED OR DISCLOSED TO OTHERS FOR ANY PURPOSE EXCEPT AS SPECIFICALLY AUTHORIZED IN WRITING BY AN OFFICER OF SULLINS ELECTRONICS.

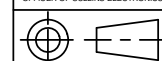

TITLE		PART NUMBER	
IDC SOCKET .100" CC/RS, w/ SR		SFH213-PP C-D -ID-BK	
SIZE	CAGE CODE	DWG. NO.	REV
C	54453	11223	D
SCALE: 2:1		SHEET 1 OF 2	



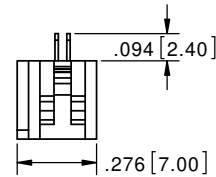
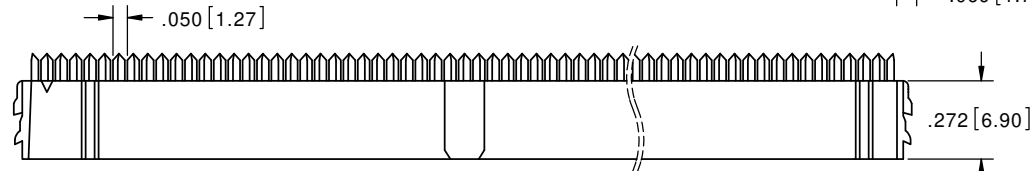
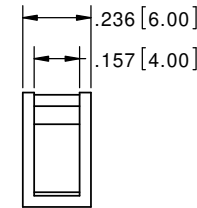
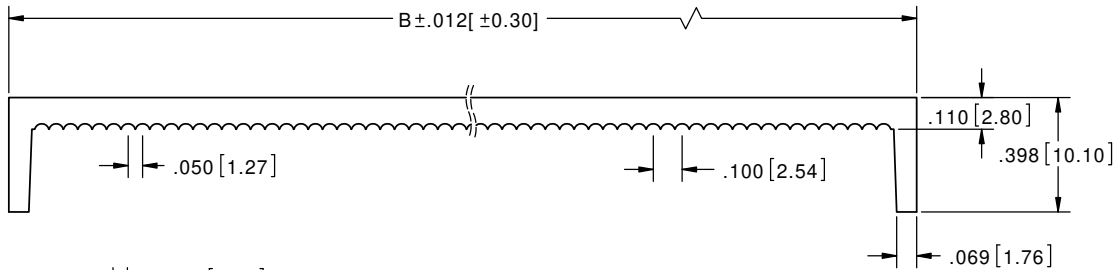
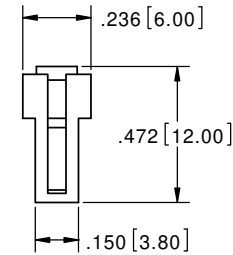
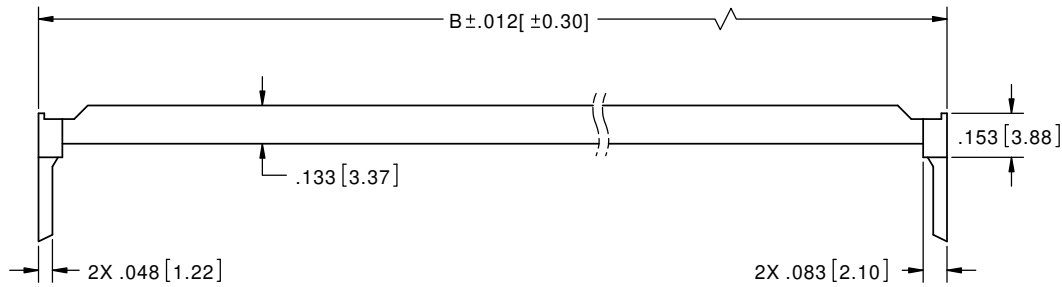

(POSITION 30 & 32)

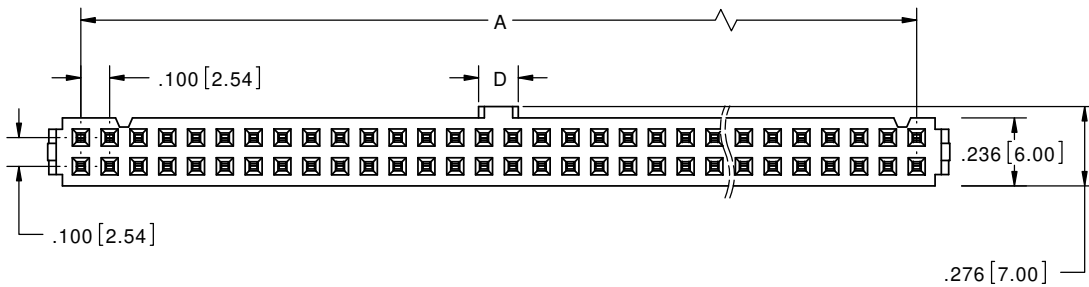
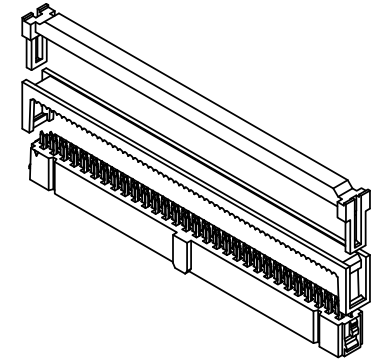

PART NUMBER	POSITIONS/ CONTACTS	A		B		D	
		INCH	MM	INCH	MM	INCH	MM
POSITION 03 THRU 25: SEE SHEET 1 FOR PART NUMBERS	03/06	SEE SHEET 1 FOR DIMENSIONS					
	04/08						
	05/10						
	06/12						
	07/14						
	08/16						
	09/18						
	10/20						
	12/24						
	13/26						
	15/30						
	17/34						
20/40							
25/50							
SFH213-PP_C-D30-ID-BK	30/60	2.900	73.66	3.179	80.74	0.138	3.50
SFH213-PP_C-D32-ID-BK	32/64	3.100	78.74	3.379	85.82		

- NOTES:
- INSULATOR MATERIAL: PBT 30% GLASS FIBER.
 - CONTACT MATERIAL: PHOSPHOR BRONZE.
 - OPERATING TEMPERATURE: -40 °C TO +105 °C.
 - UL FLAMMABILITY RATING: 94V-0.
 - CURRENT RATING: 1 AMP
 - INSULATION RESISTANCE: 3,000 MEGOHMS MIN.
 - CONTACT RESISTANCE: 30m OHMS MAX.
 - DIELECTRIC WITHSTANDING: 500 V AC.
 - MATES WITH SBH11 SERIES
 - FOR .050" [1.27mm] PITCH FLAT RIBBON CABLE, 26 - 28 AWG WIRE RANGE.



RoHS COMPLIANT

UNLESS OTHERWISE SPECIFIED:
DIMENSIONS ARE IN INCHES (MM)

TOLERANCES:

ANGULAR: ± 30°

DECIMALS
 .XX = ± .012 [3]
 .XXX = ± .008 [20]
 .XXXX = ± .0040 [100]

DRAWN 3/24/2009 NAME JH

THE INFORMATION HEREIN CONTAINS
 PROPRIETARY INFORMATION OF
 SULLINS ELECTRONICS AND IS NOT
 TO BE REPRODUCED, USED OR
 DISCLOSED TO OTHERS FOR ANY
 PURPOSE EXCEPT AS SPECIFICALLY
 AUTHORIZED IN WRITING BY AN
 OFFICER OF SULLINS ELECTRONICS.

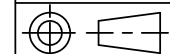

TITLE IDC SOCKET, .100" CC/RS w/ SR

PART NUMBER SFH213-PP_C-D_-ID-BK

SIZE C CAGE CODE 54453 DWG. NO. 11223 REV D

SCALE: 2:1 SHEET 2 OF 2