



Chipsmall Limited consists of a professional team with an average of over 10 year of expertise in the distribution of electronic components. Based in Hongkong, we have already established firm and mutual-benefit business relationships with customers from,Europe,America and south Asia,supplying obsolete and hard-to-find components to meet their specific needs.

With the principle of "Quality Parts,Customers Priority,Honest Operation,and Considerate Service",our business mainly focus on the distribution of electronic components. Line cards we deal with include Microchip,ALPS,ROHM,Xilinx,Pulse,ON,Everlight and Freescale. Main products comprise IC,Modules,Potentiometer,IC Socket,Relay,Connector.Our parts cover such applications as commercial,industrial, and automotives areas.

We are looking forward to setting up business relationship with you and hope to provide you with the best service and solution. Let us make a better world for our industry!



Contact us

Tel: +86-755-8981 8866 Fax: +86-755-8427 6832

Email & Skype: info@chipsmall.com Web: www.chipsmall.com

Address: A1208, Overseas Decoration Building, #122 Zhenhua RD., Futian, Shenzhen, China





1.00 mm [.039"] Contact Centers, Female Headers, Straight/SMT- SFM Series
Mates with SMH series

SPECIFICATIONS

- 1 Amp current rating
- UL Flammability Rating: 94V-0
- Insulator Material: Black LCP
- Contact Material: Phosphor Bronze
- Contact Resistance: 20 milli Ohms Max.
- Operating Temperature: -40°C to +125°C
- Processing Temperature: 260°C Max. for 10 seconds

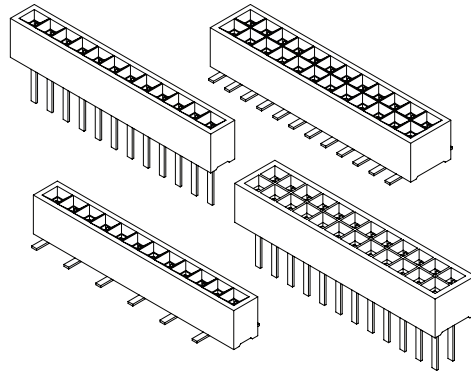

TERMINATION TYPE

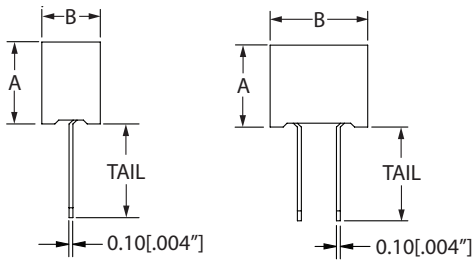

Single Row, Straight, (ST)

Dual Row, Straight, (ST)

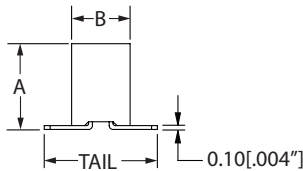

Single Row, SMT, Pin 1 Left (SC) or SMT, Pin 1 Right (SD)

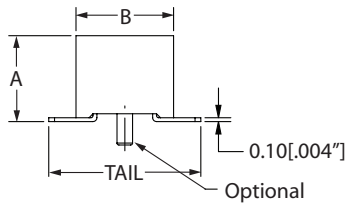

SFM210-, Dual Row, SMT Without Guide Posts (SM) or SMT With Guide Posts (SP)

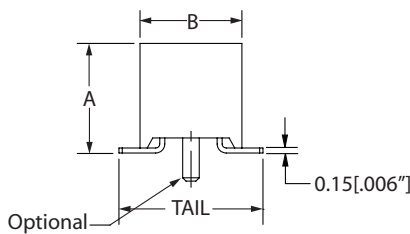

SFM315-, Dual Row, SMT Without Guide Posts (SM) or SMT With Guide Posts (SP)

STRAIGHT

EXAMPLE P/N	A	B	TAIL
SINGLE ROW			
SFM210-LPPE-S10-ST-BK	2.10 [.083"]	1.50 [.059"]	2.40 [.094"]
DUAL ROW			
SFM210-LPPE-D10-ST-BK	2.10 [.083"]	2.50 [.098"]	2.40 [.094"]

SURFACE MOUNT

EXAMPLE P/N	A	B	TAIL
SINGLE ROW			
SFM210-LPPE-S10-SC-BK	2.20 [.087"]	1.50 [.059"]	2.90 [.114"]
SFM210-LPPE-S10-SD-BK	2.20 [.087"]	1.50 [.059"]	2.90 [.114"]

SURFACE MOUNT

EXAMPLE P/N	A	B	TAIL
DUAL ROW			
SFM210-LPPE-D10-SM-BK	2.20 [.087"]	2.50 [.098"]	3.90 [.154"]
SFM210-LPPE-D10-SP-BK	2.20 [.087"]	2.50 [.098"]	3.90 [.154"]

SURFACE MOUNT

EXAMPLE P/N	A	B	TAIL
DUAL ROW			
SFM315-LPPE-D10-SM-BK	3.30 [.130"]	3.07 [.121"]	4.34 [.171"]
SFM315-LPPE-D10-SP-BK	3.30 [.130"]	3.07 [.121"]	4.34 [.171"]



1.00 mm [.039"] Contact Centers, Female Headers, Straight/SMT- SFM Series

Mates with SMH series

PART NUMBER OPTIONS

SFM210 - L P P E - S 10 - ST - BK

SERIES (See Opposite Page)

SFM210 = 2.10 mm [.083"] Profile
SFM315 = 3.15 mm [.124"] Profile

INSULATOR MATERIAL

L = LCP

CONTACT MATERIAL

P = Phosphor Bronze

CONTACT FINISH - RoHS Compliant

P = Gold Flash Overall

S = .00010" Gold on Contact Surface, Gold Flash on Termination, (SFM 210 series)

G = .00010" Gold on Contact Surface, Gold Flash on Termination, (SFM315 series)

CONTACT CENTERS

E = 1.00 mm [.039"]

COLOR

BK = Black

TERMINATION TYPE (See Opposite Page)

ST = Straight (Single & Dual Row)

SC = Surface Mount, Standard (Single Row)

SD = Surface Mount, Opposite Bend,

Applicable on Even Pin Counts (Single Row)

SM = Surface Mount without Guide Posts (Dual Row)

SP = Surface Mount with Guide Posts (Dual Row)

NUMBER OF CONTACT POSITIONS (Pins per Row)

02 thru 50

NUMBER OF ROWS

S = Single Row

D = Dual Row

DIMENSIONS

STRAIGHT

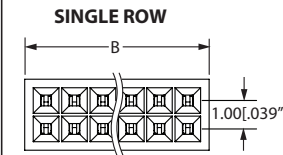
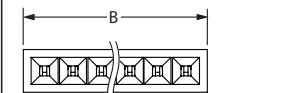
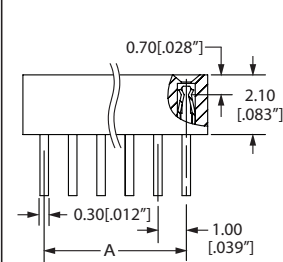

DUAL ROW

Surface Mount Top/Bottom Entry, Single Row

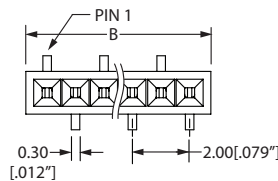

(SC) STANDARD

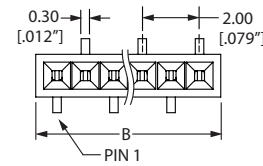

(SD) OPPOSITE BEND,
APPLICABLE ON EVEN PIN COUNTS

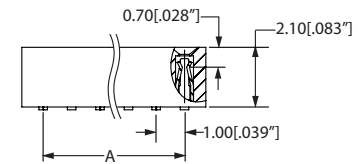

Surface Mount Top/Bottom Entry, Dual Row

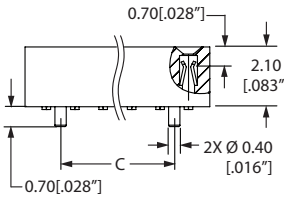
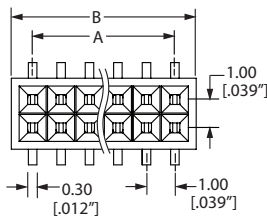

SFM210-

OPTIONAL GUIDE POSTS REQUIRE (SP) TERMINATION TYPE

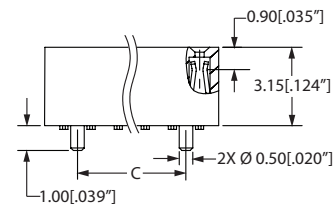

SFM315-

NUMBER OF CONTACTS SINGLE/ DUAL	A		B (SFM210)		B (SFM315)		C		NUMBER OF CONTACTS SINGLE/ DUAL	A		B (SFM210)		B (SFM315)		C	
	mm	in	mm	in	mm	in	mm	in		mm	in	mm	in	mm	in	mm	in
02/04*	1.00	0.039	2.50	0.098	2.40	0.094	N/A	N/A	27/54	26.00	1.024	27.50	1.083	27.40	1.079	25.00	0.984
03/06	2.00	0.079	3.50	0.138	3.40	0.134	1.00	0.039	28/56	27.00	1.063	28.50	1.122	28.40	1.118	26.00	1.024
04/08	3.00	0.118	4.50	0.177	4.40	0.173	2.00	0.079	29/58	28.00	1.102	29.50	1.161	29.40	1.157	27.00	1.063
05/10	4.00	0.157	5.50	0.217	5.40	0.213	3.00	0.118	30/60	29.00	1.142	30.50	1.201	30.40	1.197	28.00	1.102
06/12	5.00	0.197	6.50	0.256	6.40	0.252	4.00	0.157	31/62	30.00	1.181	31.50	1.240	31.40	1.236	29.00	1.142
07/14	6.00	0.236	7.50	0.295	7.40	0.291	5.00	0.197	32/64	31.00	1.220	32.50	1.280	32.40	1.276	30.00	1.181
08/16	7.00	0.276	8.50	0.335	8.40	0.331	6.00	0.236	33/66	32.00	1.260	33.50	1.319	33.40	1.315	31.00	1.220
09/18	8.00	0.315	9.50	0.374	9.40	0.370	7.00	0.276	34/68	33.00	1.299	34.50	1.358	34.40	1.354	32.00	1.260
10/20	9.00	0.354	10.50	0.413	10.40	0.409	8.00	0.315	35/70	34.00	1.339	35.50	1.398	35.40	1.394	33.00	1.299
11/22	10.00	0.394	11.50	0.453	11.40	0.449	9.00	0.354	36/72	35.00	1.378	36.50	1.437	36.40	1.433	34.00	1.339
12/24	11.00	0.433	12.50	0.492	12.40	0.488	10.00	0.394	37/74	36.00	1.417	37.50	1.476	37.40	1.472	35.00	1.378
13/26	12.00	0.472	13.50	0.531	13.40	0.528	11.00	0.433	38/76	37.00	1.457	38.50	1.516	38.40	1.512	36.00	1.417
14/28	13.00	0.512	14.50	0.571	14.40	0.567	12.00	0.472	39/78	38.00	1.496	39.50	1.555	39.40	1.551	37.00	1.457
15/30	14.00	0.551	15.50	0.610	15.40	0.606	13.00	0.512	40/80	39.00	1.535	40.50	1.594	40.40	1.591	38.00	1.496
16/32	15.00	0.591	16.50	0.650	16.40	0.646	14.00	0.551	41/82	40.00	1.575	41.50	1.634	41.40	1.630	39.00	1.535
17/34	16.00	0.630	17.50	0.689	17.40	0.685	15.00	0.591	42/84	41.00	1.614	42.50	1.673	42.40	1.669	40.00	1.575
18/36	17.00	0.669	18.50	0.728	18.40	0.724	16.00	0.630	43/86	42.00	1.654	43.50	1.713	43.40	1.709	41.00	1.614
19/38	18.00	0.709	19.50	0.768	19.40	0.764	17.00	0.669	44/88	43.00	1.693	44.50	1.752	44.40	1.748	42.00	1.654
20/40	19.00	0.748	20.50	0.807	20.40	0.803	18.00	0.709	45/90	44.00	1.732	45.50	1.791	45.40	1.787	43.00	1.693
21/42	20.00	0.787	21.50	0.846	21.40	0.843	19.00	0.748	46/92	45.00	1.772	46.50	1.831	46.40	1.827	44.00	1.732
22/44	21.00	0.827	22.50	0.886	22.40	0.882	20.00	0.787	47/94	46.00	1.811	47.50	1.870	47.40	1.866	45.00	1.772
23/46	22.00	0.866	23.50	0.925	23.40	0.921	21.00	0.827	48/96	47.00	1.850	48.50	1.909	48.40	1.906	46.00	1.811
24/48	23.00	0.906	24.50	0.965	24.40	0.961	22.00	0.866	49/98	48.00	1.890	49.50	1.949	49.40	1.945	47.00	1.850
25/50	24.00	0.945	25.50	1.004	25.40	1.000	23.00	0.906	50/100	49.00	1.929	50.50	1.988	50.40	1.984	48.00	1.890
26/52	25.00	0.984	26.50	1.043	26.40	1.039	24.00	0.945									

* Position 2 not available with guide posts on SFM210 Series (Termination Type SP).