



Chipsmall Limited consists of a professional team with an average of over 10 year of expertise in the distribution of electronic components. Based in Hongkong, we have already established firm and mutual-benefit business relationships with customers from,Europe,America and south Asia,supplying obsolete and hard-to-find components to meet their specific needs.

With the principle of “Quality Parts,Customers Priority,Honest Operation,and Considerate Service”,our business mainly focus on the distribution of electronic components. Line cards we deal with include Microchip,ALPS,ROHM,Xilinx,Pulse,ON,Everlight and Freescale. Main products comprise IC,Modules,Potentiometer,IC Socket,Relay,Connector.Our parts cover such applications as commercial,industrial, and automotives areas.

We are looking forward to setting up business relationship with you and hope to provide you with the best service and solution. Let us make a better world for our industry!



## Contact us

Tel: +86-755-8981 8866 Fax: +86-755-8427 6832

Email & Skype: info@chipsmall.com Web: www.chipsmall.com

Address: A1208, Overseas Decoration Building, #122 Zhenhua RD., Futian, Shenzhen, China



DO NOT SCALE FROM THIS PRINT

DESIGNED & DIMENSIONED IN MILLIMETERS [INCHES]

SFPC-XX

- TAIL OPTION  
 -SL: SOLDER LEADS (USE SFPC-S1-SL-N)  
 -PC: PCI PRESS FIT (USE SFPC-S1-PC-X)  
 -PF: PRESS FIT (USE SFPC-S1-PF-X)

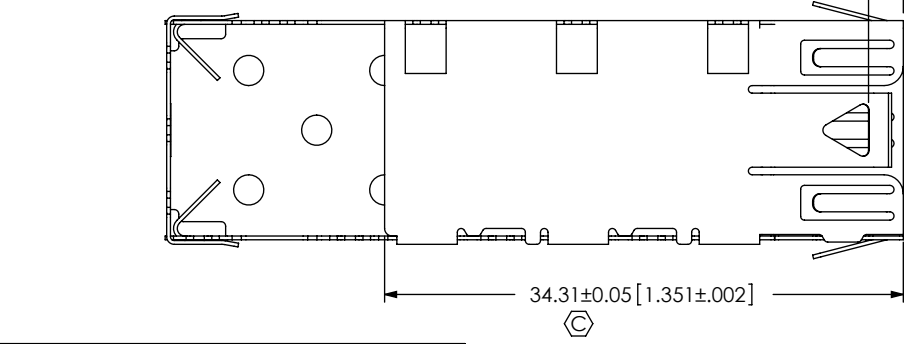
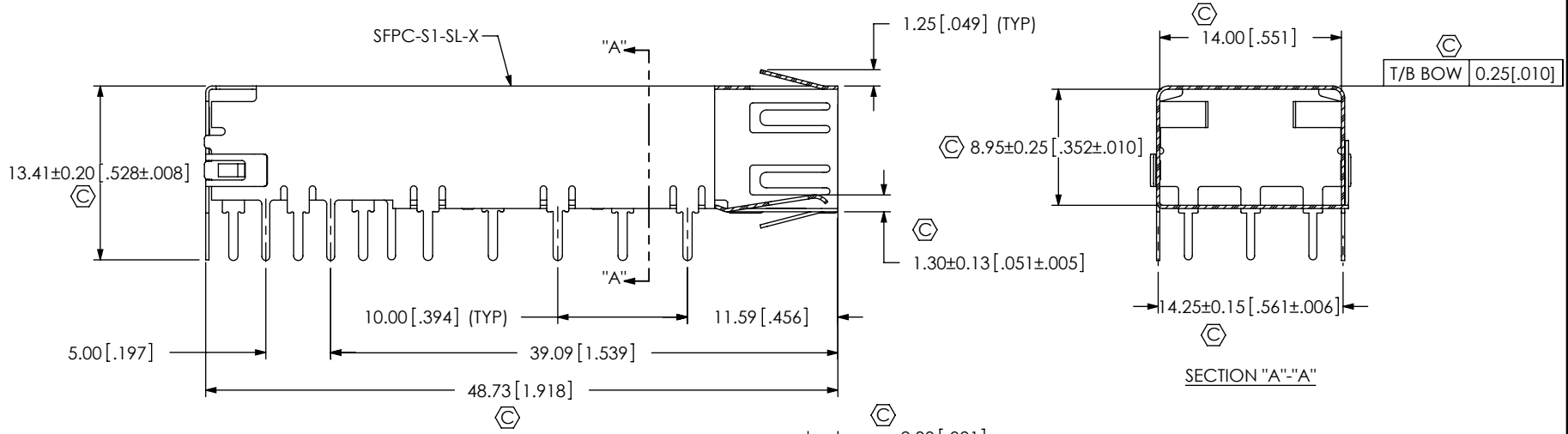
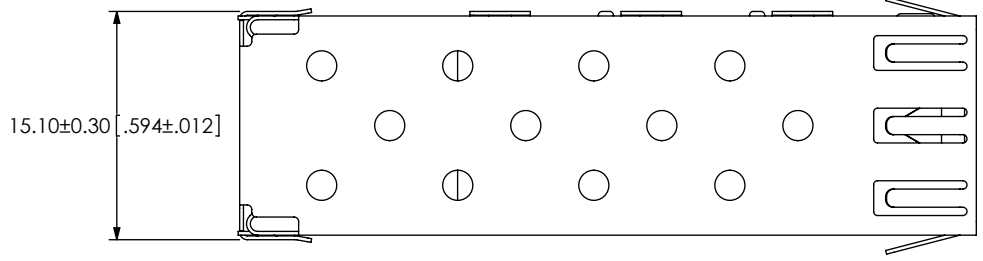
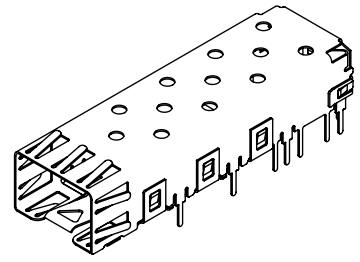

- NOTES:
- ⊕ REPRESENTS A CRITICAL DIMENSION.
  - PARTS TO BE PACKAGED IN TUBE, SUPPLIED BY VENDOR.
  - FABRICATED PARTS MUST BE FREE OF SCRATCHES, TOOL MARKS, BENT TAILS, ETC.

PACKAGING VIEW  
 (LOAD PARTS WITH OPEN END IN DIRECTION OF ARROW ON TUBE)

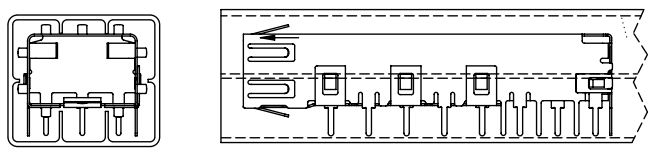

FIG 1  
 SFPC-SL SHOWN

UNLESS OTHERWISE SPECIFIED, DIMENSIONS ARE IN MILLIMETERS. TOLERANCES ARE:  
 DECIMALS ANGLES  
 X.X: ±0.3 [01] 2°  
 X.XX: ±0.13 [005]  
 X.XXX: ±0.051 [0020]

PROPRIETARY NOTE  
 THIS DOCUMENT CONTAINS INFORMATION CONFIDENTIAL AND PROPRIETARY TO SAMTEC, INC. AND SHALL NOT BE REPRODUCED OR TRANSFERRED TO OTHER DOCUMENTS OR DISCLOSED TO OTHERS OR USED FOR ANY PURPOSE OTHER THAN THAT WHICH IT WAS OBTAINED WITHOUT THE EXPRESSED WRITTEN CONSENT OF SAMTEC, INC.



520 PARK EAST BLVD, NEW ALBANY, IN 47150  
 PHONE: 812-944-6733 FAX: 812-948-5047  
 e-Mail: info@SAMTEC.com code: 55322

MATERIAL: DO NOT SCALE DRAWING SHEET SCALE: 2:1  
 -PC, -PF: STAINLESS STEEL, SUS 304  
 -SL: PHOSPHOROUS BRONZE, C5191H, NICKEL PLATED  
 THICKNESS: 0.250±0.020 [0010±.0008]

DESCRIPTION: SFPC 1X1 ASSEMBLY

DWG. NO. SFPC-XX

BY: VICKY Z 02/02/2010 SHEET 1 OF 2

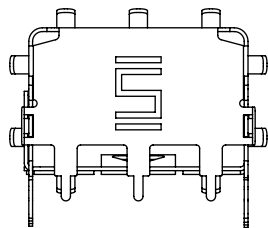

11.45±0.20 [.451±.008]

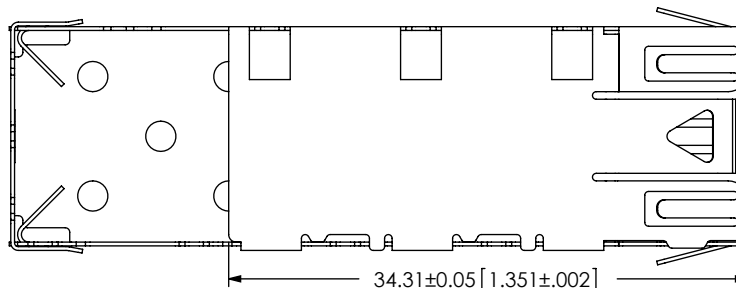
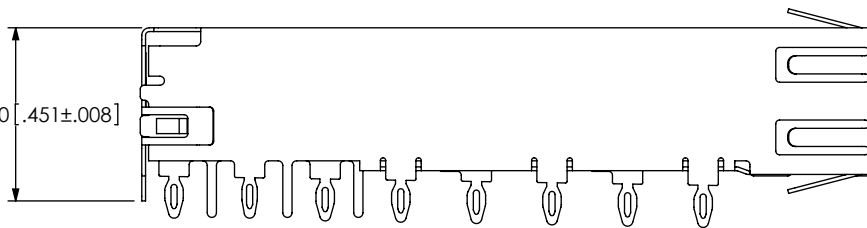

34.31±0.05 [1.351±.002]

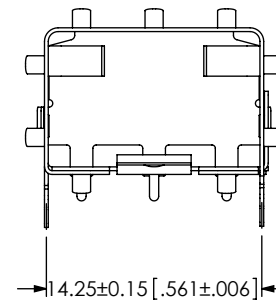

14.25±0.15 [.561±.006]

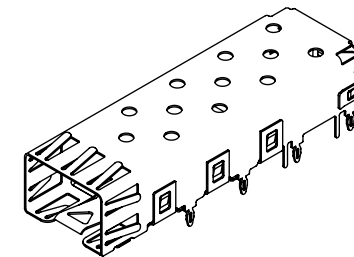
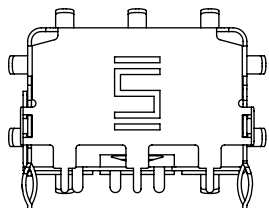
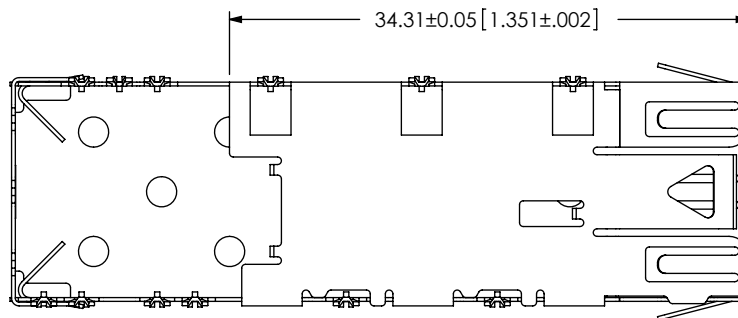
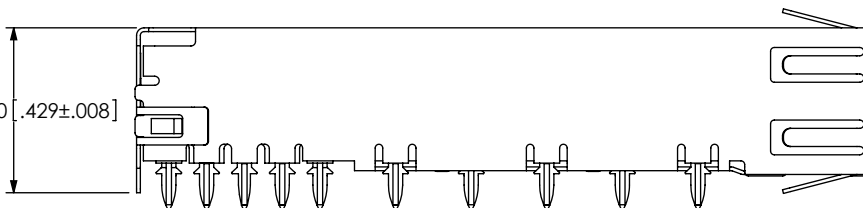

FIG 2  
SFPC-PC SHOWN  
(SAME AS FIG 1, EXCEPT AS SHOWN)



10.91±0.20 [.429±.008]



34.31±0.05 [1.351±.002]

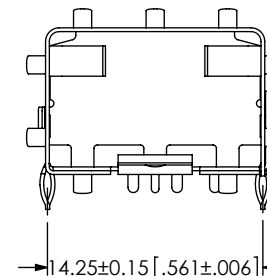

14.25±0.15 [.561±.006]

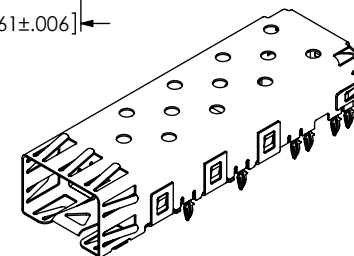

FIG 3  
SFPC-PF SHOWN  
(SAME AS FIG 1, EXCEPT AS SHOWN)

F:\DWG\MISC\MKTG\SFPC-XX-MKT.SLDDRW

**PROPRIETARY NOTE**  
THIS DOCUMENT CONTAINS INFORMATION CONFIDENTIAL AND PROPRIETARY TO SAMTEC, INC. AND SHALL NOT BE REPRODUCED OR TRANSFERRED TO OTHER DOCUMENTS OR DISCLOSED TO OTHERS OR USED FOR ANY PURPOSE OTHER THAN THAT WHICH IT WAS OBTAINED WITHOUT THE EXPRESSED WRITTEN CONSENT OF SAMTEC, INC.

DO NOT SCALE DRAWING

SHEET SCALE: 2:1



520 PARK EAST BLVD, NEW ALBANY, IN 47150  
PHONE: 812-944-6733 FAX: 812-948-5047  
e-Mail: info@SAMTEC.com code: 55322

DESCRIPTION:  
SFPC 1X1 ASSEMBLY

DWG. NO.  
SFPC-XX

BY: VICKY Z 02/02/2010 SHEET 2 OF 2