



Chipsmall Limited consists of a professional team with an average of over 10 year of expertise in the distribution of electronic components. Based in Hongkong, we have already established firm and mutual-benefit business relationships with customers from,Europe,America and south Asia,supplying obsolete and hard-to-find components to meet their specific needs.

With the principle of “Quality Parts,Customers Priority,Honest Operation,and Considerate Service”,our business mainly focus on the distribution of electronic components. Line cards we deal with include Microchip,ALPS,ROHM,Xilinx,Pulse,ON,Everlight and Freescale. Main products comprise IC,Modules,Potentiometer,IC Socket,Relay,Connector.Our parts cover such applications as commercial,industrial, and automotives areas.

We are looking forward to setting up business relationship with you and hope to provide you with the best service and solution. Let us make a better world for our industry!



Contact us

Tel: +86-755-8981 8866 Fax: +86-755-8427 6832

Email & Skype: info@chipsmall.com Web: www.chipsmall.com

Address: A1208, Overseas Decoration Building, #122 Zhenhua RD., Futian, Shenzhen, China





.100" [2.54 mm] Contact Centers, IDC Dip Plug Straight - SIP110 Series

SPECIFICATIONS

- Operating Temperature: -40°C to +105°C
- Current Rating: 1 Amp
- Dielectric Withstanding: 1,000 VAC
- Insulation Resistance: 5,000 Megohms
- For .050" [1.27 mm] Pitch AWG 26-28 Flat Ribbon Cable
- UL Flammability Rating: 94V-0

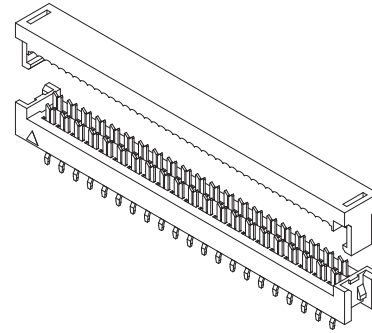

PART NUMBER OPTIONS

SIP110 - P P P C - D 10 - ST - BK

<p>SERIES SIP110 = IDC Dip Plug</p> <p>INSULATOR MATERIAL P = PBT</p> <p>CONTACT MATERIAL P = Phosphor Bronze</p> <p>CONTACT FINISH - RoHS Compliant P = Gold Flash Overall E = .000100" Pure Tin, Matte, Overall V = Gold Flash on Contact Surface, Nickel on Termination J = .000015" Gold on Contact Surface, Gold Flash on Termination K = .000015" Gold on Contact Surface, Nickel on Termination</p>	<p>COLOR BK = Black</p> <p>TERMINATION TYPE ST = Straight SK = Straight with Kink</p> <p>NUMBER OF CONTACT POSITIONS 03 thru 10, 12, 13, 14, 15, 17, 20, 25, 30, 32</p> <p>NUMBER OF ROWS D = Dual Row</p> <p>CONTACT CENTERS C = .100" [2.54 mm]</p>
--	--

DIMENSIONS For complete drawings, go to www.sullincorp.com or e-mail techsupport@sullincorp.com

Dimensions in [] are in millimeters, all others are in inches.

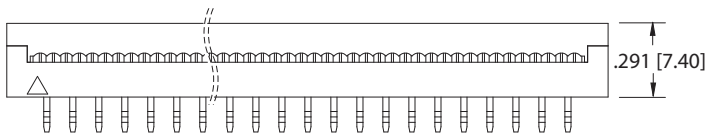

ASSEMBLED FRONT VIEW

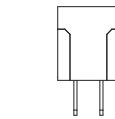

STRAIGHT (ST)

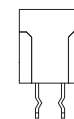

WITH KINK (SK)

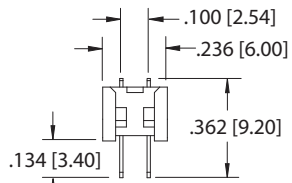
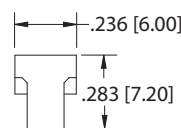
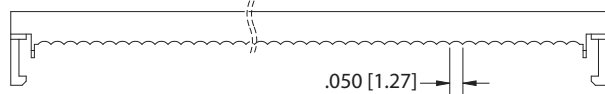

STRAIGHT (ST)

Example P/N: SIP110-PP_C-D10-ST-BK

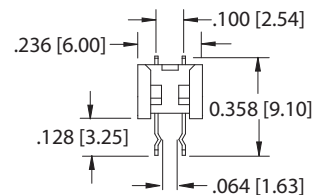
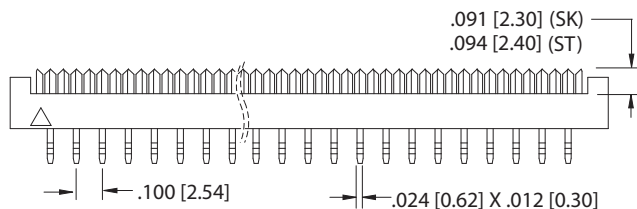

WITH KINK (SK)

Example P/N: SIP110-PP_C-D15-SK-BK